

EVOLUTION CORNER WALL-HUNG BASIN

Cat. No.
4-23X



Faucet not included



Mounting Hardware

W: 23-1/2"
D: 25-1/4"

Interior Dimensions:

Basin Interior: 16" x 13-1/2"
Basin Depth: 6-1/2"
Spout hole: 1-3/8"

Features:

- ▶ Made of Vitreous China
- ▶ Available pre-drilled for single hole faucet (4-231) or 8" widespread (4-238)
- ▶ Pre-drilled overflow hole
- ▶ Contemporary style
- ▶ Mounting Hardware Included
- ▶ Designated for corner installation

Colors:

WH White
BQ Bisque

Meets or exceeds the following specifications: ASME A112.19.2 2013 and CSA B45.1-13 for ceramic plumbing fixtures.

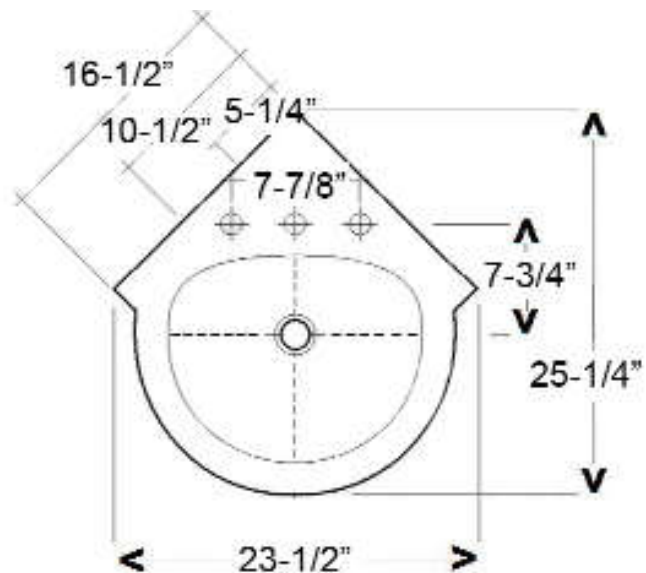

Dimensions of fixture are nominal and may vary within the range of tolerances established by ASMEI Standard A112.19.2-2013. Dimensions and specifications subject to change without notice.