

INSTALLATION MANUAL

METAL FRAME MIRROR

CONTACT US

Thank you for shopping with us! We hope that our products have added a touch of brightness to your life. If you need any assistance, please don't hesitate to reach out. Our dedicated team is available 24/7 to ensure your satisfaction.

ACCESSORIES LIST

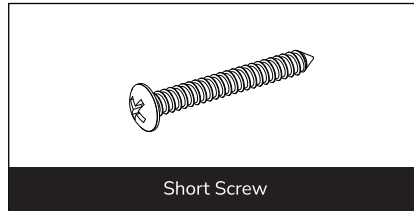
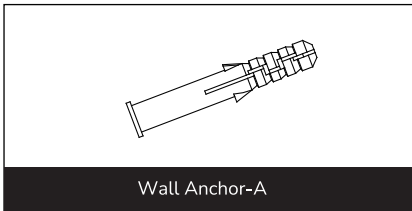

TOOLS REQUIRED

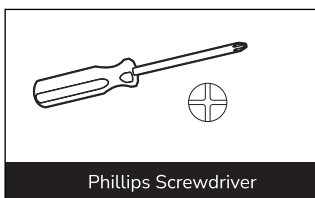
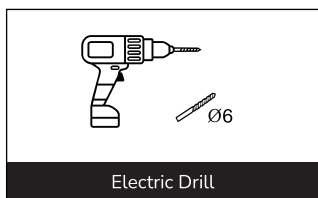
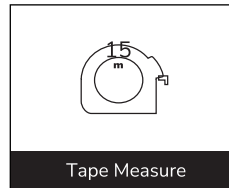
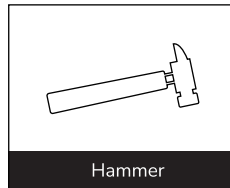
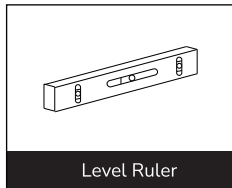

INSTRUCTIONS

You can choose between a vertical or horizontal hanging orientation according to your preference.

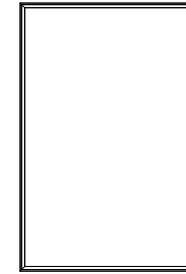

vertical

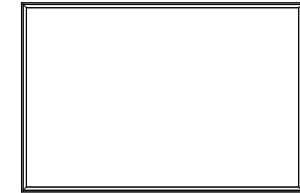

horizontal

1. Confirm the distance between the centers of the two hanging holes and mark them on the wall (①). And use an electric drill to punch holes at mark spots and then apply wall anchors A with a hammer (②).

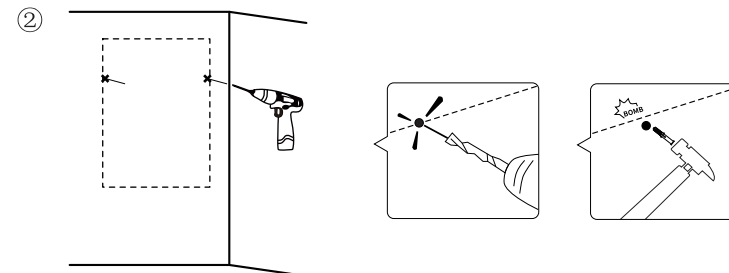
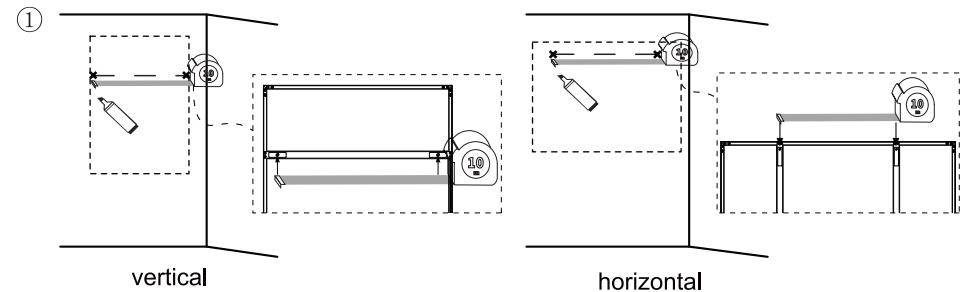

Thickness of Wall

Recommended Drill Bit

> 16mm

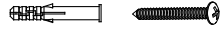

1/4" (6mm) drill bit, drilling depth in 1 31/32" (50mm)

< 8mm

Unapplicable

Note: Please wear goggles and pay attention to safety.

2. Take the short screw and insert it into the wall - inserted rubber plug (the Wall-Anchor A). Make sure to leave a 7 - 14mm gap between the end of the screw and the wall surface. This will provide enough space for hanging the mirror securely.

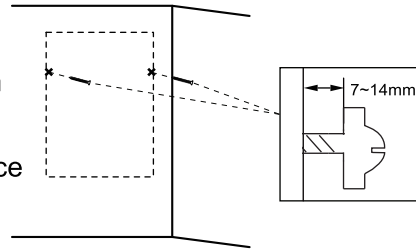

3. First, use your fingers to locate the center point of the hanging hole, align the center point with the screw, and slowly adjust it. After attaching one side, attach it to the other side to ensure that the mirror is inserted into the correct position and securely fastened hang it up.

Note: Suggest installing with two or more people.

