

8236PL-01GD-US

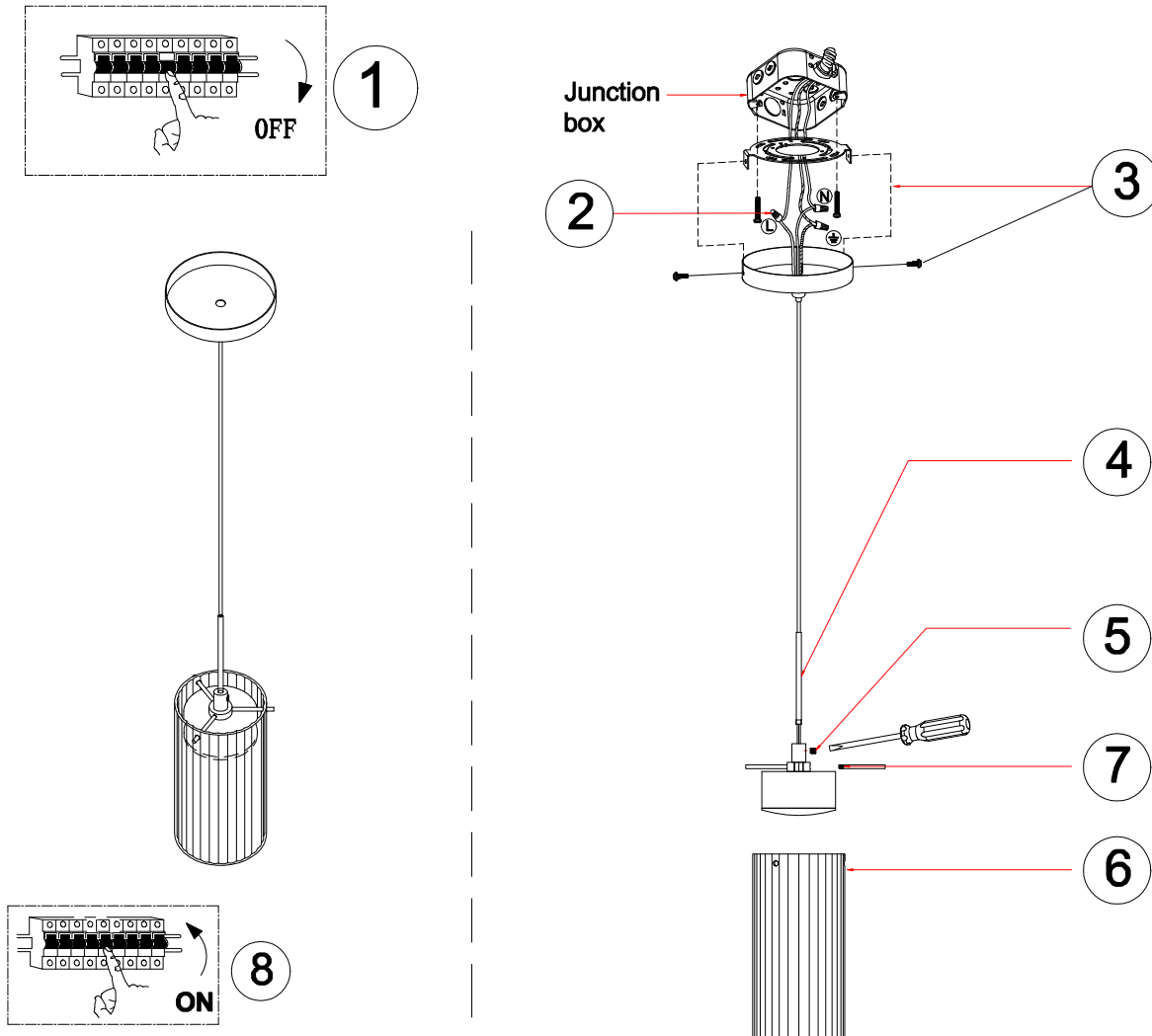

- 1 : Shut down the power.
- 2 : Screw on the terminal cap in the correct way
- 3 : Screw the mounting plate to the junction box Then fix the screws on both sides of the canopy.
- 4: Insert a toothed thin tube into the cylindrical iron piece.
- 5: Use a single-head screwdriver to insert the plastic screw into the cylindrical iron piece and secure the wire.
- 6: Insert the striped glass into the LED lamp head.
- 7: Insert a thin iron rod with teeth through the grooves of the glass, then screw it into the iron piece hole, and secure the glass with the grooves.
- 8: Turn on the main power supply, and the lights will come on.

LED PARAMETERS :

DC - 120V

CRI : 90

Color temperature : 3000 K

Power : 7 W

Lumens : 590 LM

Dimming : 100%-10%, TRIAC