

Assembly Instruction

anctor

Note:

1. Should be assembled on flat ground to keep balance.
2. Before completing the installation, do not tighten the screws.

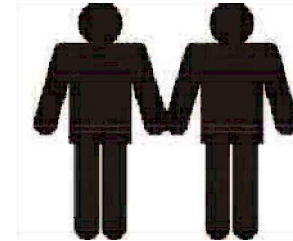
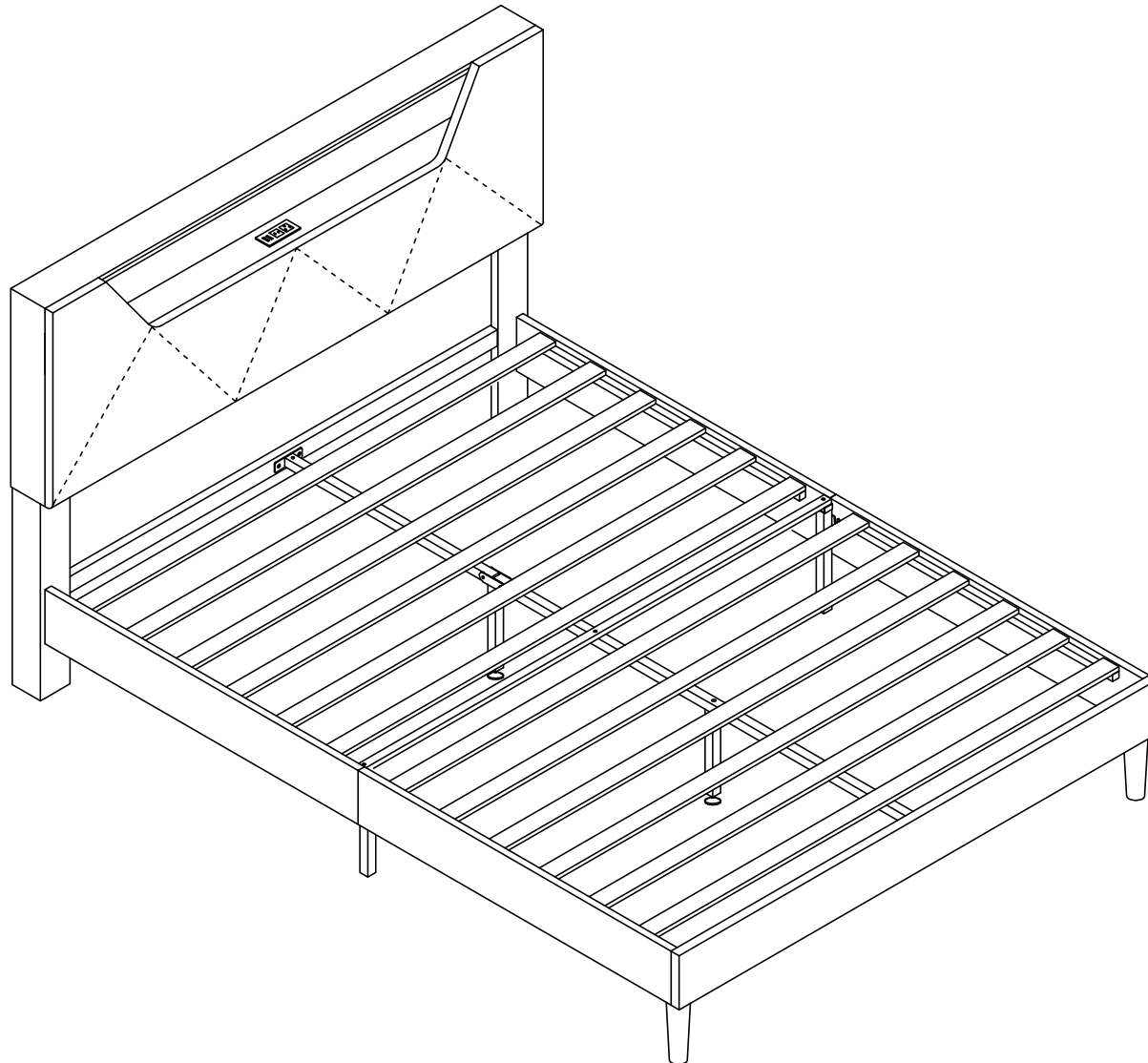

**You must need
two people to install !!**



**Before starting the
assembly, you must
read the whole
manual and follow
the instructions**

Assembly Instruction

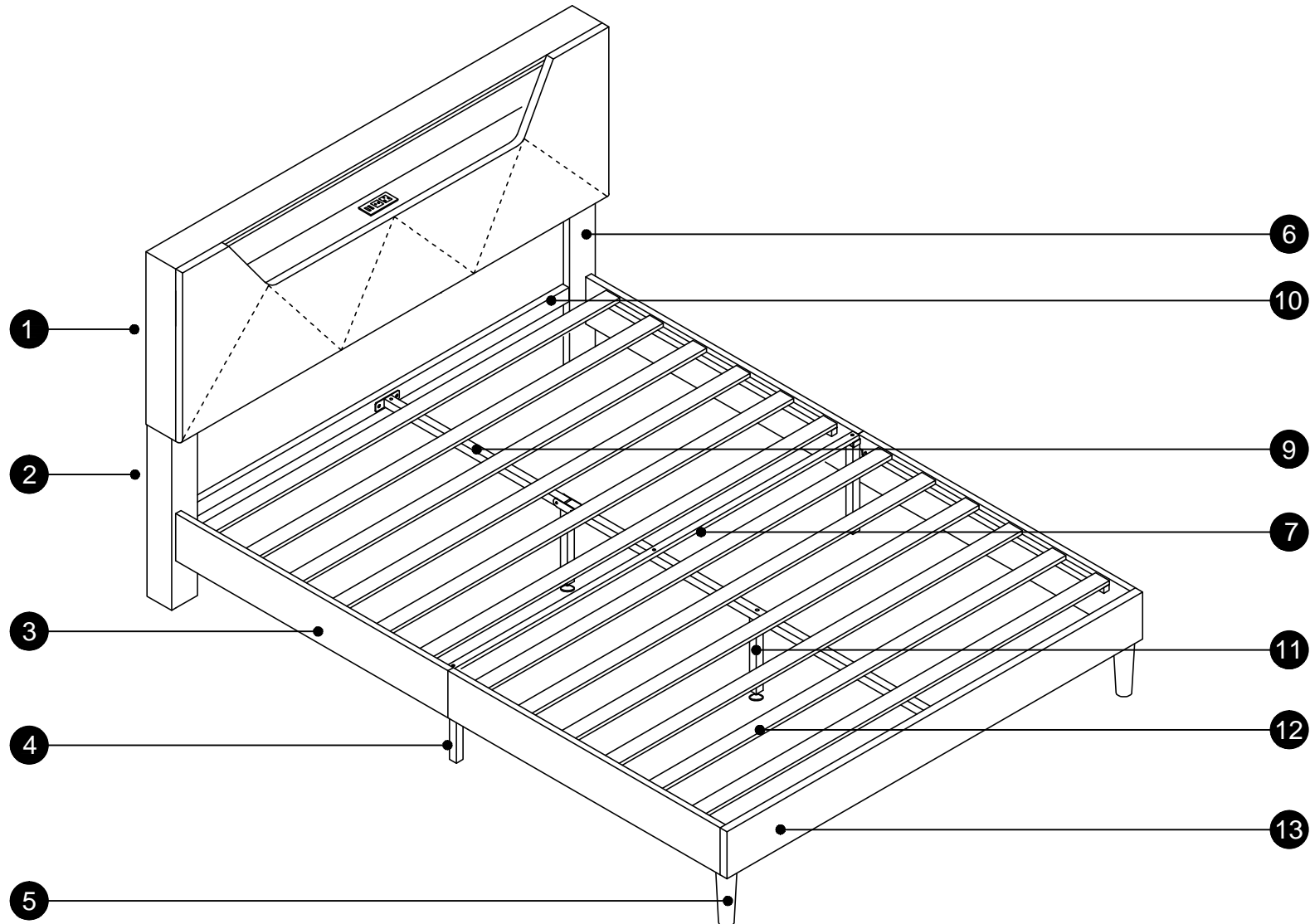

Assembly Instruction

Hardware Parts



M8*15

A 20PCS



M8*20

B 14PCS

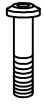

M8*35

C 4PCS

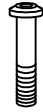

M8*45

D 5PCS



M8*φ22MM

E 4PCS



F 1PC

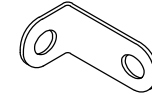

H 2PCS

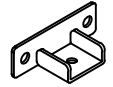

I 2PCS

Part list

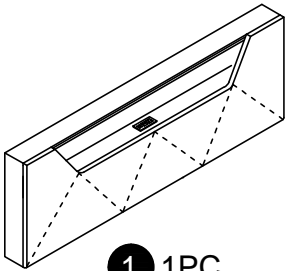

1 1PC

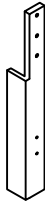

2 1PC

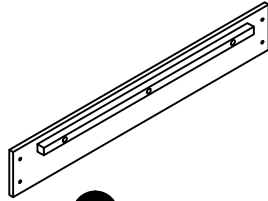

3 4PCS



4 2PCS



5 2PCS



6 1PC

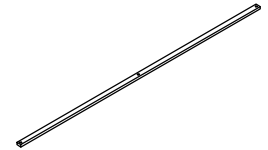

7 1PC

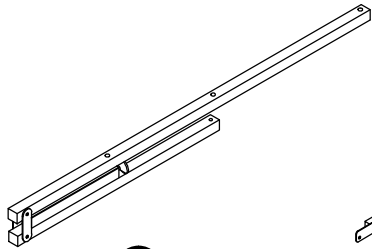

9 1PC

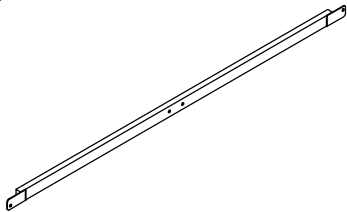

10 1PC



11 1PC

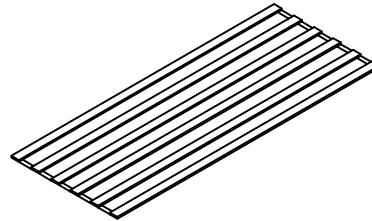

12 2PCS

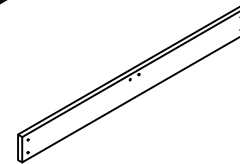

13 1PC

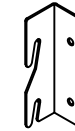

14 1PC



15 1PC



16 1PC



17 1PC

Assembly Instruction

Step:1

Due to the heavy head of the bed, two or more people must participate in the install !!!

M8*45
D 4PCS

M8*φ22MM
E 4PCS

There is a rectangular hole at the bottom, which can be inserted into the foot of the bed

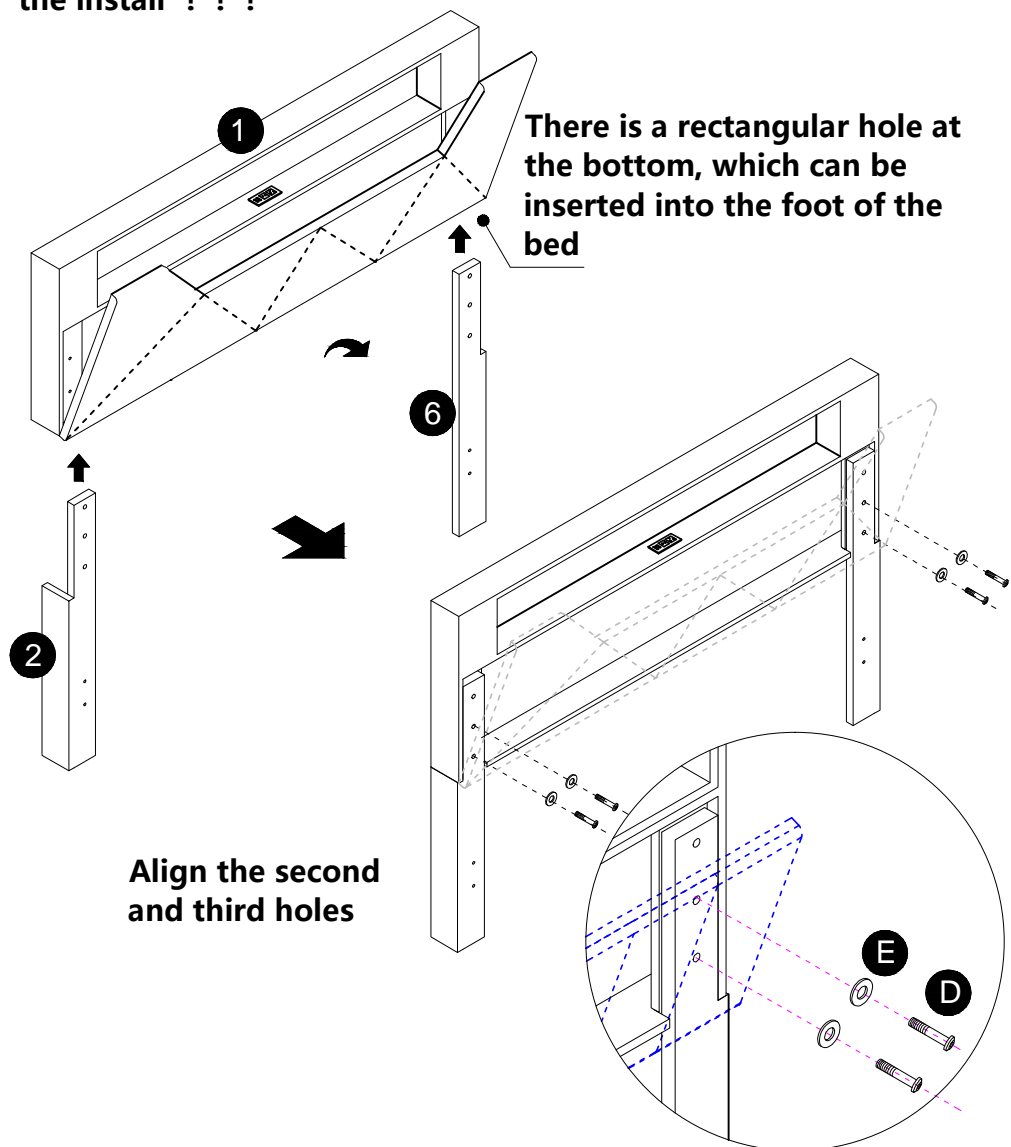

Step:2

M8*20
B 2PCS

The position of the hole near the bottom is downward

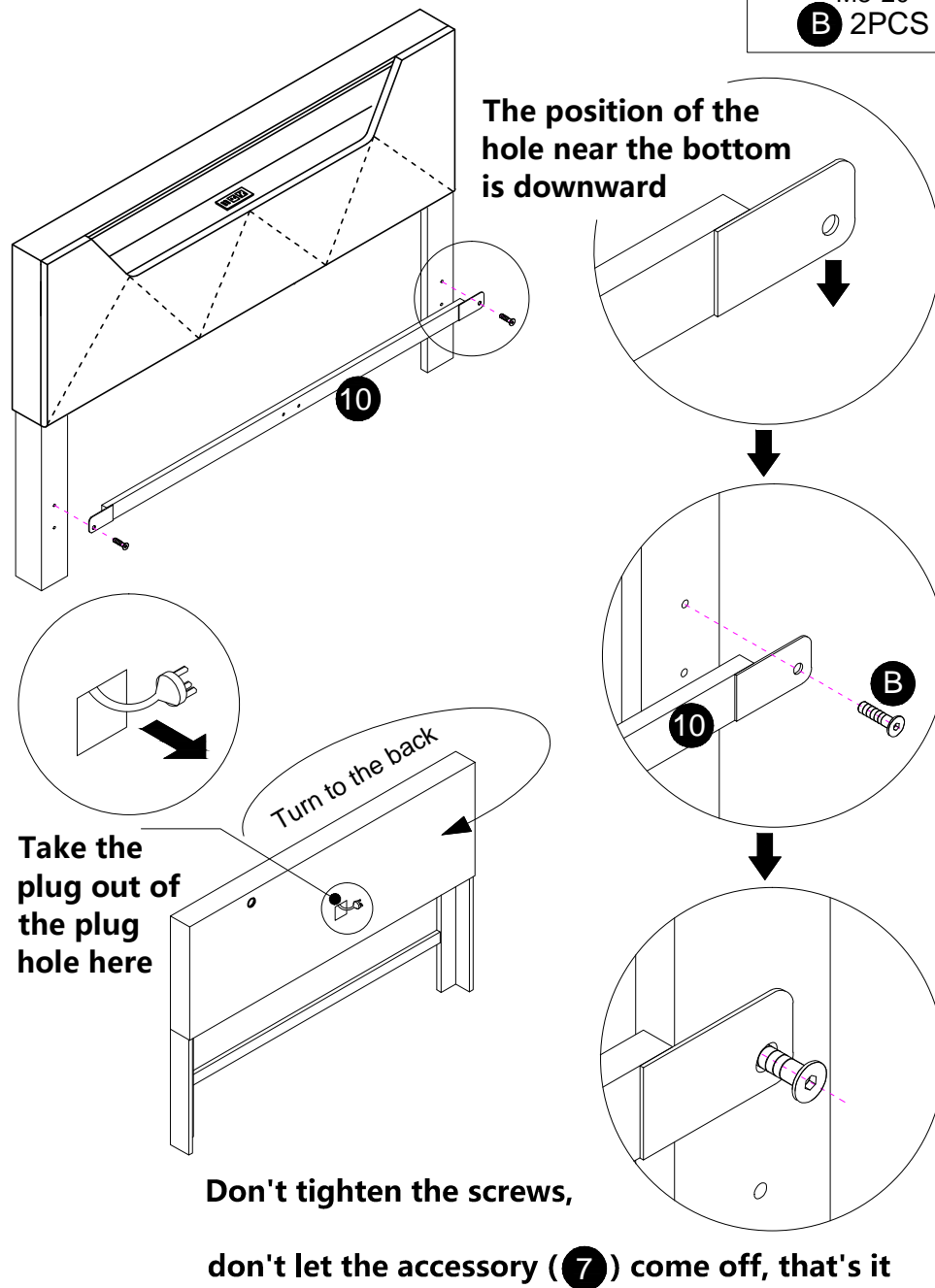

Assembly Instruction

Step:3

M8*15
A 8PCS

Four bed sides (3)
need to be installed, 2 sets in total

Tips : Don't tighten all the screws. Tighten them at last.

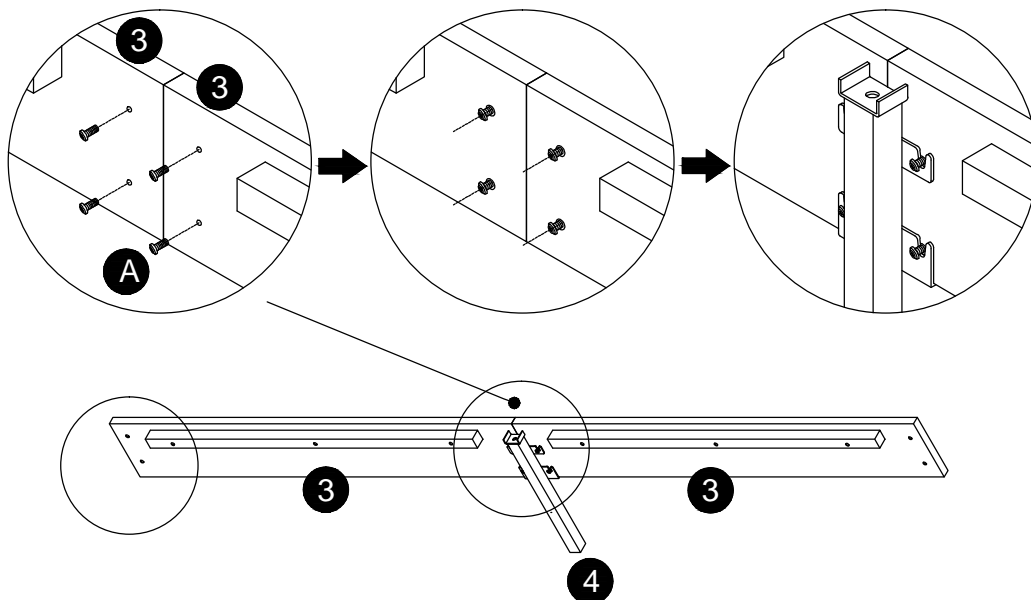

Step:4

M8*15
A 8PCS

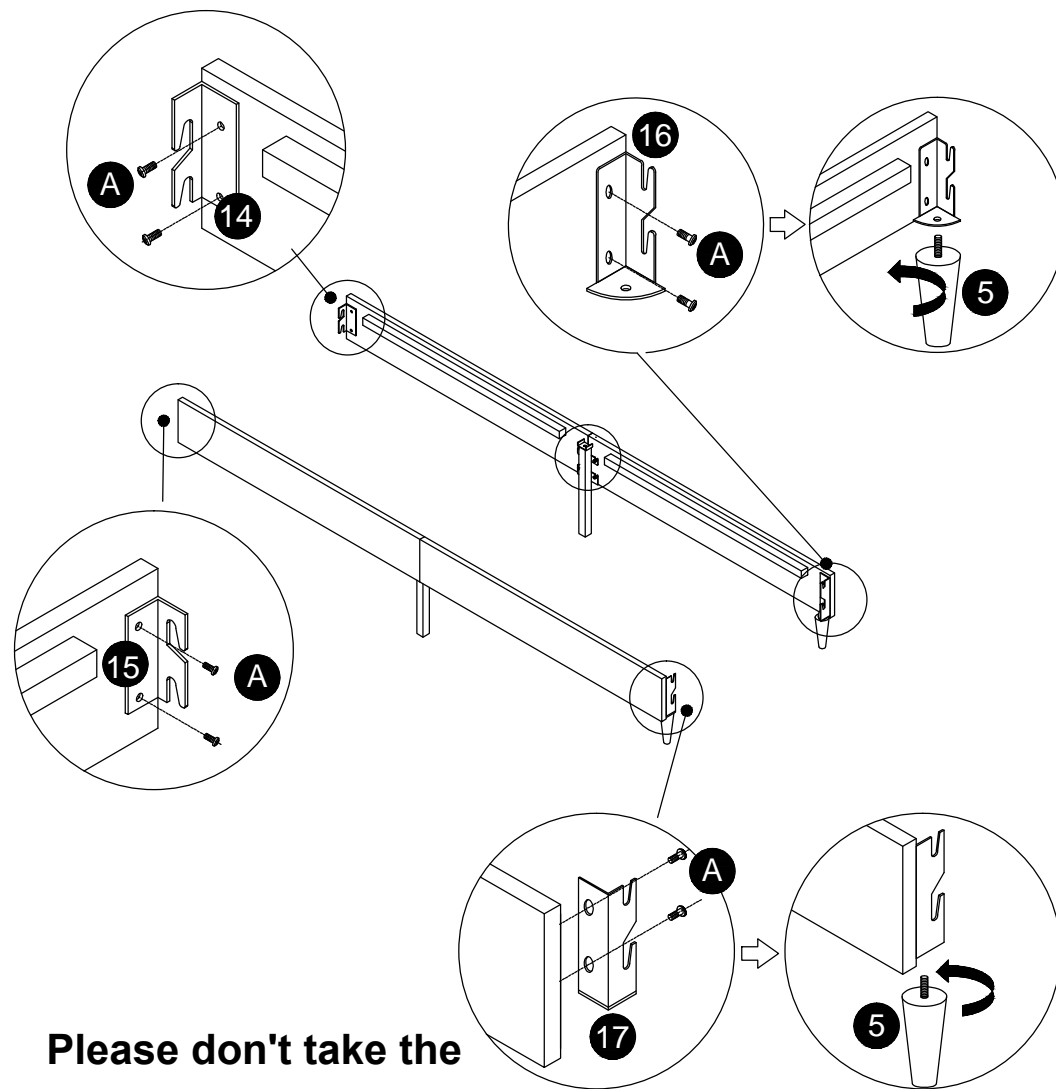

Please don't take the
wrong,

14 corresponds to 16
15 corresponds to 17

Assembly Instruction

Step:5

Pull the attachment (7)
out slightly so that the
bed side hook fits in

M8*20
B 2PCS

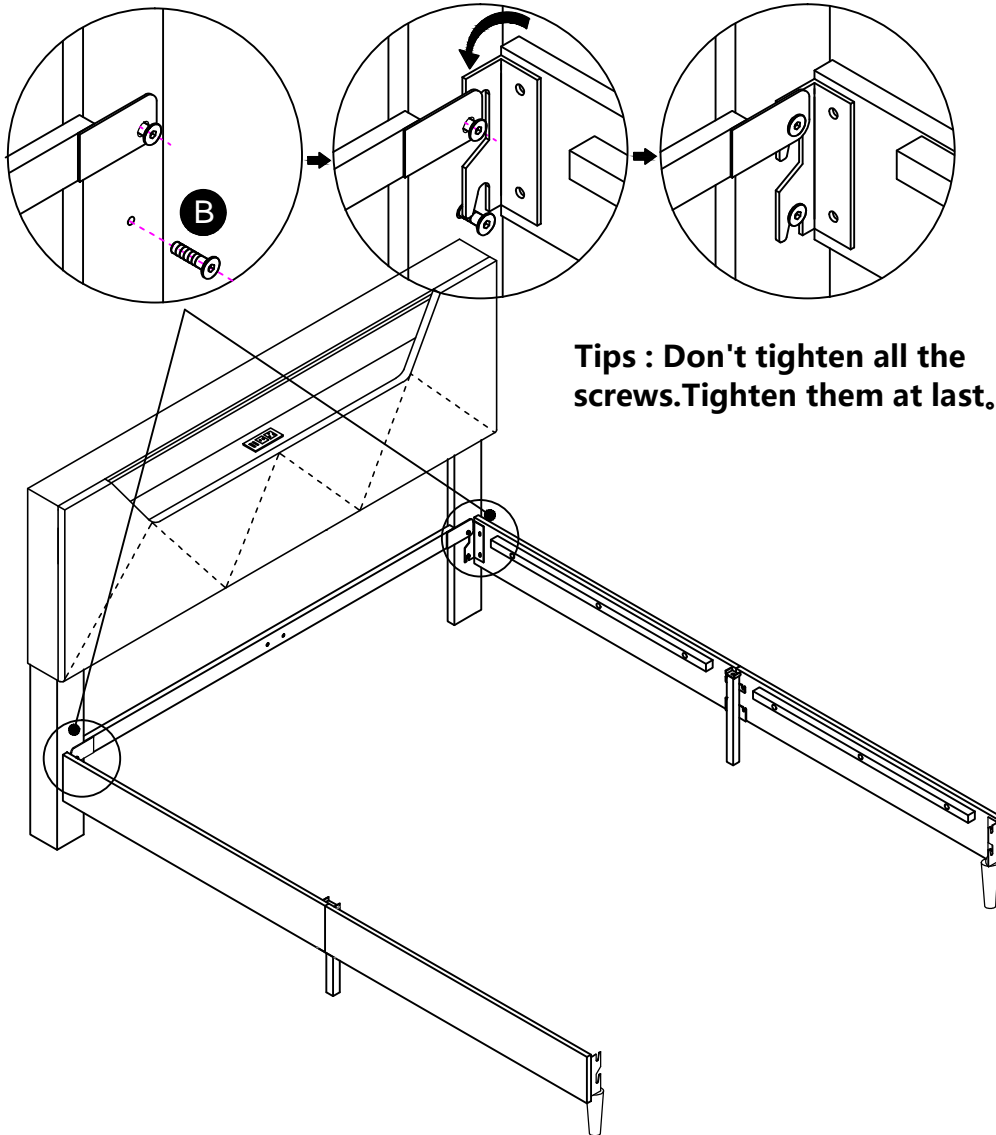

Step:6

M8*20
B 4PCS

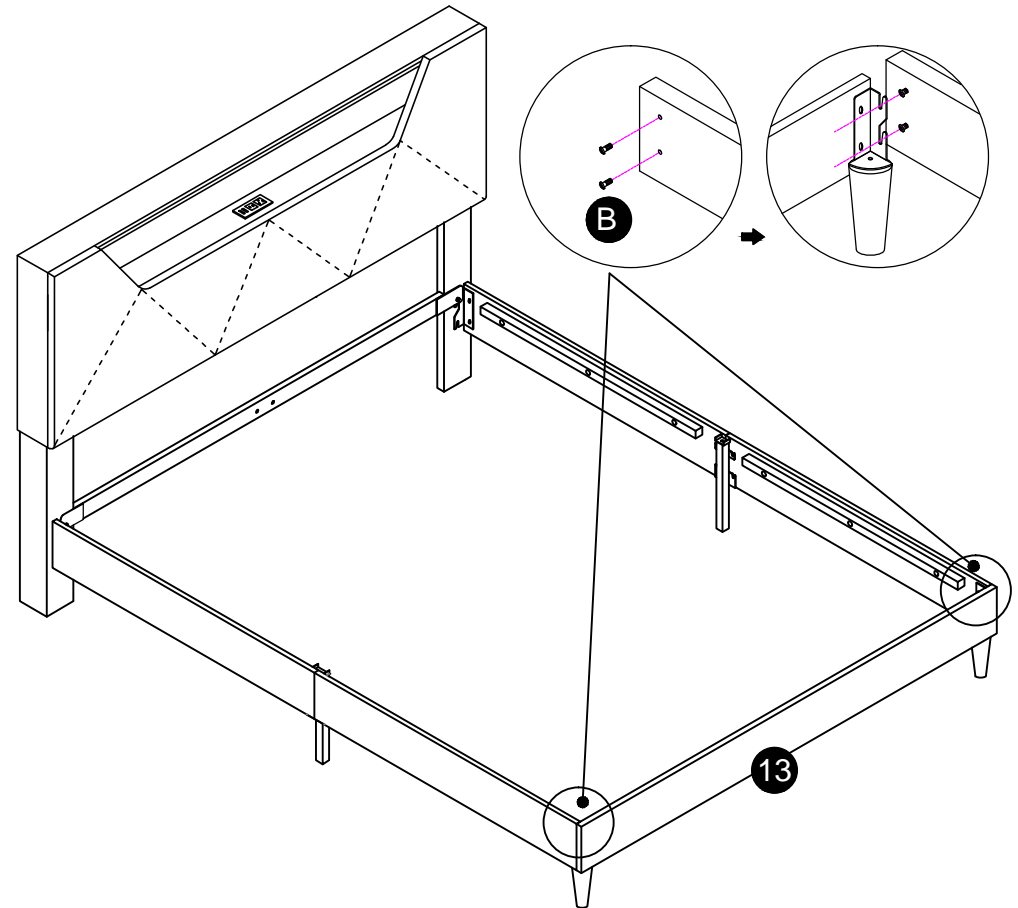

Assembly Instruction

Step:7

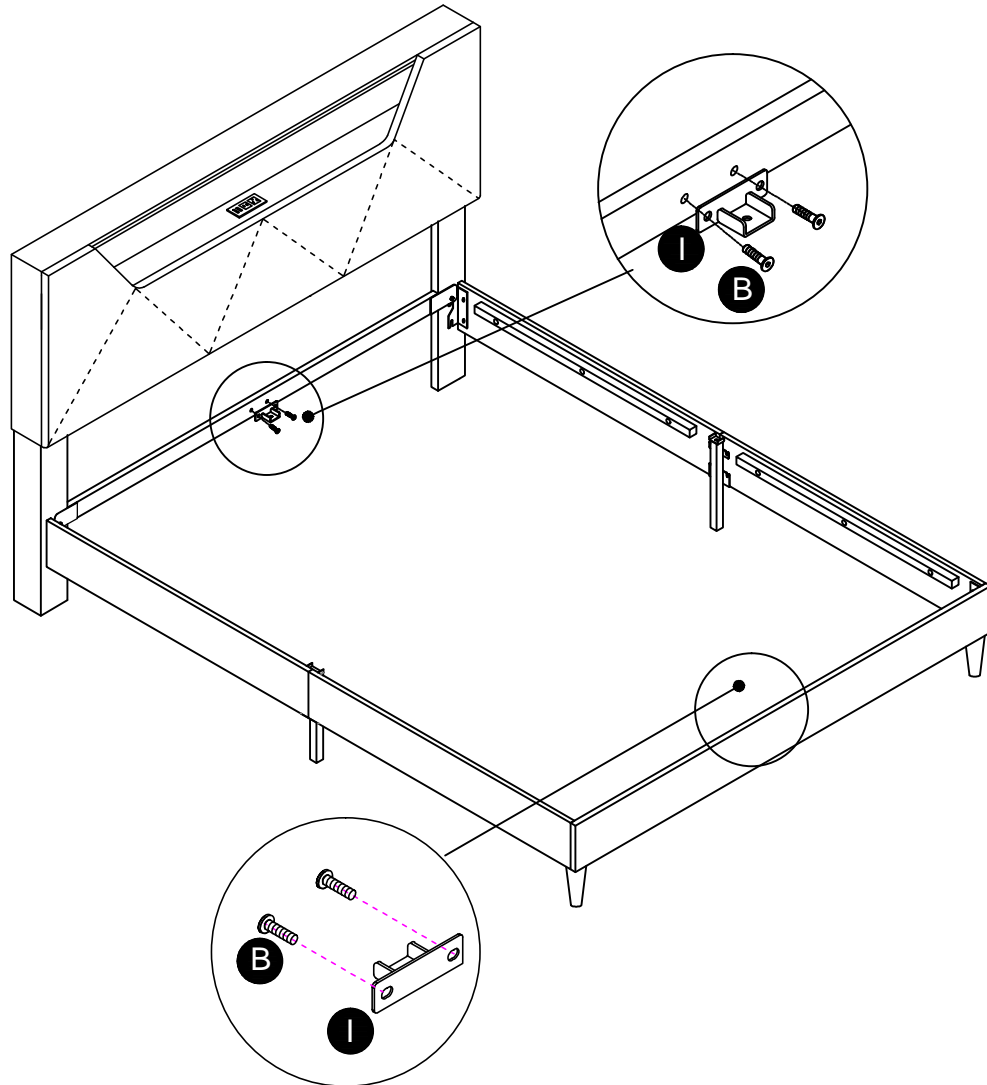

M8*20
B 4PCS

Step:8

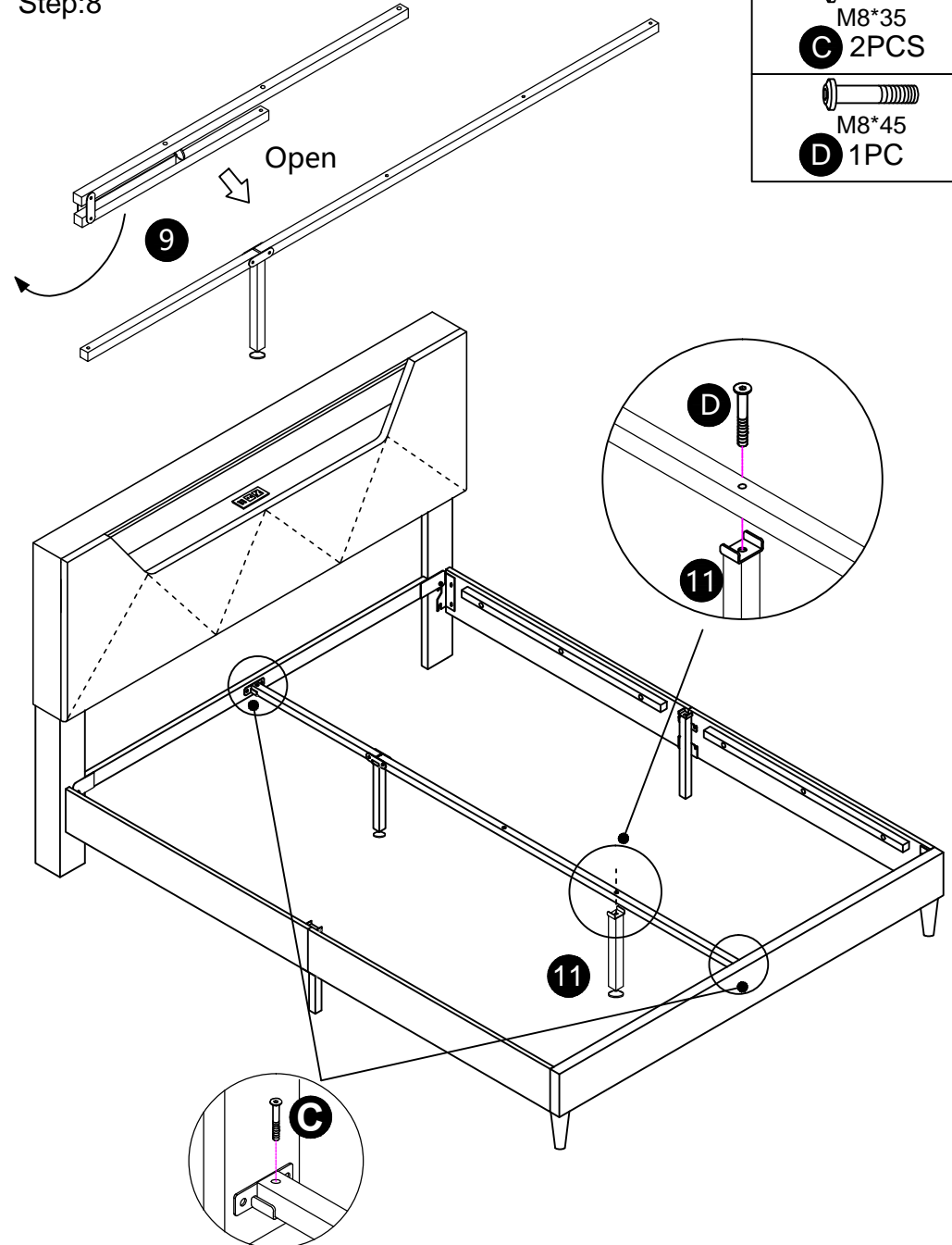

M8*35
C 2PCS

M8*45
D 1PC

Assembly Instruction

Step:9

M8*20
B 2PCS

M8*35
C 1PC

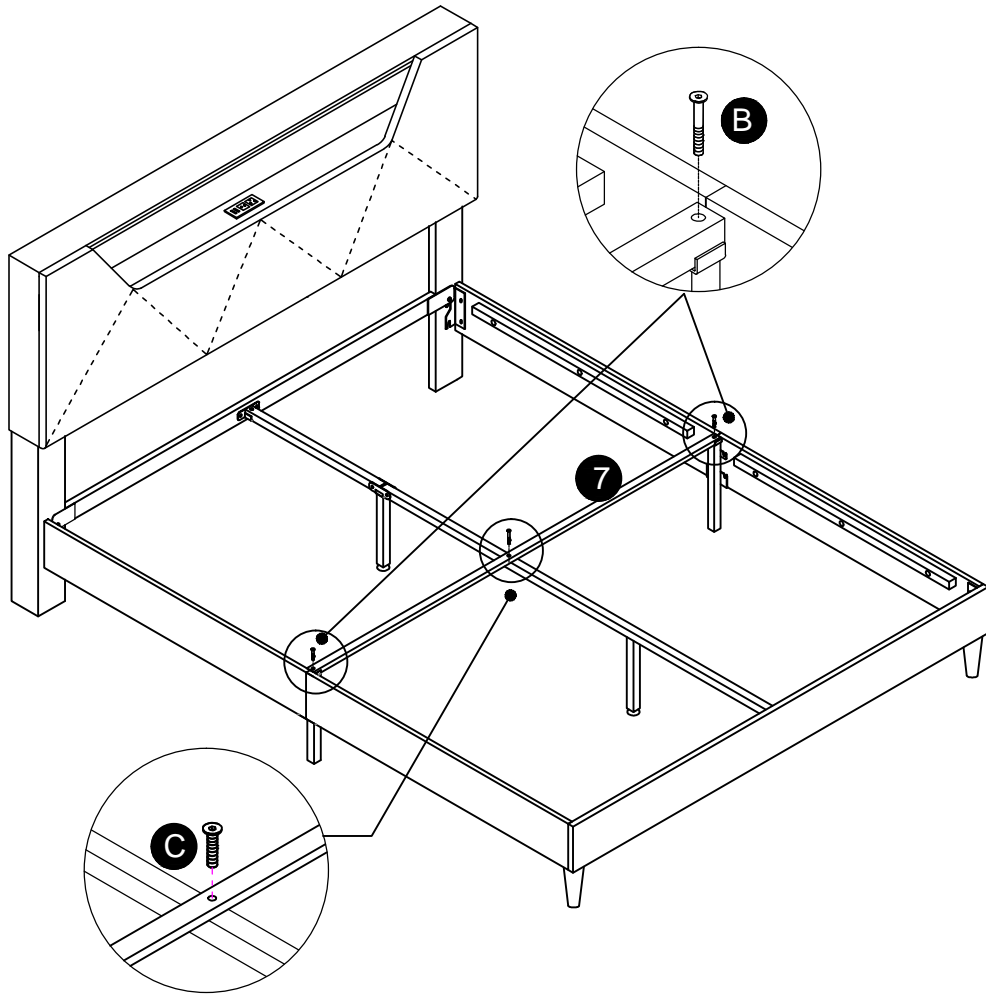

Tips : Here, all the screws of the whole bed must be tightened

Step:10

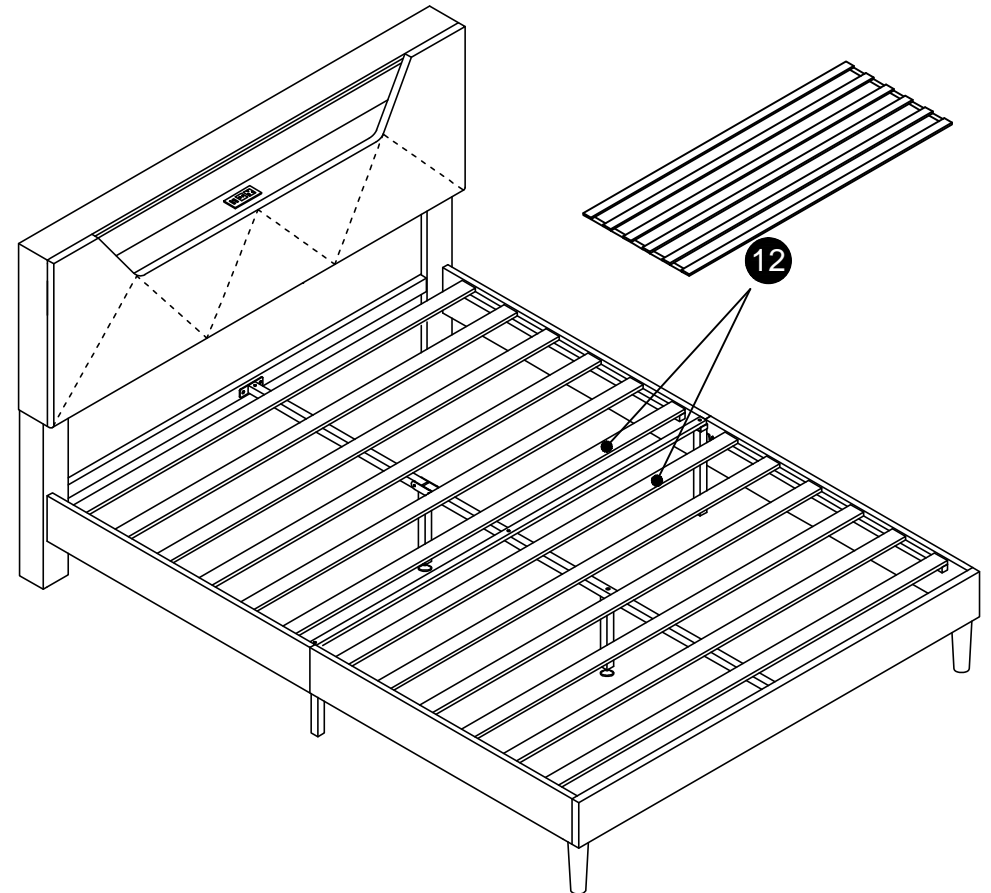

Additional instructions of LED light bar

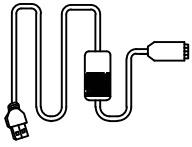

**1PC
Power cord**

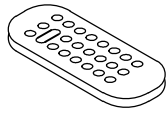

**1PC
Remote control**

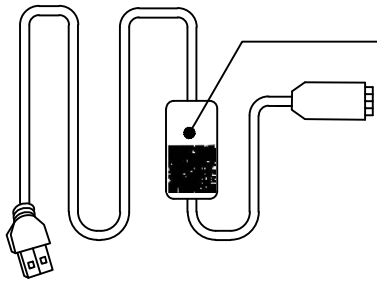

There is a
two-dimensional code
at the position of the
power line. Scanning
can download the APP
for the control light

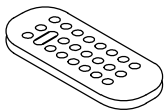

you can use
the remote
control to
control the
color

The LED lamp can only be used when it is powered on

There is a 4-pin
connector behind
this direction

If not, please pull
him out through
the hole from the
front

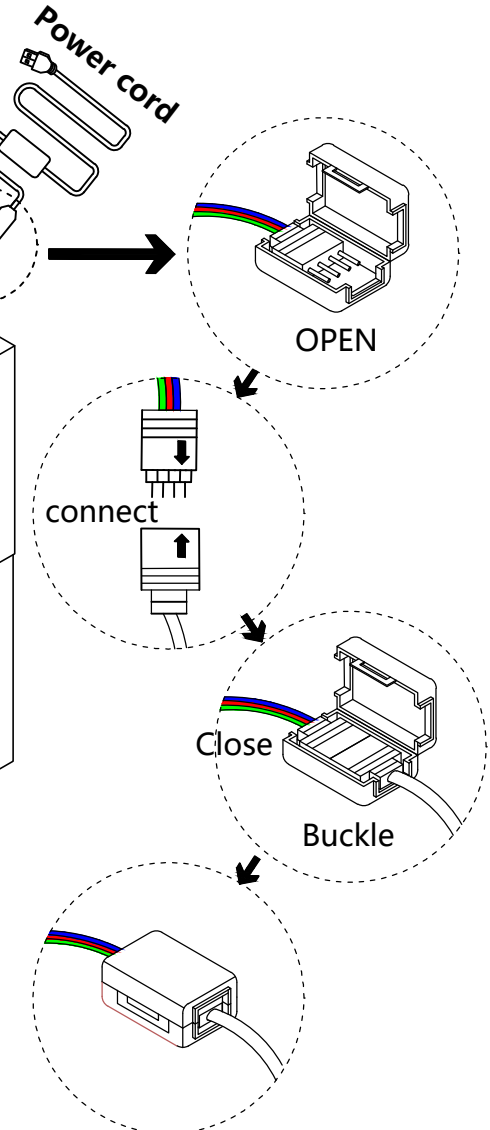

Additional instructions

If you feel that the height of the head of the bed is not enough,
please see the instructions on this page

When you open the package, you will also see the following
accessories, which are used to raise the
height of the head of the bed during the assembly process

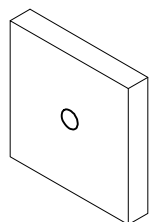

Wooden block

16 2PCS

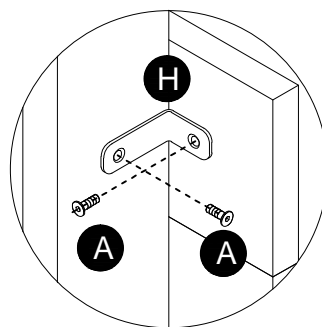
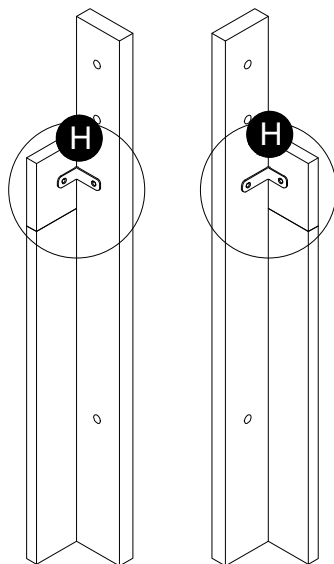
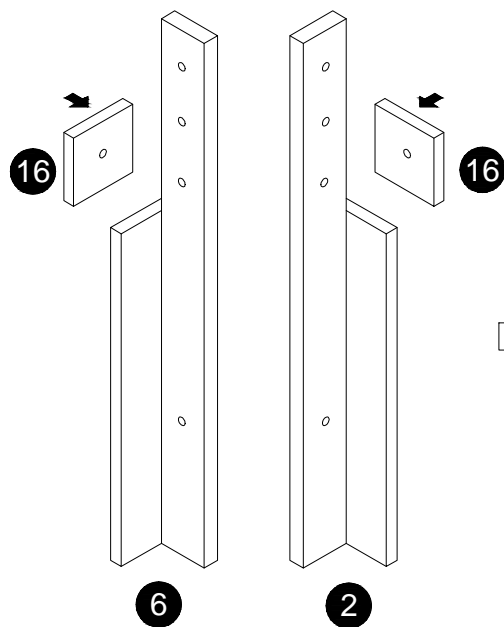

After assembling
according to this
page, the head of
the bed should
be placed as flat
as possible

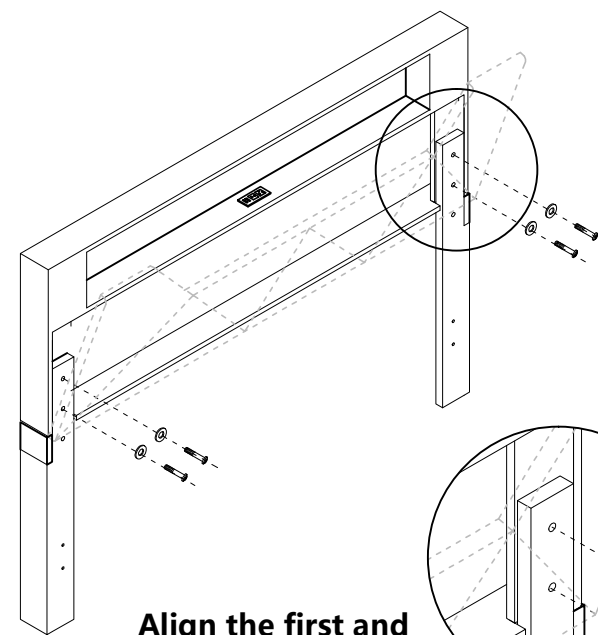
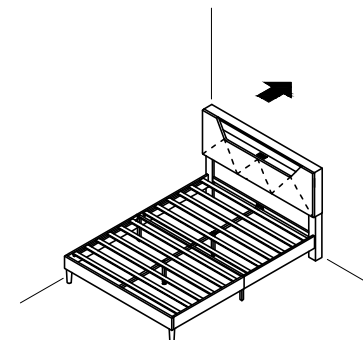

Align the first and
second holes from
the top down

