

Assembly guide

Prepare To Start

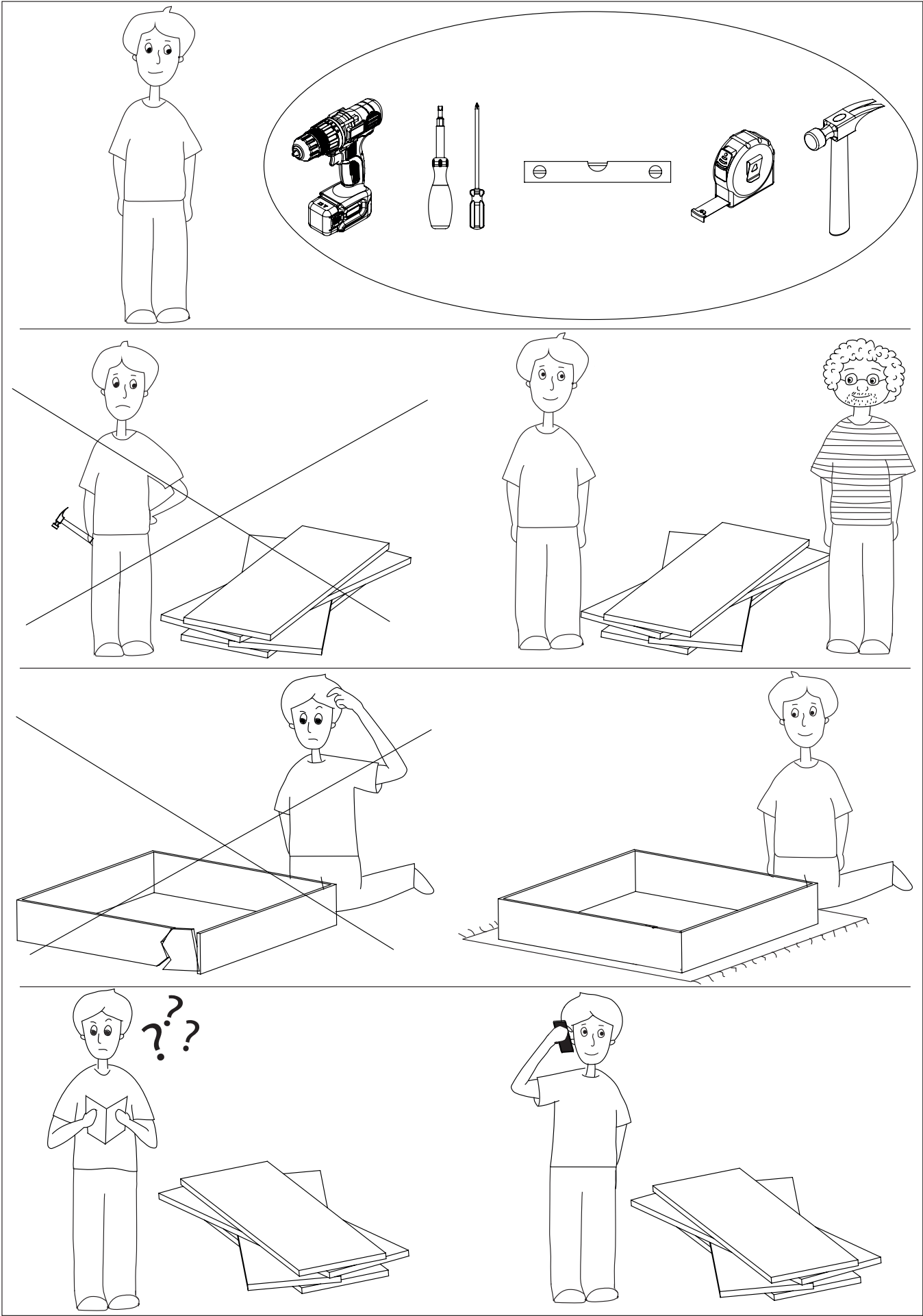

Components

Part1	1x
Part2	1x
Part3	1x
Part4	1x
Part5	1x
Part6	1x
Part7	2x
Part8	1x
Part9	1x
Part10	1x
Part11	1x
Total	12x

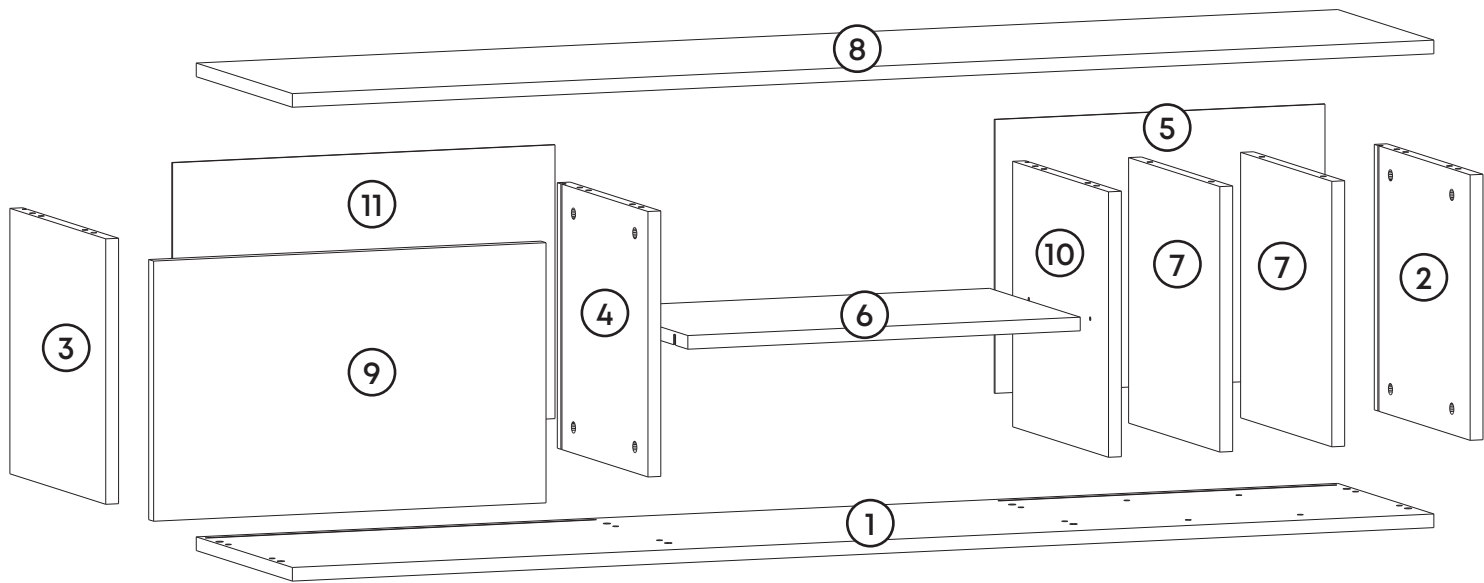

Accessory Parts

A01

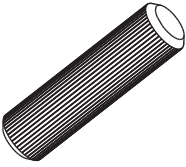

Dowel Q824x

A02

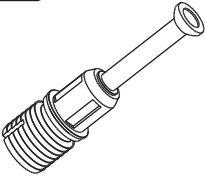

Screw16x

A03



Head16x

A04



Rafix Screw4x

A05



Rafix Head4x

A06



Pvc Sticker16x

A08



Nail16x

A09

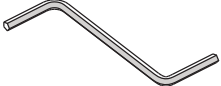

Allen1x

A15



Leg5x

A17



3,5 x 16 Screw44x

A28



Hinge Base2x

A33

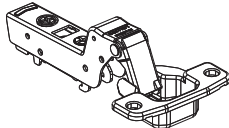

Full Hinge1x

A34

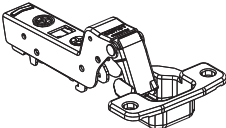

Full Hinge Brake1x

How to instal Components

*Before starting, please check the below figures

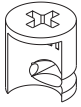

HEAD

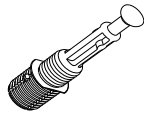

SCREW



DOWEL

If the dowel is not required during the installation phase, it is not included in the package.

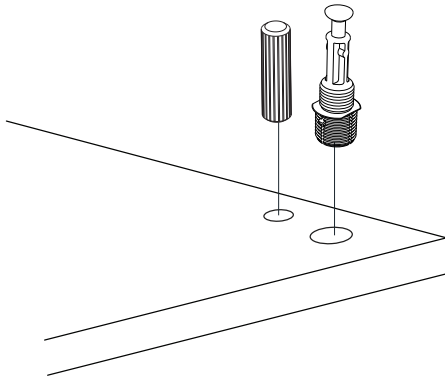

*Please notice that there is an small arrow on A03 (head). This arrow should show the direction of upper hole.

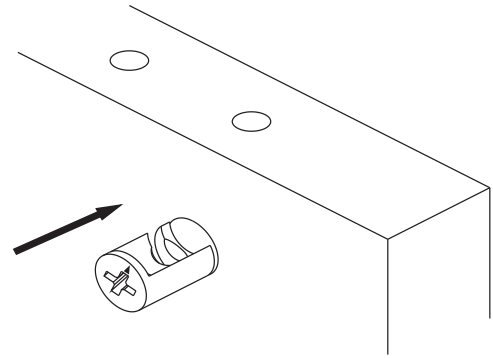

*After attaching two pieces please turn the A03 (head). clockwise direction with the help of a screwdriver.

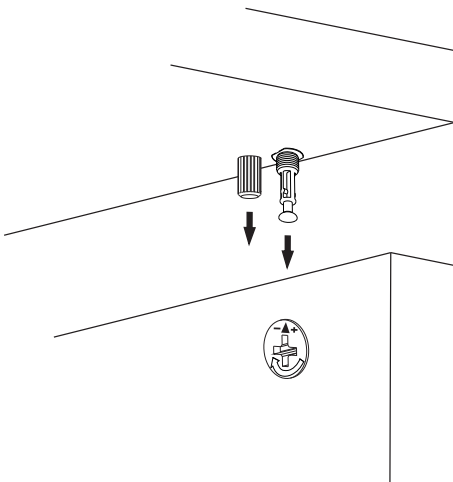

*Please do not over screw the minifix head since it may be broken if too much power is imposed. Just make sure that it is screwed to the direction “+” do not go any further.

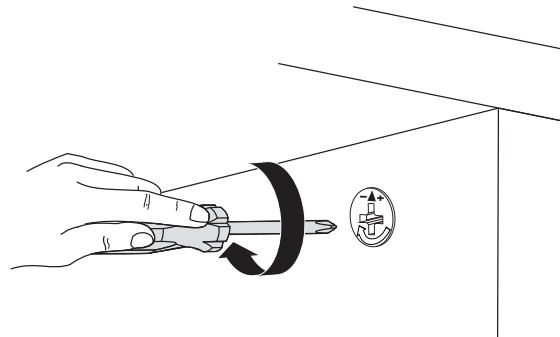

1.

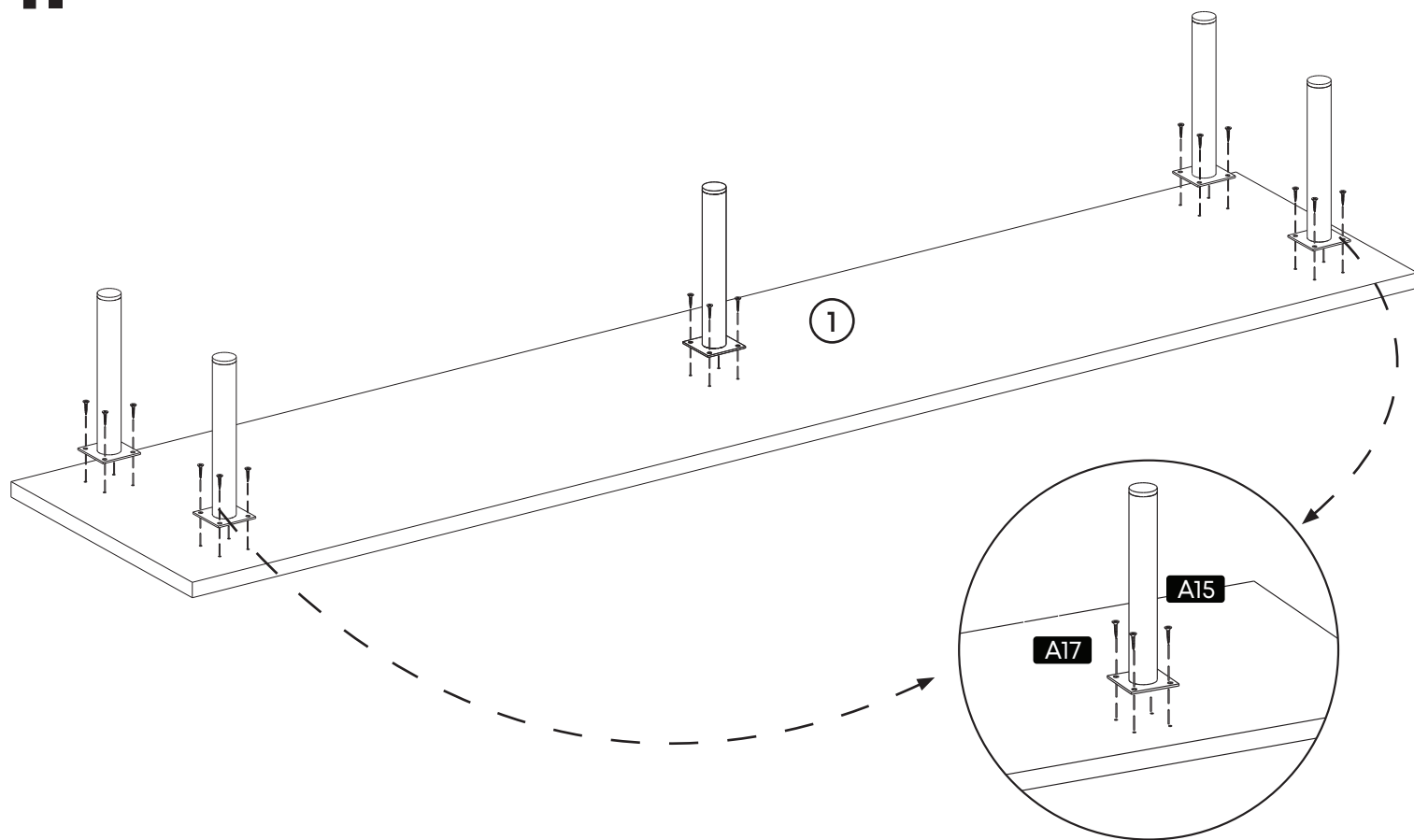

2.

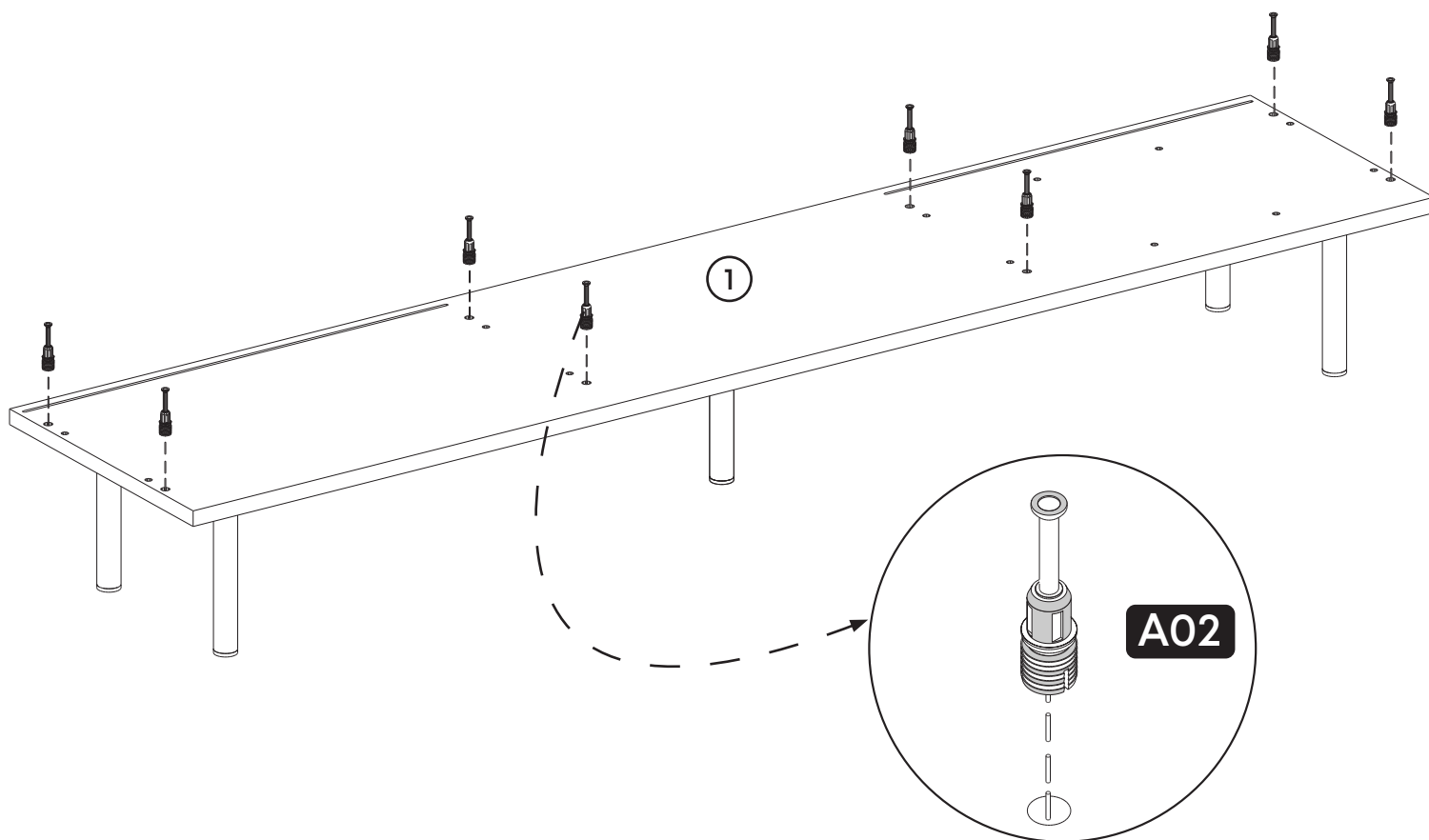

3.

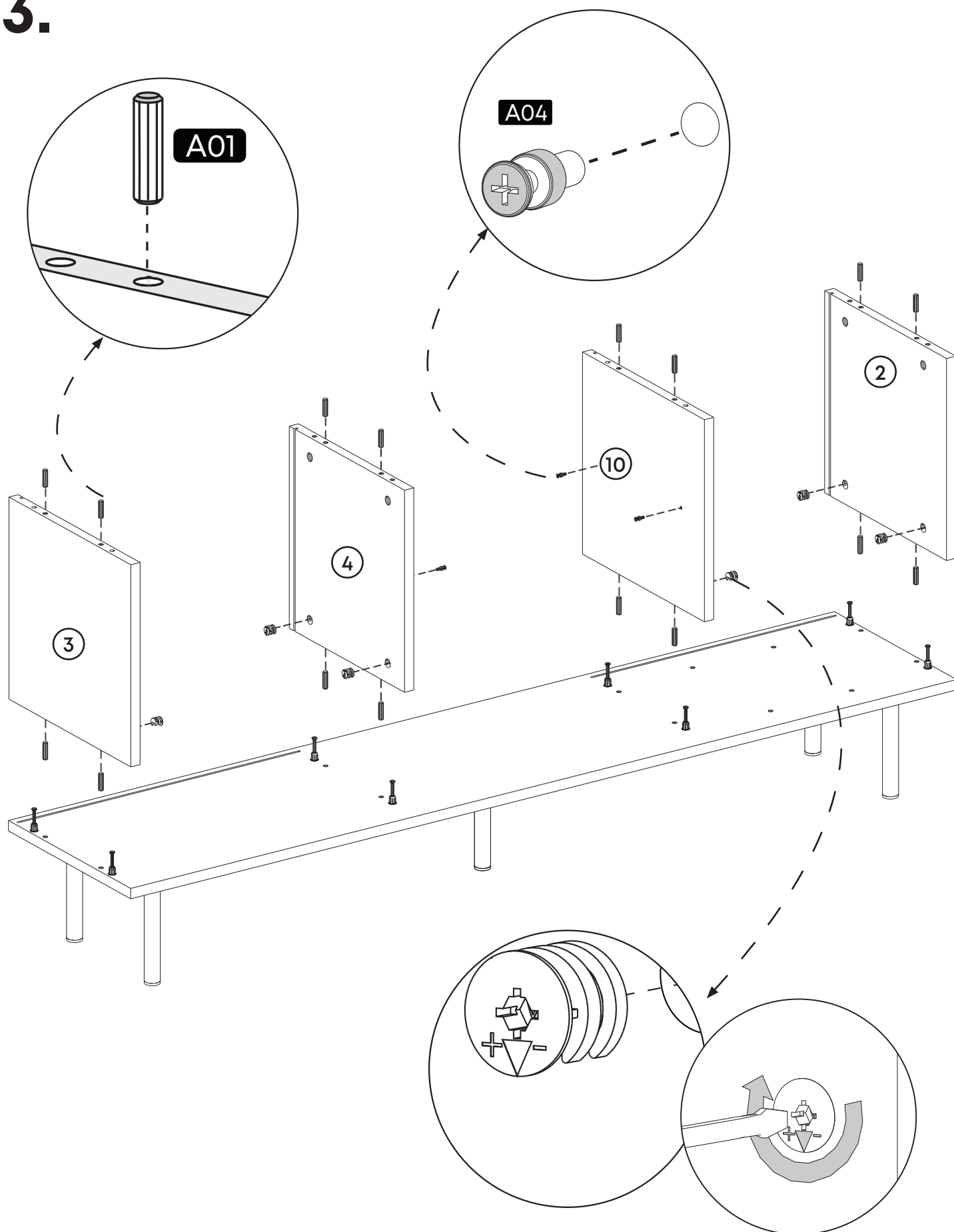

4.

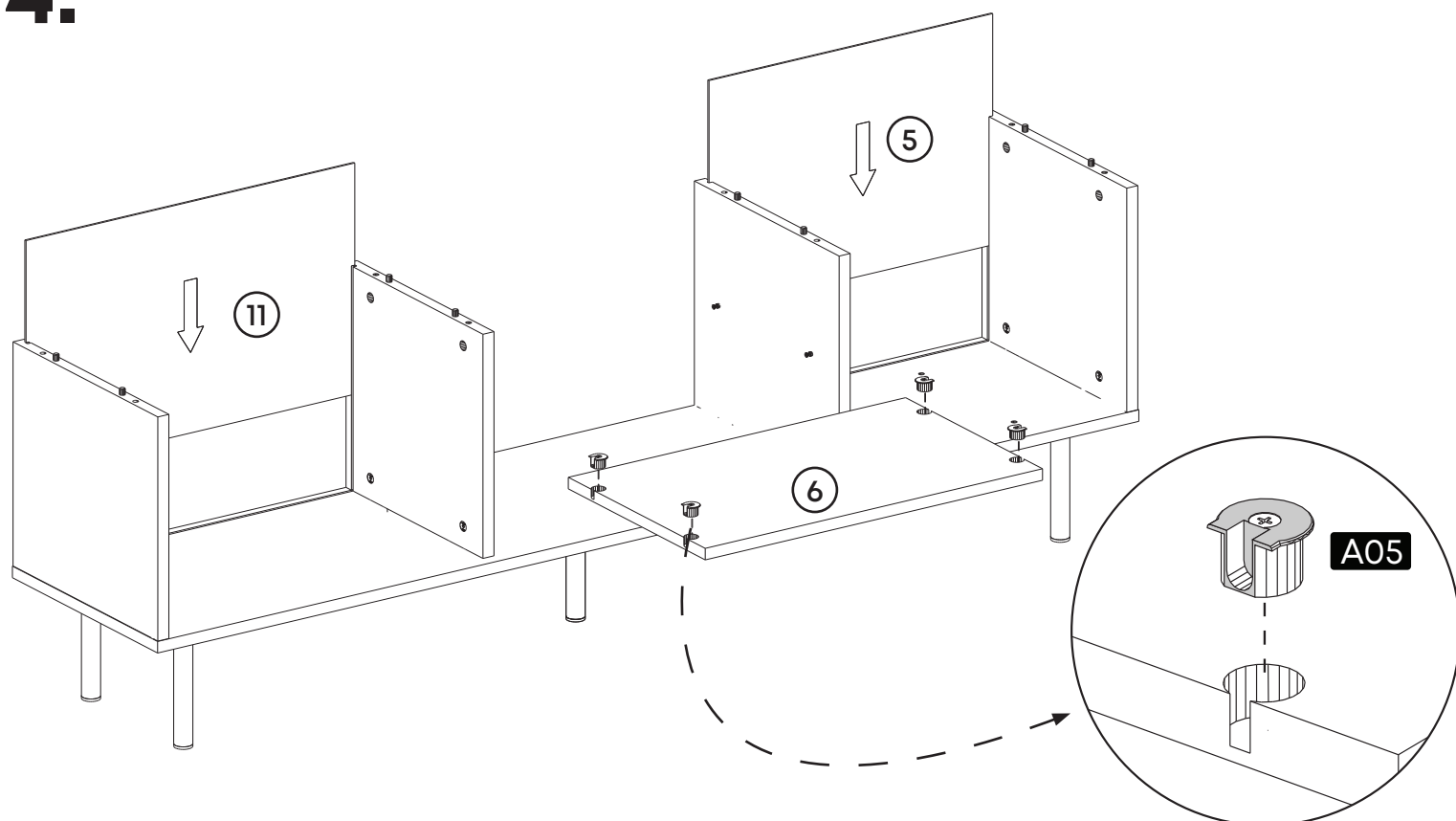

5.

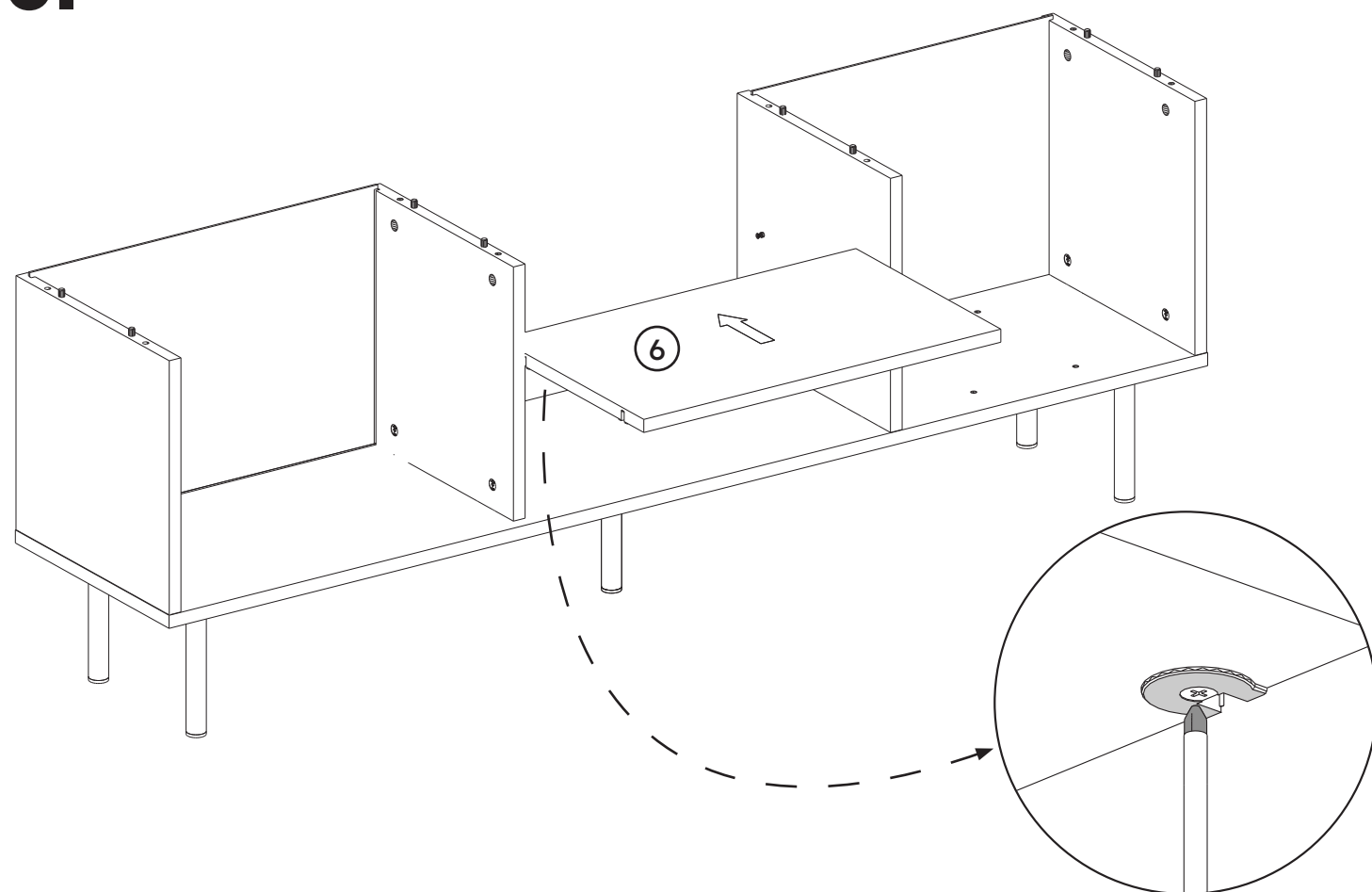

6.

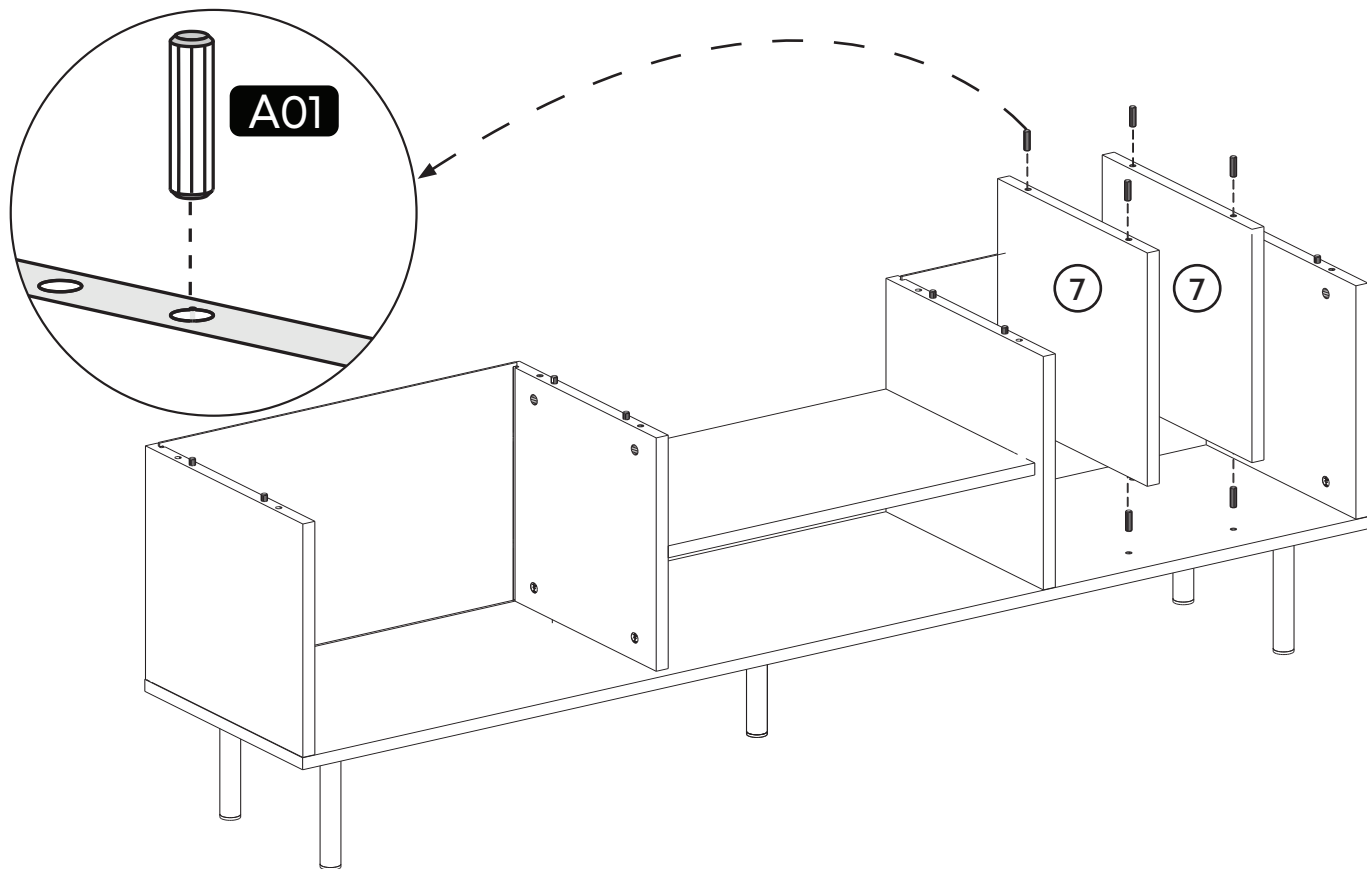

7.

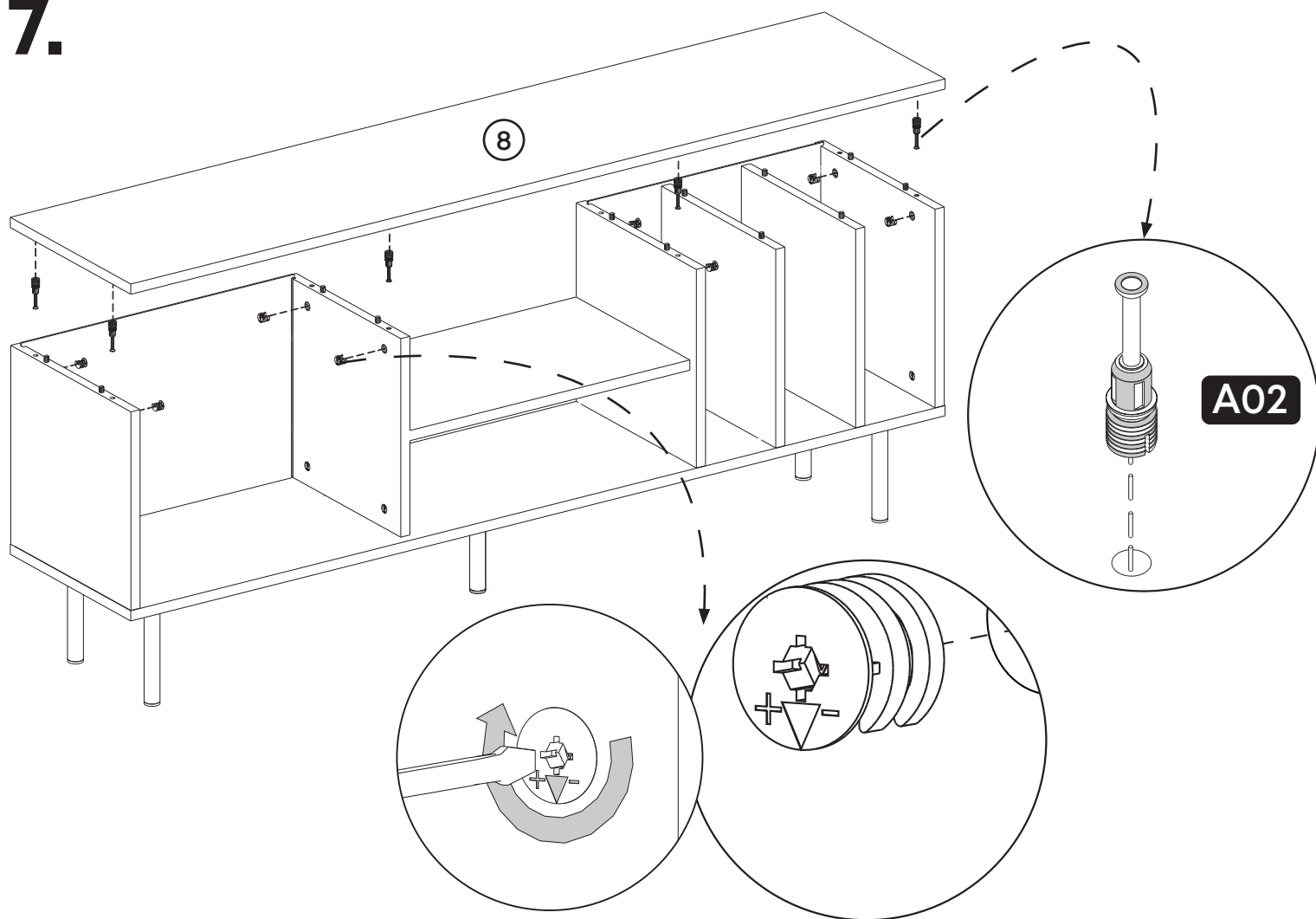

8.

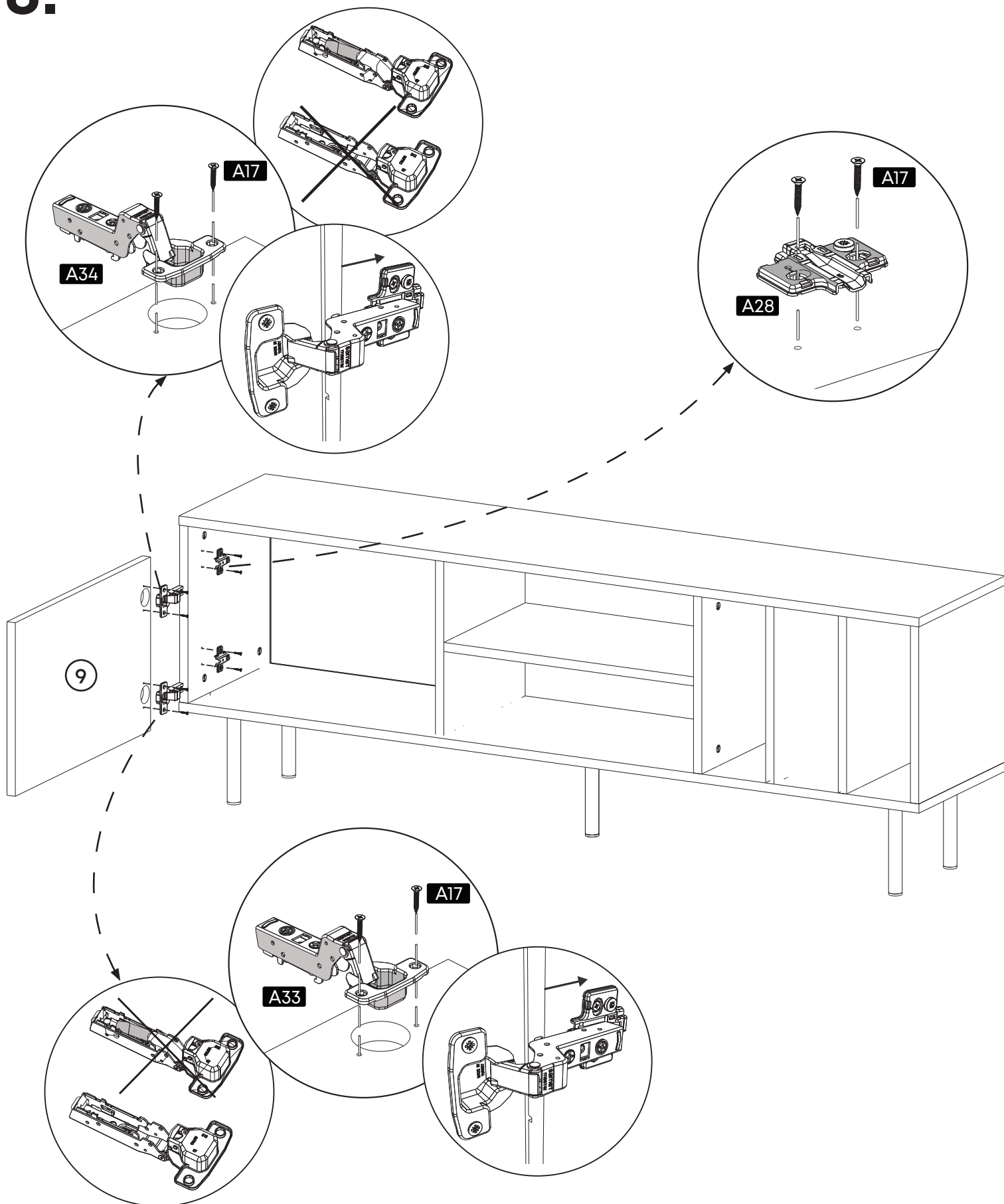

9.

Settings of Hinge

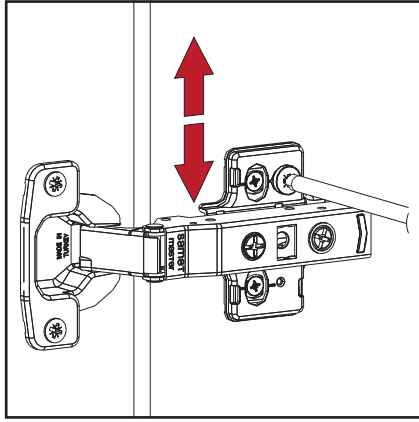

Settings of Hinge

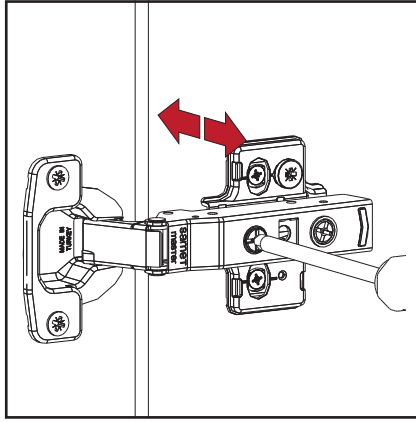

Settings of Hinge

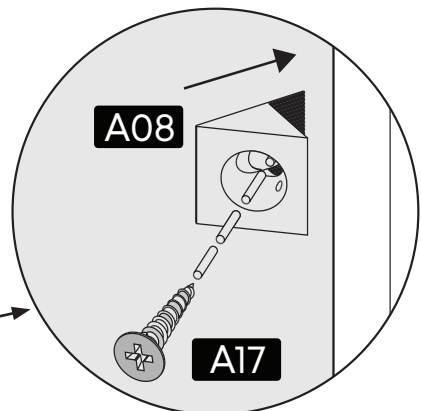
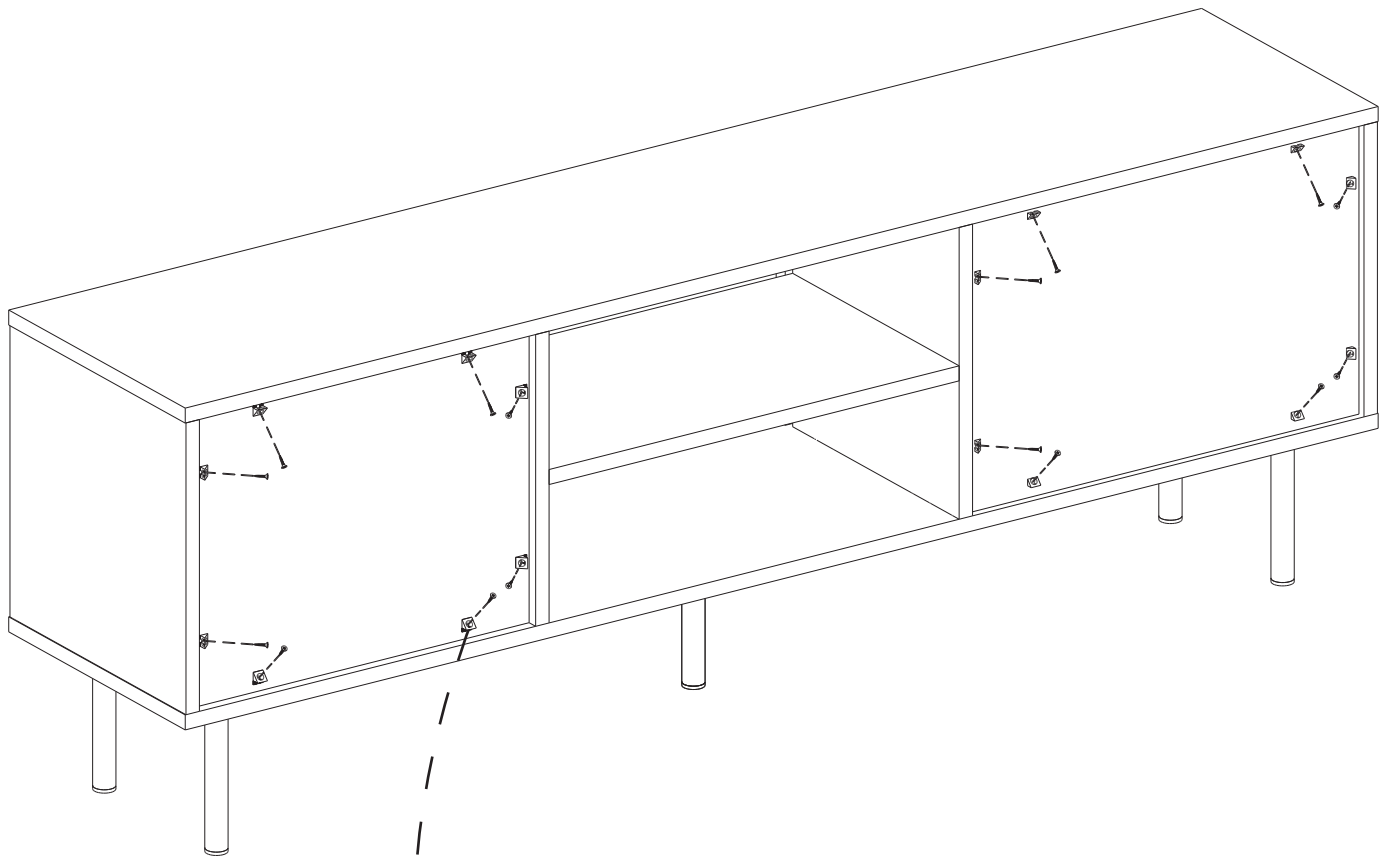
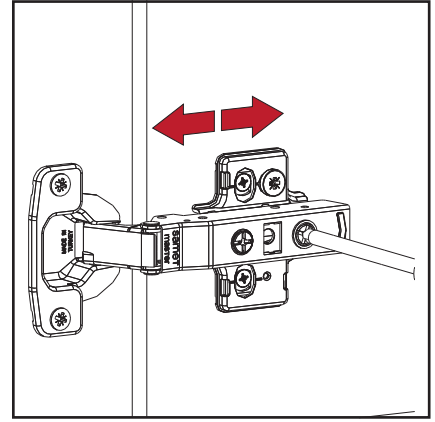

10.

