

Assembly Instructions

⚠ Before you throw the carton, please ensure that you have all the parts needed for the assembly.

⚠ **Hardware Note:**

1. For each step please don't fully tighten all the screws at first, when they all align to the holes you can fully tighten them.

2. All the bolts should be assembled **vertically** to the holes.

⚠ **Spare parts** can be found in the hardware box if you do not have enough bolts for assembly.



Bolts 6pcs

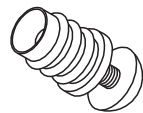

Foot caps 2pcs

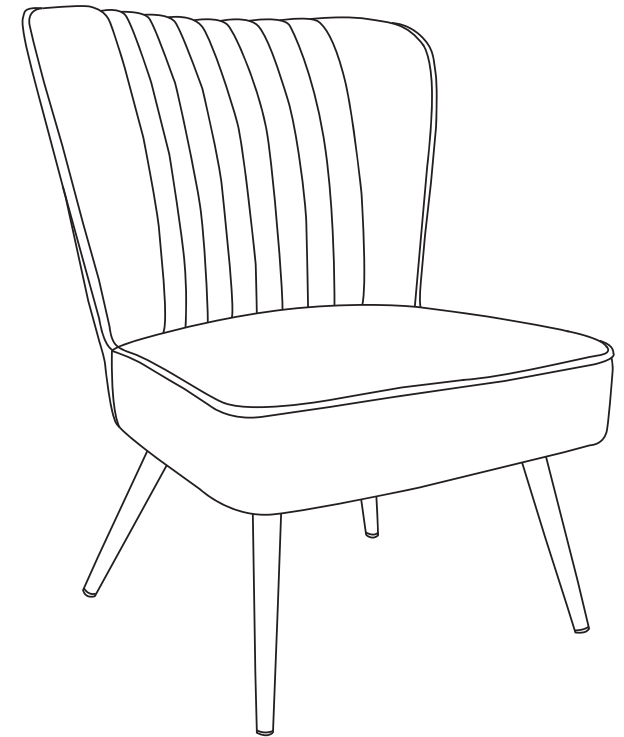

Assembly Instructions

Parts and Hardware

Please check to make sure you have all parts and hardware before starting assembly process

A

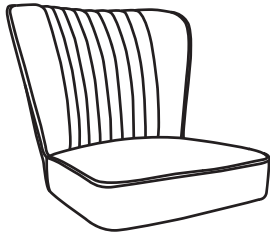

Seat 2pcs

B

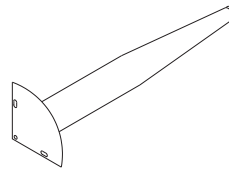

Legs 8pcs

①



Bolts 24pcs

②

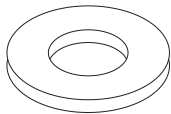

Flat washer 24pcs

③

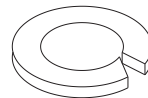

Spring washer 24pcs

④



Wrench 1pc

Assembly Instructions

Assembly Instructions

Step 1: Assemble legs to the bottom of chair using bolts, spring washers and flat washers. Half tighten the bolts one by one until all the bolts are align to the holes then fully tighten them by the short side of wrench.

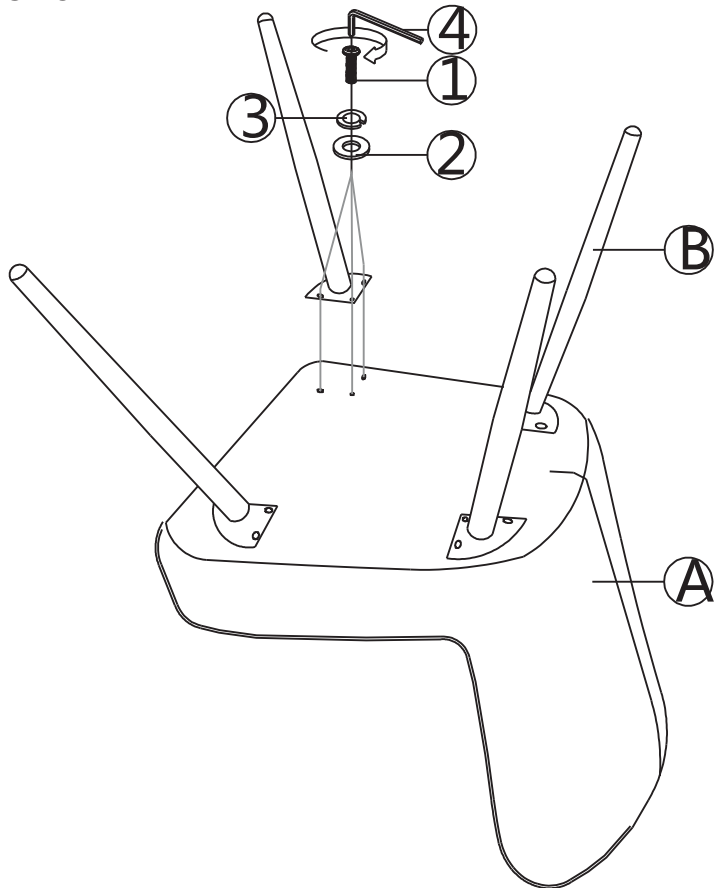

Step 2: If the chair is not steady, please adjust the foot caps under the legs.

