

Installation Guide

Tools Required

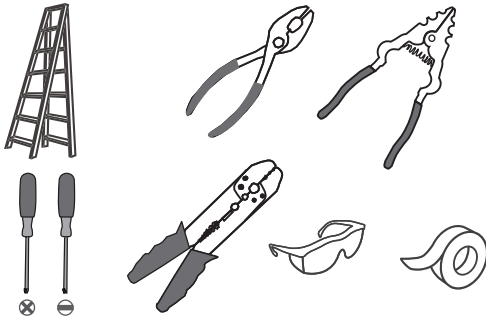

Light Source

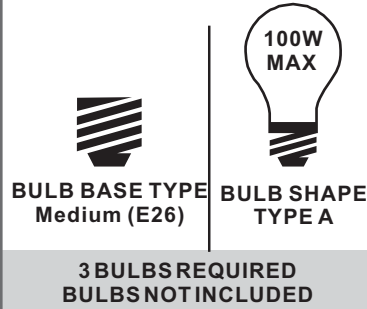

Fixture Height Adjustable 26.5" to 75.75"

⚠ Warnings and Cautions

Turn off the electricity at the circuit breaker before installation. Consult a licensed electrician if in doubt about installation.

Turn off power to the fixture and allow the bulbs to cool before replacing.

Package Contents

Preparation: Identify and inspect all parts before beginning the installation.

Missing or damaged parts? Contact your original place of purchase.

PARTS BAG

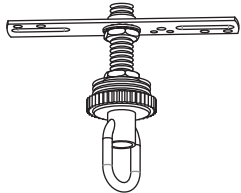

A Crossbar Assembly
x 1



B Outlet Box Screw
x 2



C Wire Connector
x 3

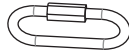

D Quick Link
x 2



E Fixture Chain
x 1

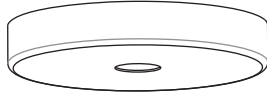

F Ceiling Canopy
x 1



G Fixture Loop
x 1



H Rod
x 2



I Center Column
x 1

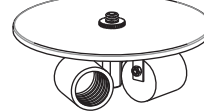

J Socket Assembly
x 1



K Stem with
Hex Nuts



L Hex Nut
x 1



M Flat Washer
x 2



N Rubber Washer
x 2



O Shade
x 1



P Shade Holder
x 1



Q Cap
x 1



R Check Ring
x 1



S Finial
x 1

Table of Contents

Socket Assembly, Rods & Fixture Loop

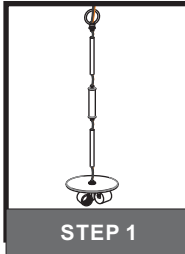

STEP 1

Crossbar Assembly

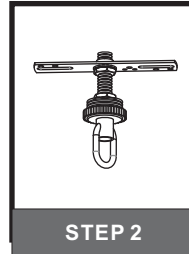

STEP 2

Fixture Chain

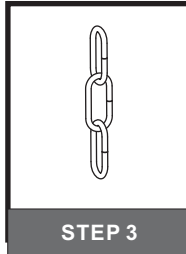

STEP 3

Wiring

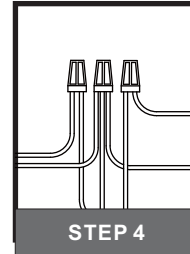

STEP 4

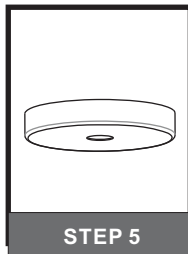

STEP 5

Ceiling Canopy

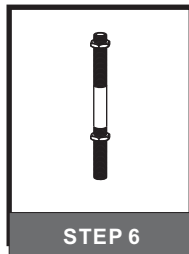

STEP 6

Stem & Hex Nuts

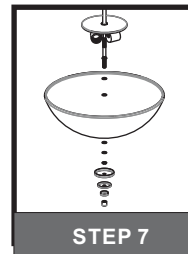

STEP 7

Shade & Cap

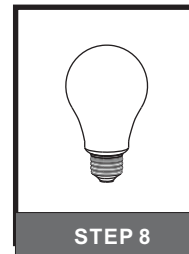

STEP 8

Bulbs

STEP 1

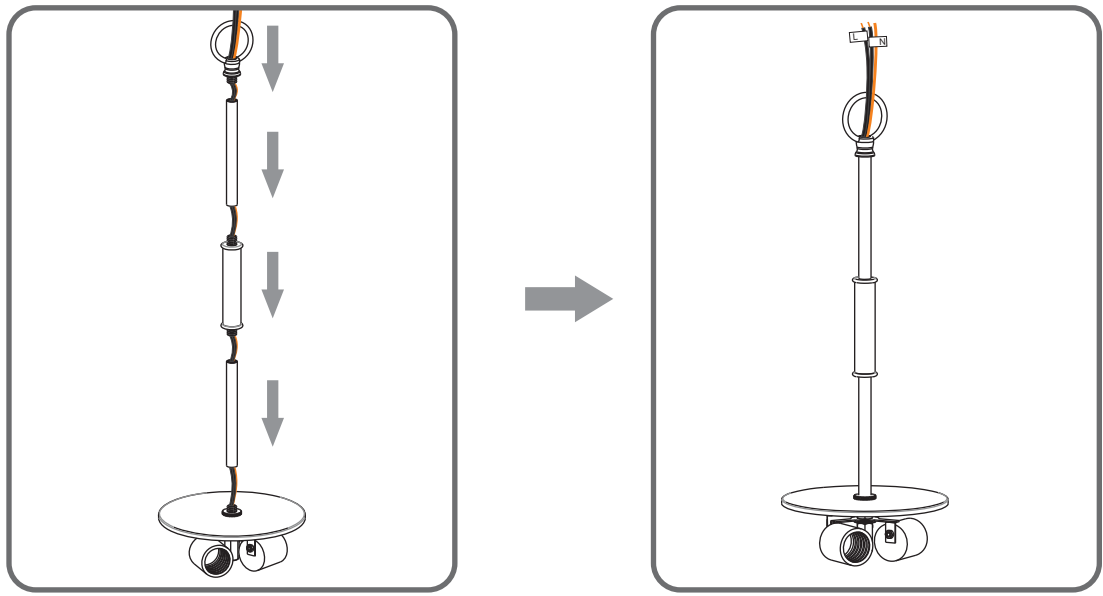

STEP 2

- 1 ----- 2 ----- 3

Step 1
Install crossbar assembly

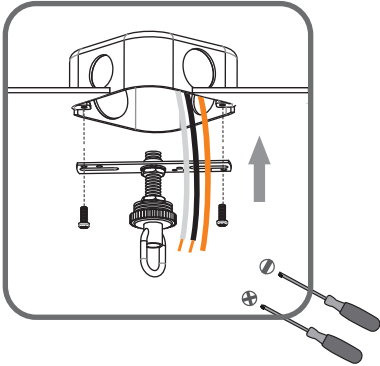

Step 2 - 3
Test fitting ceiling canopy to nipple

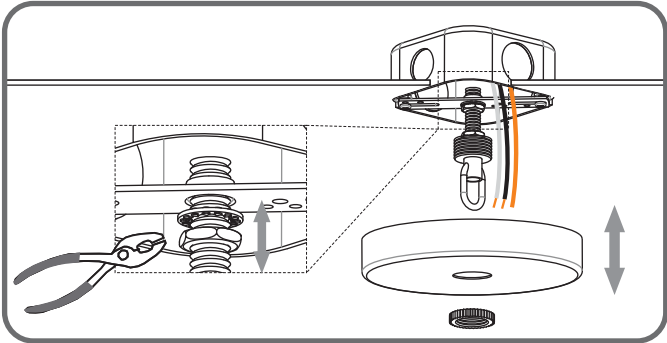
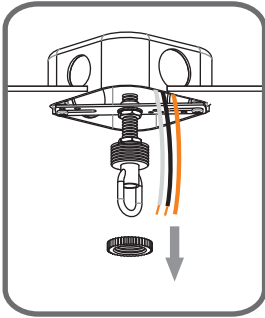

STEP 3

1

Step 1
Adjust fixture chain length

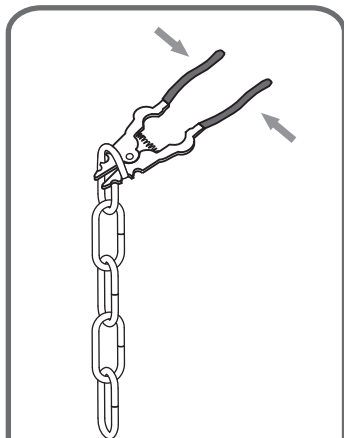

Suggested Chain Length:

8' ceiling: 9.5" Chain
9' ceiling: 20.5" Chain
10' ceiling: 31.5" Chain

2

Step 2 - 3
Install Fixture Chain

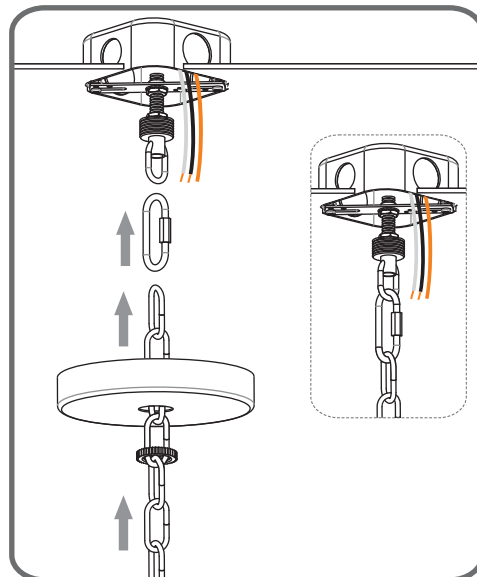
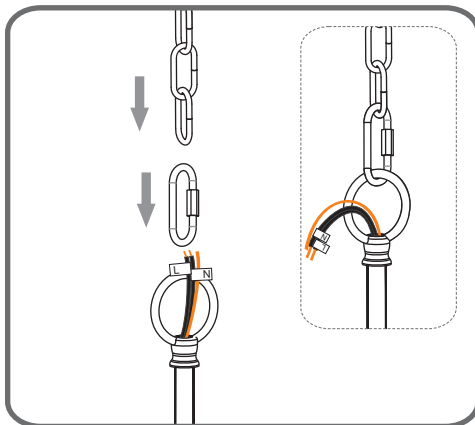

STEP 4

1

Step 1
Feed the fixture wires
through the loop

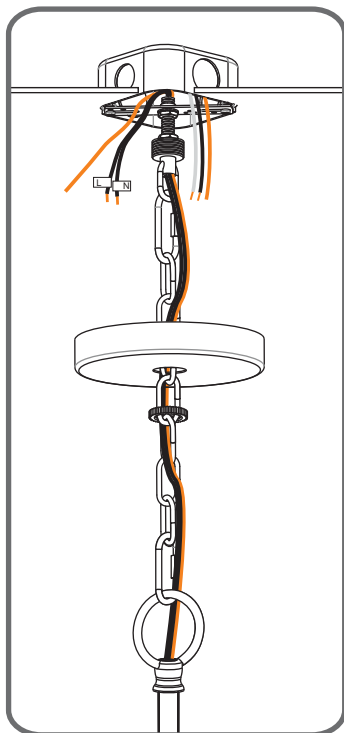

2

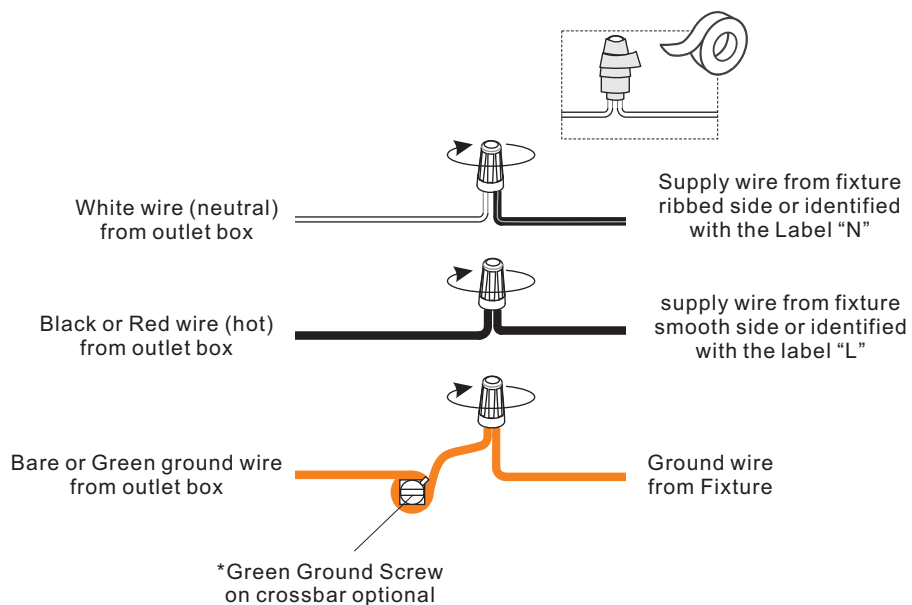

STEP 5

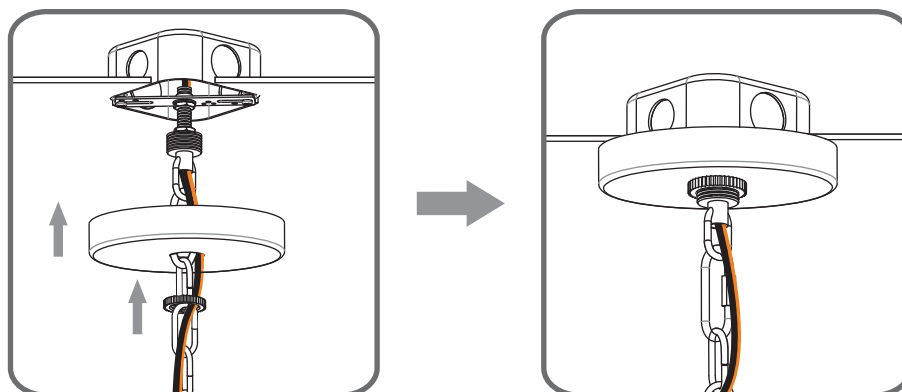

STEP 6

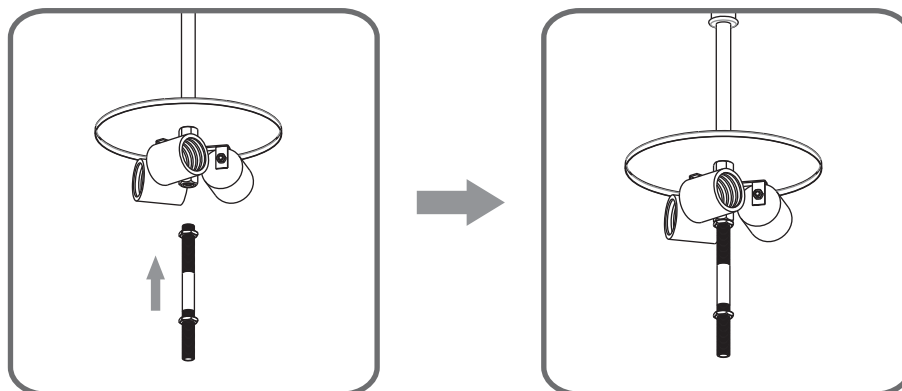

STEP 7

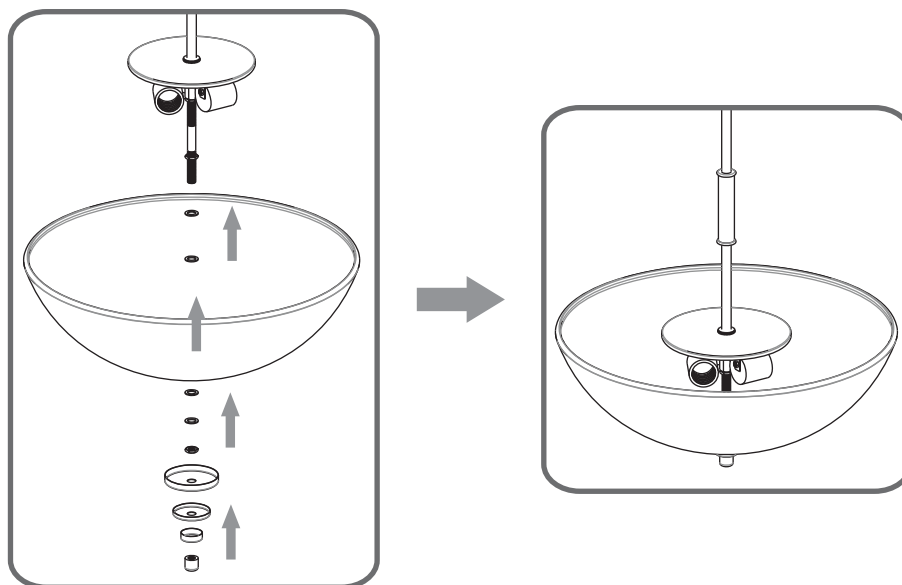

STEP 8

