

Assembly Instructions for **Model 1274717**



STEP 1

Remove the center column cover.



STEP 2

The main line is inserted into the threaded tube.



STEP 3

Assemble the lamp arm and center column, and tighten the nuts to secure.



STEP 4

Connect the arm wire to the main wire, connecting wires of the same color together.

Wrap with black tape.

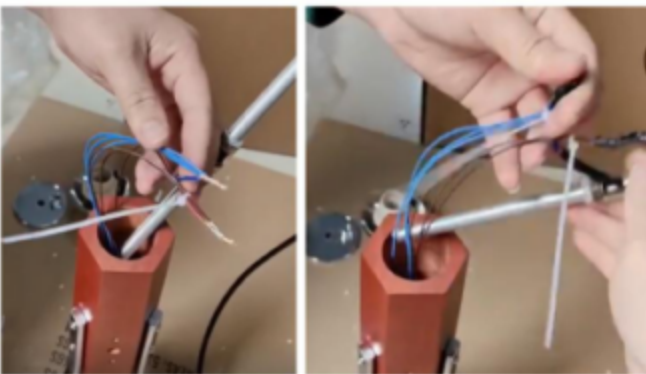

STEP 5

Arrange the lamp arm line.



STEP 6

Install the center column cover and tighten the nut to secure it.



STEP 7

Install the light pole. Pass the light pole through the main line.

Install the base and secure it.



STEP 8

Remove the mounting bracket from the ceiling canopy.

Mark the drilling position on ceiling with the help of the mounting bracket.

Drill holes on the marks and stick the expansion anchors into the holes.

Mount the mounting bracket on the ceiling.



STEP 9

Hold the fixture close to ceiling.

Connect the wires of the lamp body to the reserved wires at home.

There is no need to distinguish between positive and negative poles when wiring.

STEP 10

Install the ceiling canopy to the mounting bracket on the ceiling and fix it with screws.

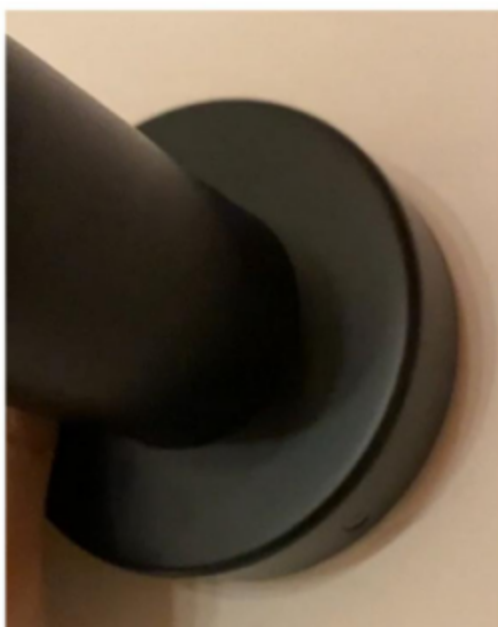

Your fixture is now assembled and ready to use.

Video link:

https://v.youku.com/v_show/id_XNjQ2NTEwNTU0NA==.html?spm=a2hcb.profile.app.5~5!2~5~5!3~5!2~5~5~A&playMode=puv