

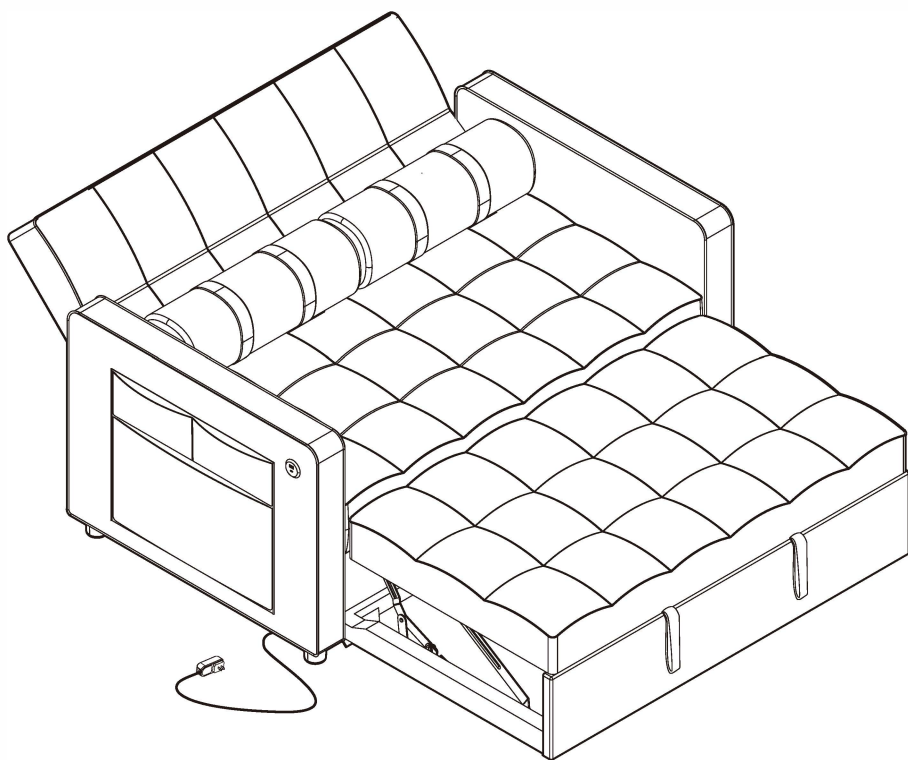

IMPORTANT!

Product ships in
TWO PACKAGES.
PACKAGES may
arrive separately.



Important Safety Information

- Please carefully read all instructions before attempting installation. If you do not understand the instructions or have any questions or concerns, please call technical support or email customer service.
- Before starting assembly, verify all parts are included and undamaged. Do not use damaged or defective parts. If you require replacement parts, please call technical support or email customer service.
- This product contains small parts that may pose a choking hazard.
- Do not use this product for any purpose that is not explicitly specified in this manual. We are not liable for damage or injury caused by improper mounting, incorrect assembly, or inappropriate use.

Care and Maintenance

- Use a vacuum cleaner to remove any loose debris.
- Clean using mild detergent with a damp cloth.

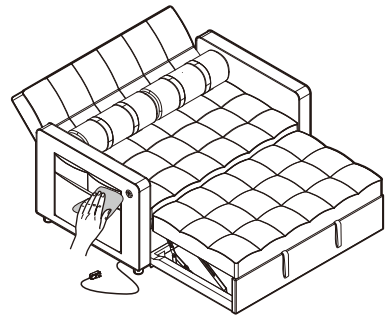

Installation Tips

- Make sure you have enough space to lay the parts out before assembling.
- To avoid scratches, assemble this product on unfolded cardboard or a soft surface.
- It is recommended that at least two people install this product together.



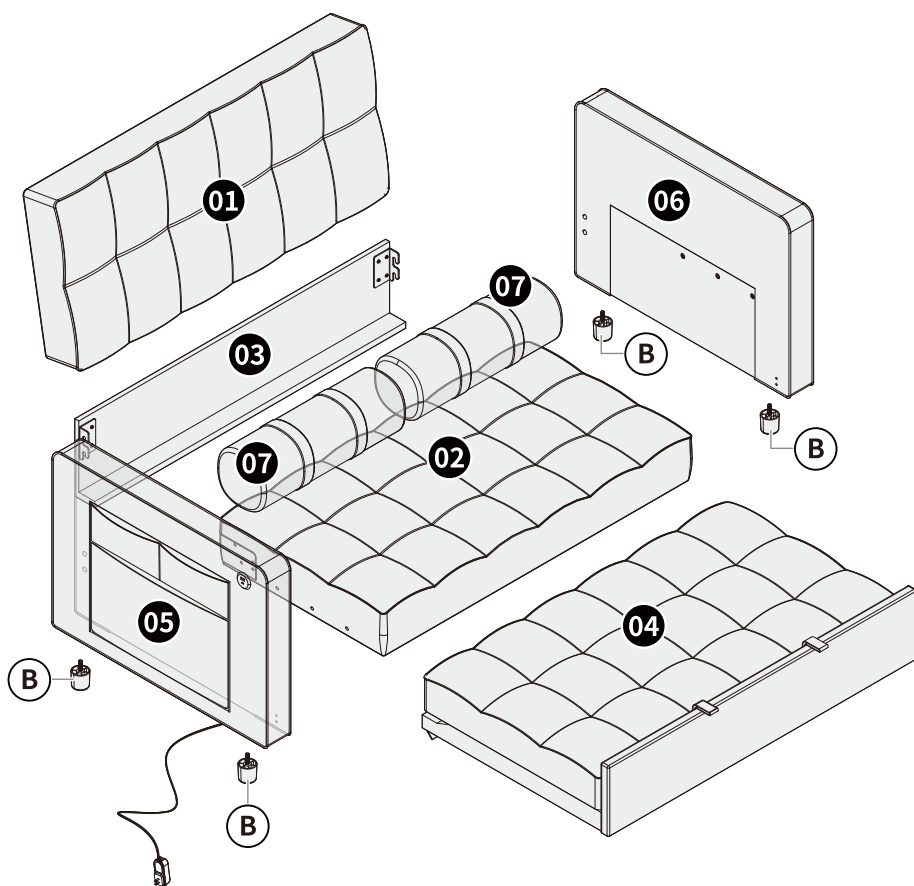

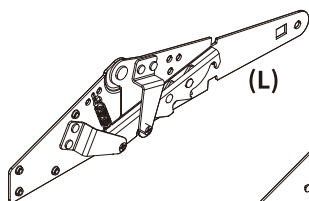
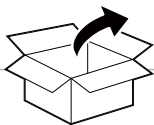

(L)

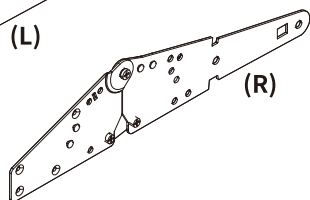

(R)

(A) x 1



(B) x 4



(C) x 2



Ø6 x 35mm

(D) x 8



Ø5 x 35mm

(E) x 8



Ø8 x 60mm

(F) x 6



D5/D6

(G) x 8



D8

(H) x 6

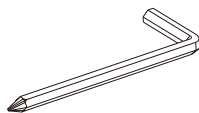

3/16" (5mm)

(I) x 1

1

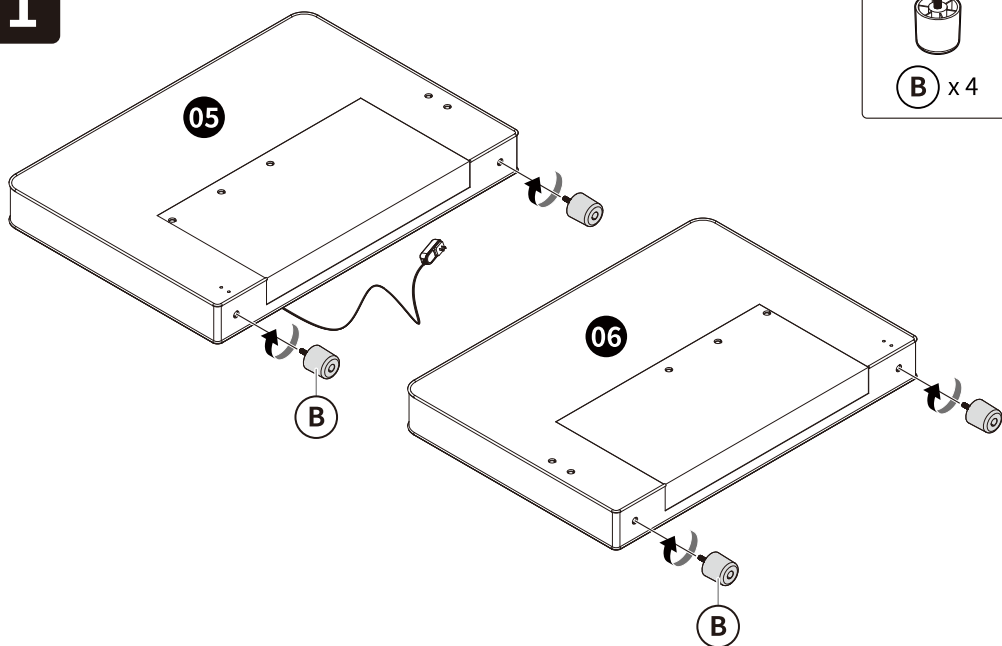

2

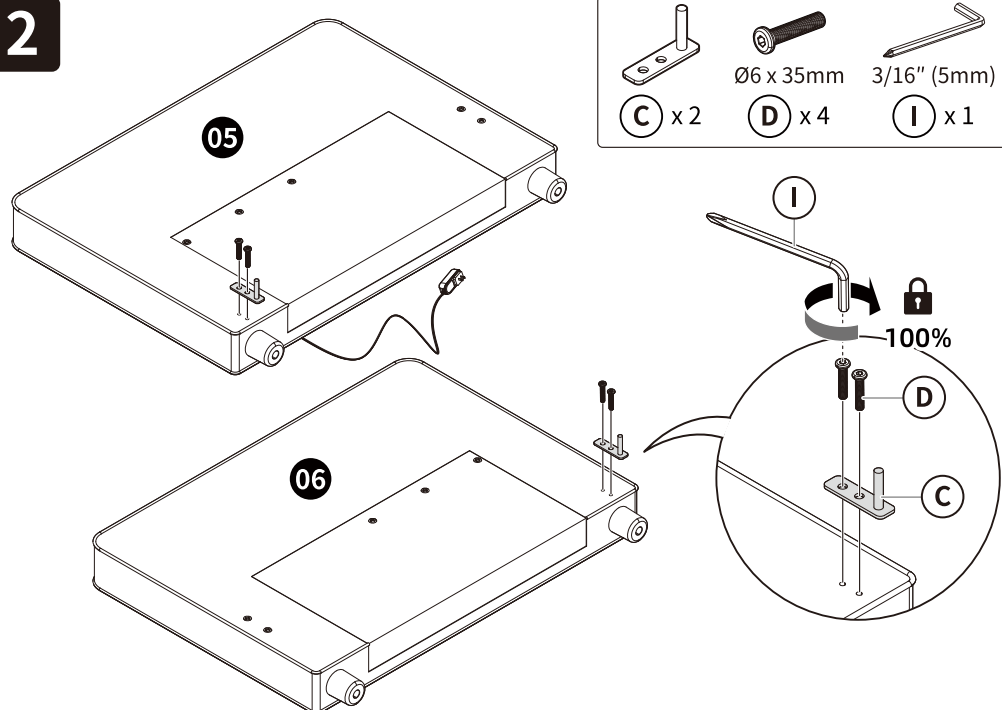

3

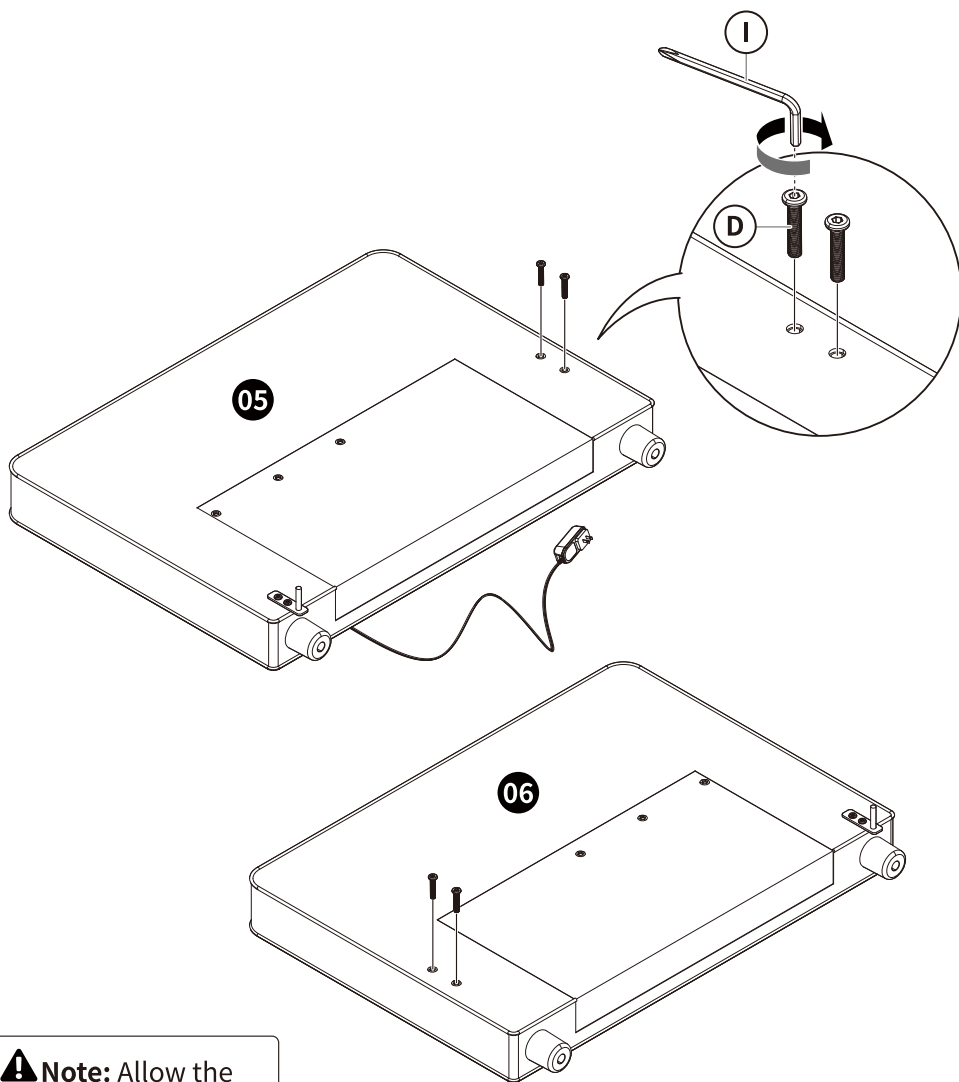
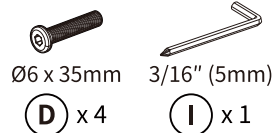

⚠ Note: Allow the bolt head to protrude 3/16" (5mm).



4



Important: Identify the two hinges before inserting them.

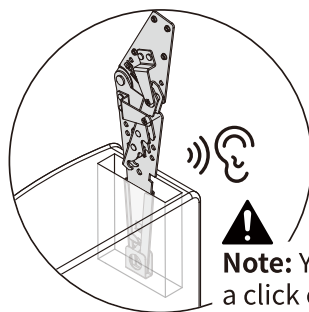
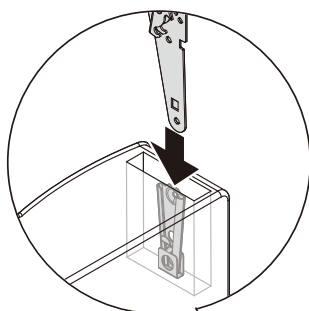
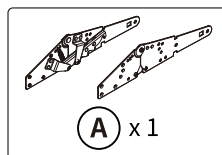

Note: You will hear a click once the hinge is locked.

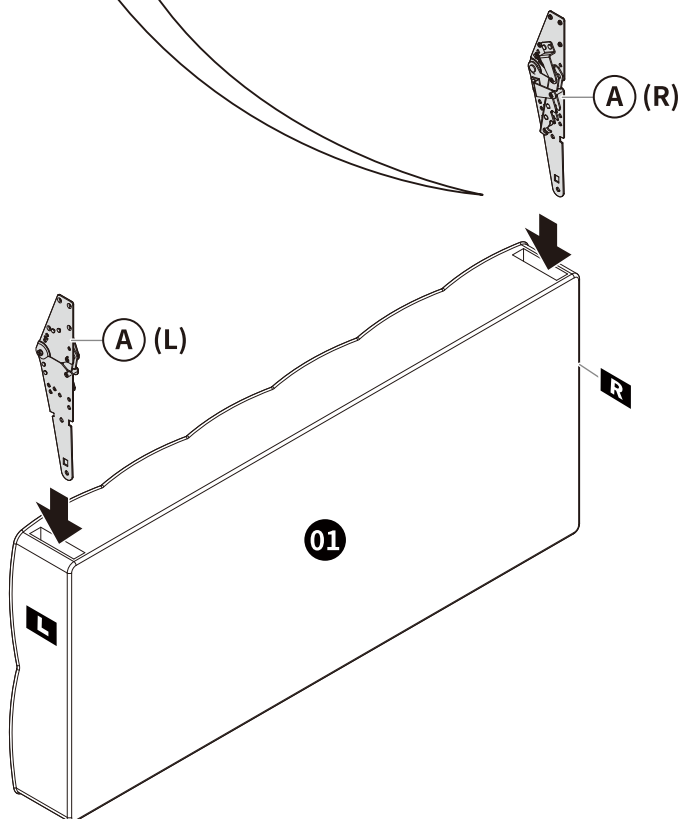

5

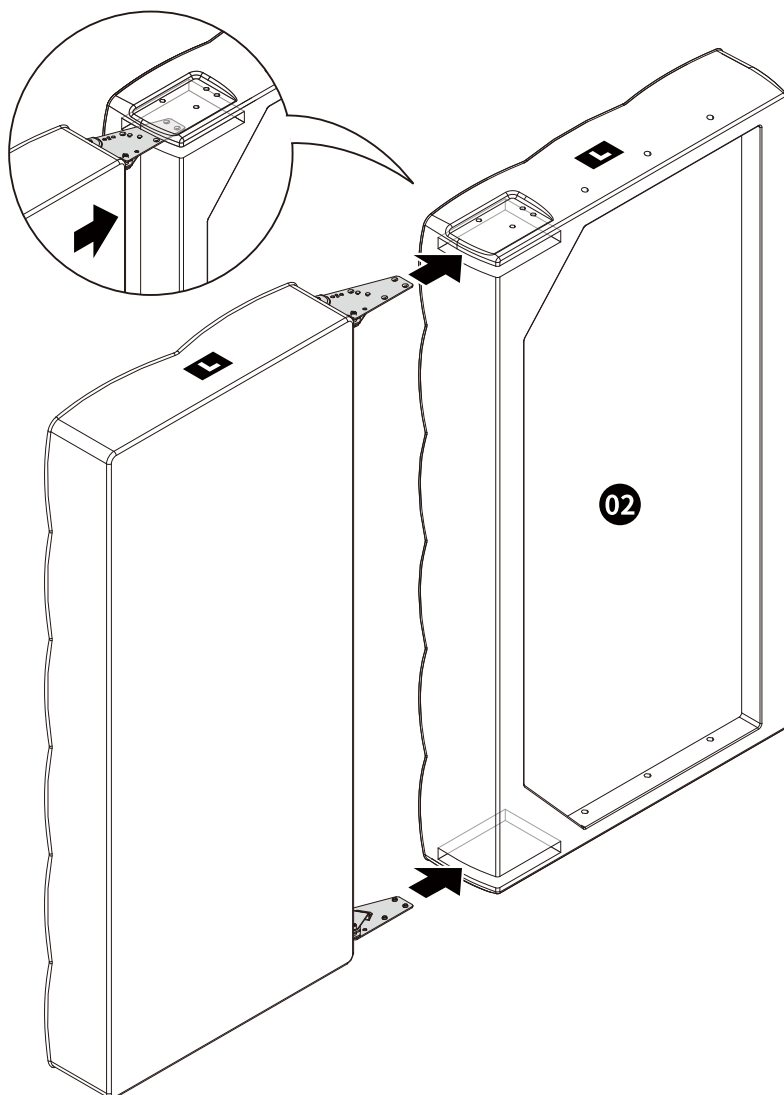
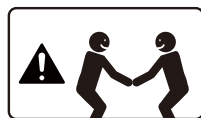
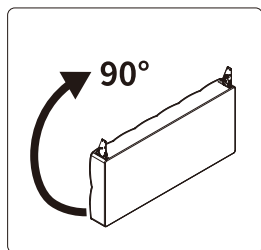

6



Note: For easier alignment, press the backrest and seat together while holding the hinge during tightening.

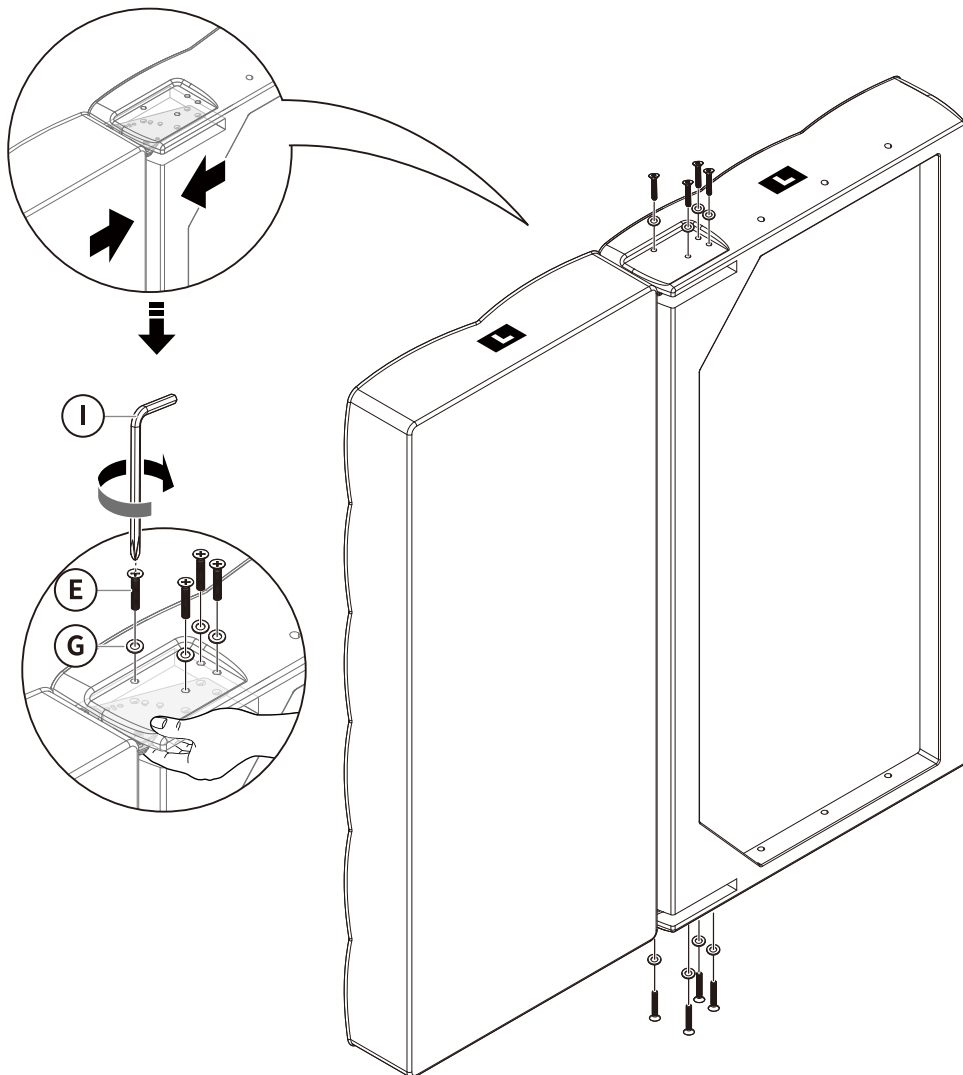
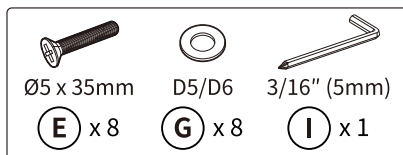

7



Ø8 x 60mm

(F) x 3



D8

(H) x 3



3/16" (5mm)

(I) x 1

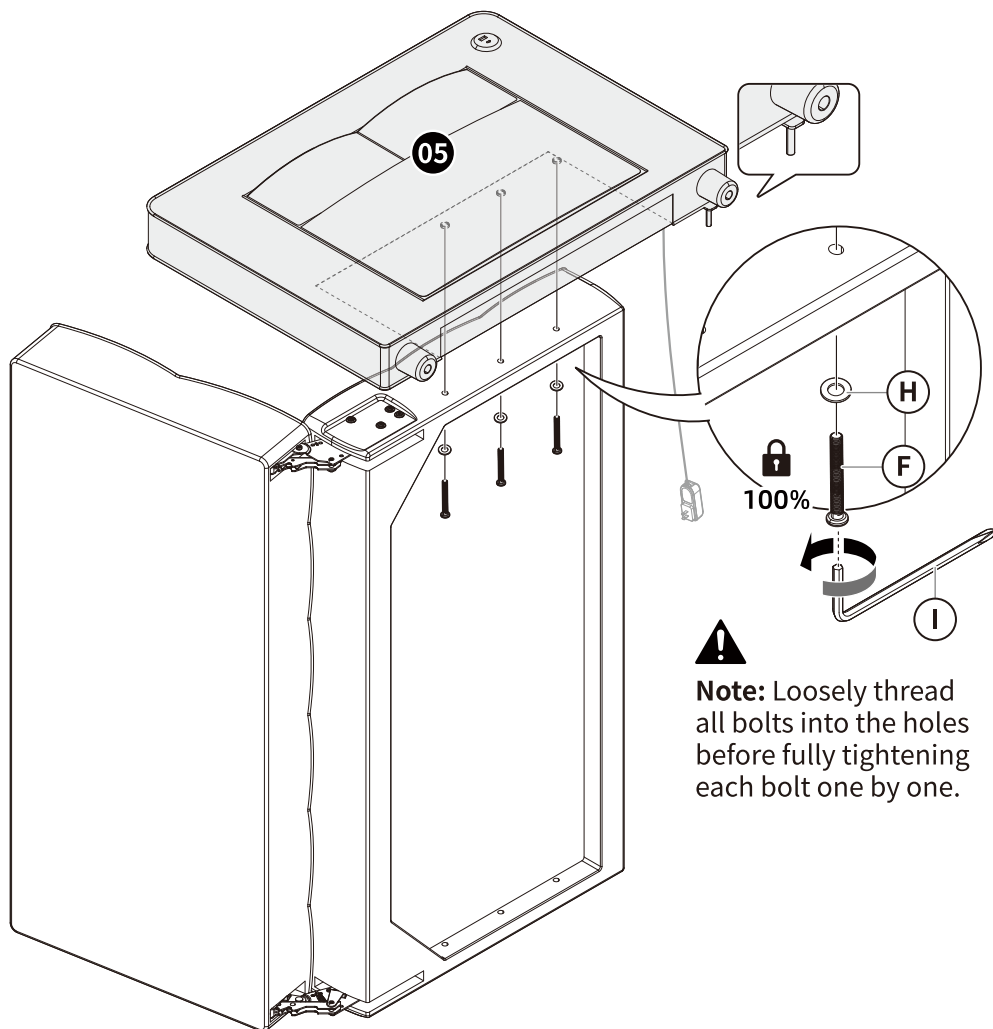

Note: Loosely thread all bolts into the holes before fully tightening each bolt one by one.

8

180°

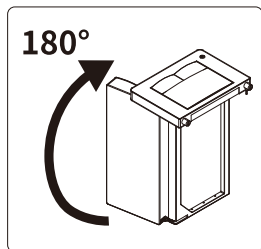

Ø8 x 60mm

(F) x 3



D8

(H) x 3

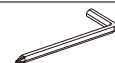

3/16" (5mm)

(I) x 1

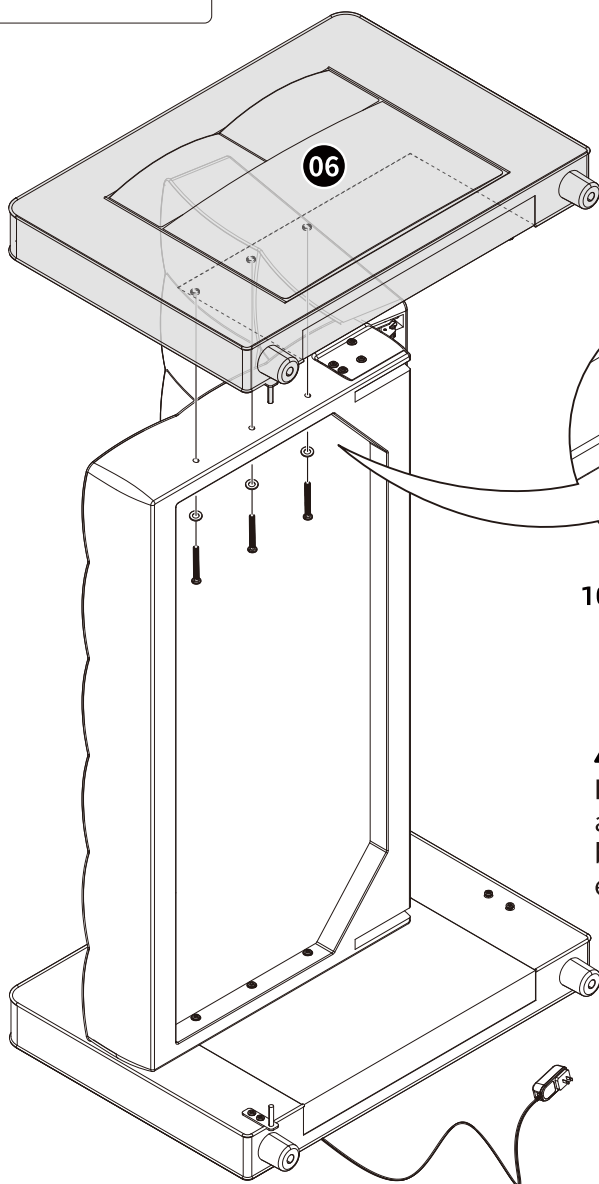

100%



Note: Loosely thread all bolts into the holes before fully tightening each bolt one by one.

9

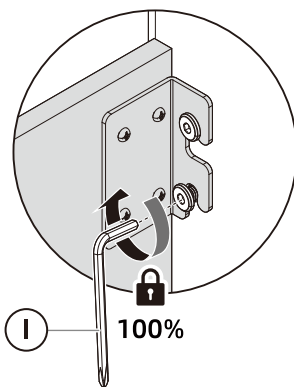
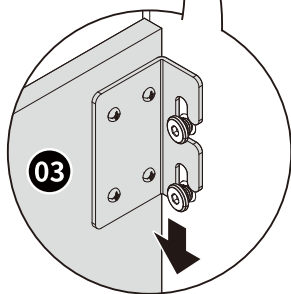
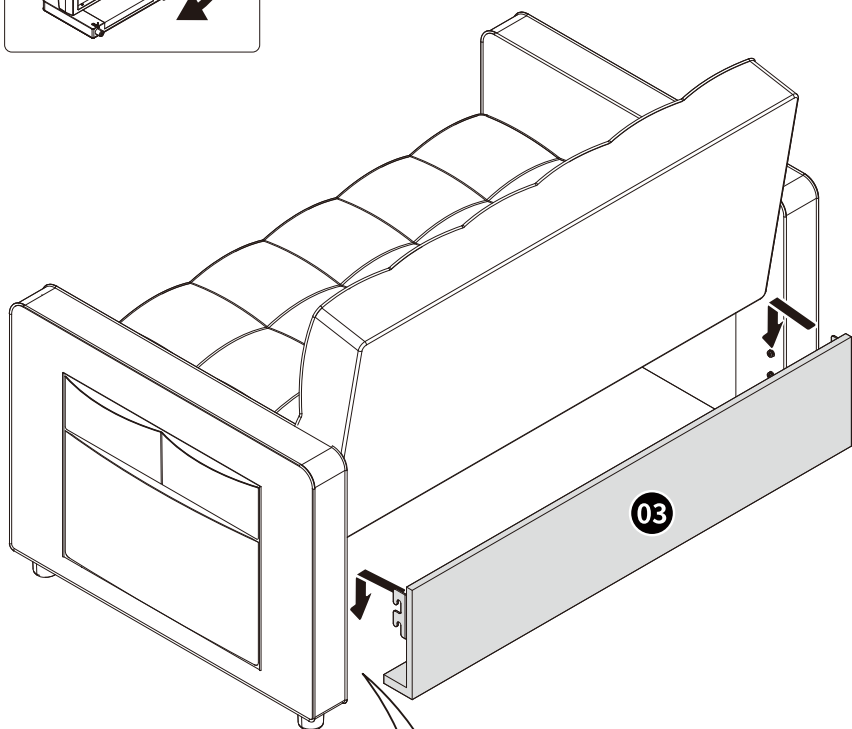
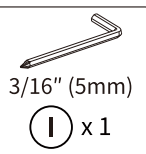
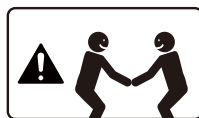
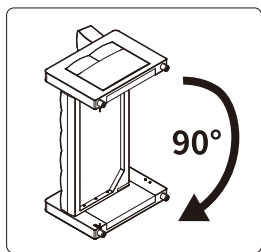

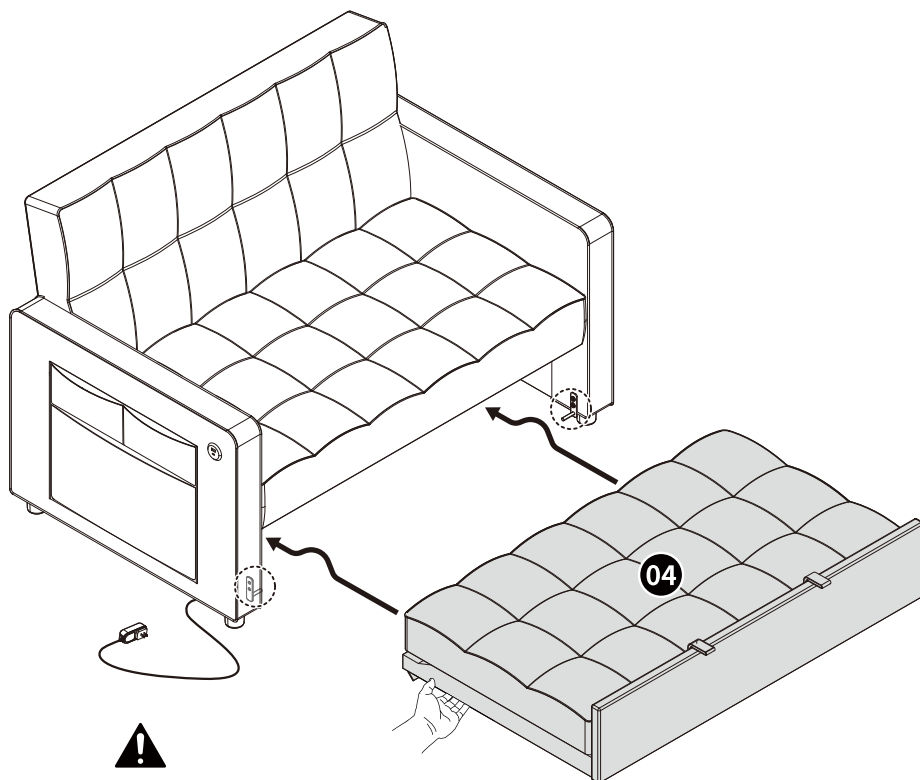

Note: Lift the back casters over the stoppers, then push the footrest into the sofa base.

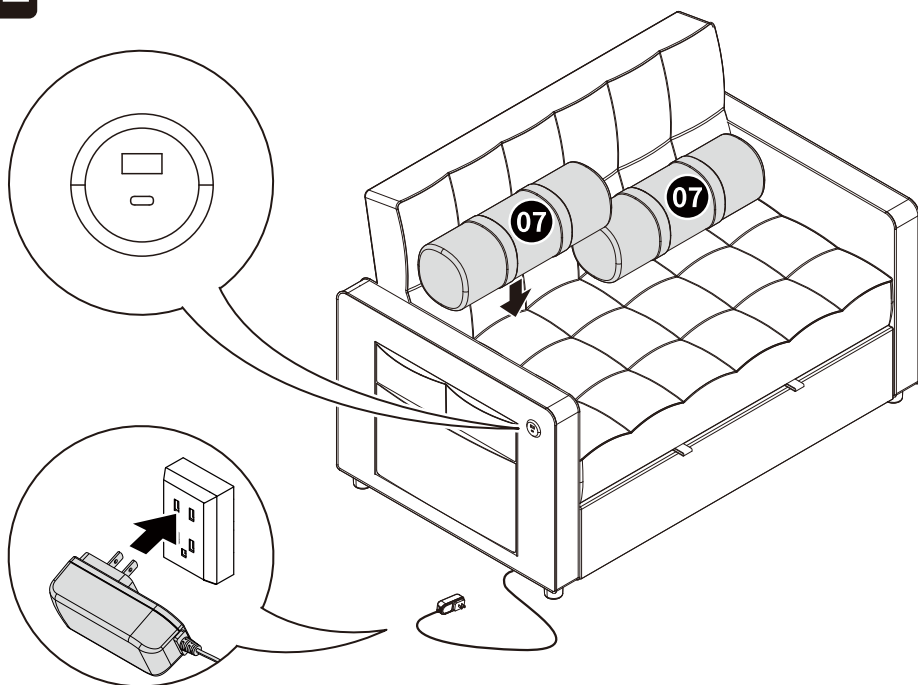

3 Angle Adjustment



Note: To adjust between angles, tilt the backrest forward. Pressing backward will lock it in the closest position.

To return the backrest to position #1, tilt it all the way forward past the #3 position to fully unlock, then lay it down.

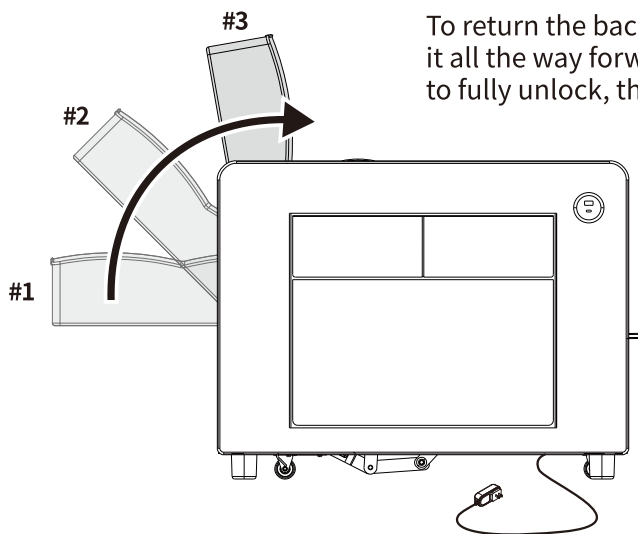

Bed Setup

Grip the straps and slide the footrest out. Pull the straps up to lift the top, then forward and down to lock it into a raised position. Reverse the steps to move it back under the sofa.

