

LED Floor Lamp

[Instruction Manual]

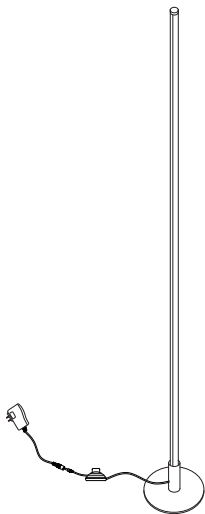

CAUTION

1. Before assembly, place all parts out on a clean flat surface and inspect each part for defects that may have occurred during shipping.
2. Inspect wire insulation for any cuts, abrasions or exposed copper that may have resulted during shipping. If there are any defects in the wire, DO NOT continue to assemble. Please send an email to our Customer Service immediately.
3. Consult a qualified electrician if you have any electrical questions.
4. Never drape clothes over the lamp.
5. To reduce the likelihood of tipping over, we recommend placing the lamp behind furniture and keep children and pets away.
6. To prevent children from suffocating and choking, keep them away from packing materials.
7. Please keep this manual and hand it over when you transfer the product.

Packing List

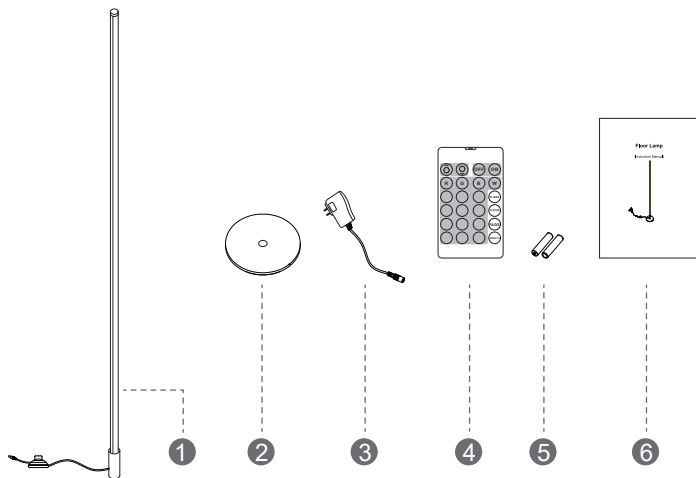

Part	Description	Quantity
1	Column Floor Lamp	1
2	Base	1
3	Adapter	1
4	Remote Control	1
5	AAA Battery (Installed)	2
6	Instruction Manual	1

ASSEMBLY INSTRUCTIONS

Before assembly, compared the accessories with the packing listing to make sure all parts are present; install the adapter first to check if product functions as intended.

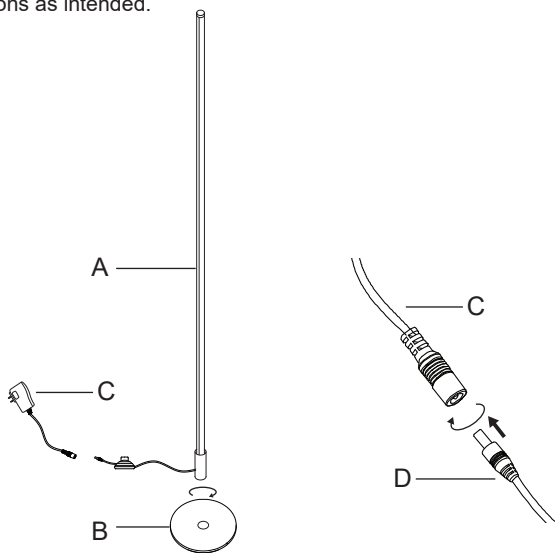

1. Screw the Column Floor Lamp (A) clockwise onto Base (B) until tight.
2. Connect the Adapter connector (D) to the Adapter (C) and then Spin lock(3)
3. Place the floor lamp where you need it and plug into the power supply.

FUNCTIONS

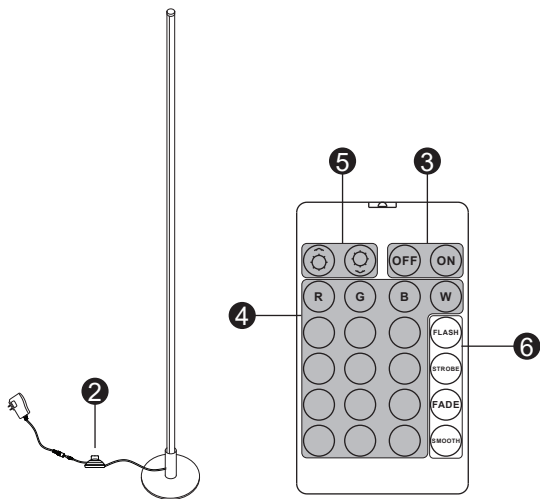

1. Remote Control
2. On/Off Foot Switch
3. On/Off Switch
4. 16 Colors
5. Dimmer
6. Color Mode
7. WiFi Smart Control

Memory function: the floor lamp can remember the brightness and color mode you settled before closing.

Note

- There must be a direct line of sight between the Remote Control and the Signal Receiver (1).
- The Remote Control works within 26ft without obstacles, and the IR signal cannot pierce through glasses or walls.

Specifications

- Product Height: 57.5 IN
- Base Length: 7.8 IN
- Wire Length: 70 IN
- Materials: Iron, ABS, Aluminum
- Input Voltage: AC100V-240V 60Hz
- Voltage of Remote: DC 3V (2 x 1.5V AAA Battery)
- Operating Range: 26FT

WiFi Smart Control Instruction

Software Installation

Scan QR Code or search "Smart Life" in Google Play or the App store to download and install the Smart Life APP.

Register

If you don't have an APP account, register an account or sign in with a verification code by SMS.

1. Tap to enter the registration page
2. The system automatically recognizes your country/region. You can also select your country code. Enter the mobile number/email and tap "Next"

3. If you enter a mobile number, then enter the verification code from the message, as shown in the picture, and enter the password, tap "Confirm" to finish registration.

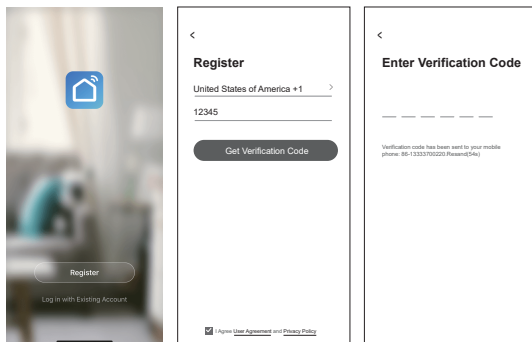

Note: Each device can only be connected to one account. If anyone else needs to control it, please share your device via the APP.

Choose Device to Add

1. Plug the Adapter plug into a socket.
2. Sign in your account and tap the "Add Device" button on the middle of the APP, then choose the "Socket (Wi-Fi)".

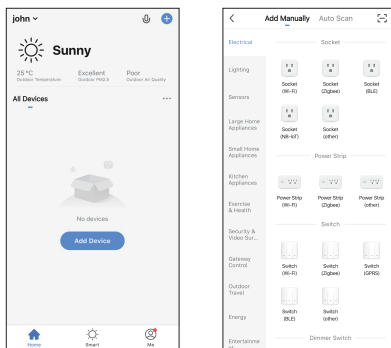

3. Reset the Device

Option A.

Reset the device via remote control

Step A-1: Power on the foot switch

Step A-2: Long press "ON" button of the remote control for 5 seconds

Step A-3: Ensure the light blinking fast

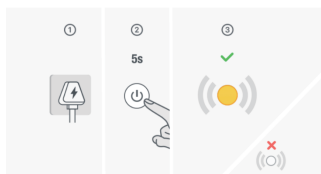
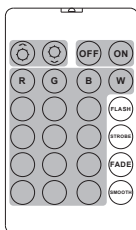

Resetting Devices >

Option B.

Reset the device via foot switch

Step B-1: Power on the foot switch

Step B-2: Turn the switch on-off-on-off-on-off-on (on-off 3 times)

Step B-3: Ensure the light blinking fast

Reset the device first.

If the light is blinking fast, skip the reset step

- ① Power on
- ② Turn On-off-on-off-on (Subject to User Manual)
- ③ Ensure light is fast blinking



Resetting Devices >

4. Select the Wi-Fi that the floor lamp will connect to; enter the Wi-Fi password and confirm, as shown in the figure:

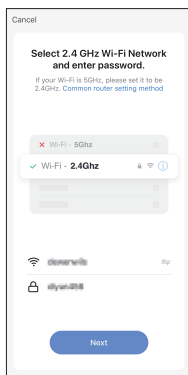

Note: Wi-Fi Column Floor Lamp configuration only supports a 2.4GHz Wi-Fi network. When work with a 5GHz router supports both 2.4GHz and 5GHz network at the same time, please make sure the names of each network is different, and then connect to the 2.4GHz network.

5. The App will proceed with the connection process, as shown in the figure:

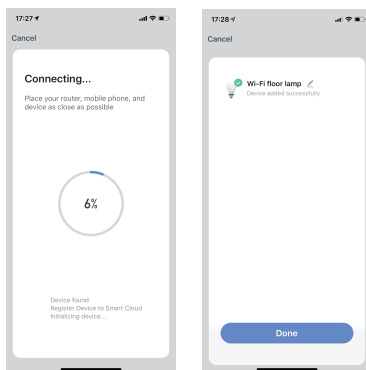

6. After the connection process completed and the light stopped blinking, the Lamp has been connected and is ready for operation.

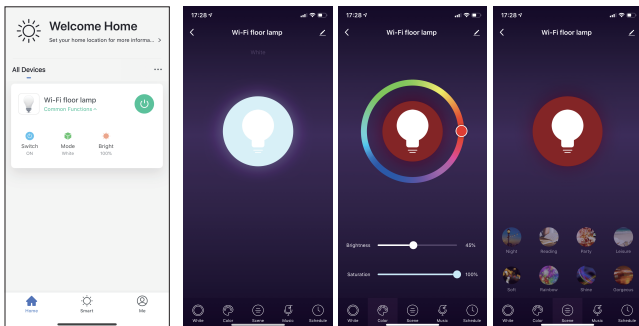

The device is now visible inside the APP overview and can be controlled. The light color and brightness can now be adjusted via the APP.

Note: The APP and Remote Control can be used simultaneously.

One Year Limited Warranty

We warrant this product to be free from defects in material and workmanship for a period of one year from the date of purchase. Warranty is void if damage is caused by misuse or improper installation.

Our dedicated customer service team will get back to you within 24 hours.