

CARE AND MAINTENANCE

Never use abrasive or acid-based cleaners on the shelf rack.
Clean shelves and rods with a solution of mild detergent and water .Use a soft cloth or sponge to wipe parts.Rinse and dry thoroughly.Keep surfaces dry and clean for a longer lasting finish.

NOTICE

Please read and understand these instructions before attempting to assemble,operate or install the product.

- Two adults required for a assembly.
- Do not allow children to climb or play in or around the shelves .
- Each shelf holds up to 66 Ibs.When items are evenly distributed.
- Assemble on a soft surface,such as carpeting to avoid scratching the finish .

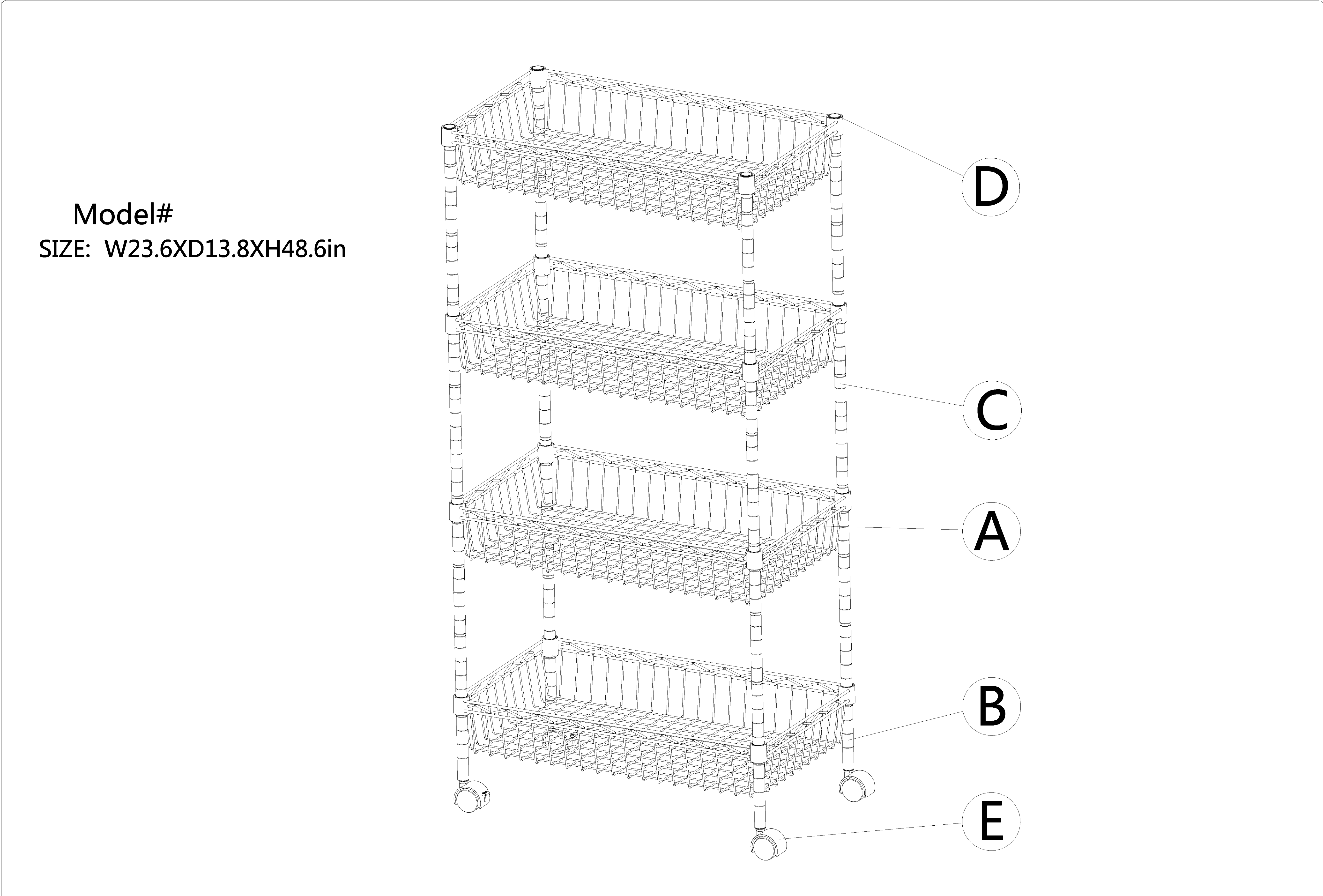

No.	A	B	C	D	E
Name	Wire Basket	Lower Pole	Upper Pole	Plastic Clip	Nylon Caster
Parts					
Quantity	4PCS	4PCS	4PCS	32PCS	4PCS

PREPARATION

- 1.Before beginning assembly of product,make sure all parts are present.Compare parts with package contents list and hardware contents .If any parts is missing or damaged,do not attempt to assemble the product .
- 2.Estimated Assembly Time :Approximately 15-20 minutes.
- 3.Helpful Tools(not included):Rubber Mallet.
- 4.Tools Required for Assembly (included): Wrench

Assembly Steps:

1 Screw the Nylon Casters (E) into the bottom of four Lower Poles (B) and fastened by Wrench . Snap Plastic Clips (D) onto the pole grooves of four lower poles at the same position and make sure that the arrow of plastic clips are pointing up.

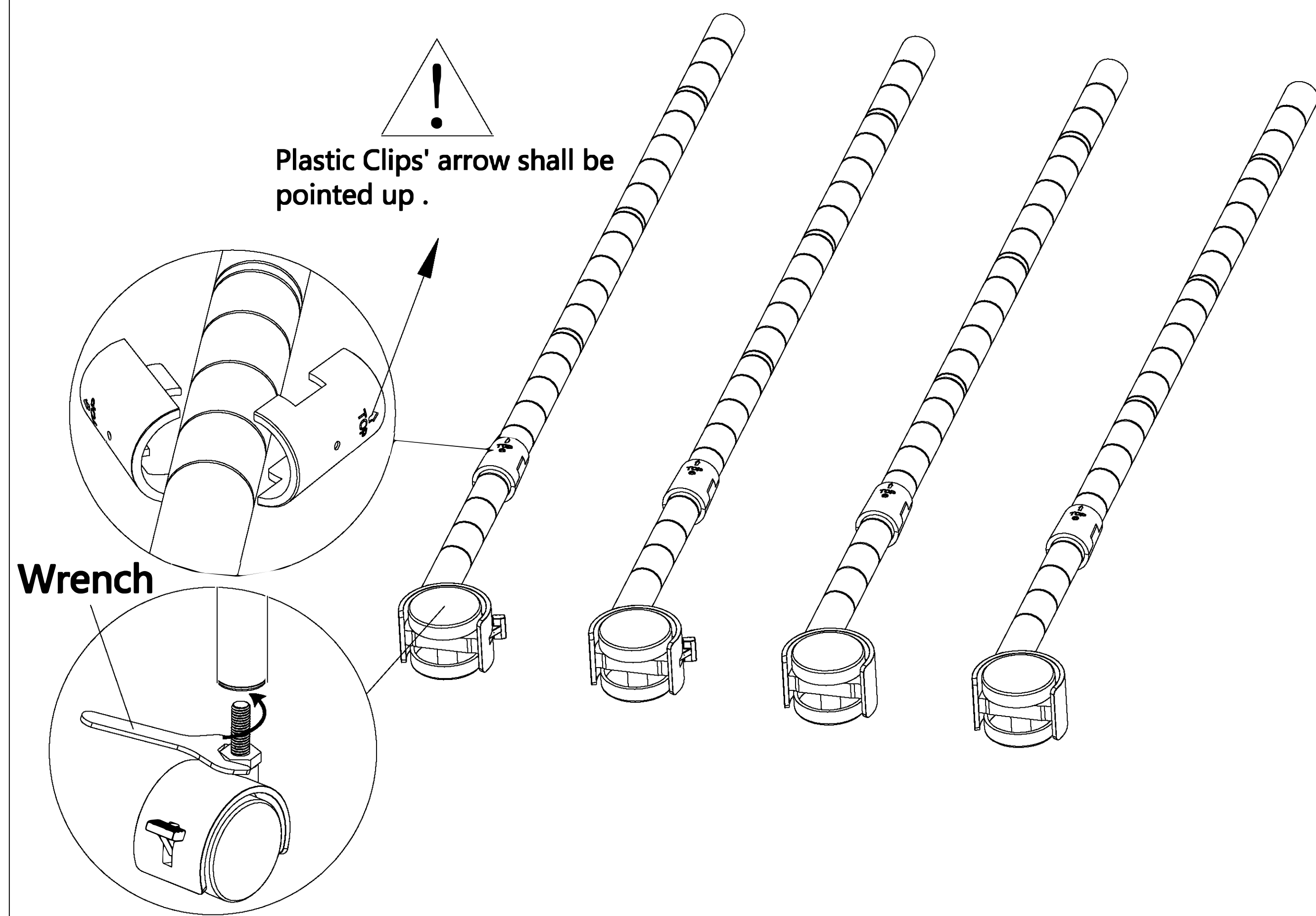

2 Please make sure Wire Basket (A) the correct way up. Hold the wire basket on its side and slide the top of four lower poles through the bottom of each basket at its corners until there is snug fit . After 4 poles have been slid through the basket collar holes, set the basket upright.

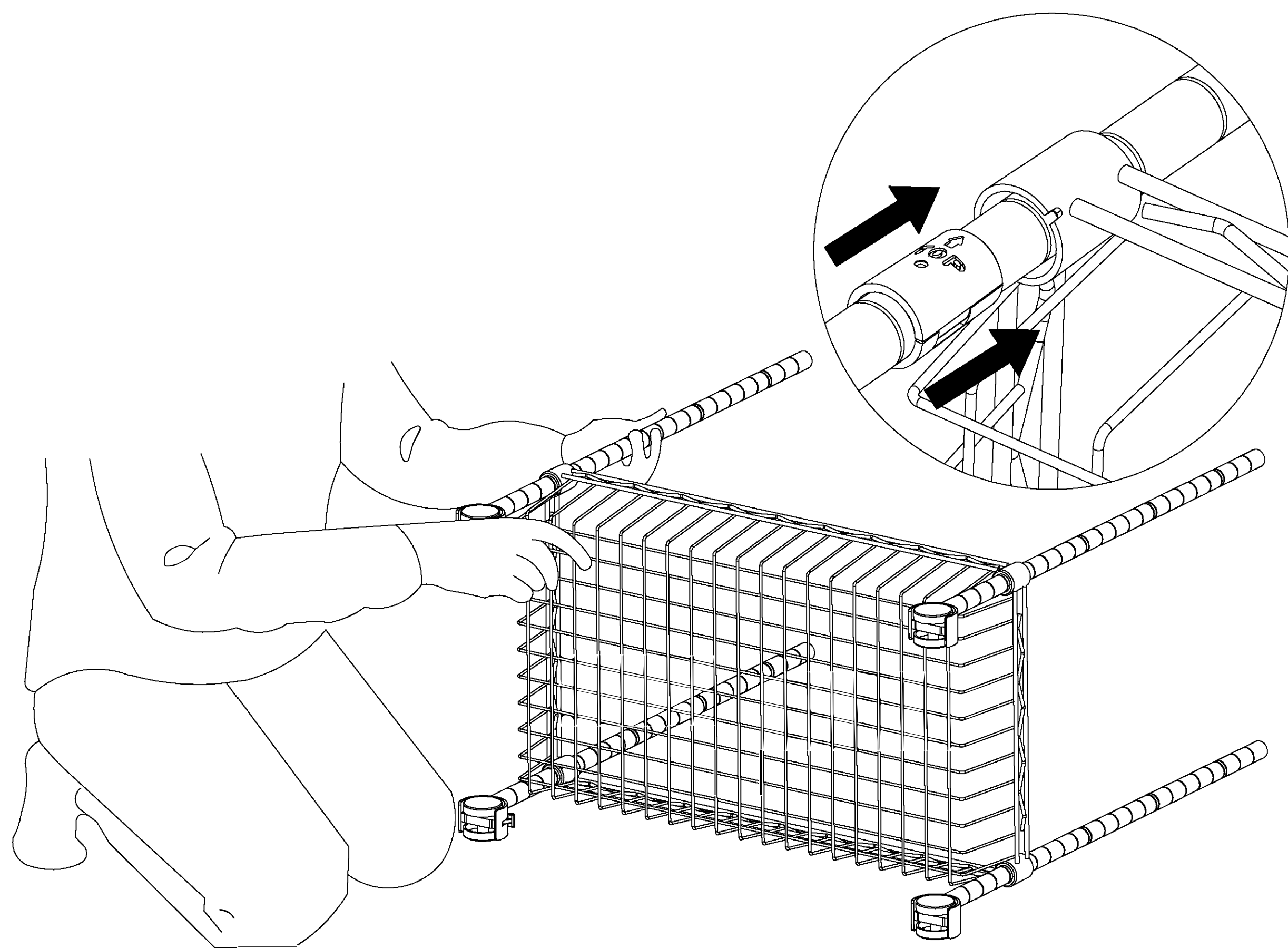

3 Snap plastic clips into the pole grooves of the lower poles at your desired basket height position. Slide down the basket from top down onto the plastic clips.

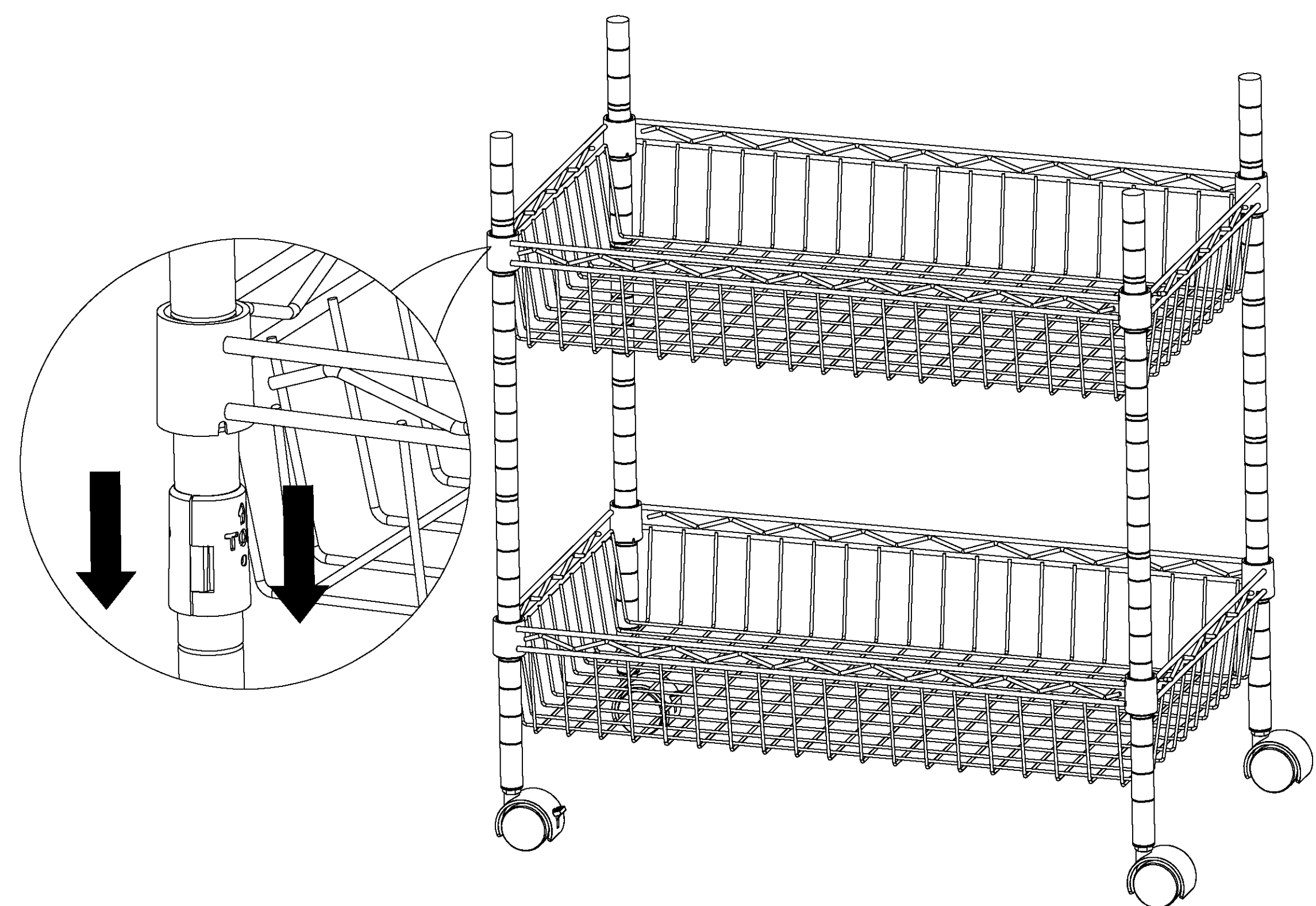

4 Screw Upper Poles (C) into Lower poles by screw connectors which is already on the upper poles.

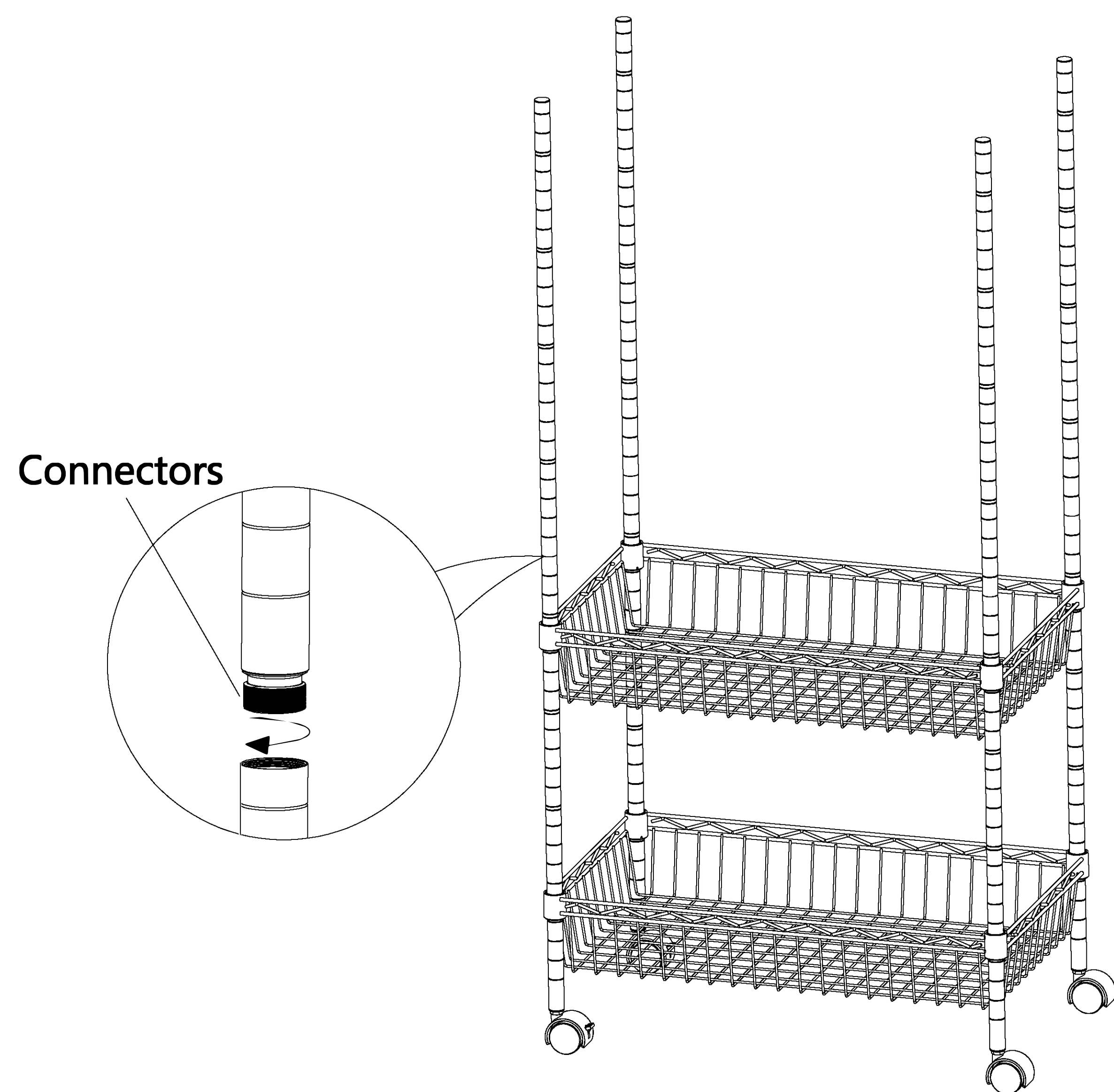

5 Repeat the step ③ to assemble the rest of wire baskets at the place you desire.

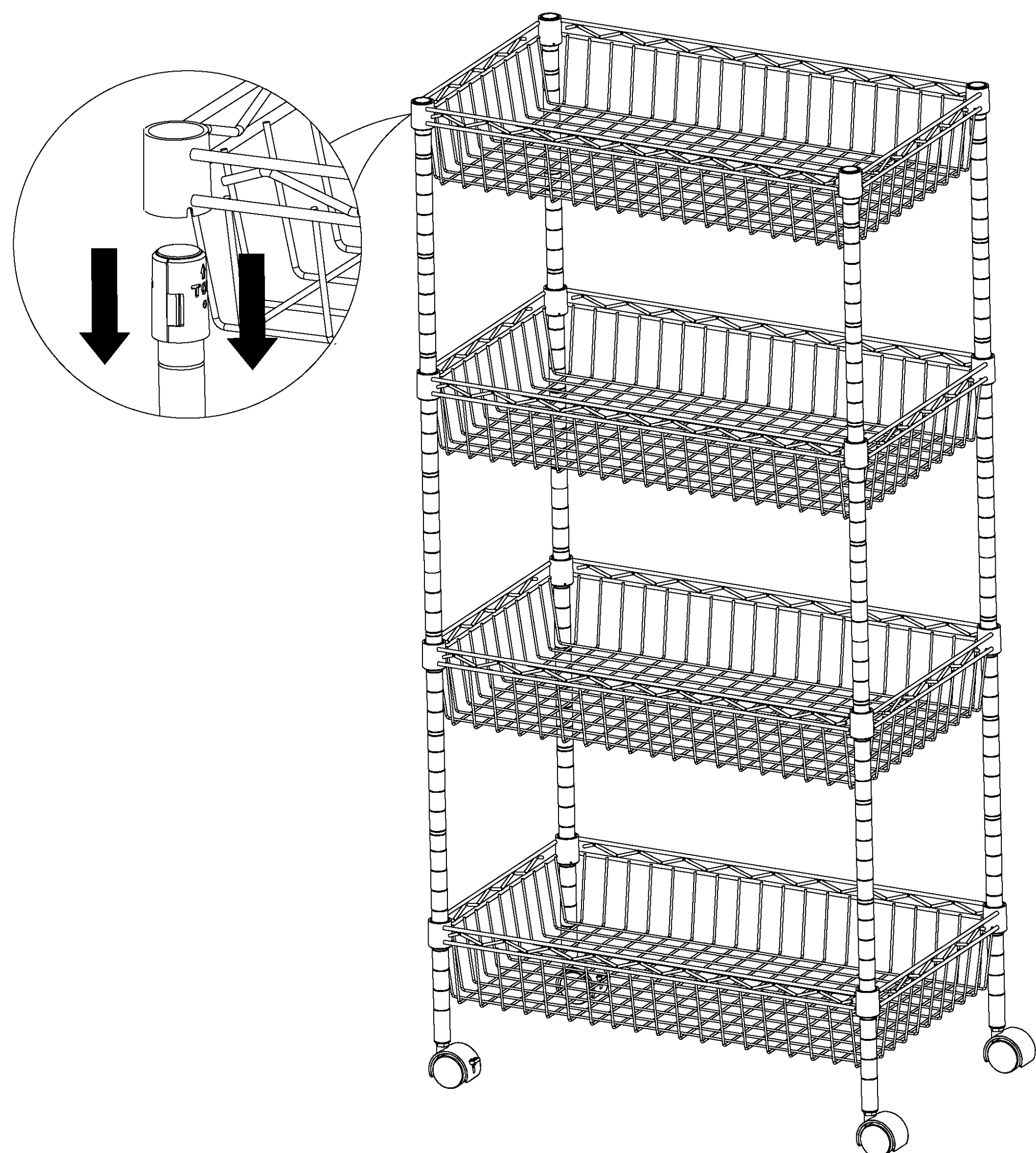

6 Once all four wire baskets have been installed, pushing firmly down on every basket at corners by rubber mallet to ensure the basket in a place over the plastic clips.

