

Assembly Instructions & User's Manual

FULL BED

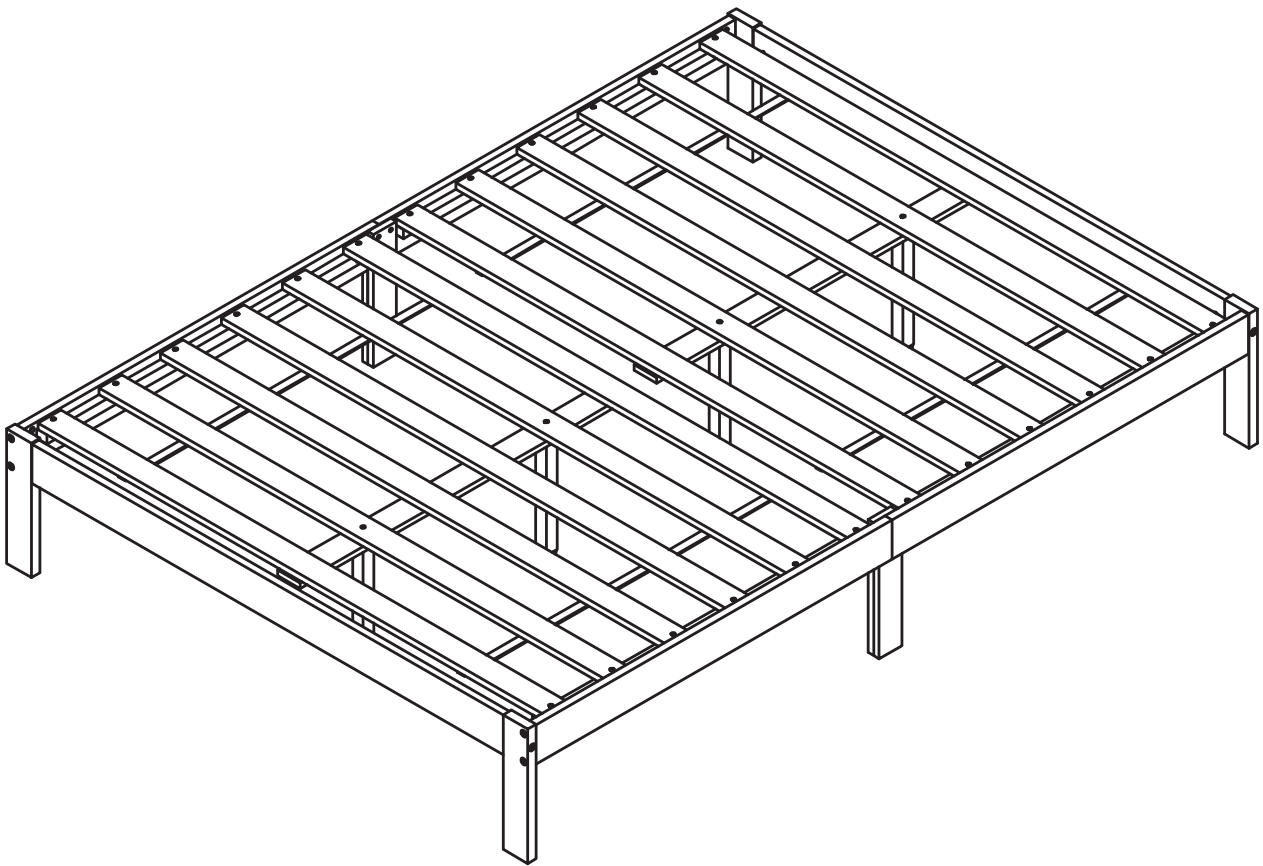

Before Assembly

- Remove all parts and hardware from the box. Place all items on a carpeted or scratch-free work surface, as this will avoid damaging parts during assembly
- The shipping box can provide an ideal work surface if none is available.
- Use the components and hardware lists below to identify, inventory and separate each of the hardware and components included
- To avoid accidentally discarding small components or hardware, do not dispose of any packaging or contents of the shipping carton until assembly is complete.
- **DO NOT USE** power tools unless it is explicitly identified in this manual as required for use during assembly. Power tools can damage the fasteners hardware and/or components
- Do not fully tighten all fasteners / screws until all parts are in place. Failure to follow these instructions may cause the fasteners/screws to misalign during assembly.

Share The Comfort

We'd love to see it in action! Share your stylish setup on social media and show us how you've integrated it into your home.

Your creative flair can inspire others to find their perfect piece. Remember to tag us – you might just get featured on our channels.

Important Safety Information

- Please read all instructions carefully before assembling this product.
- Where applicable, and for your safety, assembly by an adult is strongly recommended
- Use only vendor-supplied hardware to assemble this item. Using unauthorized hardware could jeopardize the structural integrity of the item.
- Hardware may loosen overtime. Periodically check that all connections are tight

Care&Use

- Use a soft, clean cloth that will not scratch the surface when cleaning
- Dust often and use a vacuum cleaner crevice tool to clean between seams
- Keep furniture at least 60cm/2ft from heat sources to avoid damage

Package Contents

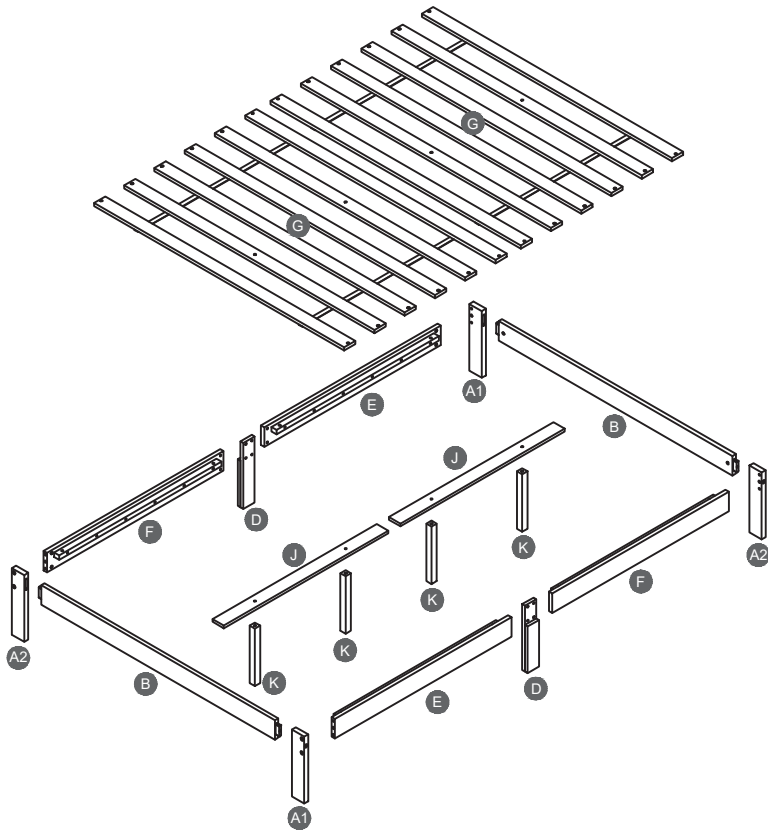

Part List

Part No.	Part Name	Qty	Box
A1.	Bed Post	x2	1
A2.	Bed Post	x2	1
B.	Hb. Fb. Panel	x2	1
D.	Side Rail Support	x2	1
E.	Side Rail	x2	1
F.	Side Rail	x2	1
G.	Set of Slats	x2	1
J.	Center Rail	x2	1
K.	Support Leg	x4	1

Hardware List

1.	JCBC M6 x 110mm		x 4
2.	M6 x 15mm Barrel Nut		x 12
3.	Flat Washer		x 8
4.	JCBC M6 x 30mm		x 8
5.	Wood Dowel M10 x 30mm		x 4
6.	JCBC M6 x 65mm		x 12
7.	JCBC-W M6 x 30mm		x 8
8.	Adjustable Screw		x 4
9.	CSK Screw M4 x 25mm		x 16
10.	M4 Allen Key		x 1

Tool required for assembly :

- * Allen Key (supplied)
- * Phillips Screwdriver (not supplied)

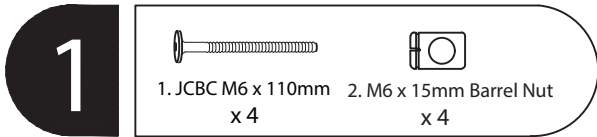

Assemble the Foot Post (A1)(A2) to the Hb. Fb. Panel (B).

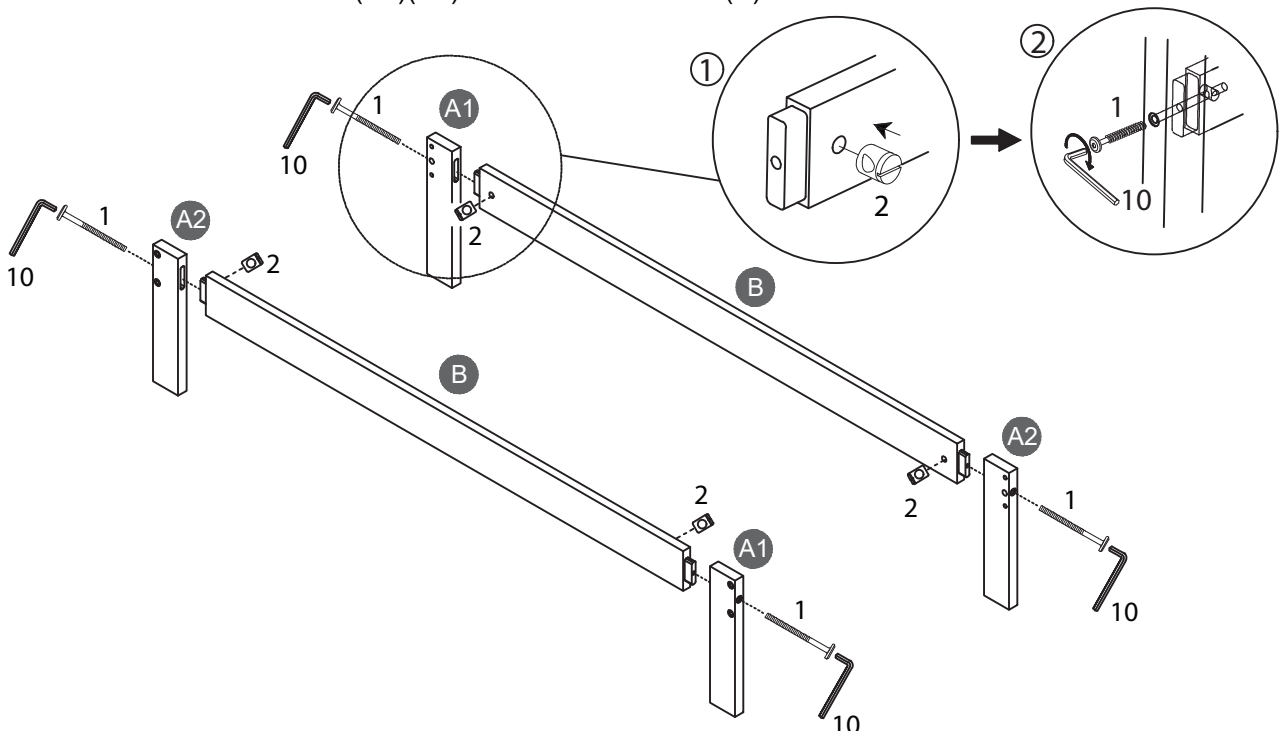

2

- 3. Flat Washer x 8
- 4. JCBC M6 x 30mm x 8

Assemble the Side Support Rails (D) to the all the Side Rails (E)(F).

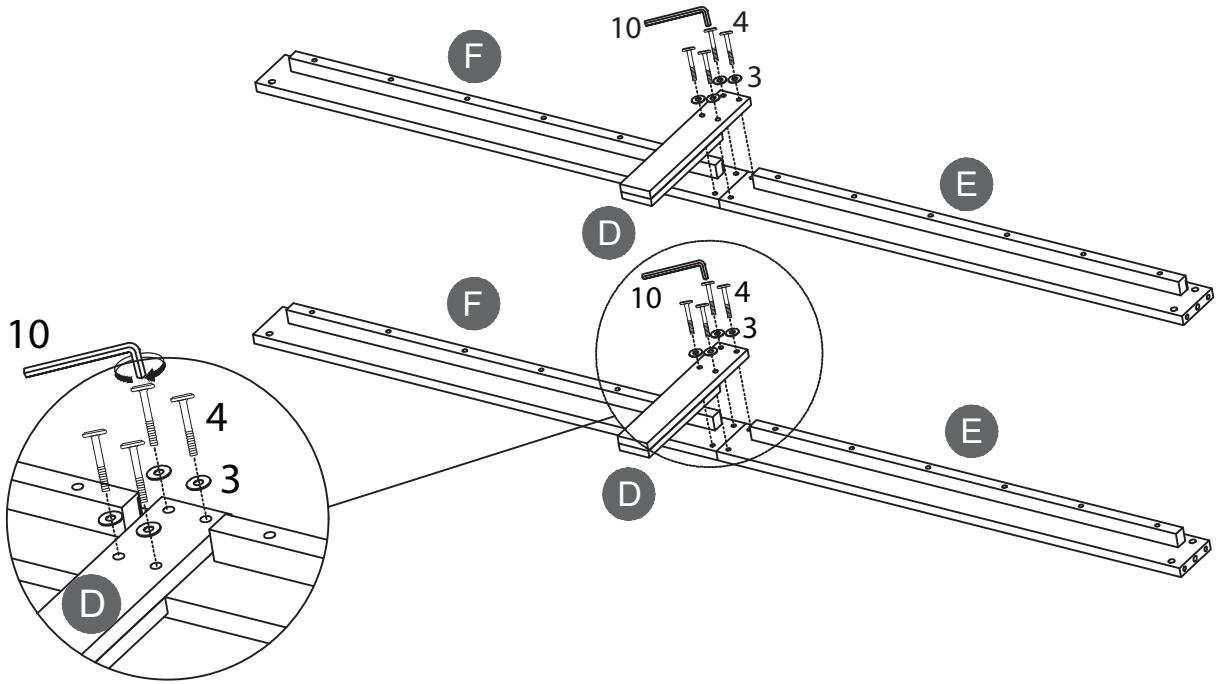

3

- 2. M6 x 15mm Barrel Nut x 8
- 5. Wood Dowel M10 x 30mm x 4
- 6. JCBC M6 x 65mm x 8

Assemble the Side Rails to the Headboard and Footboard.

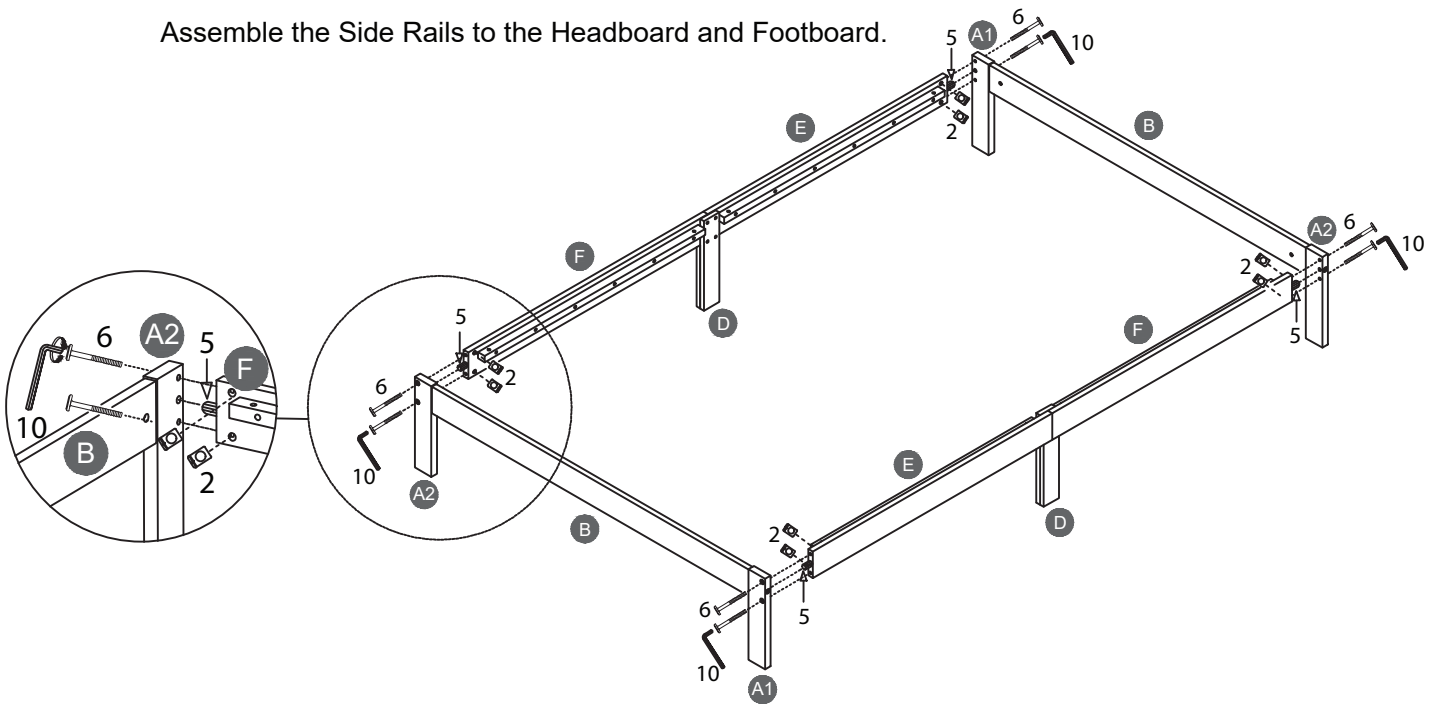

4

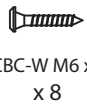
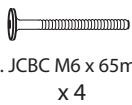

6. JCBC M6 x 65mm x 4 7. JCBC-W M6 x 30mm x 8 8. Adjustable Screw x 4 9. CSK Screw M4 x 25mm x 16

Lock the Support Legs (K) onto the Slats (G) and Center Rail (J). Please note that the Support Legs (K) have the Adjuster at the bottom, Unscrew it to adjust if necessary. Attach the Slats (G).

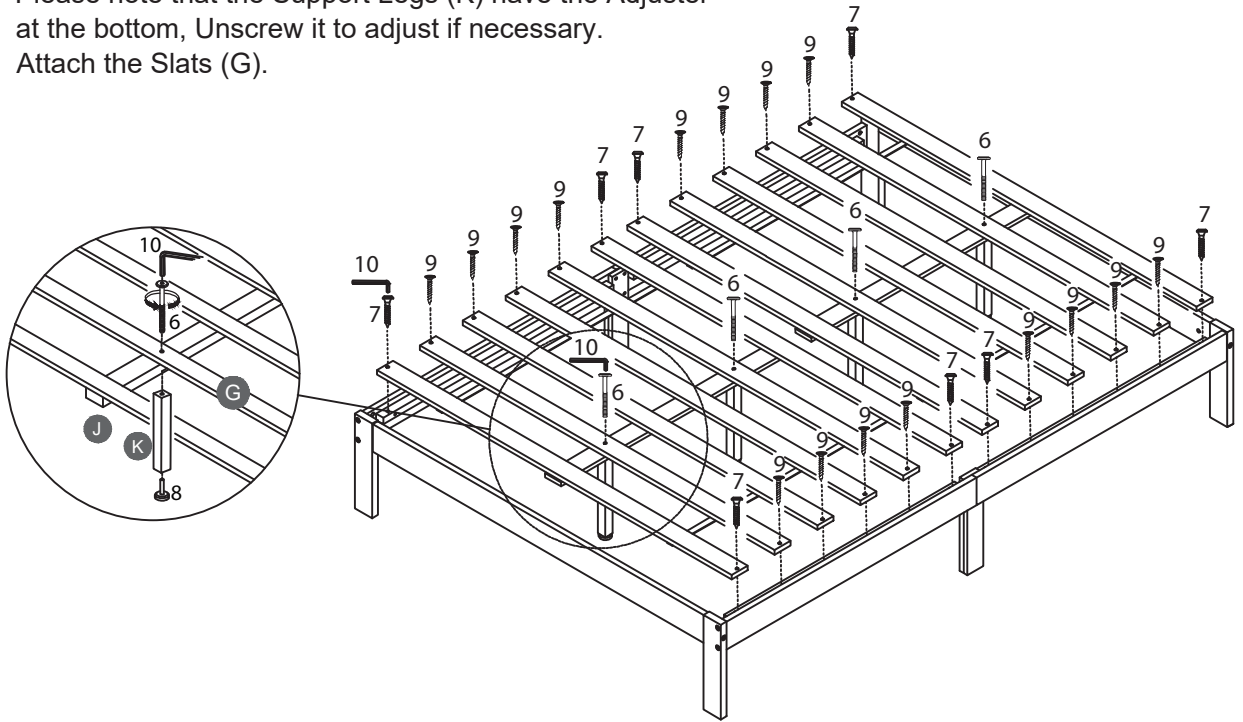

5

Remove adhesive protection strip from non-slip taped slats as shown to help keep your mattress in place.

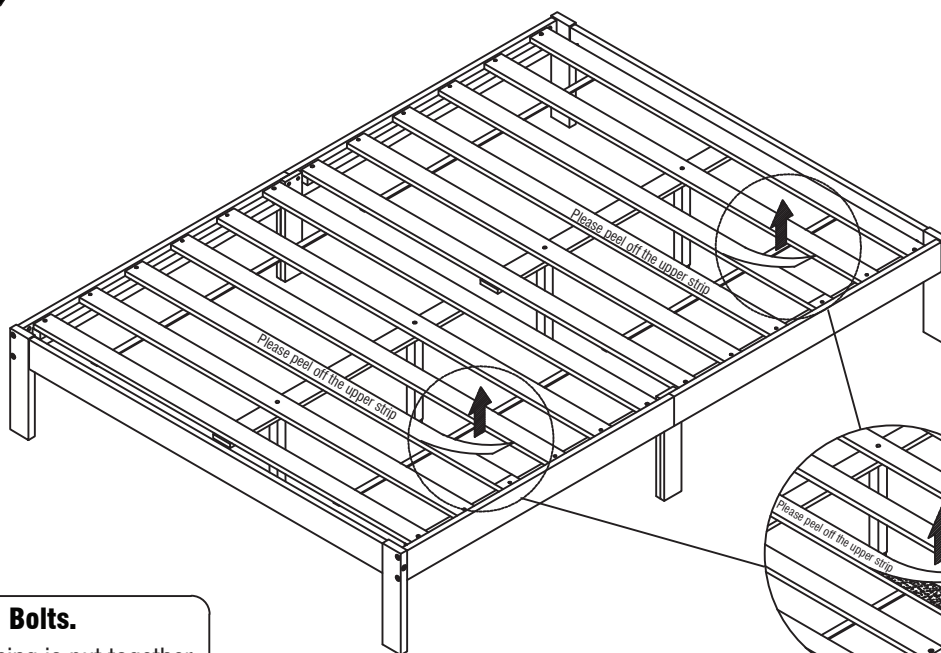

Tighten the Bolts.

When everything is put together tighten all the Bolts.

Please make sure to only remove the top vinyl strip and not the whole tape!