

Instruction

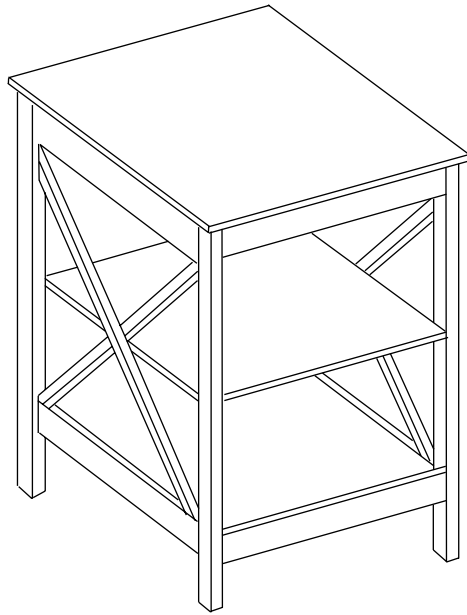

PARTS -PIEZAS

① x 1

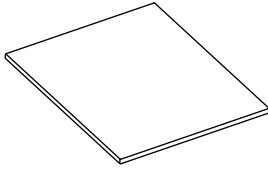

Top Panel

② x 2

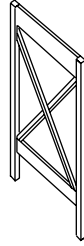

Side Panel

③ x 1

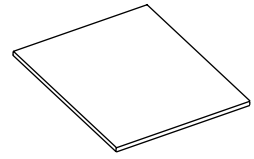

Shelf Panel

④ x 1

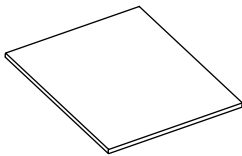

Bottom Panel

⑤ x 2

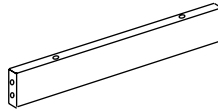

Cross Bar

⑥ x 2

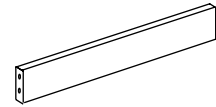

Cross Bar

PARTS -PIEZAS

A x 10



Cam Bolt

B x 10

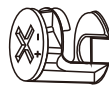

Cam Lock

C x 26



Dowel

D x 4



Ø 0.16 x 1.97 inch
Actual Size

Screw

E x 4



Mat

1

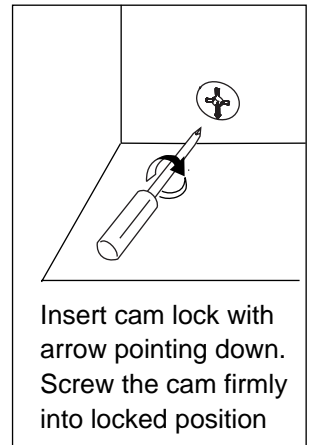
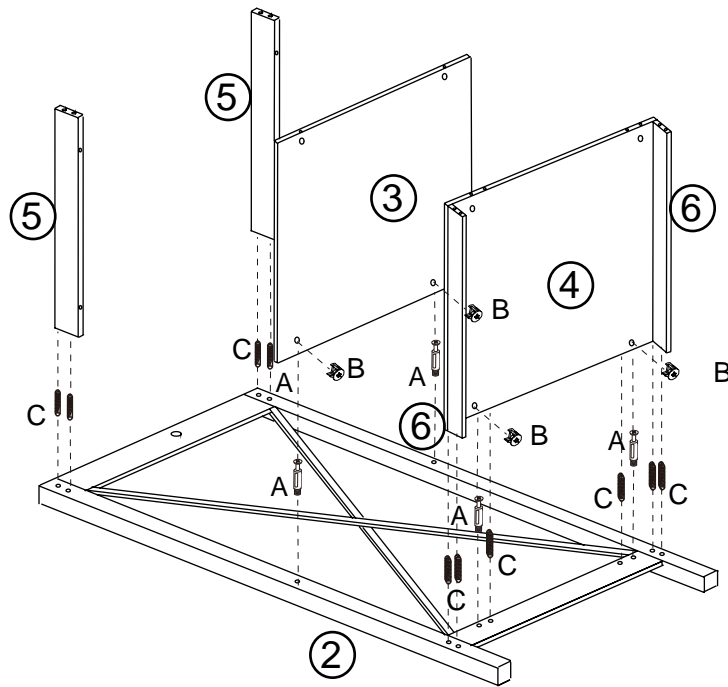

Step 1

Insert cam bolts (A) and dowels (C) into the holes of the side panel (2) like the image.

Align the holes of the cross bars (5), shelf panel (3), and bottom panel (4) to the cam bolts and dowels and connect them together. Once they are all attached, insert cam locks (B) to the inner holes on the cross bars and the bottom holes on the shelf and bottom panels to tighten the attachments.

Note: Make sure all cam locks are tightened.

2

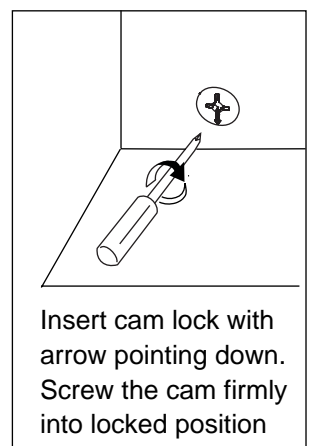
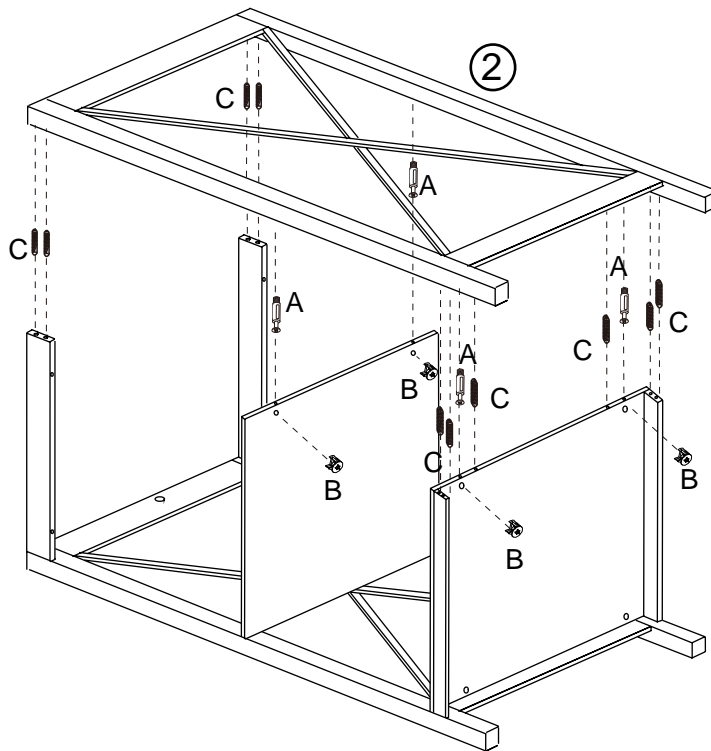

Step 2

Insert cam bolts (A) and dowels (C) into the holes on the other sides of the cross bars, shelf panel, and bottom panel. Once all dowels and cam bolts are inserted, attach the side panel (2) to the cross bars and the shelf and bottom panels. Then, insert cam locks (B) into the inner holes on the cross bars and the bottom holes of the shelf and bottom panels to tighten them together.

Note: Make sure cam locks are tightened.

3

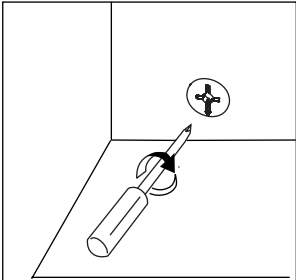

Insert cam lock with arrow pointing down. Screw the cam firmly into locked position

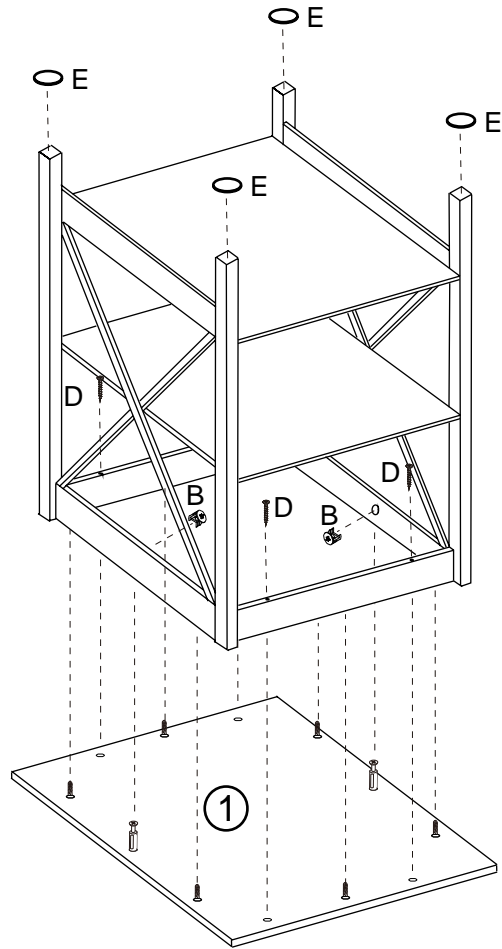
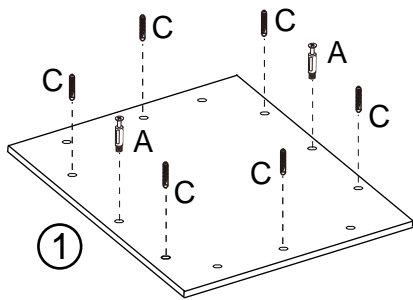

Step 3

Have the top panel (1) upside down on a soft surface, such as carpet. Make sure there are not any sharp objects underneath. Insert cam bolts (A) and dowels (C) into the holes on the top panel. Once all cam bolts and dowels are inserted in the holes, align them to the holes on the side panels and cross bars and connect them together. Insert cam locks (B) into the holes on the inner sides of the side panels and screw (D) into the cross bars to tighten them together.

Note: Make sure all cam locks and screws are tightened.

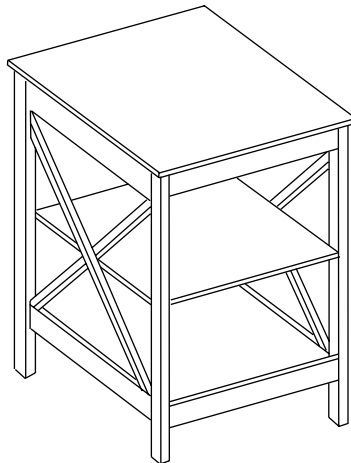

Your end table is now finished.

Make sure all bolts and screws are secured tightly before using.

Do not sit or stand on top.

Be sure to clean up any spills immediately.

Enjoy!