



User's Manual



INSTALLATION INSTRUCTIONS

Installation Manual

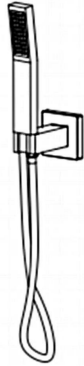
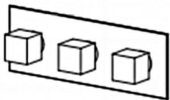
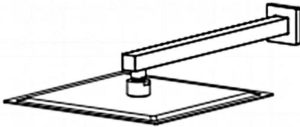

IAPMO RESEARCH AND TESTING, INC.

1825 S. WILSON AVENUE, CHICAGO, ILL. 60628 • TEL: 312/349-7000 • FAX: 312/349-7001 • WWW.IAPMO.COM • COUNCILING

CERTIFICATE OF LISTING

Effective Date: August 01/03

Issued to: Fluorocube Plastic Products

Model Number: 7000

Issued by: Reliance Test Certificate Co., Inc.

Product: 1/2" x 1/2" x 1/2" Fluorocube Plastic

Testing Agency: RELIAISON INC.

Product Use: RECREATION

Product Description: 1/2" x 1/2" x 1/2" Fluorocube Plastic

Product Dimensions: 1/2" x 1/2" x 1/2"

Product Weight: 1/2" x 1/2" x 1/2"

Product Material: 1/2" x 1/2" x 1/2"

Product Color: 1/2" x 1/2" x 1/2"

Product Finish: 1/2" x 1/2" x 1/2"

Product Location: 1/2" x 1/2" x 1/2"

Product Manufacturer: 1/2" x 1/2" x 1/2"

Product Distributor: 1/2" x 1/2" x 1/2"

Product Retailer: 1/2" x 1/2" x 1/2"

Product Installer: 1/2" x 1/2" x 1/2"

Product Maintainer: 1/2" x 1/2" x 1/2"

Product User: 1/2" x 1/2" x 1/2"

Product Owner: 1/2" x 1/2" x 1/2"

Product Buyer: 1/2" x 1/2" x 1/2"

Product Seller: 1/2" x 1/2" x 1/2"

Product Supplier: 1/2" x 1/2" x 1/2"

Product Manufacturer: 1/2" x 1/2" x 1/2"

Product Distributor: 1/2" x 1/2" x 1/2"

Product Retailer: 1/2" x 1/2" x 1/2"

Product Installer: 1/2" x 1/2" x 1/2"

Product Maintainer: 1/2" x 1/2" x 1/2"

Product User: 1/2" x 1/2" x 1/2"

Product Owner: 1/2" x 1/2" x 1/2"

Product Buyer: 1/2" x 1/2" x 1/2"

Product Seller: 1/2" x 1/2" x 1/2"

Product Supplier: 1/2" x 1/2" x 1/2"

Product Manufacturer: 1/2" x 1/2" x 1/2"

Product Distributor: 1/2" x 1/2" x 1/2"

Product Retailer: 1/2" x 1/2" x 1/2"

Product Installer: 1/2" x 1/2" x 1/2"

Product Maintainer: 1/2" x 1/2" x 1/2"

Intention: Fluorocube plastic complying with this document shall be suitable with the manufacturer's equipment and, otherwise, no other use.
In the use of this plastic material, the user, consumer or other end user, shall be responsible for the proper use of the material and shall be
accountable by way of a purchase order or by placing a purchase order
with the supplier. Reliance on purchasing order or purchase order shall
void any installation.

Intention: Fluorocube plastic complying with this document shall be suitable with the manufacturer's equipment and, otherwise, no other use.
In the use of this plastic material, the user, consumer or other end user, shall be responsible for the proper use of the material and shall be
accountable by way of a purchase order or by placing a purchase order
with the supplier. Reliance on purchasing order or purchase order shall
void any installation.

Intention: Fluorocube plastic complying with this document shall be suitable with the manufacturer's equipment and, otherwise, no other use.
In the use of this plastic material, the user, consumer or other end user, shall be responsible for the proper use of the material and shall be
accountable by way of a purchase order or by placing a purchase order
with the supplier. Reliance on purchasing order or purchase order shall
void any installation.

Intention: Fluorocube plastic complying with this document shall be suitable with the manufacturer's equipment and, otherwise, no other use.
In the use of this plastic material, the user, consumer or other end user, shall be responsible for the proper use of the material and shall be
accountable by way of a purchase order or by placing a purchase order
with the supplier. Reliance on purchasing order or purchase order shall
void any installation.

Intention: Fluorocube plastic complying with this document shall be suitable with the manufacturer's equipment and, otherwise, no other use.
In the use of this plastic material, the user, consumer or other end user, shall be responsible for the proper use of the material and shall be
accountable by way of a purchase order or by placing a purchase order
with the supplier. Reliance on purchasing order or purchase order shall
void any installation.

Handwritten signature: [Signature]

Handwritten signature: [Signature]

This listing is not a warranty, nor does it constitute an endorsement of the product or the manufacturer. It is a statement of the product's compliance with the applicable standards.

This listing is not a warranty, nor does it constitute an endorsement of the product or the manufacturer. It is a statement of the product's compliance with the applicable standards.

This listing is not a warranty, nor does it constitute an endorsement of the product or the manufacturer. It is a statement of the product's compliance with the applicable standards.

This listing is not a warranty, nor does it constitute an endorsement of the product or the manufacturer. It is a statement of the product's compliance with the applicable standards.

This listing is not a warranty, nor does it constitute an endorsement of the product or the manufacturer. It is a statement of the product's compliance with the applicable standards.

[illegible]

<p align="center">IAPMO RESEARCH AND TESTING, INC.</p> <p align="center">3801 East Philadelphia Avenue, Channahon, Illinois 61018-1509 • 815-398-0400 • FAX 815-398-0401 • www.iapmo.org</p>			
 ANSI Z39.18-2001	 IAPMO RESEARCH & TESTING	 UL LISTED	
 UPC C	<h1>CERTIFICATE OF LISTING</h1>		
<p>The above-named manufacturer at this institution of listing is available within or jurisdiction:</p>			
Effective Date:	Expiring Date:	File #:	VOID AFTER EXPIRATION
Product:	Function: Fire Alarm	Model:	File #:
Issue Date:	Original Date:	Model:	
Manufacturer:	<p>Each listing certificate must have permanent legible markings to identify the product and its function. The product shall be tested once, however, it shall be used to identify the manufacturer. The product shall also bear all other markings required by the standard. The marking shall be located where the manufacturer and other markings are required. The product so prepared shall also bear the ULPP certification mark.</p>		
Manufacturer:	<p>Function listing certificates are provided to facilitate compliance with the manufacturer's commitment and the requirements of the latest edition of applicable listing code. Listing certificates are issued by IAPMO R&T recognized jurisdiction. This recognition has been granted based upon the manufacturer's compliance to the applicable requirements of 2003 NFPA 72.</p>		
Producers are in compliance with the following contract:	<p>Contract # _____ National Firemarking Code of Canada</p>		
 John Collins General Manager, National Listing	 R. Ching Director, National Listing	 J. Smith Director, National Listing	

BEFORE INSTALLATION

NO.	Items	Qty
1	Upper outlet pipe	1
2	Top shower head	1
3	Hand-held shower head	1
4	Water inlet connection	1
5	Stand for hand shower head	1
6	Hexagon socket screw	4
7	Shower hose	1
8	Main body	1
9	Panel	1
10	Sleeve	3
11	Water diversion hand wheel	3
12	Accessory bag	1

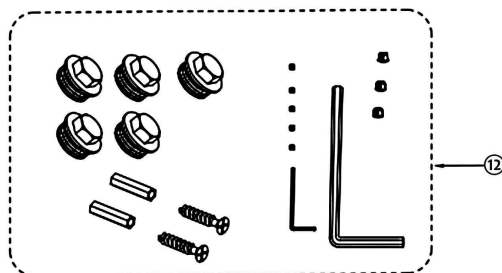
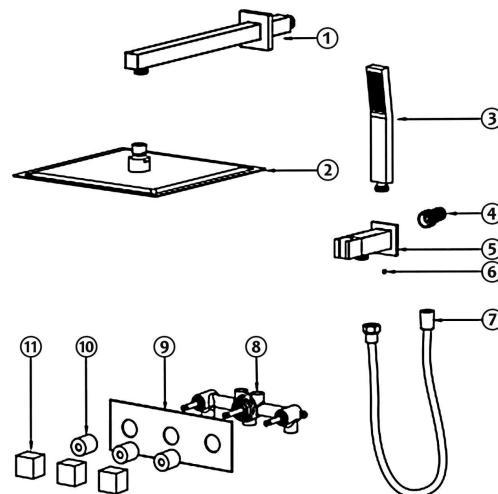

Check accessories

Standard List of Accessories:

When you open the product packaging, please check whether the objects in it are consistent with the main body and accessories you purchased. If there is any inconsistency, please contact our company or our distributor.

Note: 1. Accessories are subject to change without prior notice if the change does not affect usage;

2. The appearance of the product is subject to the physical objects you receive, and the schematic diagram is only for reference.

INSTALLATION STEPS

This product has been inspected and debugged by the factory to the best condition. Please do not disassemble and assemble it yourself.

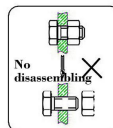

Before installing the faucet, please be sure to remove sundries and sludge from the water pipe to prevent sundries from blocking the faucet.

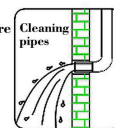

1. Dig pipe grooves for pre-burying pipes.

2. Install the main body, water inlet and outlet pipes.

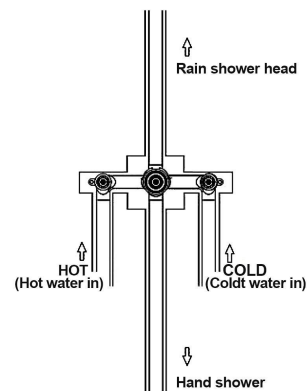
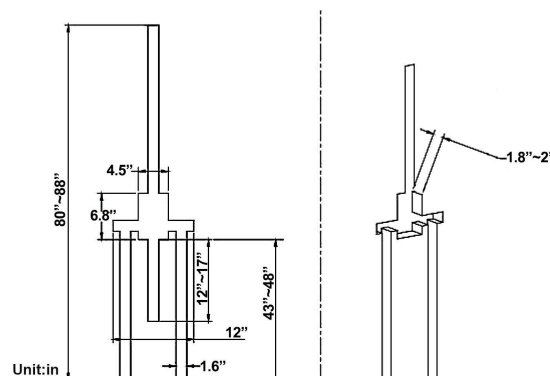

3. Fix the main body of the faucet with self-tapping screws (the main body must be flush with the wall).

4. Install the panel, sleeve and hand wheel in sequence.

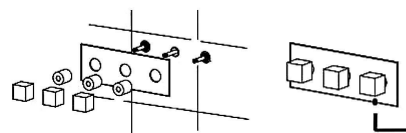
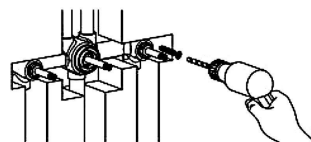

5. Install upper outlet pipe and top shower head. (wrap the PTFE tape on the thread)

6. Install the stand for hand-held shower head. (wrap the PTFE tape on the thread)

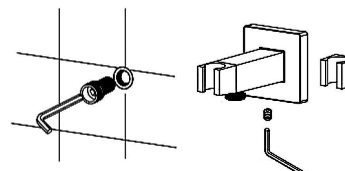
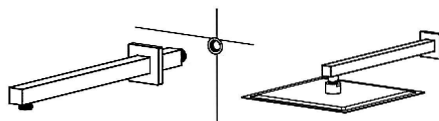

INSTALLATION STEPS

7. Finished

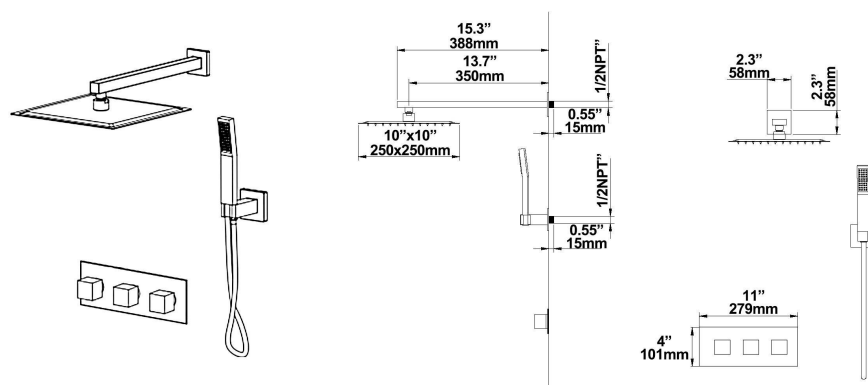

CLEANING CARE

In order to keep the appearance of faucet clean, bright and good performance, please take care of the faucet as follows;

1. Rinse with water only and dry with soft cotton cloth;
2. Use mild liquid and colorless glass cleaner to remove surface dirt and scale film, or use polish without abrasive effect;
3. Do not use abrasive detergent, polish, emery cloth, paper towel or scraper, etc.;
4. Do not use acid cleaner, or cleaner and soap with insoluble gran etc.;
5. In the process of use, mud may accumulate in the bubbler and make the water flow show. The bubbler can be unscrewed, rinsed with water, and then installed back in place.



Please feel free to contact us if you have any questions. We will help to solve the issue together with you. OUR EMAIL: services@rbrohant.com



**AQUA
GALLERY**

Service Contact:

+1(801) 800-9309

services@rbrohant.com

Made in China