

Installation Manual

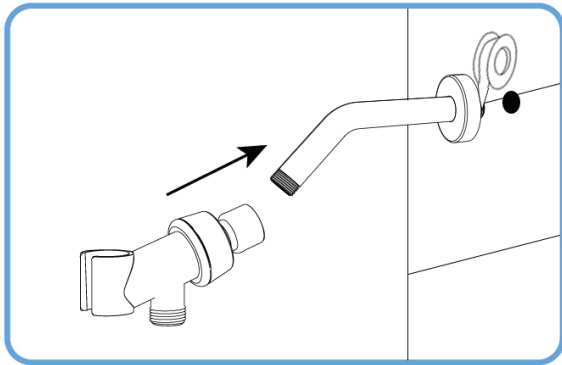

1. The longer side of the shower arm enters the wall (with Teflon), and the other end is connected to the shower bracket.

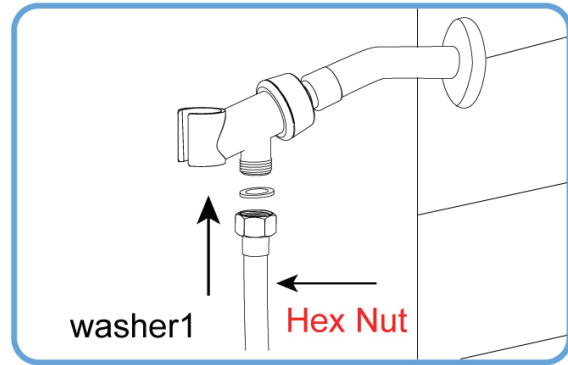

2. make sure to put a washer into the hex nut of hose and connect it to the bracket

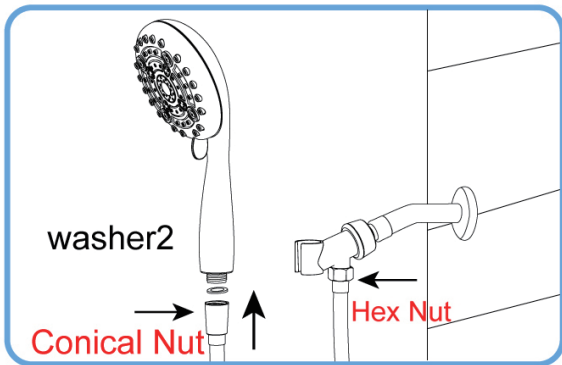

3. make sure to put a washer in to the conical nut of hose and connect it to handheld shower head

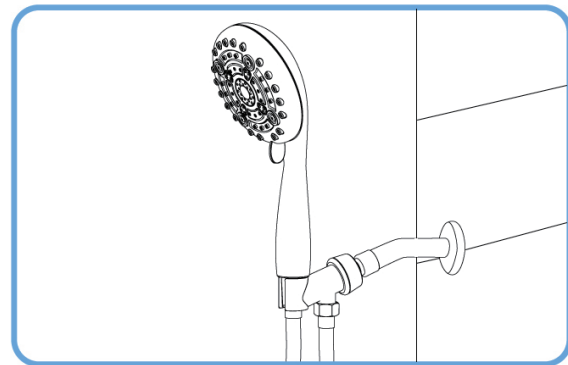

4. adjust the brass swivel ball joint of the bracket according to your need

Installing SR SUN RISE shower head

- Fasten the shower holder onto the shower arm and hand-tighten.
- Install the two black rubber washers provided at the two ends of the hose, this will prevent leaks.
- Connect one end of the hose with hex type screw to the shower holder and the other end with longer screw to the hand-held shower.
- Turn on shower and check for leaks. If leaks occur at the water outlet, use additional Teflon tape and carefully tighten with a wrench.

long screw to the hand held



hex type screw to shower holder

Customer	
Retail Store/Install Store	
Purchase Date	
Warranty Duration	3 years warranty since the purchase date.

IAPMO RESEARCH AND TESTING, INC.

5001 East Philadelphia Street, Ontario, California 91761-2816 – USA • 909-472-4100 • 909-472-4244 • www.iapmort.org



CERTIFICATE OF LISTING

IAPMO Research and Testing, Inc. is a product certification body which tests and inspects samples taken from the supplier's stock or from the market or a combination of both to verify compliance to the requirements of applicable codes and standards. This activity is coupled with periodic surveillance of the supplier's factory and warehouses as well as the assessment of the supplier's Quality Assurance System. This listing is subject to the conditions set forth in the characteristics below and is not to be construed as any recommendation, assurance or guarantee by IAPMO Research and Testing, Inc. of the product acceptance by Authorities Having Jurisdiction.

This certificate is not evidence of current listing. To verify listing status, visit the IAPMO R&T Product Listing Directory at pld.iapmo.org

Effective Date: April 2019 –Rev. 5/17/2019– Void After: April 2024
Product: Plumbing Fixture Fittings File No. 10053
Issued To: Xiamen Rainshower Co., Ltd.
No.8, Yong Feng Road, Xinglin
Jimei District
Xiamen, FUJIAN 361022
China

Identification: Plumbing supply fittings complying with this Standard shall be marked with the manufacturer's recognized name, trademark, or other mark or, in the case of private labeling, the name, trademark or other mark of the customer for whom the fitting was manufactured. The marking shall be accomplished by use of a permanent mark or by placing a permanent label on the product. Markings on plumbing supply fittings shall be visible after installation.

Single-handle, single-control, and automatic compensating mixing bath and shower valves shall have identifiable temperature control settings in which the settings are indicated by words ("cold", "warm", "hot", etc.), by numbers, or graphically.

Packages shall be marked with the manufacturer's name, trademark, or other mark as well as the model number or, in the case of private labeling, the name, trademark, or mark of the customer for whom the

Chairman, Product Certification Committee

CEO, The IAPMO Group

This listing period is based upon the last date of the month indicated on the Effective Date and Void After Date shown above. Any change in material, manufacturing process, marking or design without having first obtained the approval of the Product Certification Committee, or any evidence of non-compliance with applicable codes and standards or of inferior workmanship, may be deemed sufficient cause for revocation of this listing. Production of or reference to this form for advertising purposes may be made only by specific written permission of IAPMO Research and Testing, Inc. Any alteration of this certificate could be grounds for revocation of the listing. This document shall be reproduced in its entirety.

