

# Assembly Instructions

⚠ Before you throw the package, please ensure that you have all the parts needed for the assembly.

⚠ **Hardware Note:**  
1. Please **do not completely tighten** all the hardware, turn the bolts about **50%** by hand according to the AI step by step. Then adjust 4 legs when they are at same height, tighten all the bolts completely at last.

2. All the bolts should be assembled **vertically** to the holes.

⚠ **Spare parts** can be found in the hardware box if you do not have enough parts to assemble.

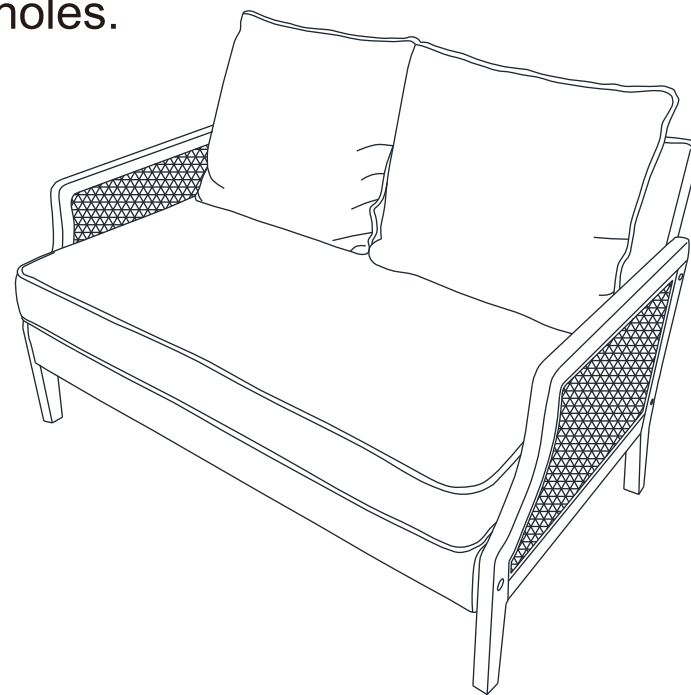

⚠ THIS INSTRUCTION BOOKLET CONTAINS IMPORTANT SAFETY INFORMATION. PLEASE READ AND KEEP FOR FUTURE REFERENCE.

# Assembly Instructions

## Parts and Hardware

Please check to make sure you have all parts and hardware before starting assembly process.

Ⓐ

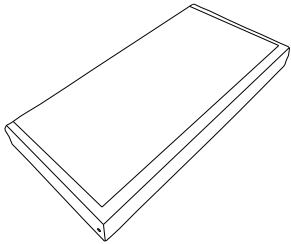

Seat 1pc

Ⓑ

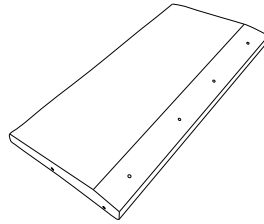

Back 1pc

Ⓒ

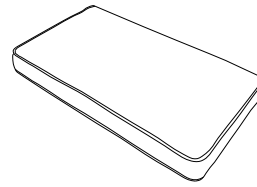

Seat Cushion 1pc

Ⓓ

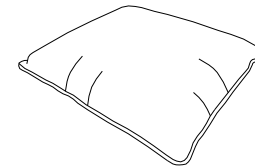

Back Cushion 1pc

Ⓔ

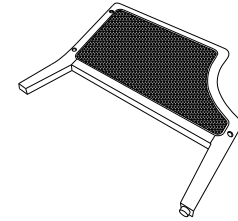

Left arm 1pc

Ⓕ

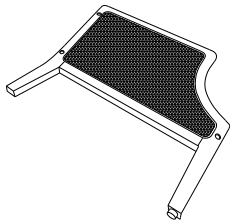

Right arm  
1pc

①

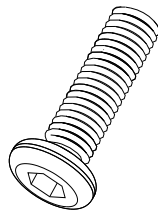

Large bolt  
10pcs

②

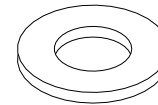

Large flat washer  
4pcs

③

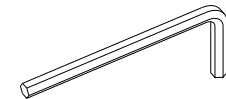

Wrench  
1pc

# Assembly Instructions

## Assembly Instructions

**Do not tighten any single bolt until all bolts are assembled.**

Step 1: Take out back cushion from the inner side of seat. Assemble back to seat.

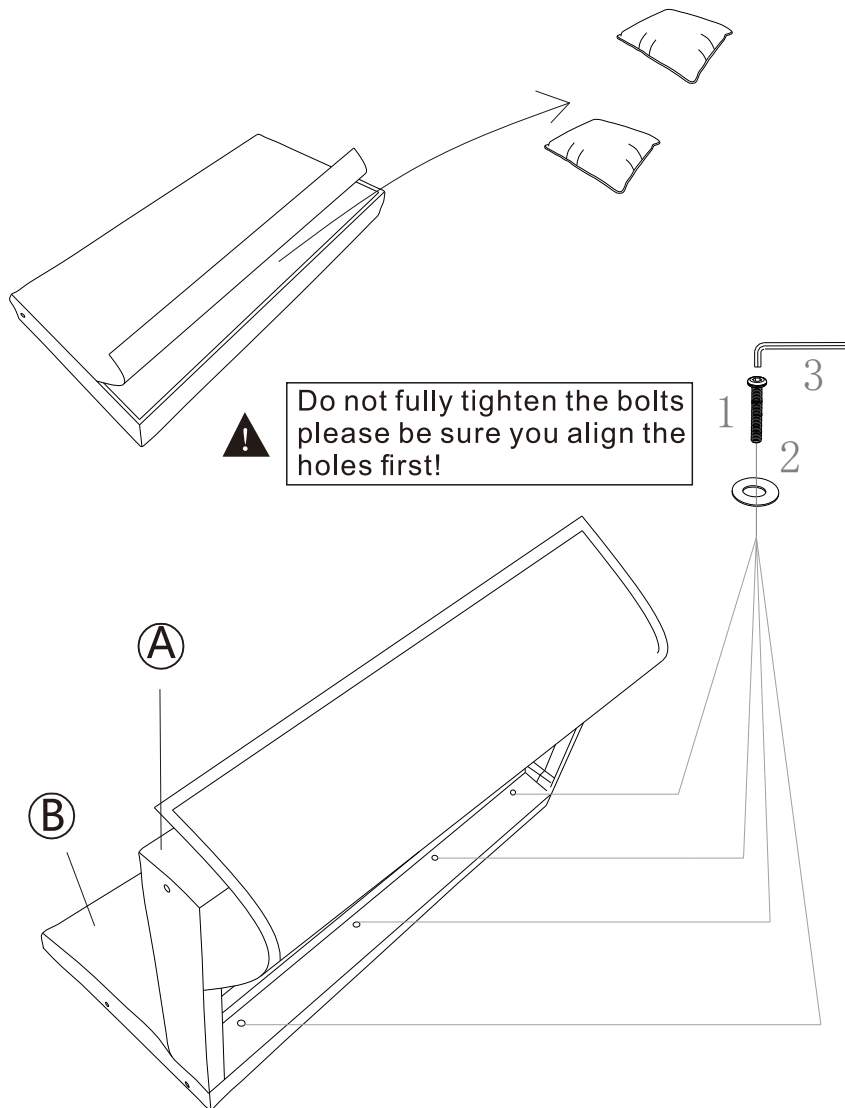

Step 2: Assemble arms to the side of seat and back. Do not fully tighten the bolts until all of them are all align to the holes then fully tighten them by the short side of wrench.(include step1)

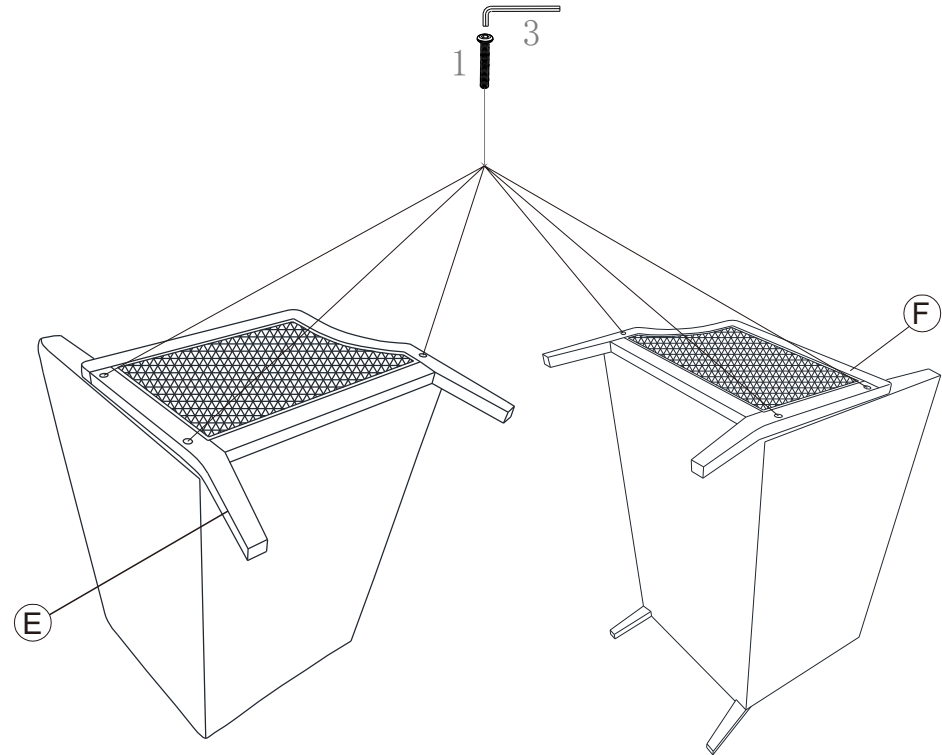

**Put arms on soft and flat place, please.**

# Assembly Instructions

## Assembly Instructions

Do not tighten any single bolt until all bolts are assembled.

Step 3: Put seat cushion and back cushion to the seat and back.

