

ASSEMBLY INSTRUCTIONS

MADE IN CHINA

Parts and Hardware

Please check to make sure you have all parts before starting assembly process.
(Attention: The legs & Hardware can be found in the bottom of seat)

- (A)
- (B)
- (C)
- (D)
- (E)

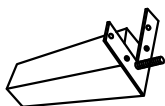
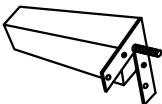
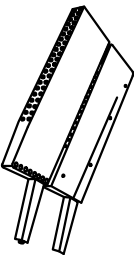
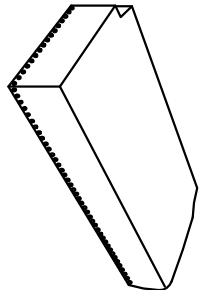
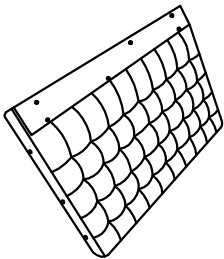

x 1
Back Cushion

x 1
Seat Cushion

x 2
Back Cushion Wings

x 2
Left Legs

x 2
Right Legs

- (F)
- (G)
- (H)
- (I)
- (J)
- (K)
- (L)

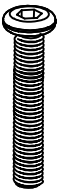

x 14
Allen Head Bolts
5/16*65mm

x 4
Allen Head Bolts
1/4*20mm

x 14
Flat washers

x 4
Flat washers

x 14
Springs washers

x 2
Plastic washers

x 1
Allen wrench

ASSEMBLY INSTRUCTIONS

MADE IN CHINA

Assembly Instructions

STEP 1:

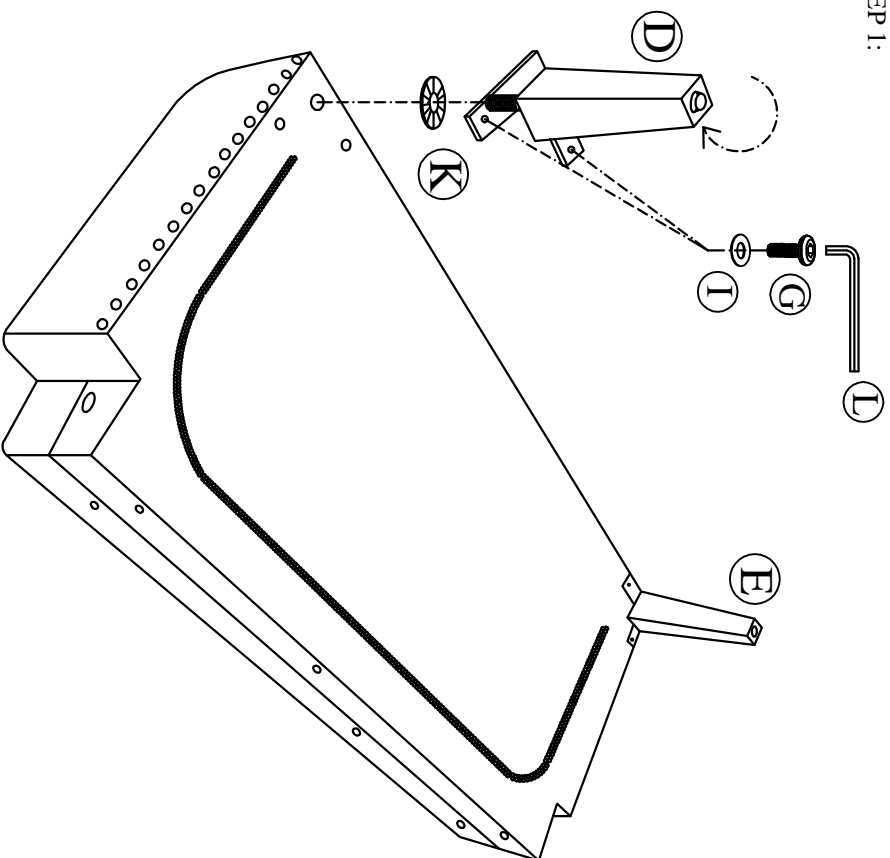

STEP 2:

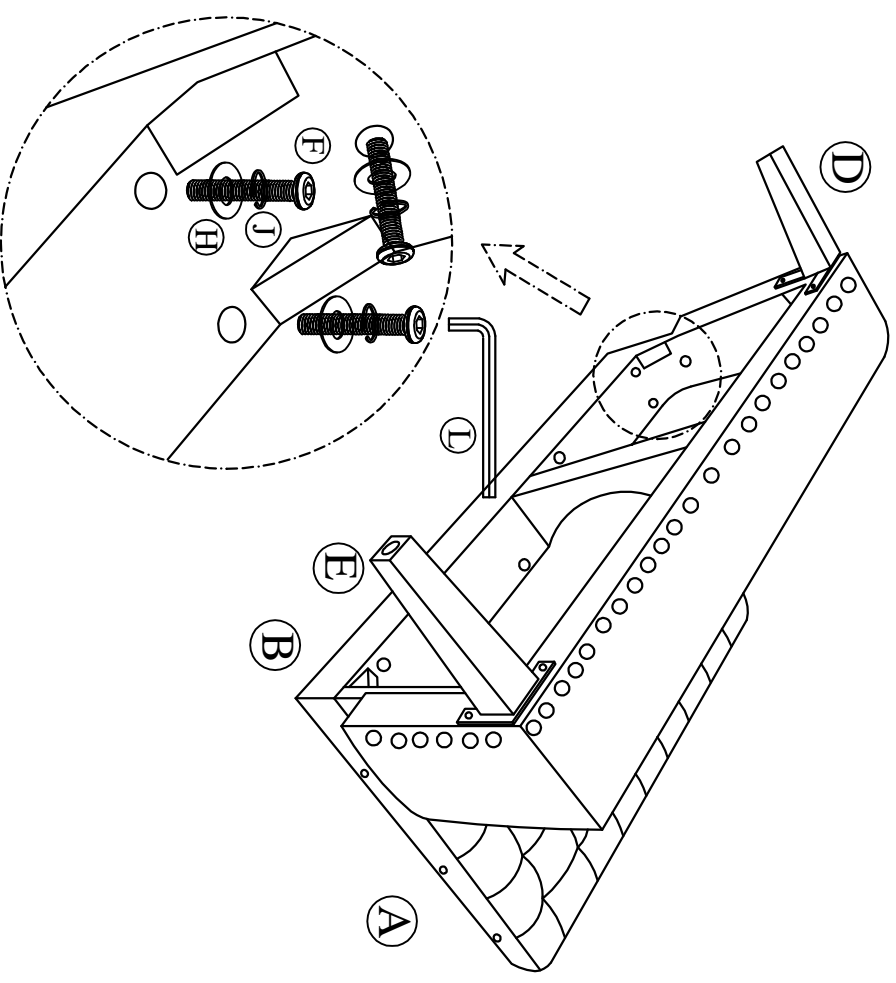

ASSEMBLY INSTRUCTIONS

MADE IN CHINA

Assembly Instructions

Please read and understand all assembly instructions before beginning assembly process.
Do not tighten any single bolt until all bolts in holes on each step

STEP 3:

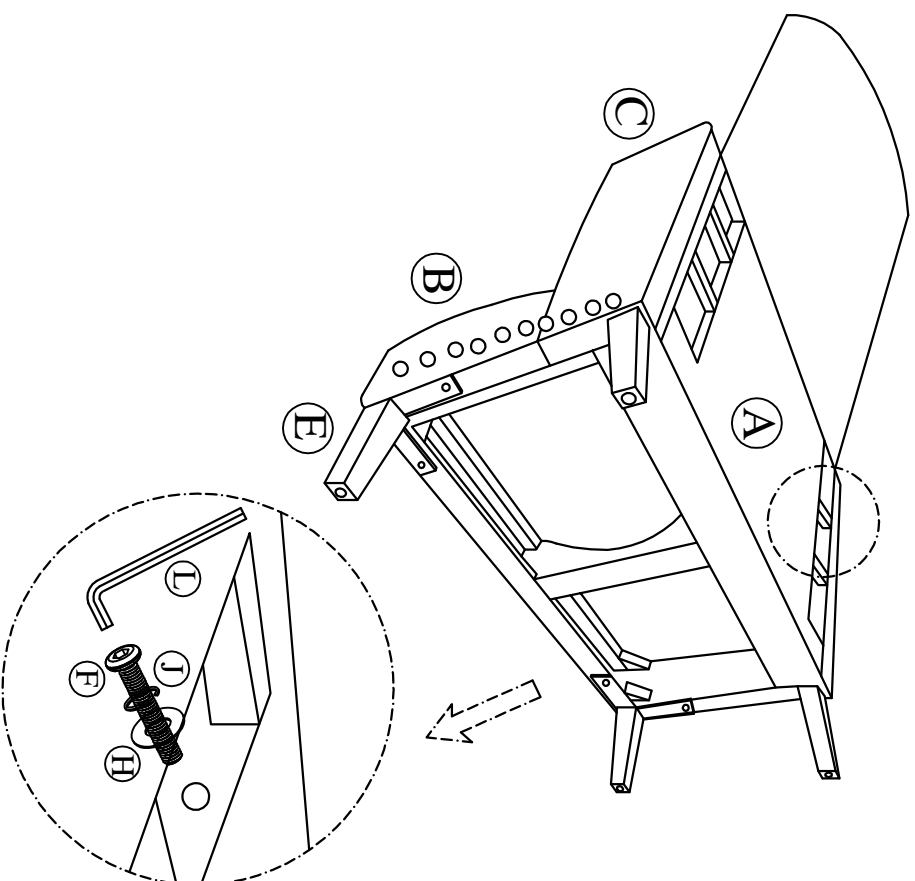

STEP 4:

