

# INSTALLATION GUIDE

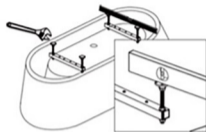

Move the bathtub into the desired location and mark on the floor along bathtub's bottom.



Loosen the nuts, washers from the metal frame. Adjust the leveling feet to align with bottom level the tub with the floor, tighten t washers ,nuts.

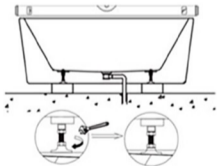

Move the bathtub back into the desired location and put the drain hose into the floor drain.



Apply silicone along the bottom of the bathtcreate airtight seal.