

## 3 Tier Corner Bookshelf

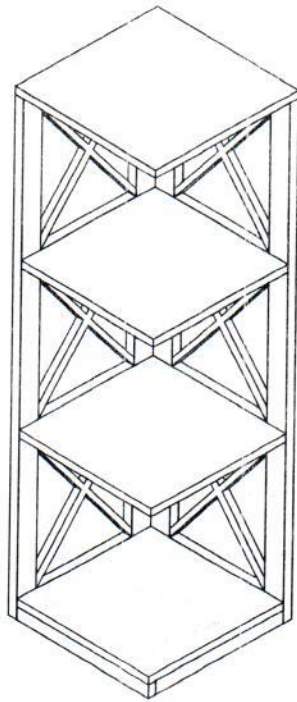

## Assembly Instructions

We have designed our furniture with you, the customer in mind. Our clear, easy to follow step by step instructions will guide you through the project from start to finish.

Feel confident that this will be a fun and rewarding project. The final product will be a quality piece of furniture that will go together smoothly and give years of enjoyment.

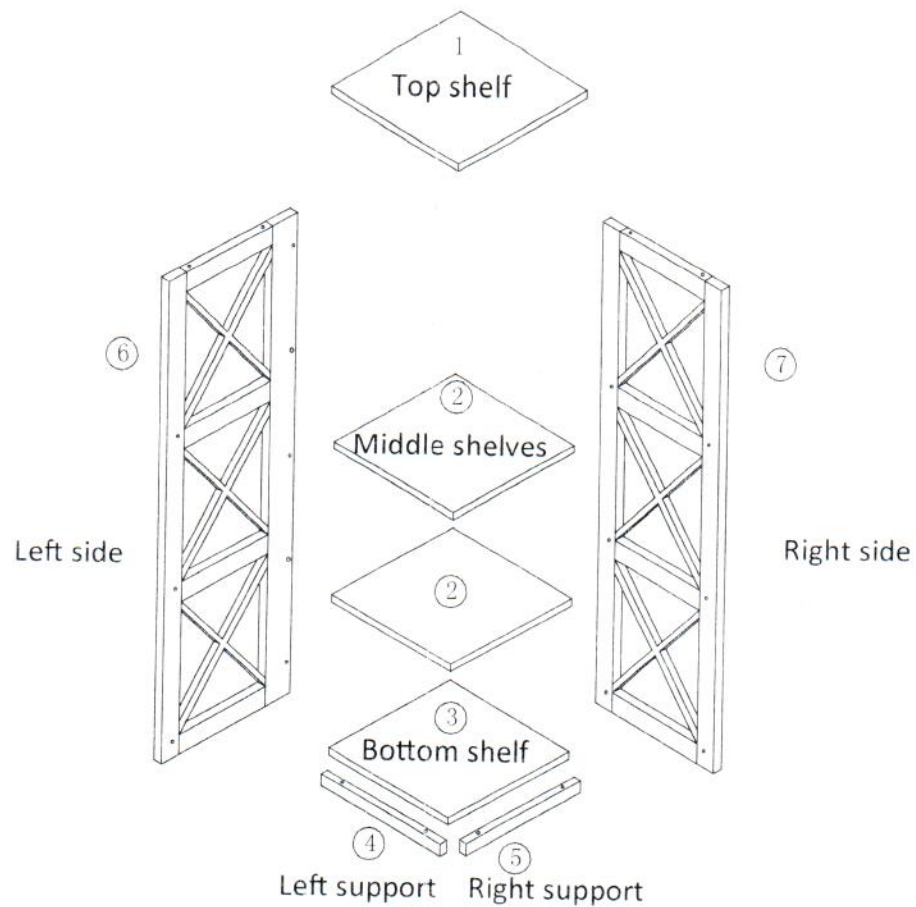

#### Assembling the unit with cams and wood dowels.

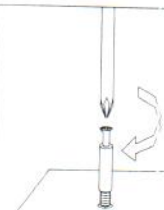

Gently screw cam dowel into the threaded anchor.

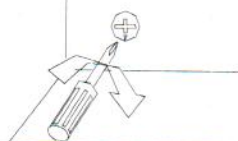

Insert cam lock with arrow pointing down. Screw the cam firmly into locked position.

## Step 1

- ① Attach supports (4) and (5) to lower shelf (3).

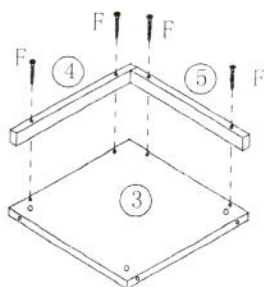

- ② Attach right side (7) to middle and lower shelves (2) and (3) using bolts and lock nuts.

NOTE: Threads of lock nut must face bolt hole.

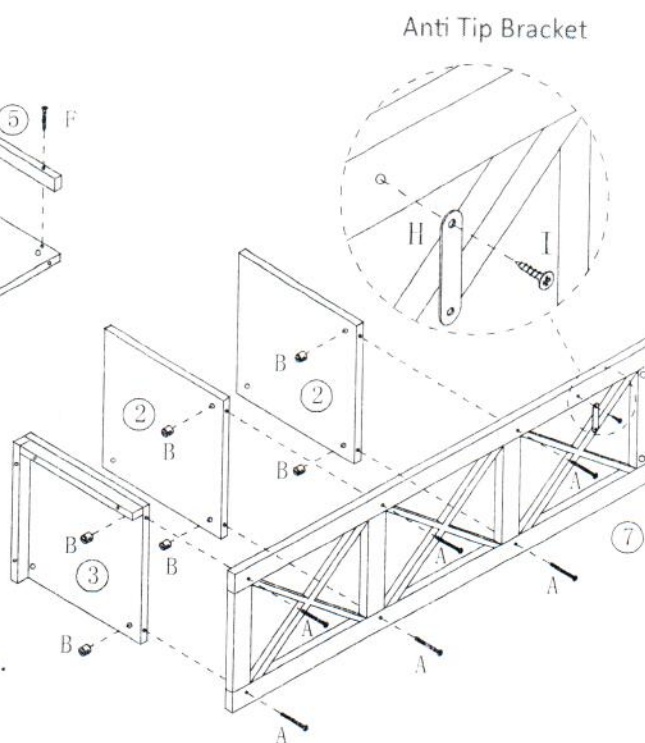

## Step 2

- ① Attach left side (6) to assembly using bolts and lock nuts.

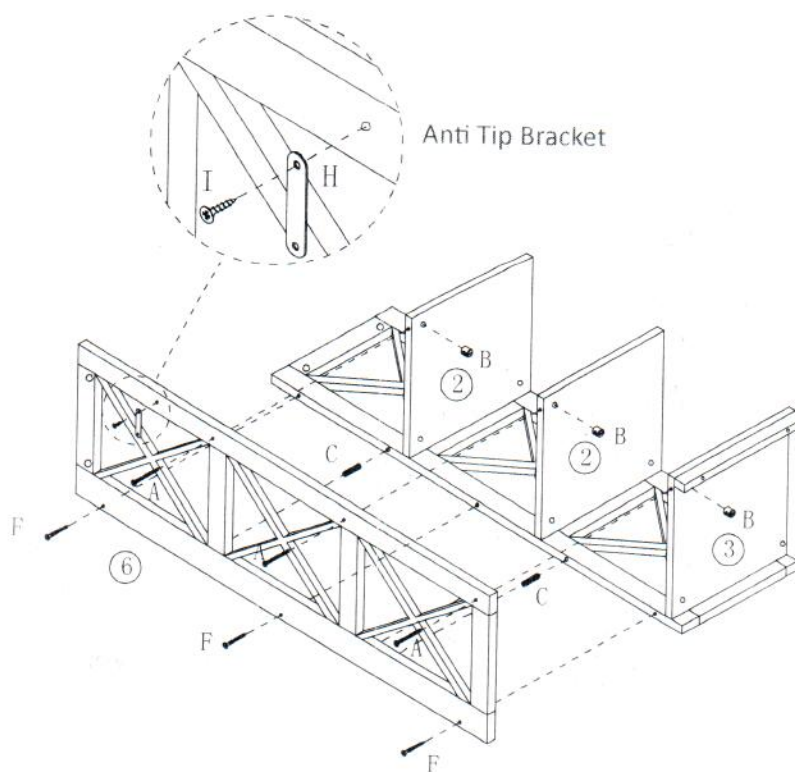

### Step 3

① Attach top shelf (1) to assembly using camlocks and cam bolts. Refer to page 2 for camlock/bolt instructions.

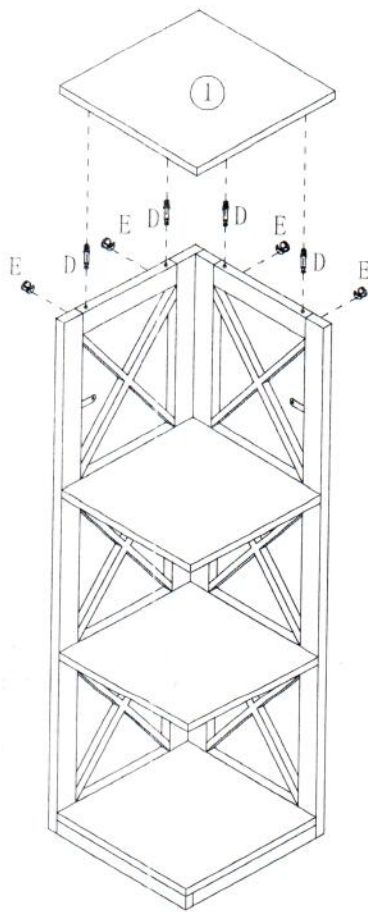

### Step 4

- ① Place unit into desired location and mark anti-tip bracket holes with pencil, remove unit.
- ② Drill holes into wall and carefully tap anchors (G) into wall.
- ③ Place unit position, and fasten to wall using screws, bracket and anchors as shown.

