

ASSEMBLY INSTRUCTIONS

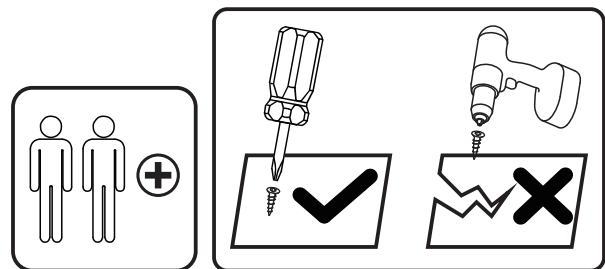
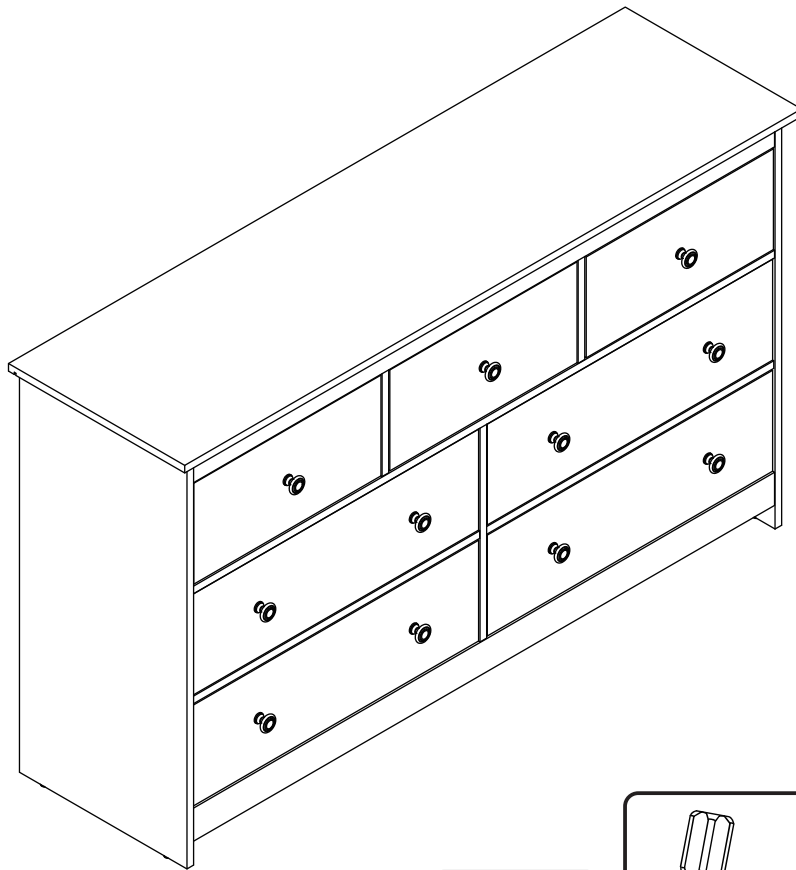

Tools Recommended

THIS INSTRUCTIONS CONTAINS IMPORTANT SAFETY INFORMATION.
PLEASE READ BEFORE ASSEMBLY AND KEEP FOR FUTURE REFERENCE.

IMPORTANT NOTICE

- This product contains small components, please ensure that they are kept away from small children.
- THIS INSTRUCTIONS CONTAINS IMPORTANT SAFETY INFORMATION. PLEASE READ BEFORE ASSEMBLY AND KEEP FOR FUTURE REFERENCE.
- Read each step carefully. It is very important that each step of instruction is performed in the correct order. If these steps are not followed in sequence, assembly difficulties will occur.
- Make sure all parts are included. Most parts are labelled or stamped on the raw edge.
- Work in spacious area, preferably on a carpet, near the place the unit will be used.
- Do not use power tools to assemble your furniture. Power tools may strip or damage the parts.
- Move your new furniture carefully, with two people lift and carry the unit to it's new location.
- Never push, drag or pull your furniture (especially on carpet)



PLEASE DO NOT RETURN PRODUCT TO US IMMEDIATELY

If a part is missing or damaged, email our customer service. We will gladly ship your replacement parts.

For Prompt, reliable service, please have your assemble instruction ready

 WARNING!	
	Children have died from furniture tipover. To reduce the risk of furniture tipover: <ul style="list-style-type: none">• ALWAYS install anti-tip device provided.• NEVER put a TV on this product.• NEVER allow children to stand, climb or hang on any drawers, doors, or shelves.• NEVER open more than one drawer at a time.• Place heaviest items in the lowest drawers.
	<p>This is a permanent label. Do not remove!</p>

Total number of boards required for this product: 59pcs

Includes frame plate: 19pcs

part 1*1pcs

part 4*1pcs

part 7*1pcs

part 10*1pcs

part 13*1pcs

part 16*1pcs

part 2*1pcs

part 5*2pcs

part 8*2pcs

part 11*1pcs

part 15*2pcs

part 26*1pcs

part 3*1pcs

part 6*1pcs

part 9*1pcs

part 12*1pcs

Includes feet: 1pcs

part 14*1pcs

Includes drawer board: 39pcs

part 17*7pcs

part 20*3pcs

part 23*4pcs

part 18*7pcs

part 21*3pcs

part 24*4pcs

part 19*3pcs

part 22*4pcs

part 25*4pcs

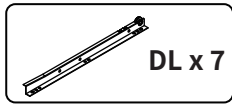
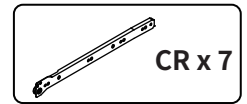
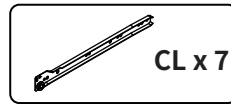
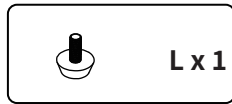
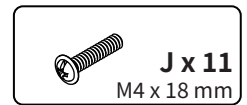
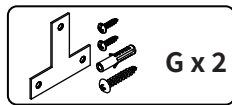
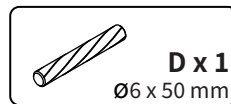
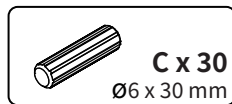
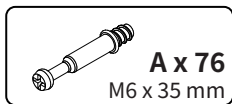
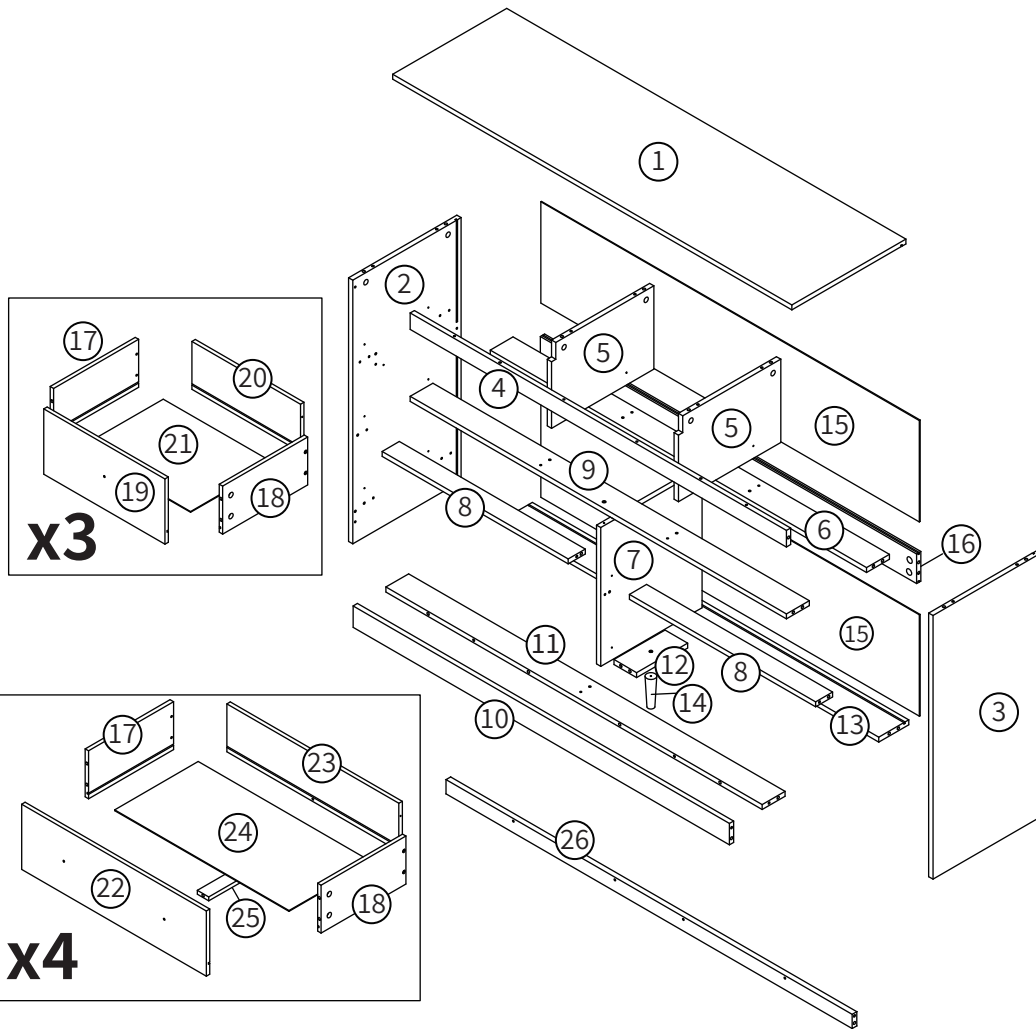

Step 1

Lock screw **(A)** on the part **①**, **⑩**, **⑪** and **⑬**. The installation position is as shown in the figure below.

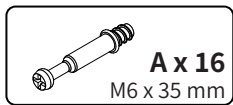
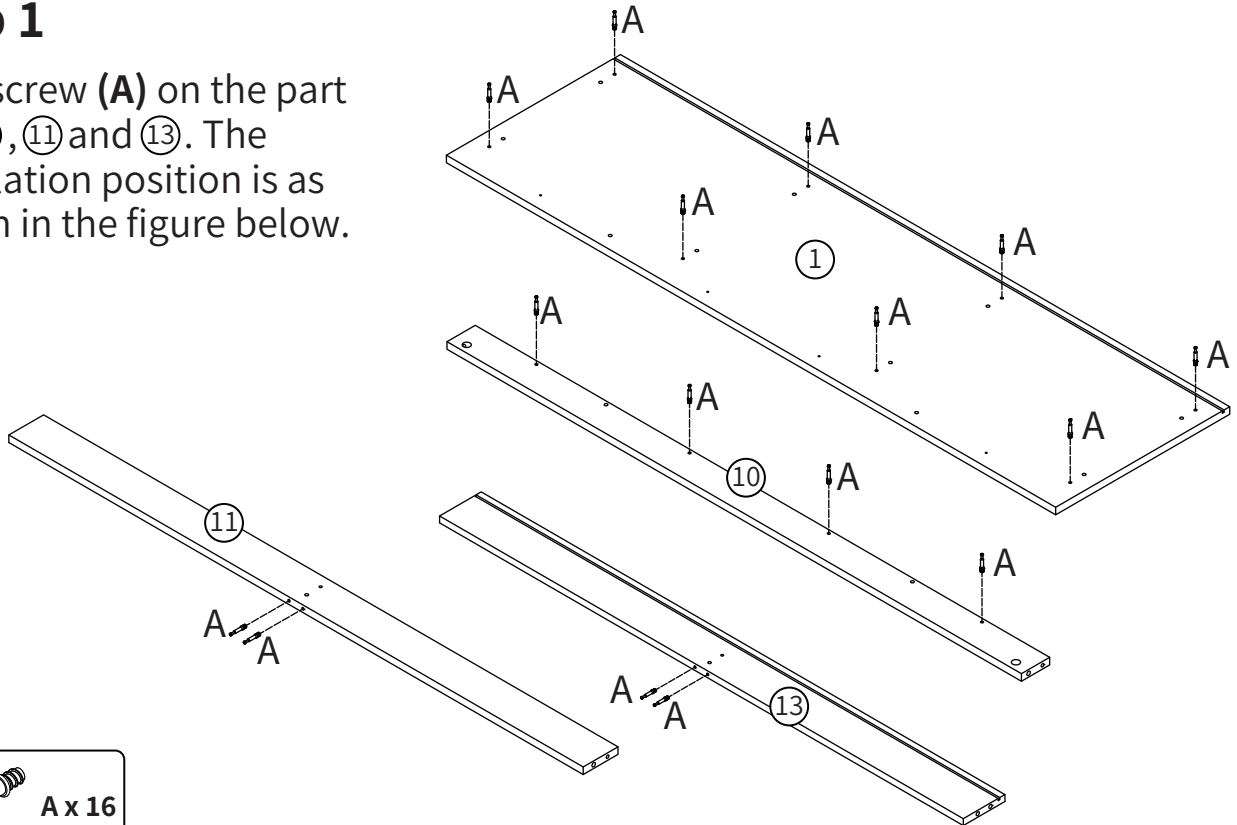

Step 2

Lock screw **(A)** and foot pad **(M)** on the part **②** and **③**. Lock the guide rail **(CL)** to the part **②** with the screw **(H)**, then lock the guide rail **(CR)** to the part **③** with the screw **(H)**. The installation position is as shown in the figure below.

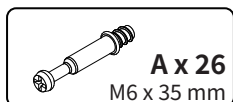
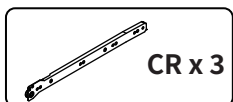
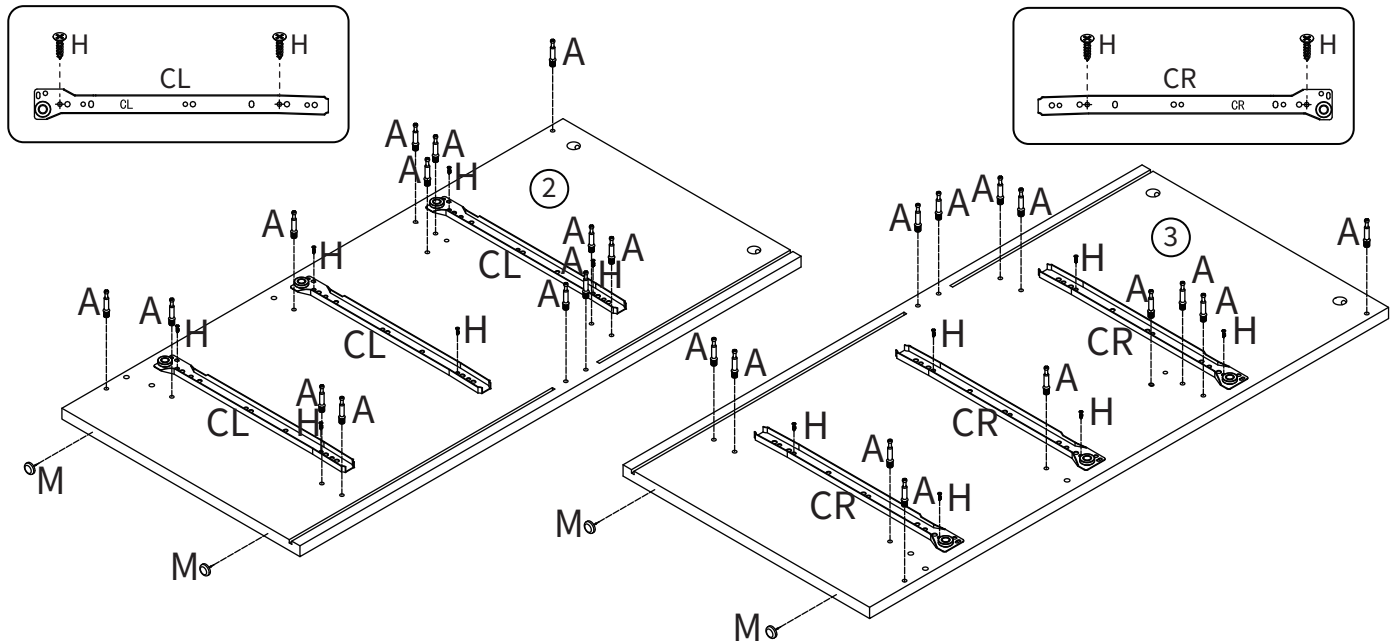

Step 3

First lock the guide rail (**CL**) to the right side of the part ⑤ with the screw (**H**), then turn it 180 degrees and lock the guide rail (**CR**) to the left side of the part ⑤ with the screw (**H**), the installation position is as shown below.

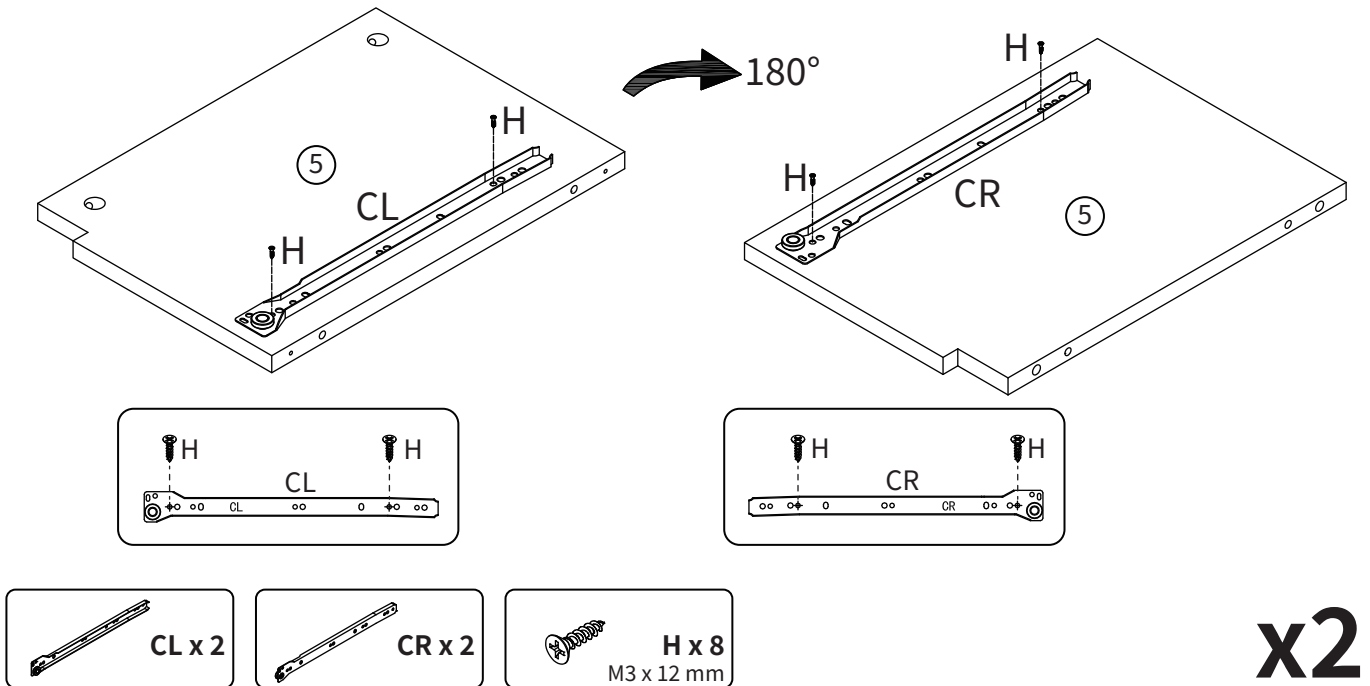

Step 4 First lock screw (**A**) and lock the guide rail (**CL**) to the right side of the part ⑦ with the screw (**H**), then turn it 180 degrees, lock screw (**A**) and lock the guide rail (**CR**) to the left side of the part ⑦ with the screw (**H**), the installation position is as shown below.

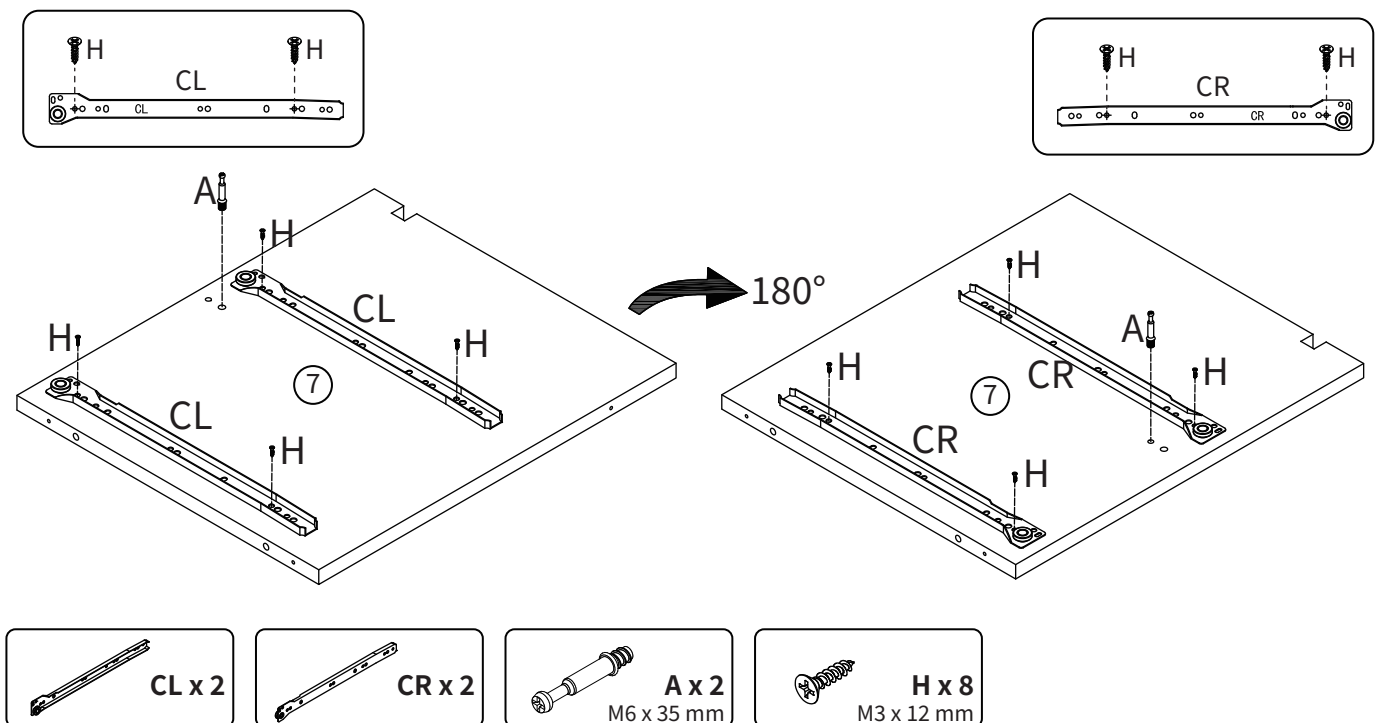

Step 5

Insert the dowel (C) into part ⑪ first, Then assemble parts ⑩ and ⑪, put eccentric (B) into the corresponding hole, and tighten it with screw (A) by turning it clockwise with a screwdriver. The installation position is as shown below.

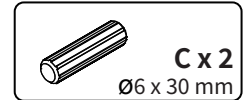
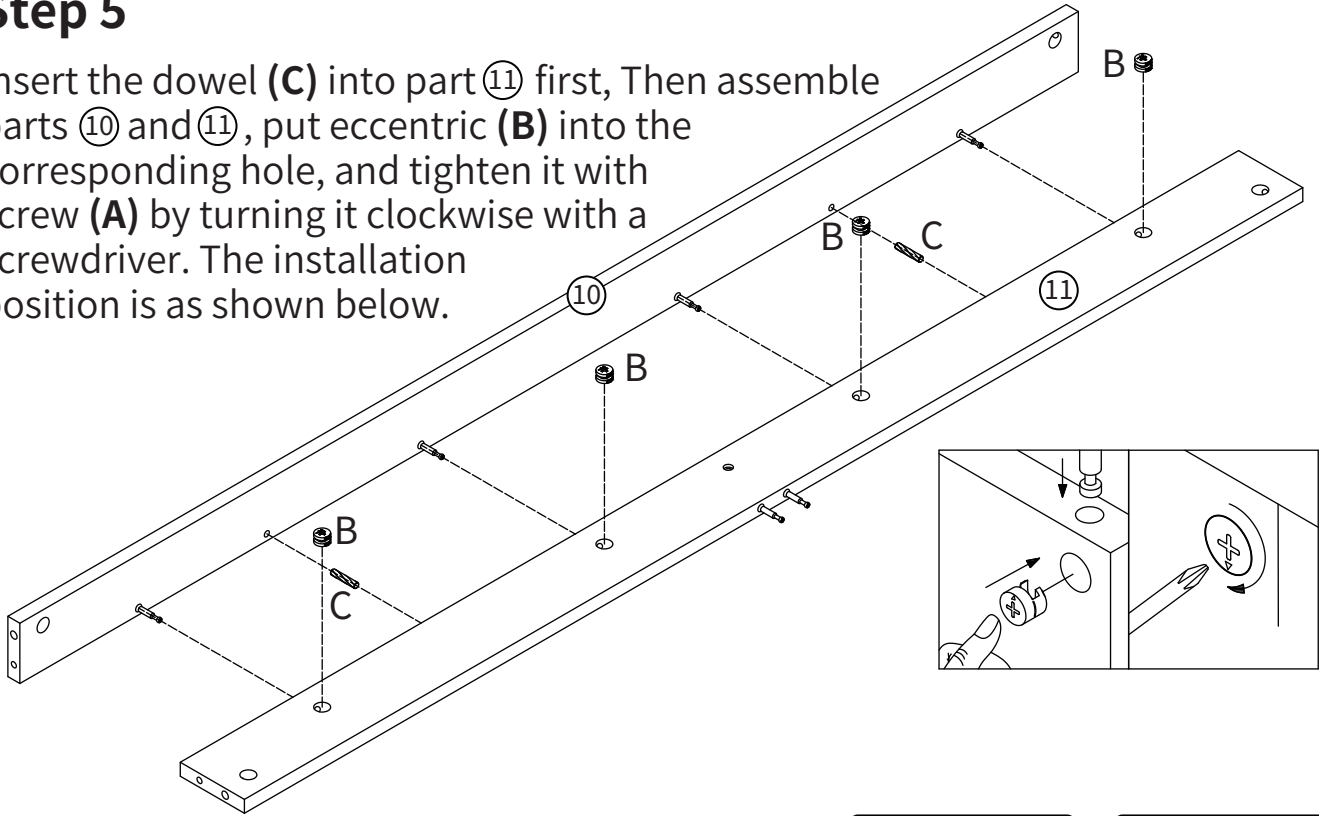

Step 6 First use screw (E) through the part ⑫ to lock the part ⑭, then use (L) to lock the part ⑭. And use the screw (E) to lock part ⑨ and part ⑳. The installation position is as shown below.

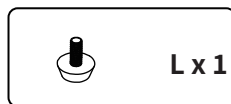
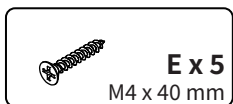
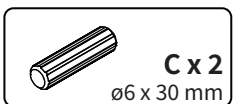
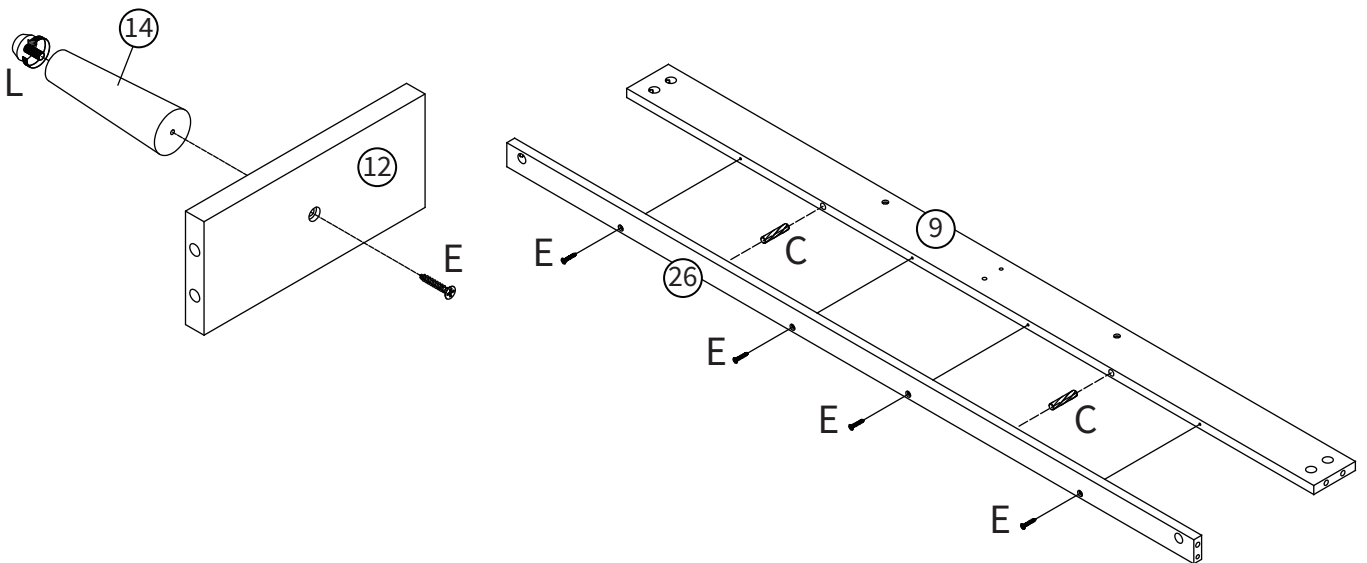

Step 7

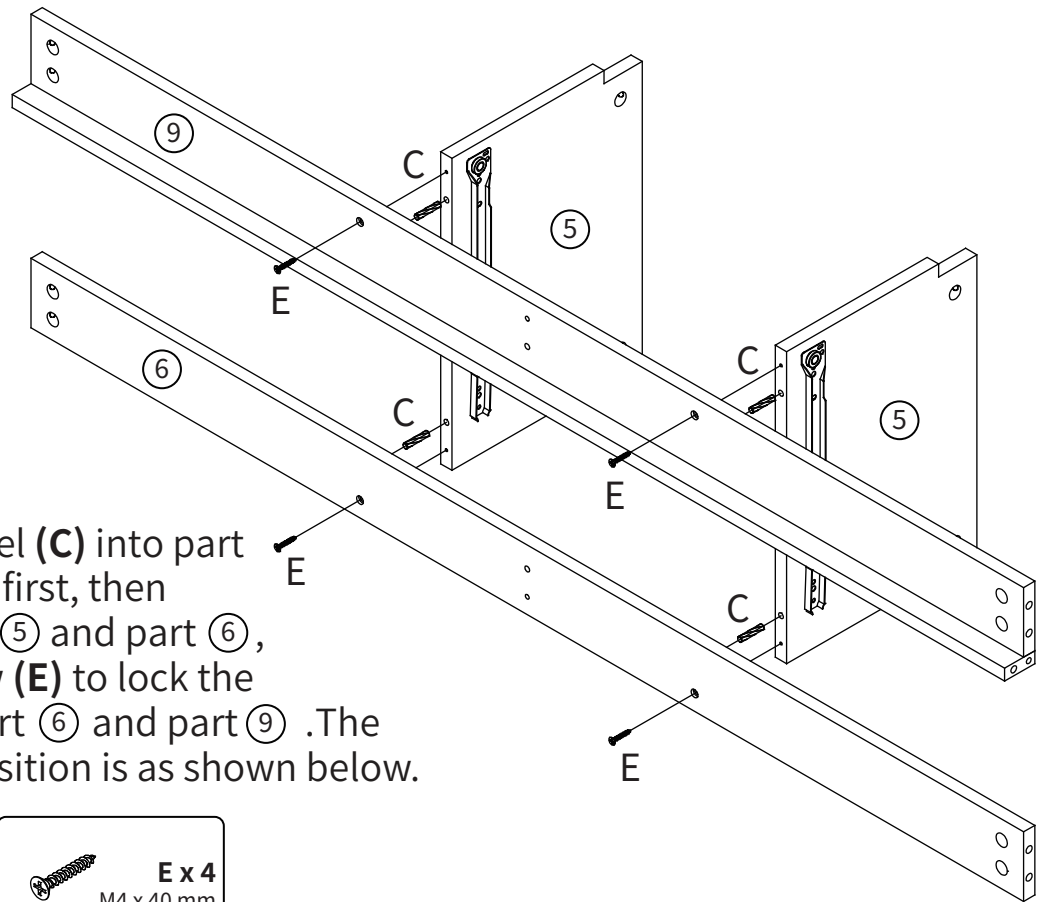

Insert the dowel **(C)** into part **(6)** and part **(9)** first, then assemble part **(5)** and part **(6)**, then use screw **(E)** to lock the part **(5)** with part **(6)** and part **(9)**. The installation position is as shown below.

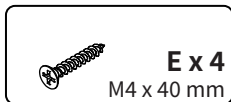
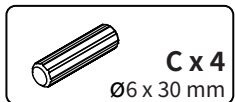

Step 8

Use screw **(E)** to lock the part **(7)** and part **(16)**. The installation position is as shown below.

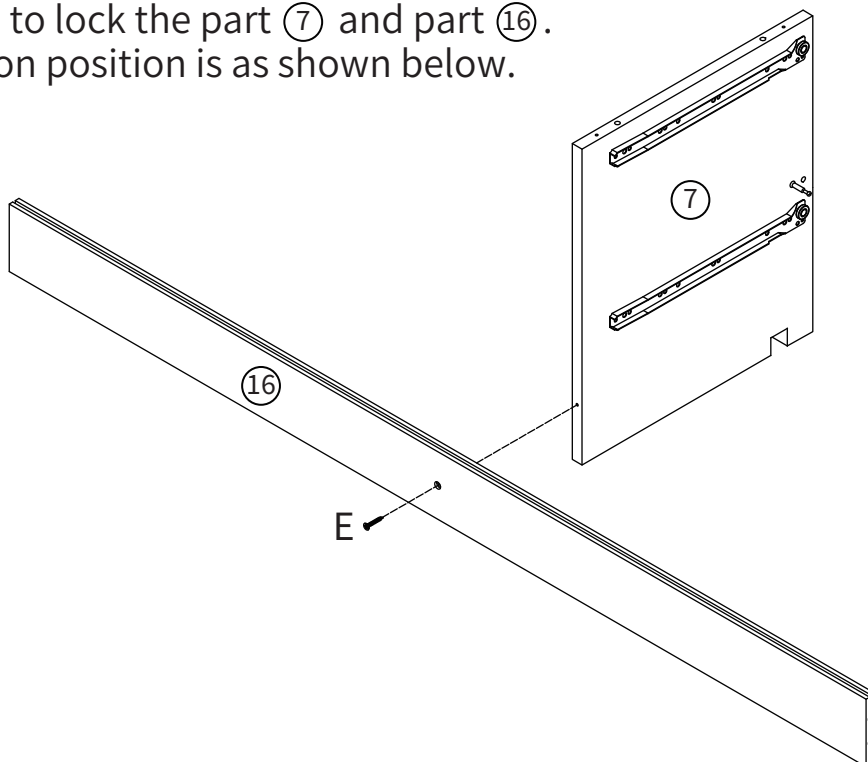

Step 9

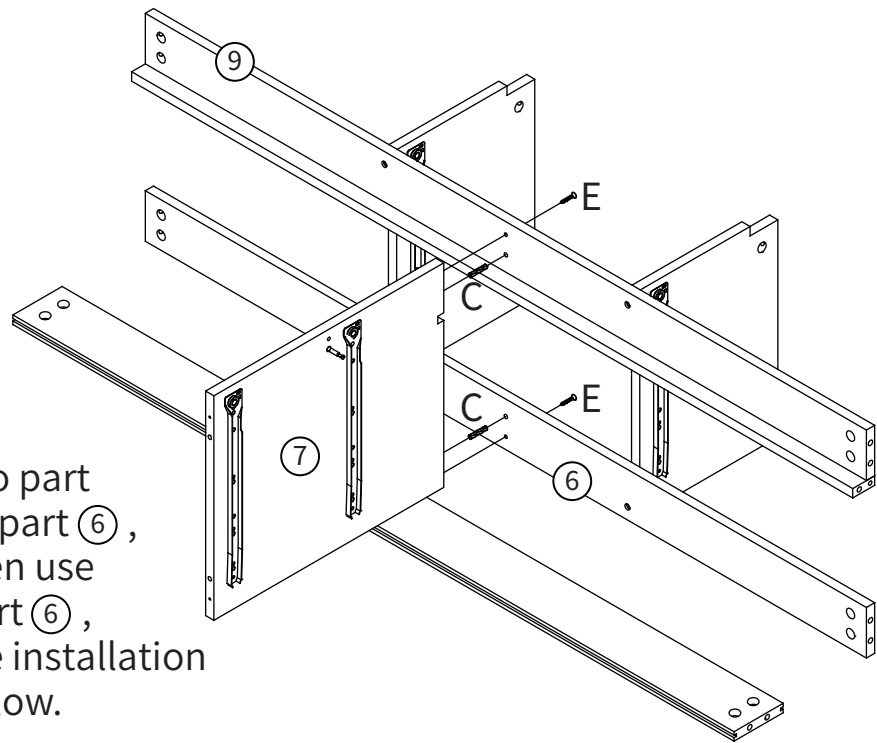

Insert the dowel **(C)** into part **(7)** first, then assemble part **(6)**, part **(9)** and part **(7)**, then use screw **(E)** to lock the part **(6)**, part **(9)** and part **(7)**. The installation position is as shown below.

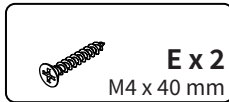
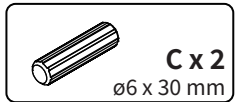

Step 10

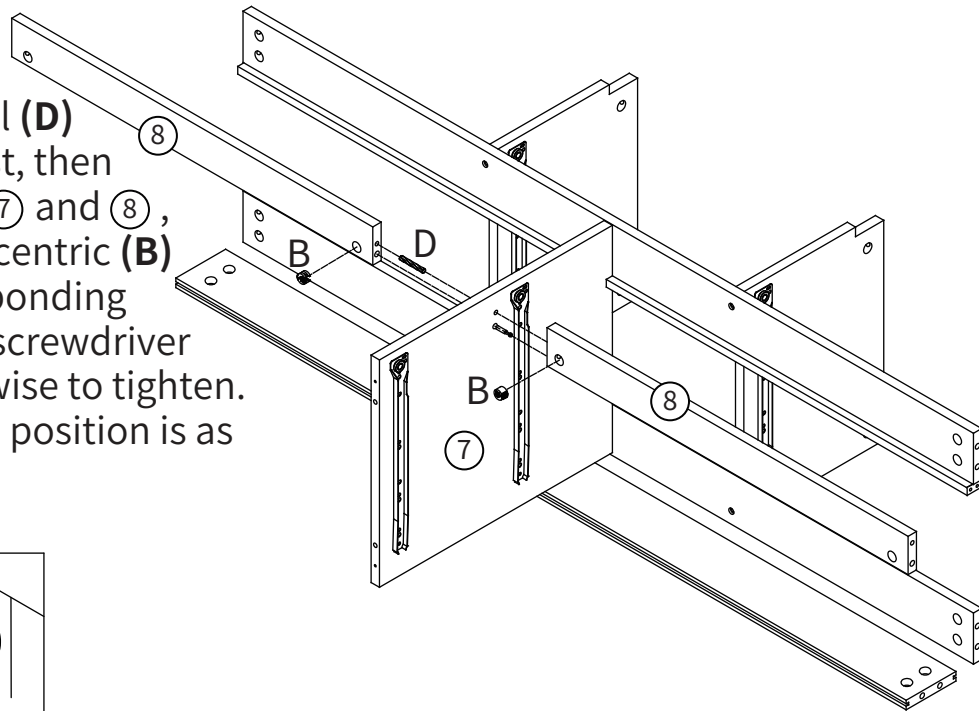

Insert the dowel **(D)** into part **(7)** first, then assemble part **(7)** and **(8)**, then put the eccentric **(B)** into the corresponding hole and use a screwdriver to turn it clockwise to tighten. The installation position is as shown below.

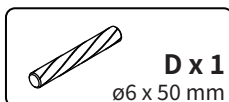
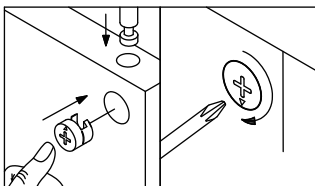

Step 11

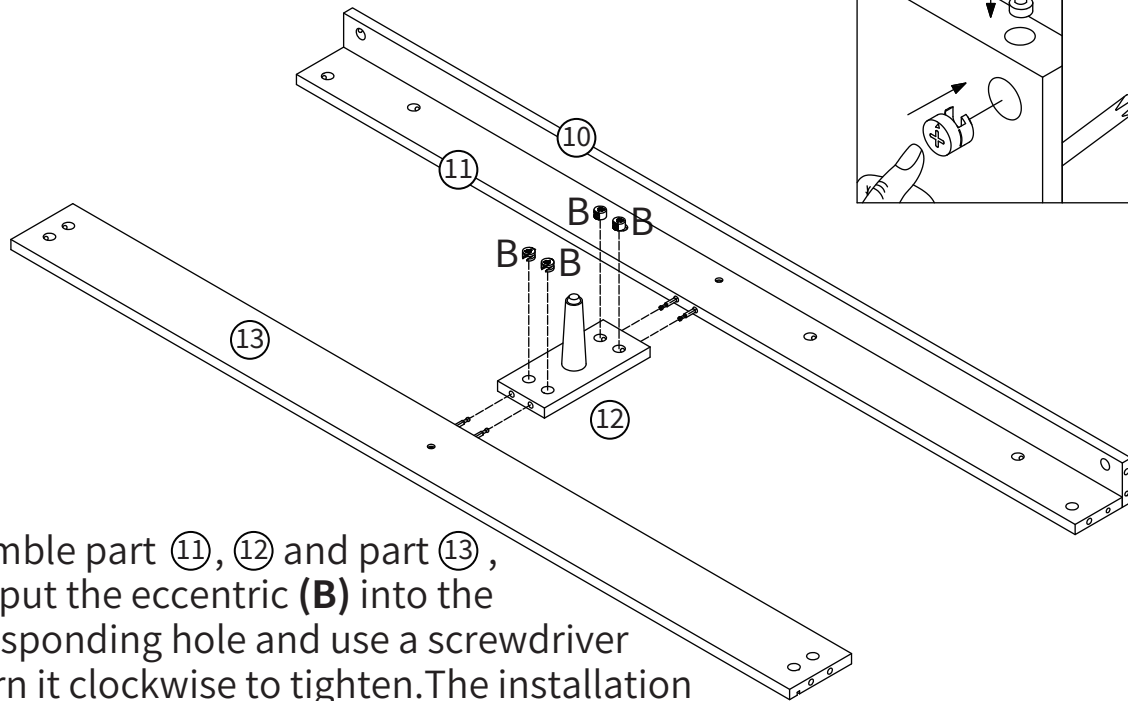

Assemble part ⑪, ⑫ and part ⑬, then put the eccentric (**B**) into the corresponding hole and use a screwdriver to turn it clockwise to tighten. The installation position is as shown below.

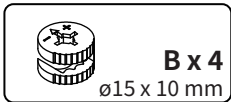

Step 12

Insert the dowel (**C**) into part ⑦ first, then assemble part ⑦, ⑪ and part ⑬, then use screw (**E**) to lock the part ⑦, ⑪ and part ⑬. The installation position is as shown below.

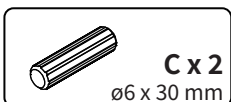
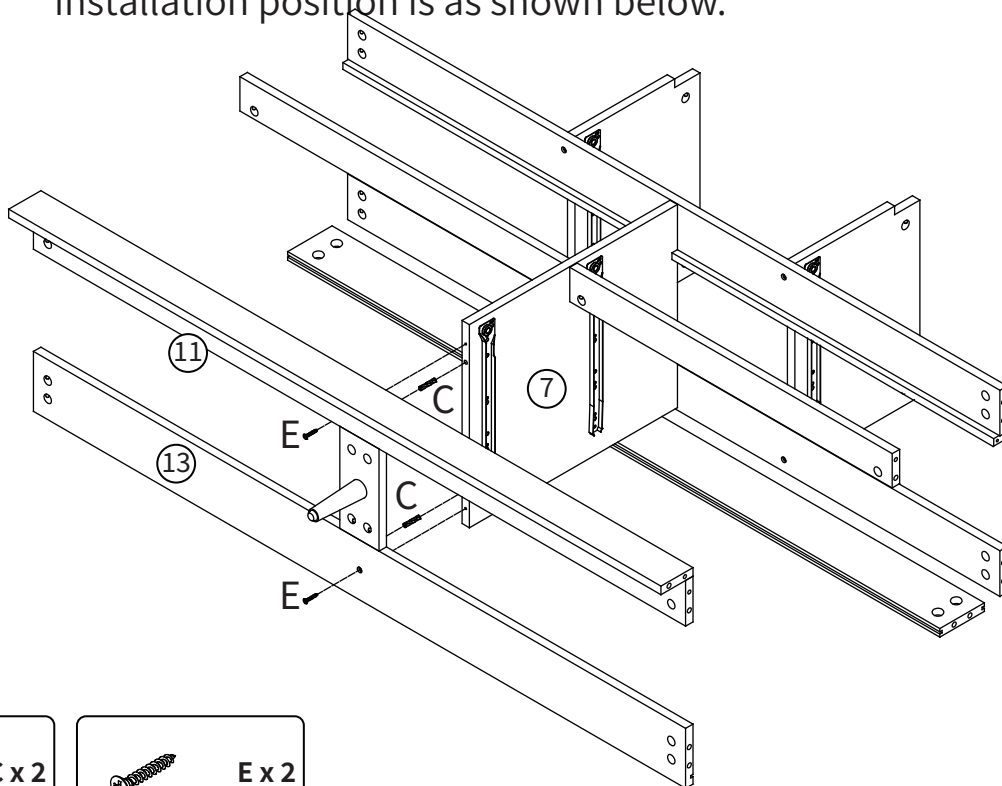

Step 15

Insert the dowel (C) into part ③ first, then assemble part ④, ⑥, ⑧, ⑨, ⑩, ⑪, ⑬, ⑬, ⑬, ⑬, ⑬, ⑬ and part ③. Put the eccentric (B) into the corresponding hole and use a screwdriver to turn it clockwise to tighten. The installation position is as shown below.

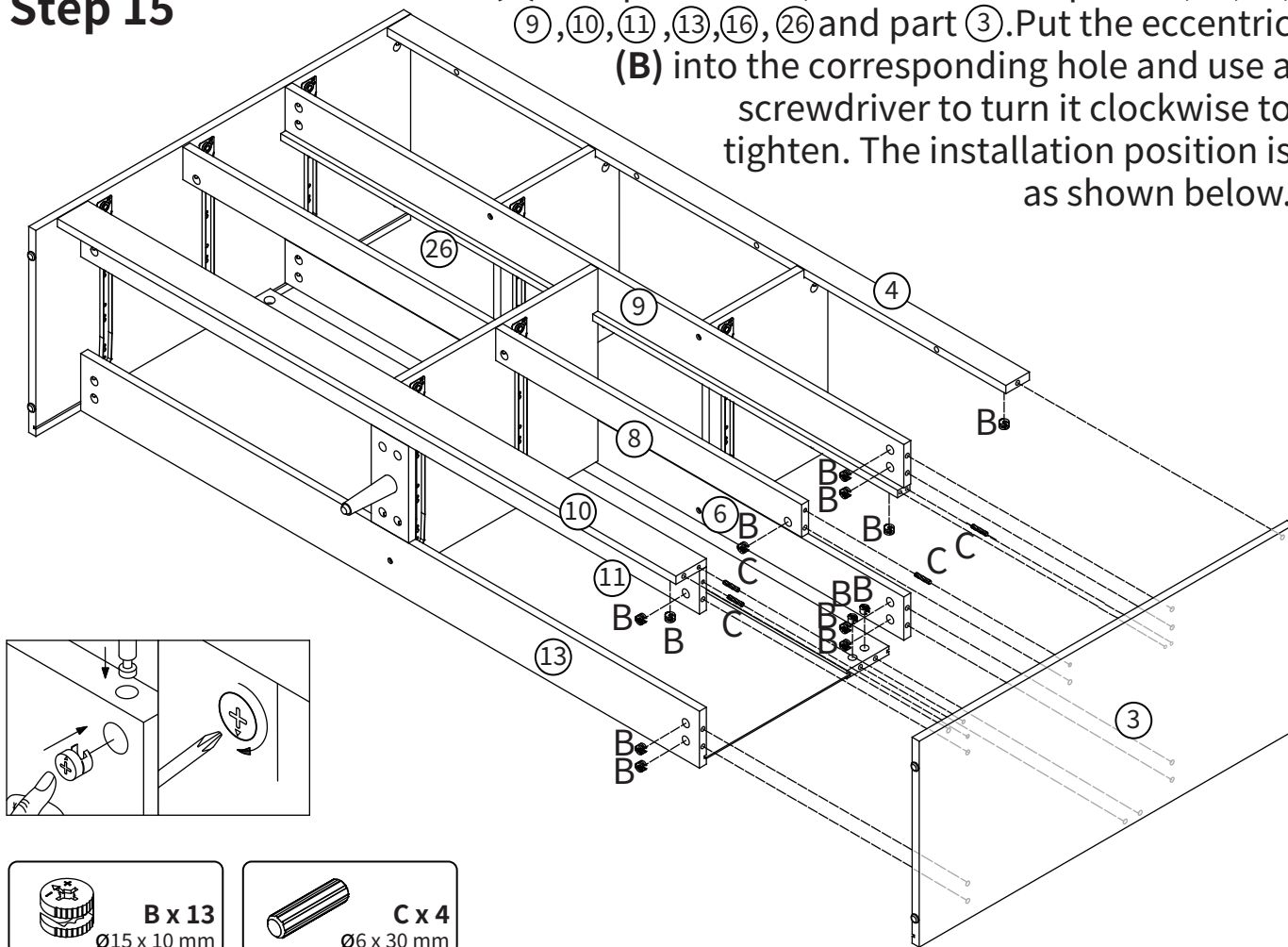

Step 16

Insert the part ⑮ into the slots of the parts ② and ③. The installation position is as shown below.

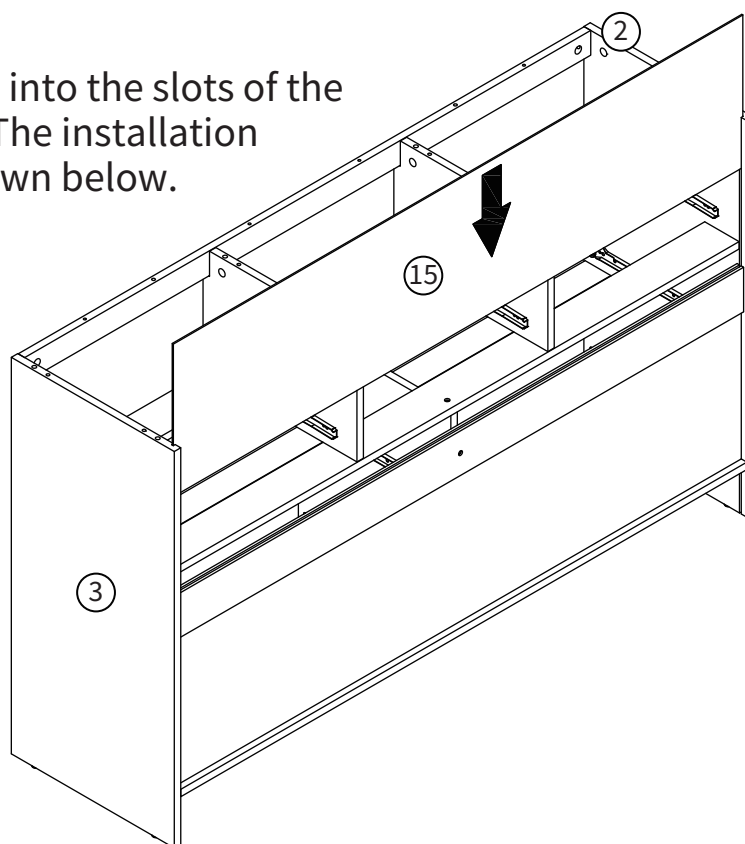

Step 17

Insert the dowel (C) into part ②, ③ and ⑤ first, then assemble part ②, ③, ⑤ and part ①. Put the eccentric (B) into the corresponding hole and use a screwdriver to turn it clockwise to tighten. Use screw (E) to lock the part ④ with the part ①. The installation position is as shown below.

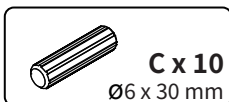
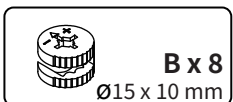
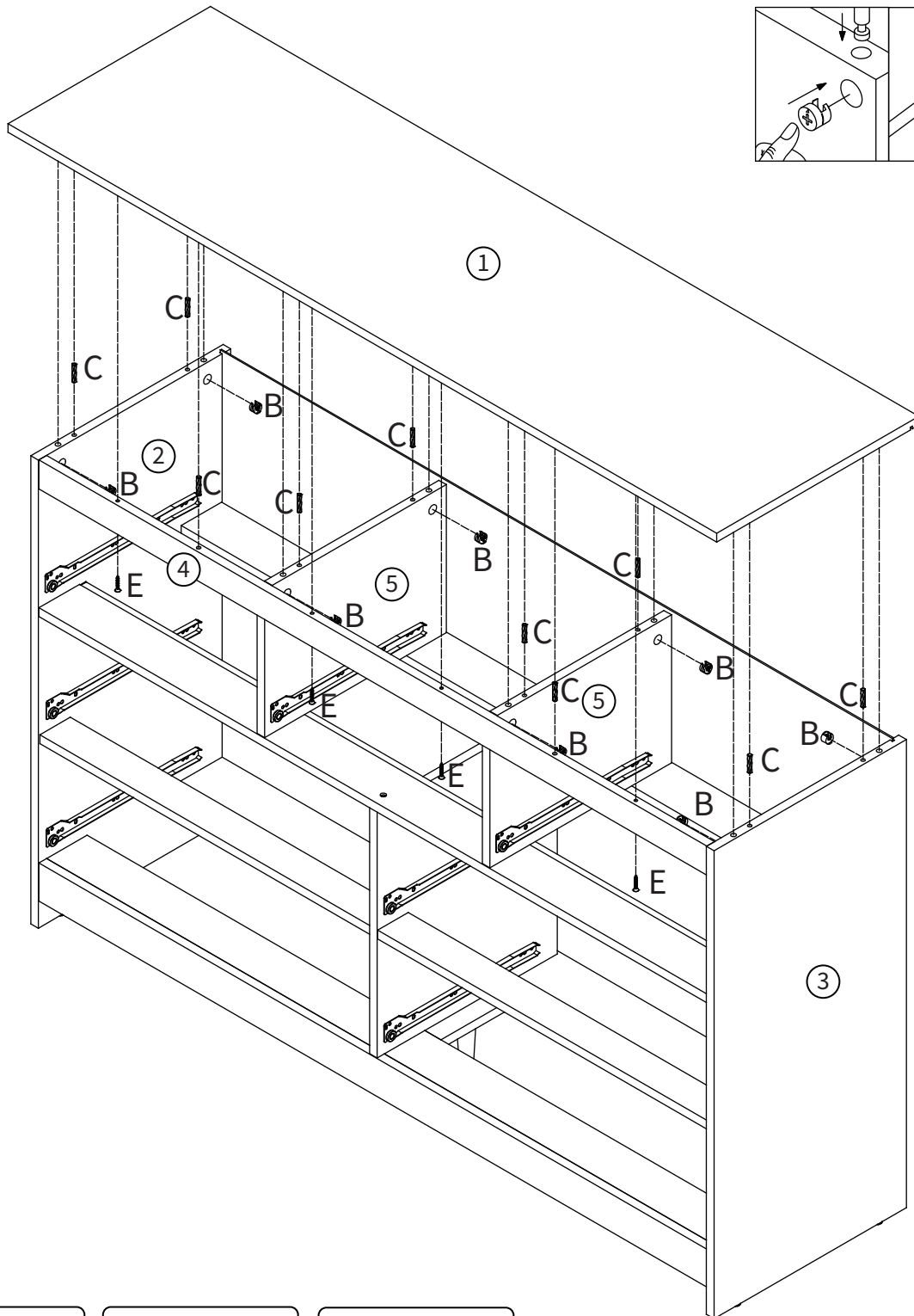

Step 18

Lock screw (A) on the part ⑰ and ⑳. The installation position is as shown in the figure below.

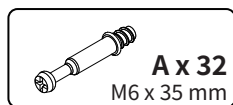
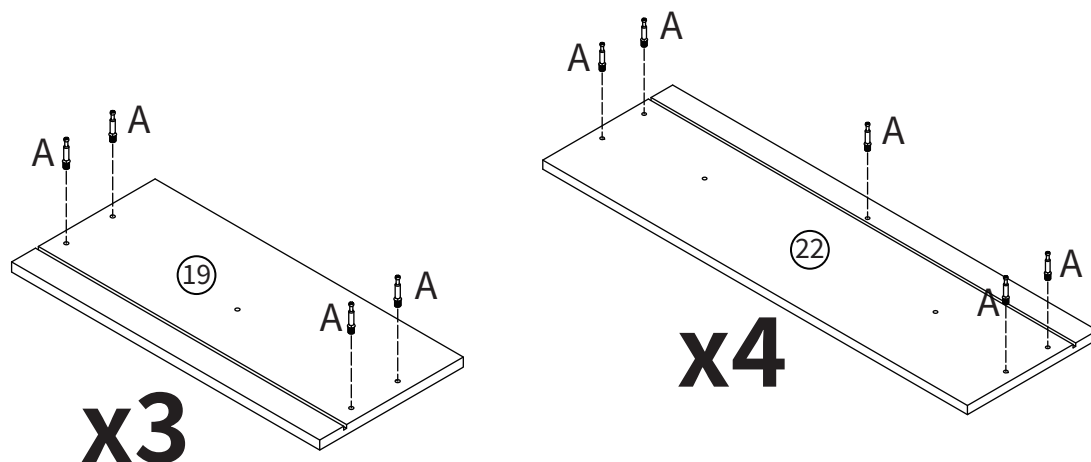

Step 19

Use screw (F) to lock the part ⑰, ⑱ and ㉔, use screw (F) to lock the part ⑰, ⑱, ㉓ and ㉕. The installation position is as shown in the figure below.

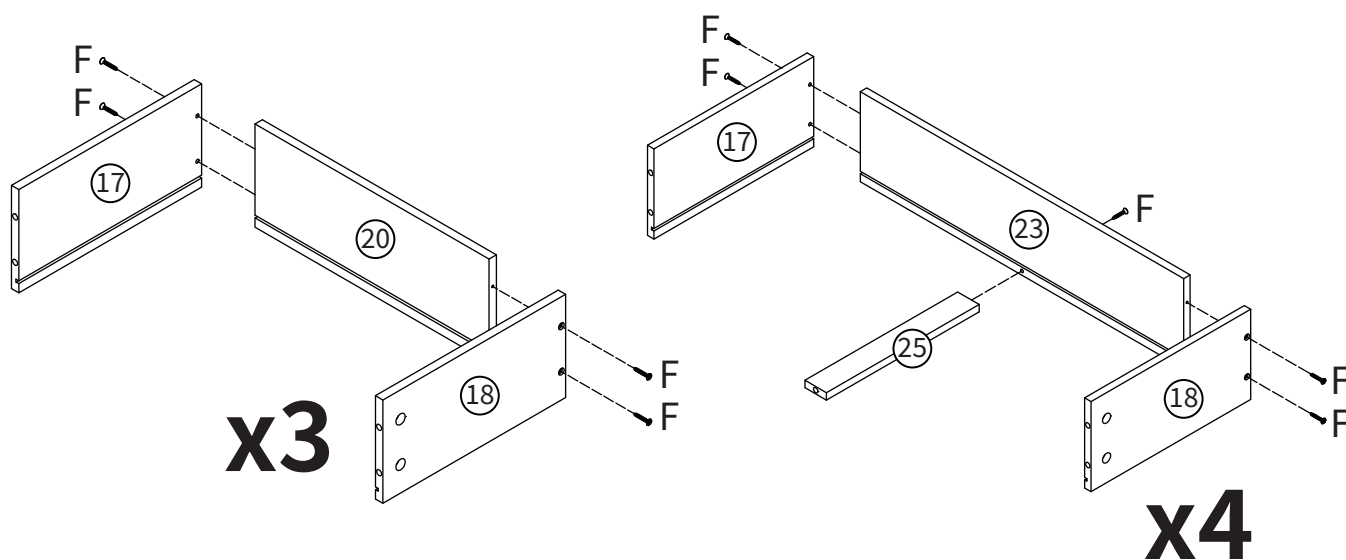

Step 20

Insert the part ⑳ into the slots of the part ⑑ and ㉒. Insert the part ㉔ into the slots of the part ⑑ and ㉒. The installation position is as shown below.

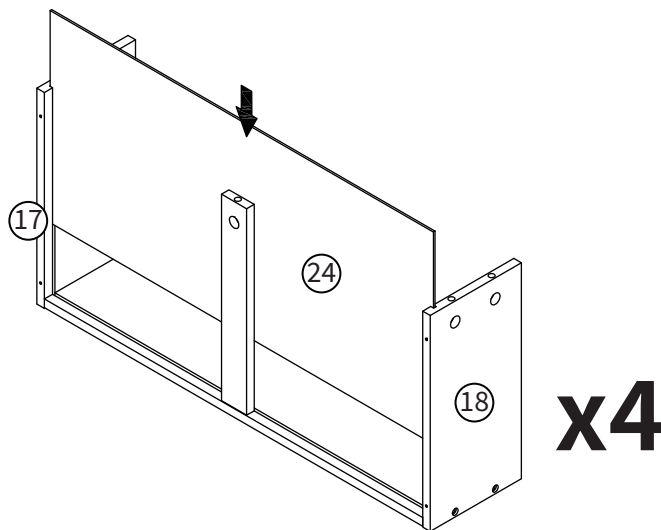
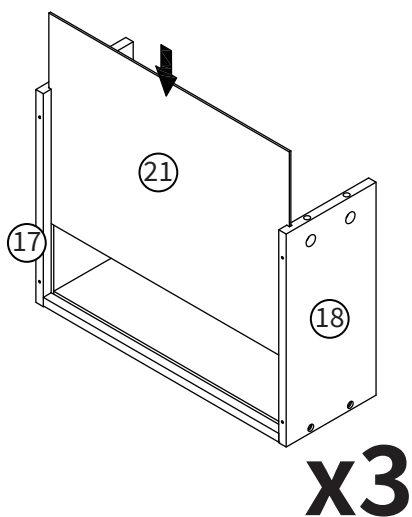

Step 21

First use hardware (J) to lock the handle (K) on the part ㉑ and ㉒, and then use eccentric (B) to combine the part ㉑ and ㉒ with the part ⑑ and ㉒ respectively. The installation position is as shown below.

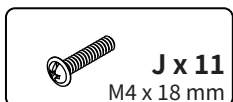
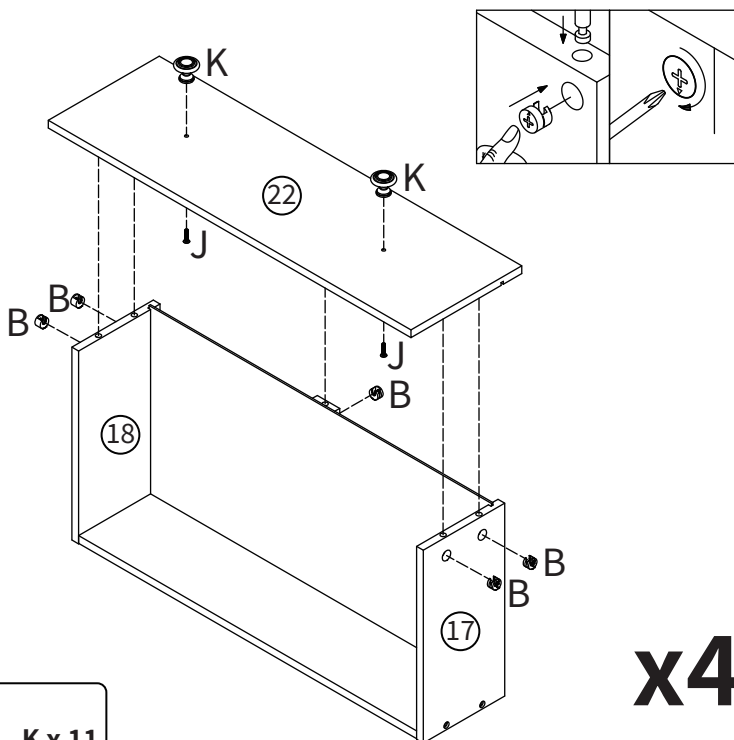
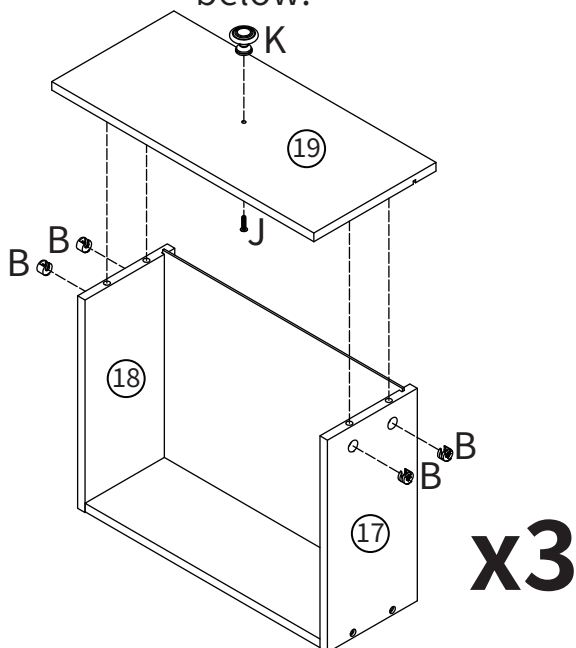

Step 22

Use screws (H) to install the guide rail (DL) on the side panel (17), and install the guide rail (DR) on the side panel (18). Drawer total of 7 sets are required to be assembled. The installation position is as shown in the figure below.

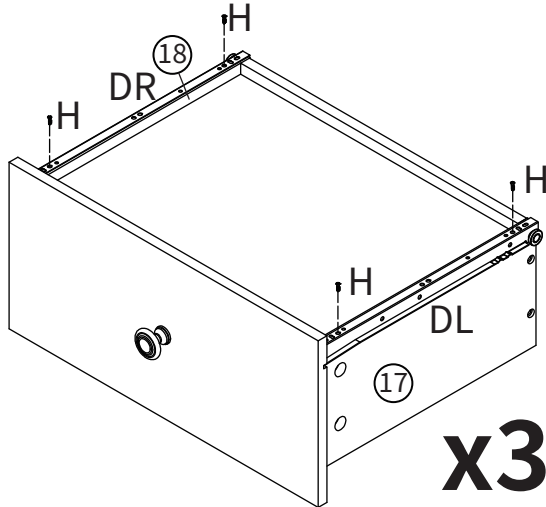
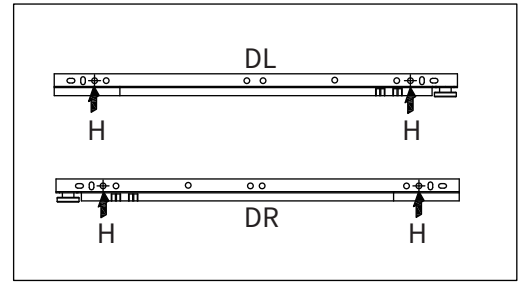

x3

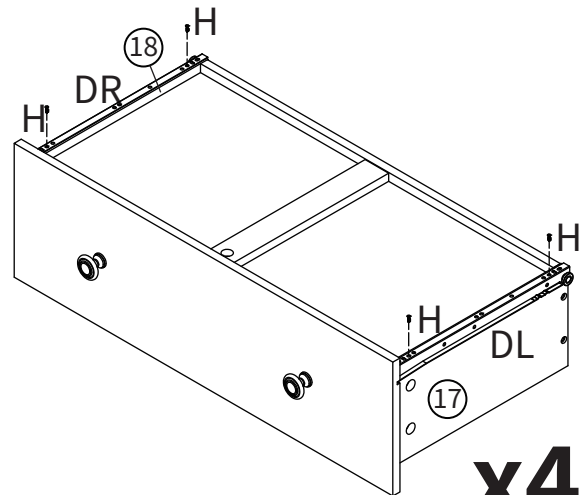

x4



Step 23

Install drawer (19) into the top drawer and drawer (22) into the bottom drawer. The following figure shows the installation position.

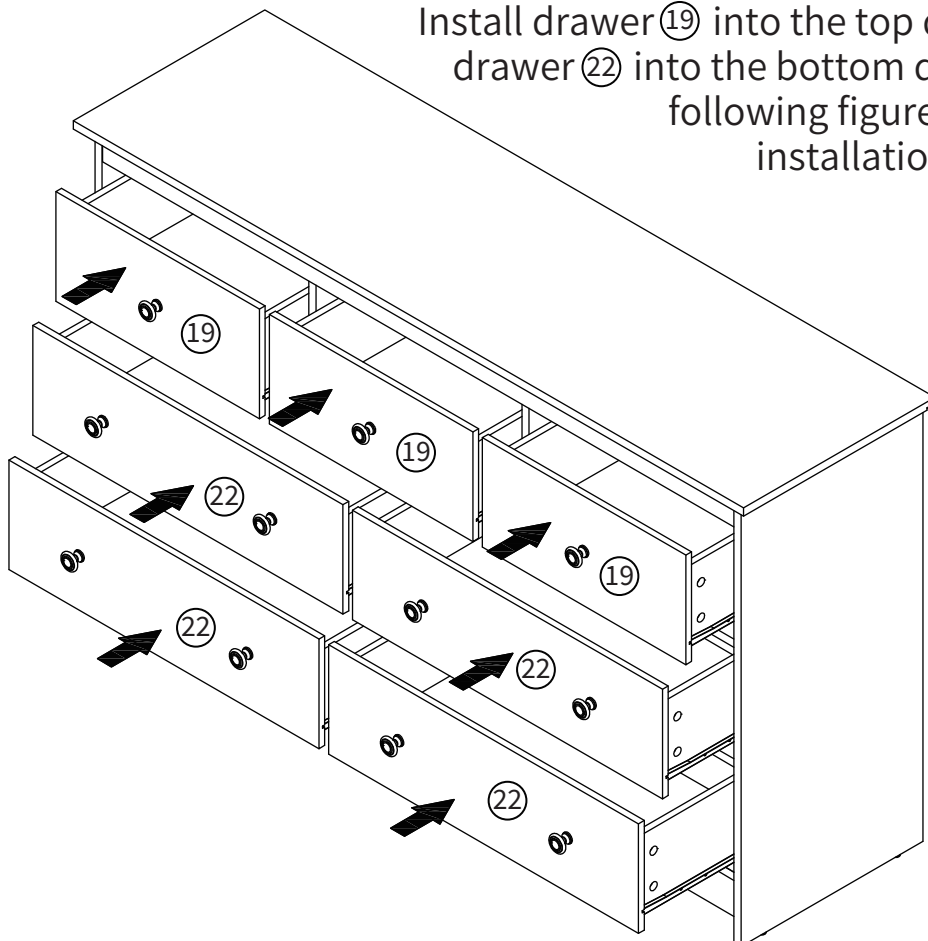

Step 24

Use the small screws in the hardware bag **(G)** to lock the piece of iron to the part **(1)**. Lock the backplane buckle **(I)** to the four corners of the backplane. The following figure shows the installation position.

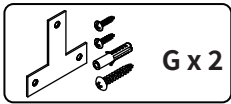
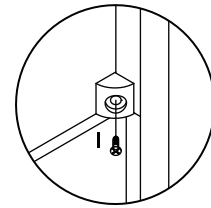
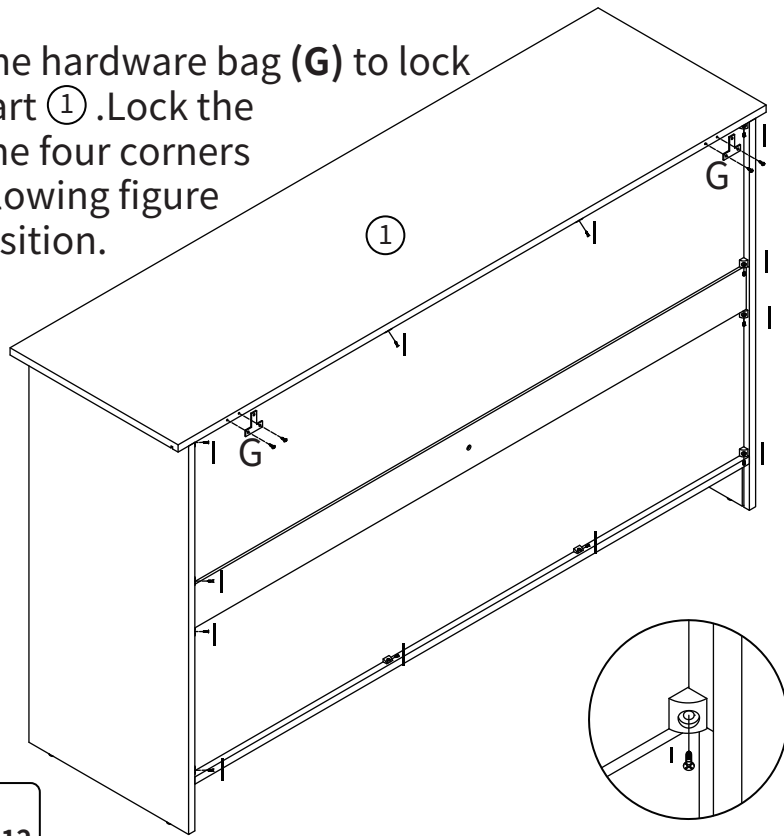
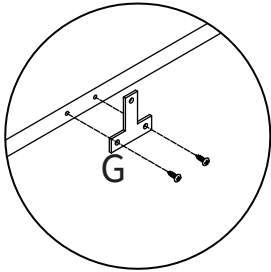

G x 2

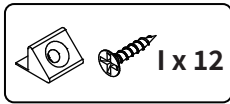

I x 12

Step 25

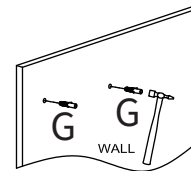
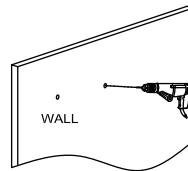
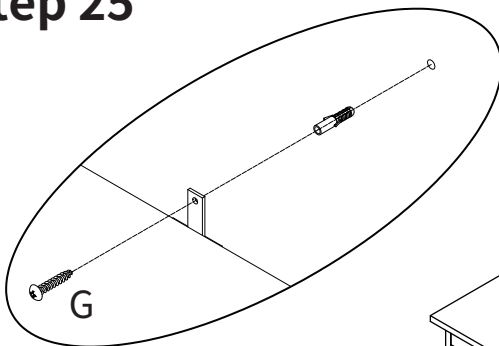

Wall

First knock the expansion screws in hardware **(G)** into the wall with a hammer, and then use the long screws in hardware **(G)** to pass through the iron sheet and lock into the expansion screws in the wall. The following figure shows the installation position.

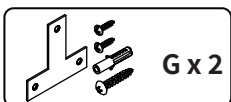
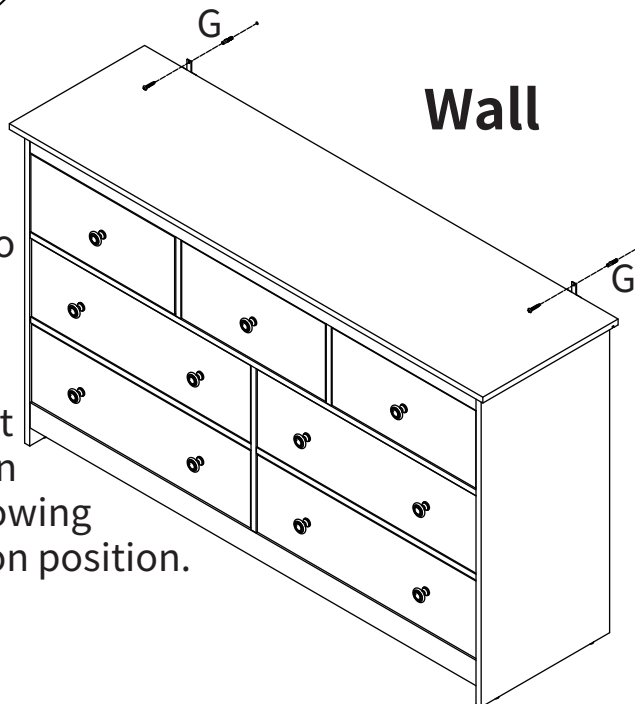

G x 2