

PARTS LIST:

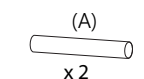

1 1/8" Diameter Rod

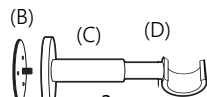

Three-Piece Adjustable Bracket
Wall Mount(B) • Wall Bracket(C) • Rod Bracket (D)



Set Screw



Wall Mounting Screw



Plastic Anchor
(for drywall only)



Rod Connector



Hex Screw
with Wrench

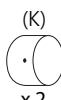

End Cap

INSTALLATION:

1. Determine the placement of the rod on the wall. Reference the Installation Diagram on the reverse side.
2. Measure and mark the bracket locations above the window frame. Use a level to ensure the rod will be level on the wall.
3. Mark the three mounting holes for each bracket on the wall using the Wall Mount (Part-B) as a template.
4. Drill three 1/8" diameter pilot holes in the wall for all marked bracket locations.
5. For drywall (hollow wall) installation: Screw plastic wall anchors (Part-G) into pilot hole until flush. Do not over tighten.
6. For wall stud installation: The plastic wall anchors (Part-G) are not used.
7. Attach all three Wall Mounts (Part-B) with mounting stub pointing away from the wall (Fig. 1). Hand tighten all mounting screws (Part-F) using a screw driver to prevent screw head damage.
8. Place Wall Bracket (Part-C) over the Wall Mount (Part-B) and tighten the rear set screw (Part-I) using the allen wrench (Part-J) provided (Fig. 2).
9. Insert the Rod Bracket (Part-D) into the Wall Bracket (Part-C) and set the desired distance from the wall. Tighten the forward set screw (Part-I) with the allen wrench (Part-J) provided to lock the Rod Bracket (Part-D) in place.
10. Screw the rod connector (Part-H) in the end of one of the rods (Part-A). Screw the other end of the rod connector (Part-H) into the other rod (Part-A) (Fig. 3). Hand tighten until the two rods are snug.
11. Install draperies or clip rings on the rod (Part-A) and place the rod in the three brackets mounted on the wall (Fig. 4).
12. Center the rod (Part-A) in the wall brackets and tighten the set screw (Part-E) using a screwdriver in each of the Rod Brackets (Part-D).
13. Attach the end caps (Part-K) to each end of the rod (Part-A) tightening the set screw (Part-I) using the allen wrench (Part-J) provided as shown in (Fig. 4).
14. We want to Thank You for your purchase. Please enjoy your new window.

**Parts exceeding the quantity listed may be included in the hardware kit. These extra parts can be discarded after assembly.

**An extra rod connector is provided to allow connecting of additional rod sets for larger windows.

 modeforhome



Scan QR Code for additional information

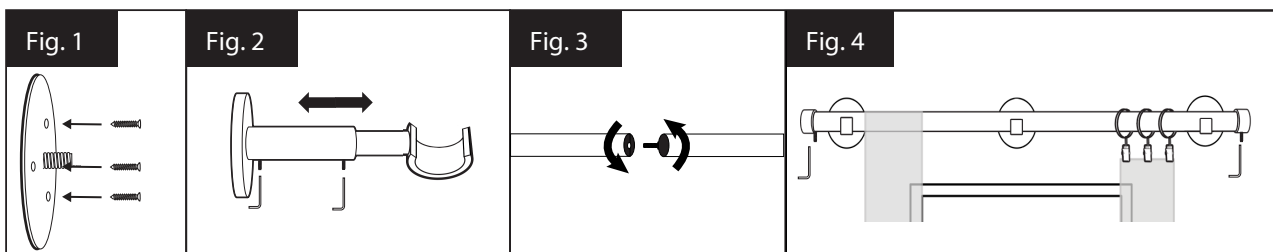

Replacement parts available. Email parts@cambridesigner.com

TOOLS NEEDED: NOT INCLUDED

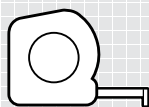

Tape Measure



Pencil

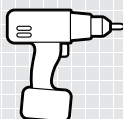

Drill



1/8" Drill Bit



#2 Phillips-head
Screwdriver



Level

INSTALLATION DIAGRAM

