

Hanging Instructions:

Quick and Easy Installation -D-ring hangers are attached to the backside of the mirror and is ready to hang right out of the box, in either a horizontal or vertical orientation.

IMPORTANT NOTICE

Hanging Instructions for Mirrors
with Strap Hangers

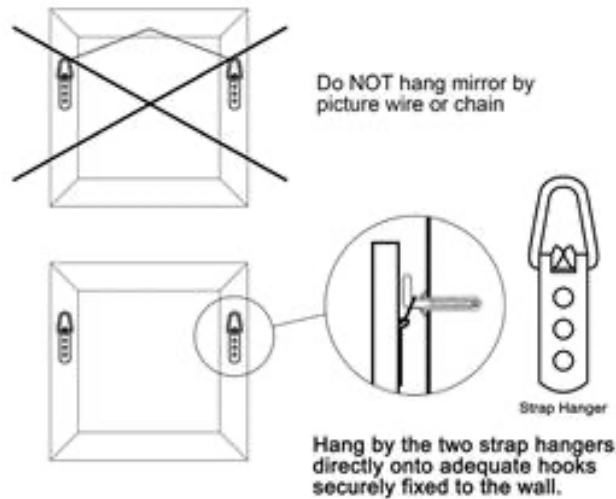

Never hang a mirror on damp wall
as the backboard of the mirror will
distort and possibly also cause damage
to the mirror itself.

If in any doubt consult a competent Installation Specialist.