

USER MANUAL

Ein bedienungsanleitung

MANUAL de usuario

Manuel de l'utilisateur

Manuale utente



Important: Read carefully and keep.

Tipp: beglaubigt das lesen und spelichern

Consejo: ertificado para leerlo yuagrdarlo

Astuce: autlentifier pour le lire et le sauvegard

Nota: certificazione leggere e conservare

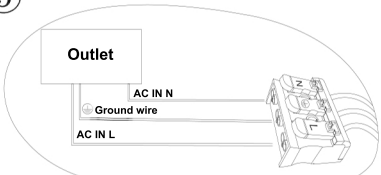
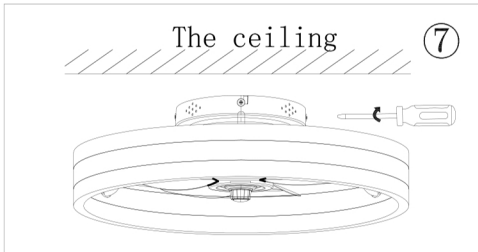
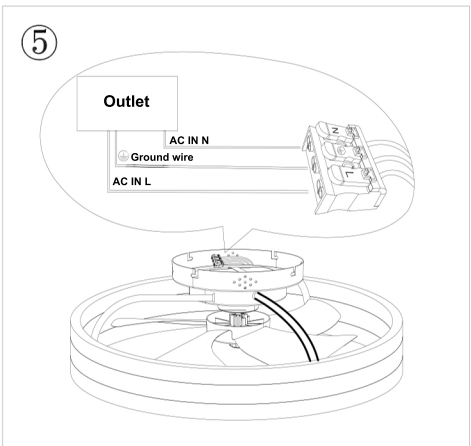
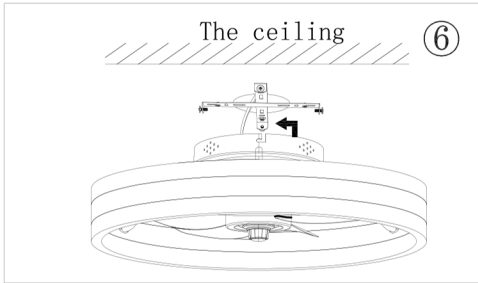
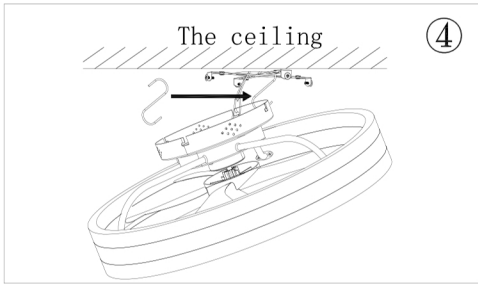
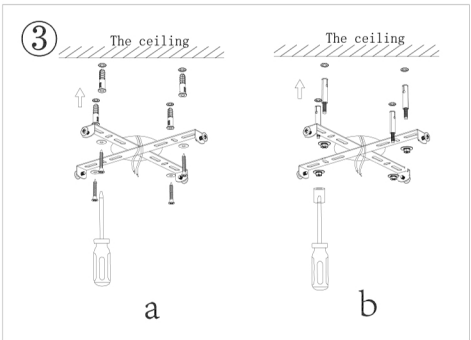
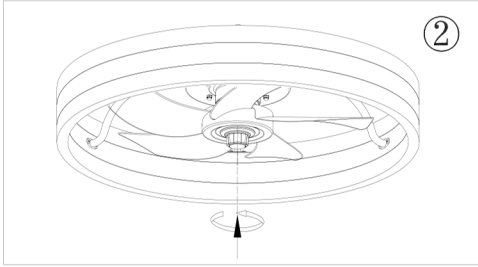
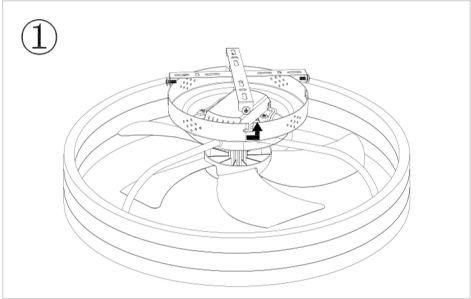
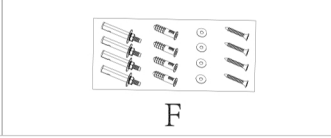
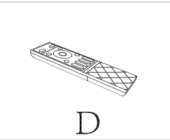
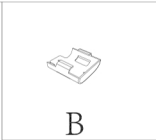
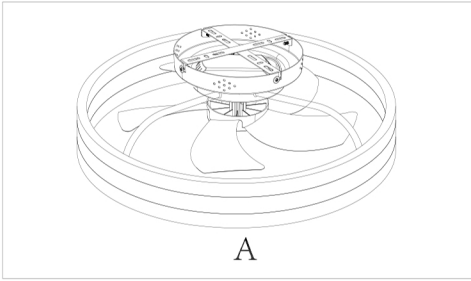

Preparations:

- 1.Prepare the required tools.
- 2.Turn off the switch.
- 3.Put all the parts in order.









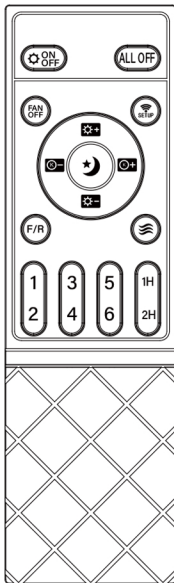

Installation procedure:

- 1.Remove the bracket from the light fixture.
- 2.Tighten the part in a counterclockwise direction to make it firm.
- 3.If the roof is a wood ceiling, install the bracket as shown in picture A . Make sure the bracket is securely secured .
If the roof is a concrete ceiling, install the bracket as shown in picture B . Make sure the bracket is securely secured .
- 4.Hook one end of the S-shaped fitting to the light fixture and the other end to the bracket . Just like the picture .
- 5.Insert the ground wire into the middle position ; Insert the N pole of the wire into the N position ; Insert the L pole of the wire into the L position .
6. Remove the S-shaped fittings ; Hang the 7-shaped hole in the light fixture on the bracket .
7. Tighten the four screws . Ensure secure installation .
8. Clean the light fixture with a clean cloth .
9. Turn on the switch . The light fixture was successfully installed ! ! !

Remote control instructions:

- 1.Install AAA batteries (Battery not included) . If the remote control is not used for a long time, please take out the battery to prevent battery damage .
- 2.The remote control function is shown below .



-  Link fan light (Normally, the remote control and fan light are already linked and can be used directly . If there is no link, follow the steps . 1.Turn off the main power supply to the fan light . 2.Turn on the main power of the fan light and press and hold this button within 5 seconds . 3.If you hear a beep, the remote is connected to the fan light . Try using a remote control to control the fan light .)
-  Turn off the lights and fans together
-  Turn on the light / Turn off the light
-  Turn off the fan
-  Lighten the lights/dim the lights
-  The light switches to night light mode
-  Turn down / up the color temperature of the light
-  Positive fan rotation / Fan reversal
-  Wind switch to natural wind mode
-  Different fan speeds
1 gear has the least wind , 6 gear has the most wind.
-  Timing function 1H/2H