

APPROX WEIGHT: 180.30 lbs.
DOES NOT INCLUDE WEIGHT OF POWER OR PACKAGING!!!

DOUBLE DECKER HARDWOOD PLATFORM CART - VHPT/D-3672

*** ANY ADDITIONS, DELETIONS, OR OMISSIONS MUST BE CORRECTED ON THIS DRAWING AS THIS DRAWING WILL BE CONSIDERED ALL INCLUSIVE ***
ALL GRAPHICS PROVIDED ARE FOR REFERENCE ONLY. IF CERTAIN DIMENSIONS ARE CRITICAL PLEASE VERIFY THOSE DIMENSIONS WITH YOUR SALESPERSON

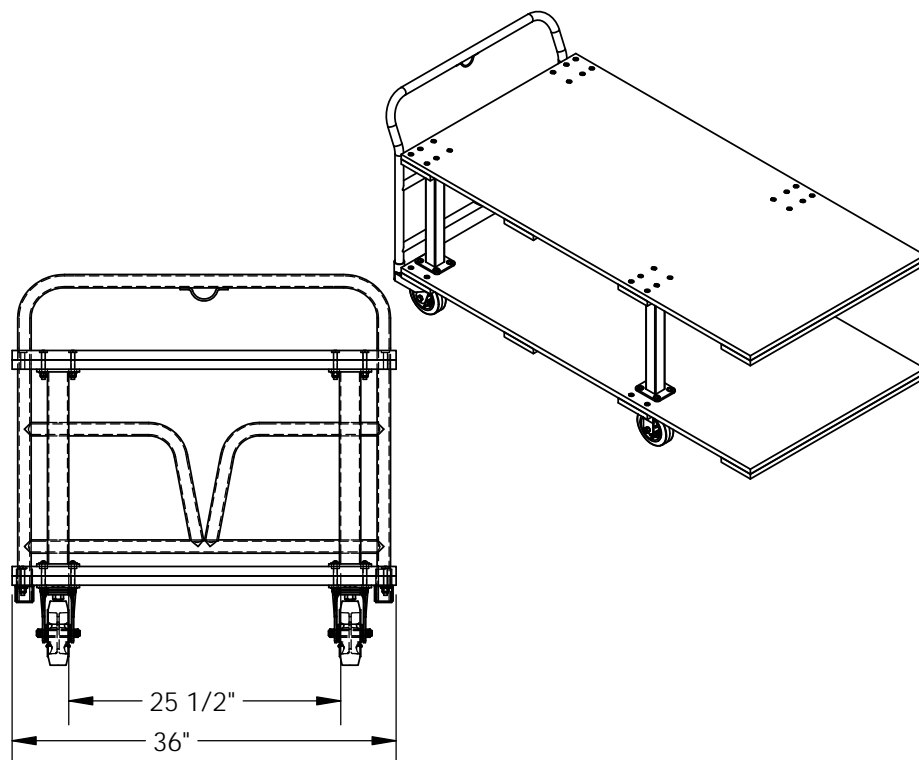
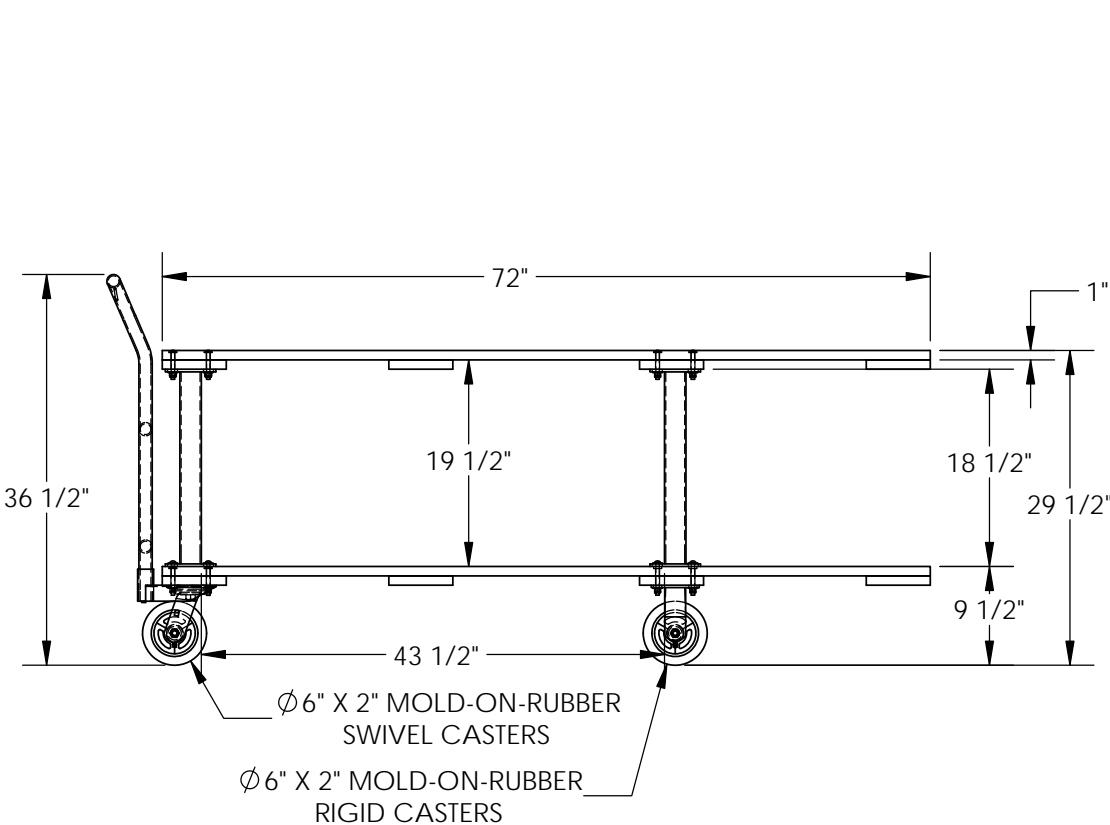

STANDARD FEATURES

- MODEL NUMBER: VHPT/D-3672
- CAPACITY: 1,600 LBS
- MAX 800 LBS PER SHELF
- DECK WIDTH: 36"
- DECK LENGTH: 72"
- BOTTOM PLATFORM HEIGHT: 9 1/2"
- TOP PLATFORM HEIGHT: 29 1/2"
- WIDTH INSIDE LEG TO INSIDE LEG: 25 1/2"
- LENGTH INSIDE LEG TO INSIDE LEG: 43 1/2"
- CONSTRUCTED OF 1" THICK HARDWOOD
- SUPPORT POSTS ARE 18 1/2" LONG
- Ø6" x 2" MOLD-ON-RUBBER CASTERS
 - 2- RIGID CASTERS
 - 2- SWIVEL CASTERS

SPECIAL FEATURES
NONE

FOR INTERNAL USE ONLY PROJECT SIGN OFF	
SALES	
ENG.	
FAB.	
POWER	

DIMENSION TOLERANCE ± 1/4"

APPROVAL

I, THE UNDERSIGNED, AGREE THAT THE PRODUCT AS REPRESENTED SATISFIES DESIGN AND DIMENSION REQUIREMENTS. I ALSO ACKNOWLEDGE MY DUTY TO CONFIRM PRODUCT AND INSTALLATION COMPLIANCE WITH ALL APPLICABLE FEDERAL, STATE AND LOCAL REGULATIONS AND STANDARDS.
ALL SPECIAL UNITS ARE NON-RETURNABLE
[] As drawn [] As marked

Signed: _____ Date: _____

LEAD TIME WILL START UPON RECEIPT OF SIGNED APPROVAL DRAWING

DISTRIBUTOR'S NAME:		P.O.#
VESTIL MANUFACTURING		X
DRAWN BY: CA		W.O.#
DATE: 12/12/12		X
REFERENCE: X		SALES: X
SCALE: 1:18		FILE NAME:
QUOTED LEAD TIME: X		33-007-013-001
QUOTE # X		