

INSTALLATION GUIDE

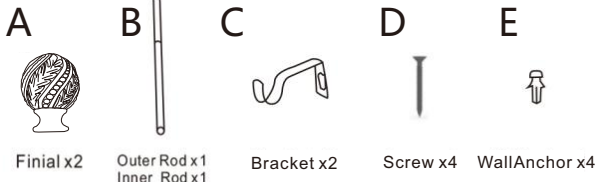

WARNING: Remember the screws and hardware chosen should be strong and appropriate for the type of surface on which they are going to be used. If you have any question, contact a specialist.

HARDWARE INCLUDED:



TOOLS REQUIRED (NOT INCLUDED):

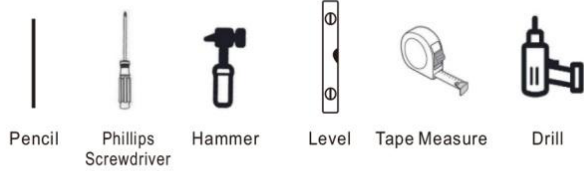

1 Step 1

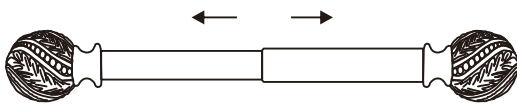

2 Step 2

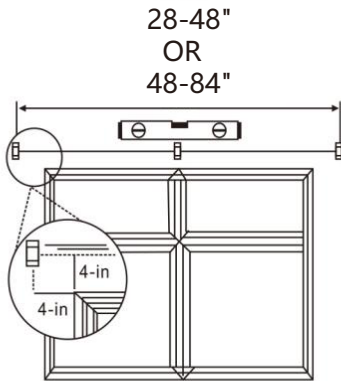

3 Step 3

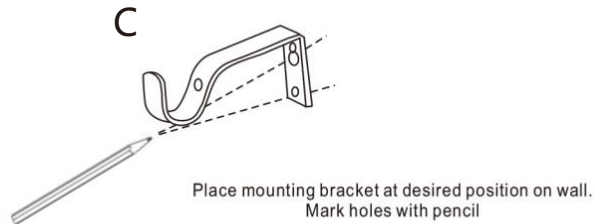

4 Step 4

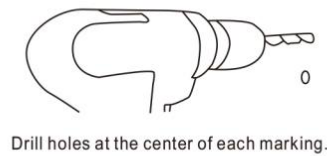

5 Step 5

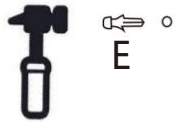

If installing into drywall, tap anchors into drilled holes with hammer until flush with wall.

6 Step 6

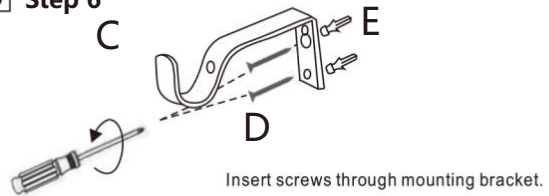

6a Step 6.1

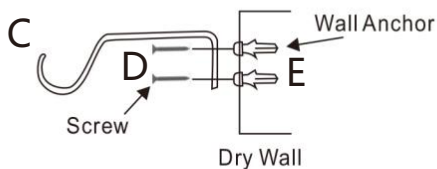

6b Step 6.2

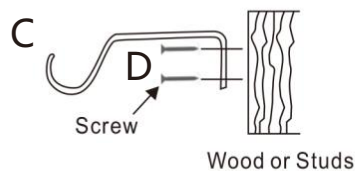

7 Step 7

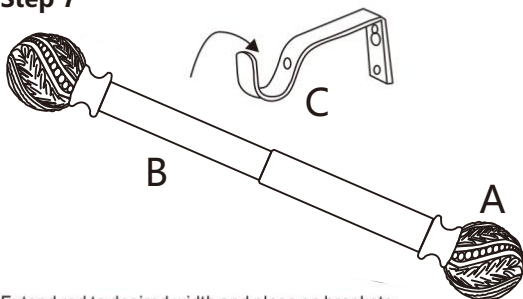

Extend rod to desired width and place on brackets.

8 Step 8

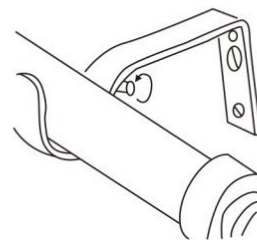

Hand-tighten set screw to secure rod.

Thank you for choosing us

INSTALLATION GUIDE



WARNING: Remember the screws and hardware chosen should be strong and appropriate for the type of surface on which they are going to be used. If you have any question, contact a specialist.

HARDWARE INCLUDED:

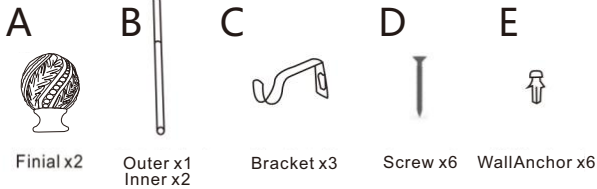

TOOLS REQUIRED (NOT INCLUDED):



1 Step 1

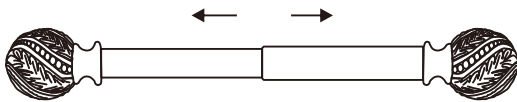

2 Step 2

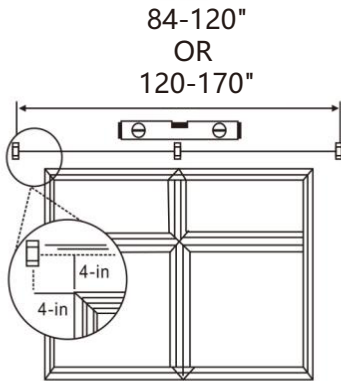

3 Step 3

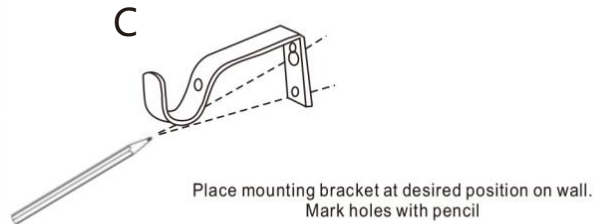

4 Step 4

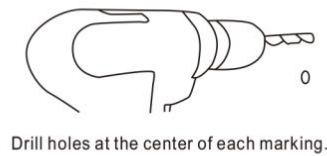

5 Step 5



6 Step 6

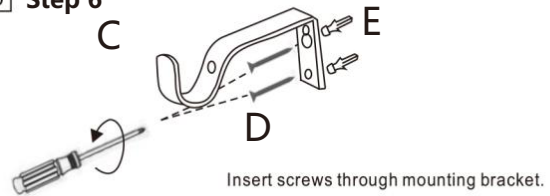

6a Step 6.1

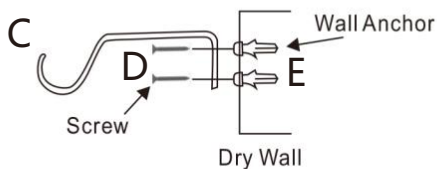

6b Step 6.2

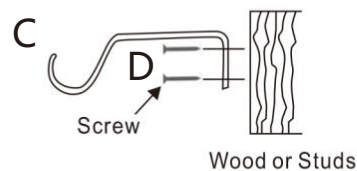

7 Step 7

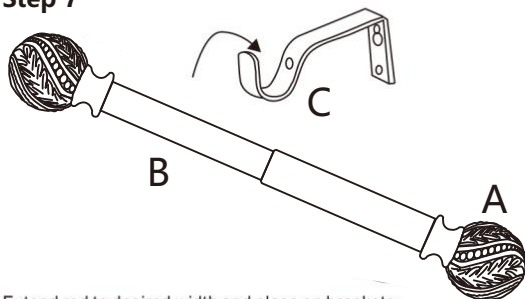

8 Step 8

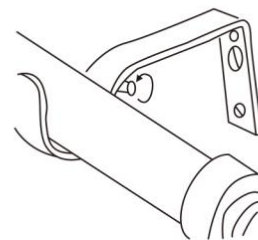

Thank you for choosing us

INSTALLATION GUIDE



WARNING: Remember the screws and hardware chosen should be strong and appropriate for the type of surface on which they are going to be used. If you have any question, contact a specialist.

HARDWARE INCLUDED:

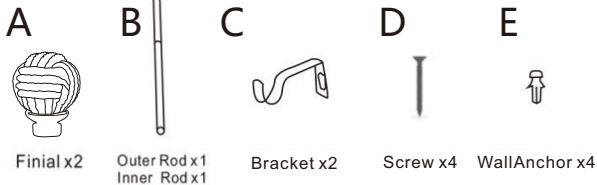

TOOLS REQUIRED (NOT INCLUDED):

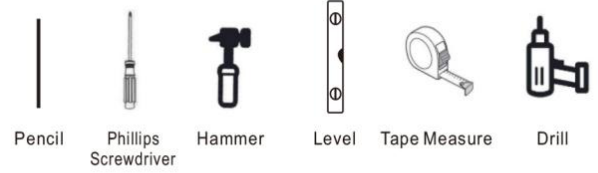

1 Step 1

3 Step 3

Place mounting bracket at desired position on wall.
Mark holes with pencil

2 Step 2

28-48"
OR
48-84"

4-in
4-in

4 Step 4

Drill holes at the center of each marking.

5 Step 5

If installing into drywall, tap anchors into drilled holes with hammer until flush with wall.

6 Step 6

Insert screws through mounting bracket.

6a Step 6.1

Wall Anchor
Screw
Dry Wall

6b Step 6.2

Screw
Wood or Studs

7 Step 7

Extend rod to desired width and place on brackets.

8 Step 8

Hand-tighten set screw to secure rod.

Thank you for choosing us

INSTALLATION GUIDE



WARNING: Remember the screws and hardware chosen should be strong and appropriate for the type of surface on which they are going to be used. If you have any question, contact a specialist.

HARDWARE INCLUDED:

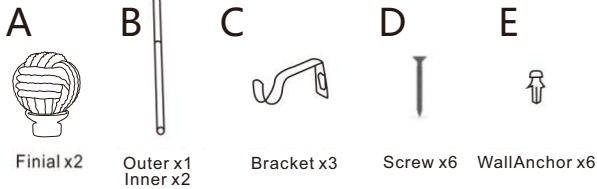

TOOLS REQUIRED (NOT INCLUDED):

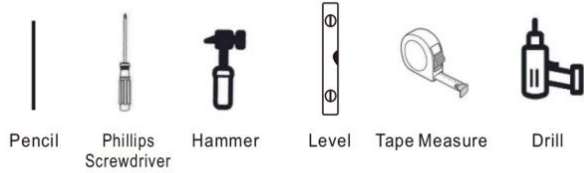

1 Step 1

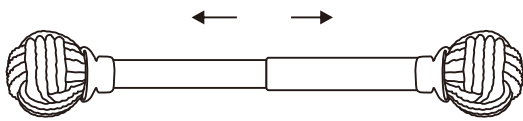

2 Step 2

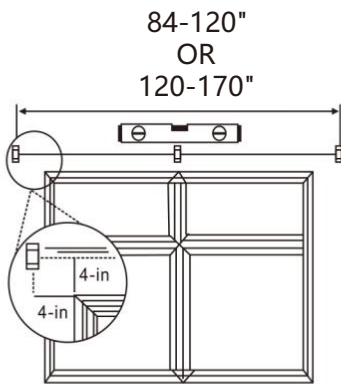

3 Step 3

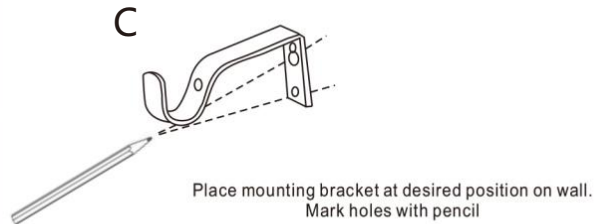

4 Step 4

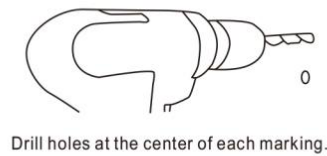

5 Step 5

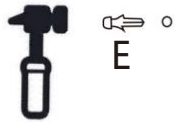

6 Step 6

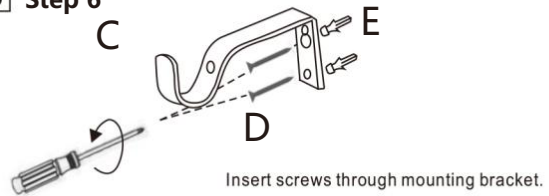

6a Step 6.1

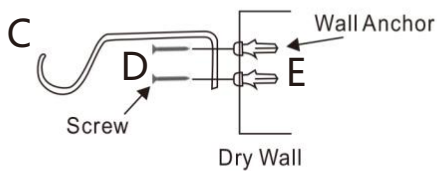

6b Step 6.2

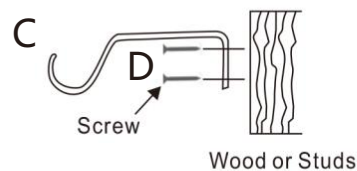

7 Step 7

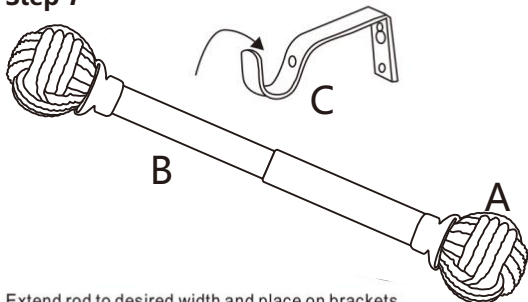

8 Step 8

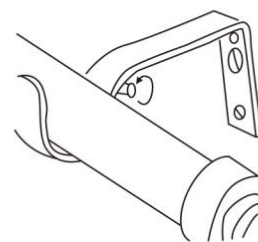

Thank you for choosing us