

Instruction Manual

Classic Two-Tiered Solar Fountain



Purchased your product online?

We would really appreciate it if you can share your experience with others by reviewing our product on the website from which you purchased.



Contents

Contents	2
What is included	3
Assembly instructions	4
YouTube video instruction	5
Warranty	6

What is included



A. Pedestal



B. Main Bowl



C. Fountain Top



D. Top Bowl



E. Top Pedestal



F. Solar Pump

Assembly instructions

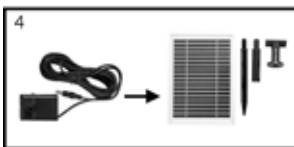
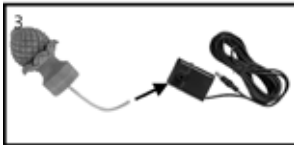
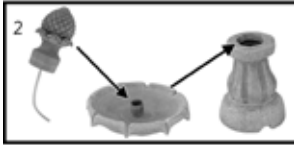
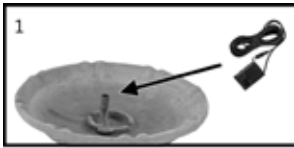

Step 1: Attach the large bowl to the pedestal, then feed pump cord through the large bowl and then out from the bottom of the pedestal.

Step 2: Connect the top piece to the smaller bowl, then connect that to the small pedestal piece.

Step 3: Connect the hose to the pump.

Step 4: Connect the pump cord to the Solar Panel, place then panel in the sun, then press the button on the back to turn it on.



Warranty

Limited 1-Year Manufacturer Warranty on xbrand.us

Manufacturer warranty covers:

- Parts that are deemed defective within 30 days will be shipped free of charge.
- Any warranty claim after 30 days, will require shipping to be paid by the customer.

Any visible damage due to the neglect, misuse, or abuse will void the limited warranty of the product.