

SPINDLE BACK WINDSOR CHAIR

ASSEMBLY INSTRUCTIONS



ASSEMBLY INSTRUCTIONS

ASSEMBLY TIPS :

1. Remove hardware from box and sort by size.
2. Please check to see that all hardware and parts are present prior to start of assembly.
3. Please follow attached instructions in the same sequence as numbered to assure fast & easy assembly.



Warning !

1. Don't attempt to repair or modify parts that are broken or defective. Please contact the store immediately.
2. This product is for home use only and not intended for commercial establishment.

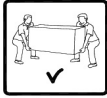

ASSEMBLY TIME 10 MINUTES

PARTS IDENTIFICATION:

A. SEAT AND BACK-1PC



BL. LEFT LEG FRAME-1PC
(Semi K/D Construction)

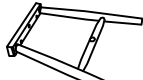

BR. RIGHT LEG FRAME-1PC
(Semi K/D Construction)

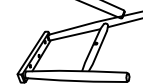

C. STRETCHER - 1PC



HARDWARE IDENTIFICATION

NO	DESCRIPTION	FIGURE	QTY
1	BOLT		2PCS
2	BARREL NUT		2PCS
3	SCREW		6PCS
4	ALLEN WRENCH		1PC
5	WOOD PLUG		2PCS

NOTE: QUANTITIES SHOWN ARE FOR ONE CHAIR

STEP 1

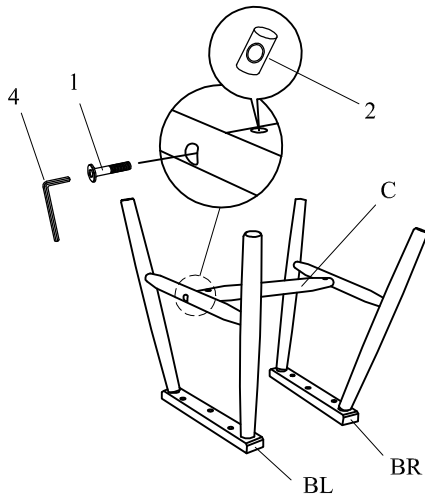

STEP 2

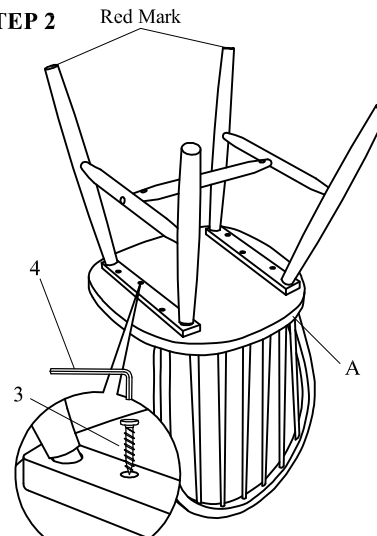

Note: Leg frame with red mark must facing front of the chair seat

STEP 3

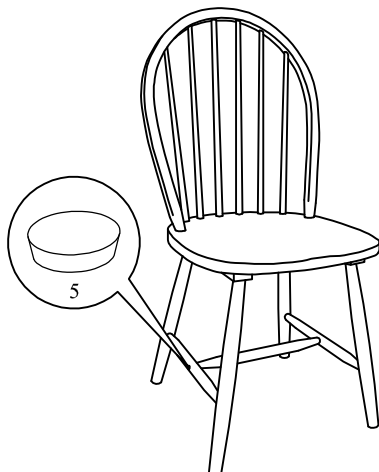

STEP 4 Complete

