

# Assembly Instruction

Decorate your home, Brighten wonderful life



# Various combination forms

**Combination mode 1**

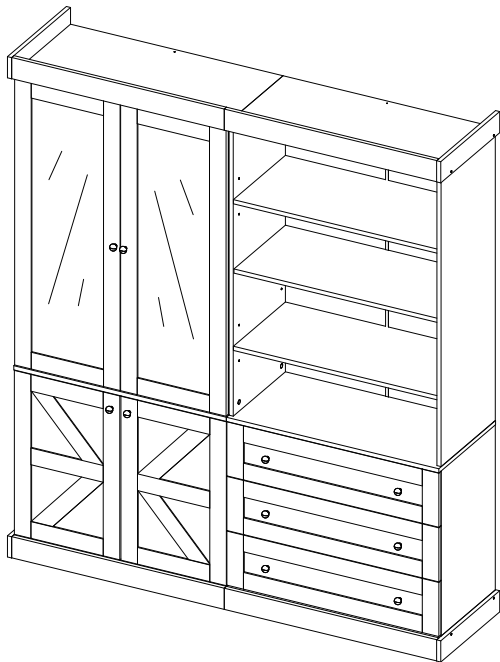

**Combination mode 2**

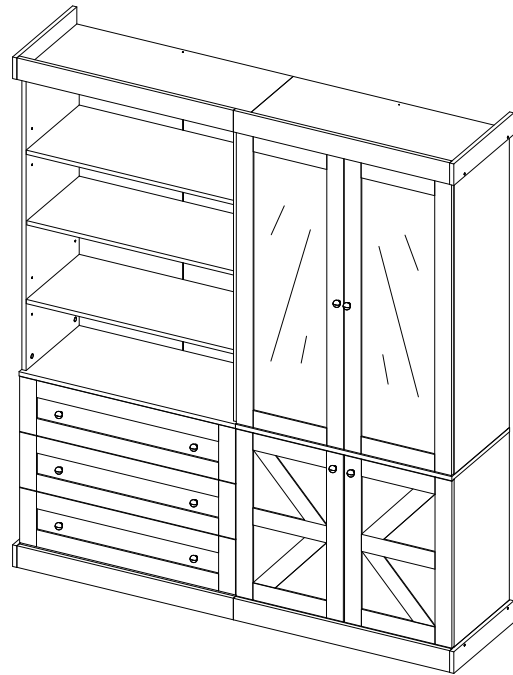

**Combination mode 3**

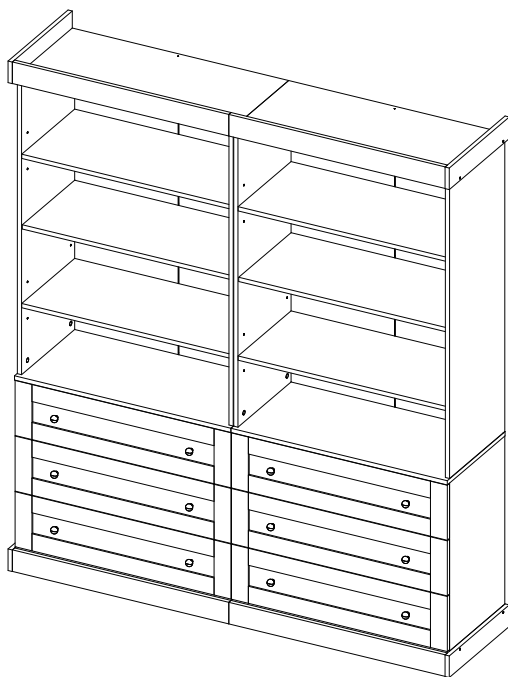

**Combination mode 4**

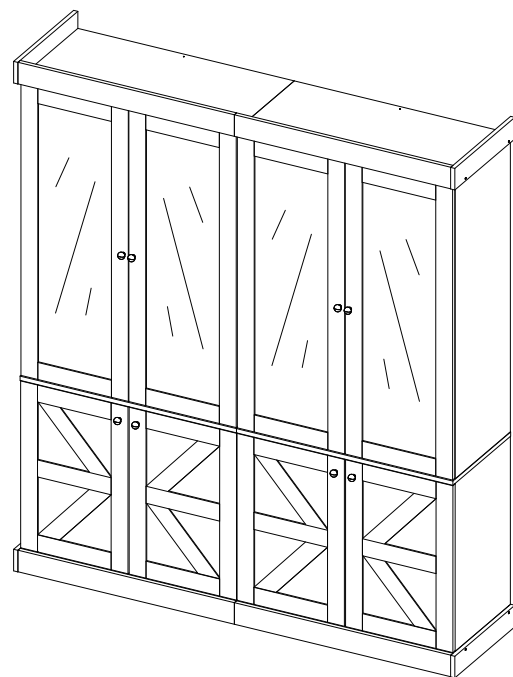

## Multi-cabinet combination



**The following is installed in the first combination mode.**

# INSTALLATION INSTRUCTION

## STEP 1

Unscrew the F fittings of the 14th and 15th boards on the right side of the left cabinet, and then take out the 14th and 15th boards.

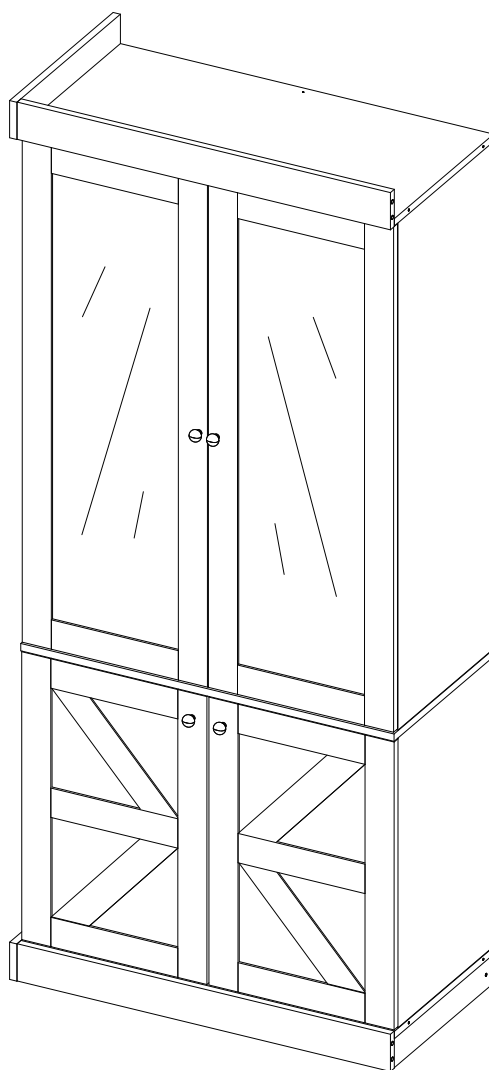
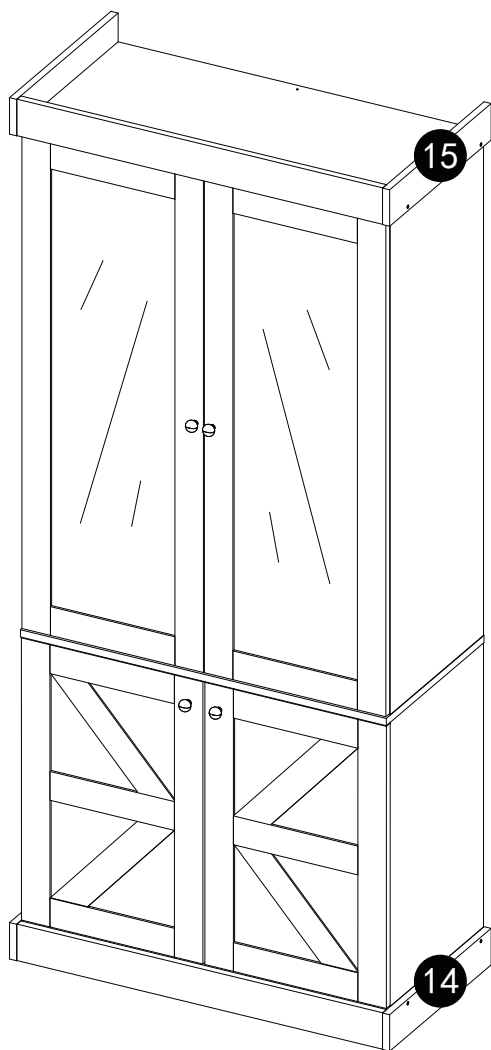

## STEP 2

Unscrew the F fittings of the 14th and 15th boards on the left side of the right cabinet, and then take out the 14th and 15th boards.

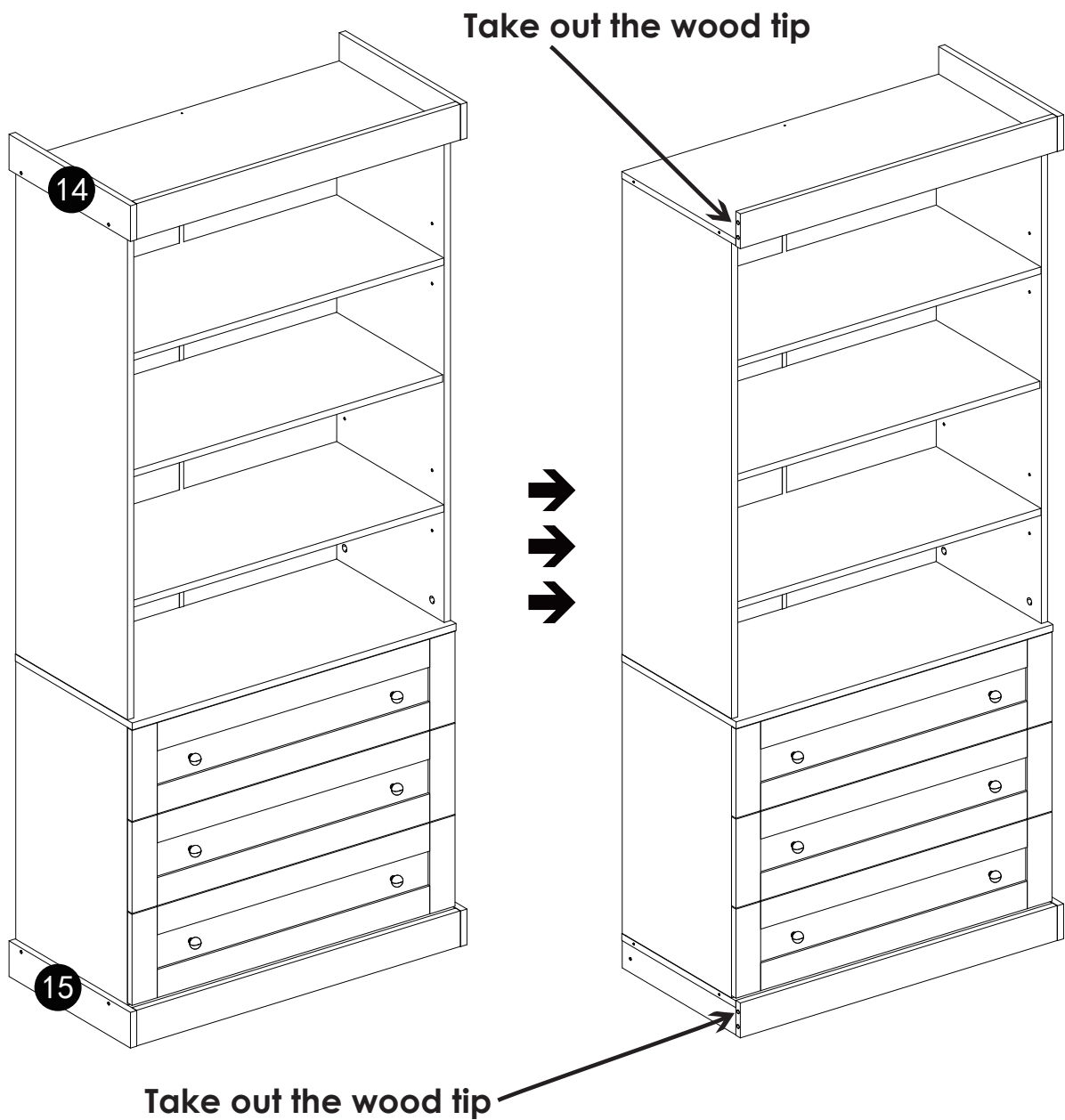

**STEP 3**

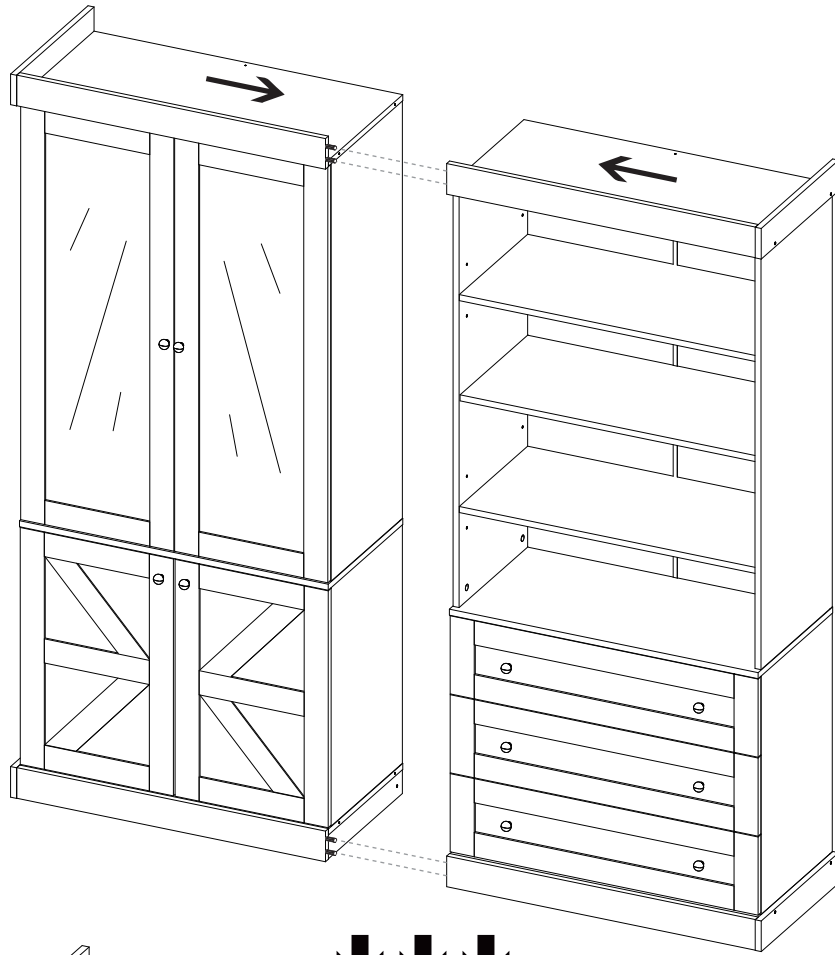

**STEP 4**

**1**

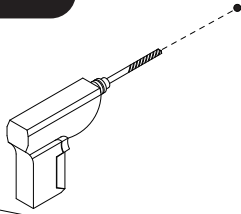

**2**

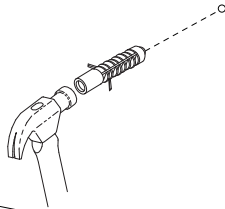

**3**

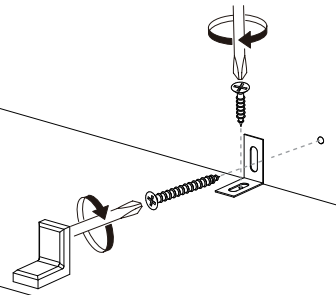

The accessories used in this step can be those in a single cabinet.

