

ASSEMBLY INSTRUCTIONS

BFTLPT-2000



GRAVITY FLUSH TOILET

ASSEMBLY INSTRUCTIONS

Thank you for selecting this product. Before use, please carefully read this operation manual to understand the correct use of this product.

Special attention should be paid to important safety warnings and the operation manual should be kept for reference.

Note: our company reserves the right to improve the product and instructions contained therein, which may be changed without notice.

The appearance of the product depends on the material of the object.

Product specification

SKU	BFTLPT-2000
1. Gravity flush, saving water.	
2. PA toilet bowl with a high gloss surface, easy to clean.	
3. T-type flush nozzle can provide a full bowl coverage flush with just 50ml of water.	
4. Home toilet-like seat size, more comfortable.	
5. Damped toilet seat and lid, silent and elegant.	
6. Easy to install.	

Tips :

1. Please always assemble according to these instructions.
2. Make sure the foot pedal, when pressed, touches the same flat surface on which the toilet is installed.
3. Ensure that the water supply pressure is no more than 0.4 Mpa.
4. Water hotter than 40 degrees is forbidden.

Product List

BFTLPT-2000 Toilet	X1
Water pipe	X1
Manual	X1

ASSEMBLY INSTRUCTIONS

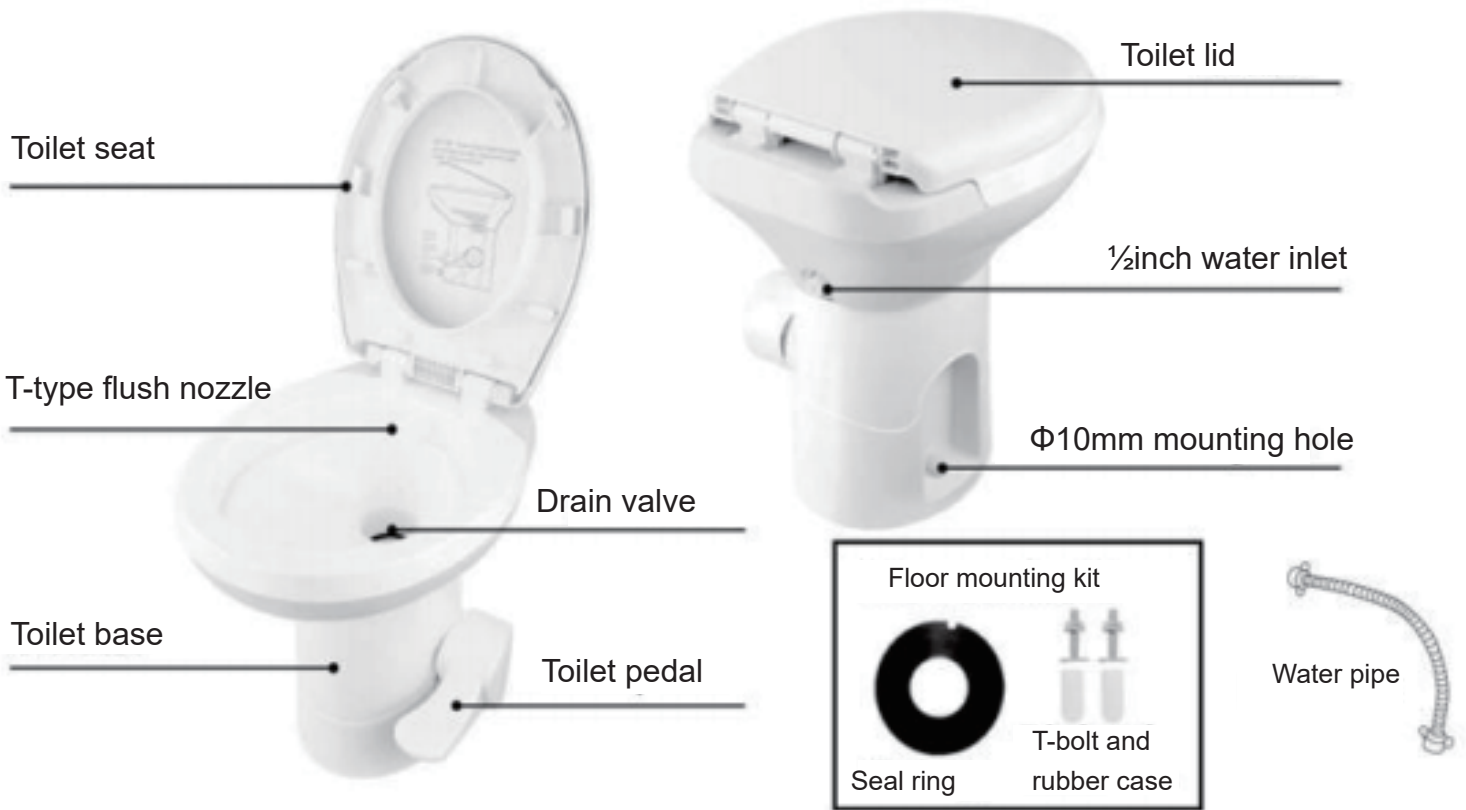

Product and mounting dimension

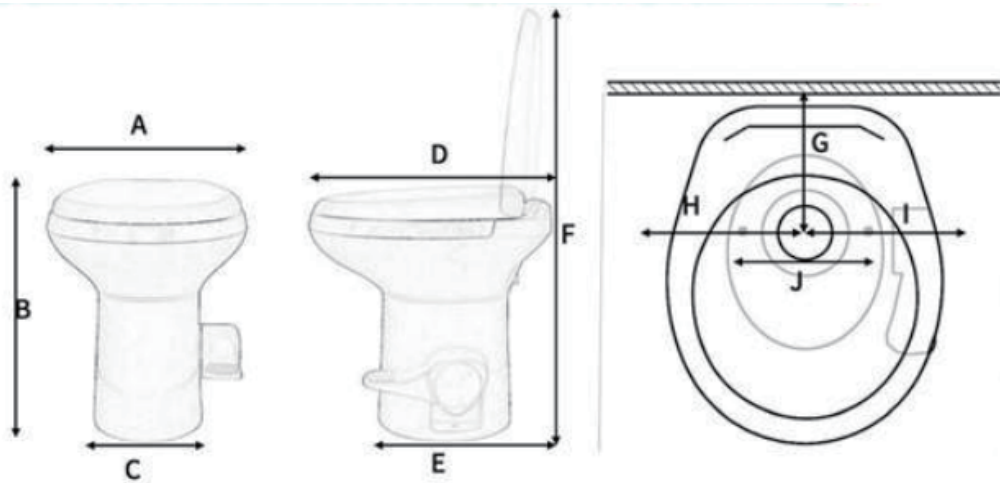

Ref.	Description
A	390mm / 15.4"
B	500mm / 19.7"
C	233mm/9.2"
D	485mm / 19.1"
E	380mm / 15.0"
F	890mm / 35.0"

Ref.	Description
G	Minimum: 200mm /7.9"
H	M.,m. mum: 200mm /7.9"
I	Minimum: 200mm /7.9"
J	170mm/6.7"

The outside diameter of the toilet drain outlet: 95mm / 3.7";

The inner diameter of the toilet drain outlet: 87mm / 3.4".

ASSEMBLY INSTRUCTIONS

Installation

1. To replace an older toilet, turn off the water supply to the toilet. Remove and drain the water supply line. Remove toilet hold-down bolts/screws. Remove the toilet from the floor. Discard the old flange seal and hold-down bolts. Ensure that the center of the floor flange is at least 200 mm/7.9" away from the back wall.

2. When installing a new floor flange, ensure that toilet mounting holes are positioned at the correct angle. The floor flange must be secured to the floor using a minimum of four screws. Insert the two provided T-bolts into slots in the floor flange. Confirm that the floor flange seal is installed on the base of the toilet. Gently position the toilet over floor flange. Align the holes in toilet base with the T-bolts as you lower the toilet onto the floor flange.

3. Install the floor mounting nuts onto the T-bolts. When tightening, ensure that the base is firmly attached and flat against floor. Place the bolt covers over the nuts.

4. Connect water supply line to the ½-inch water inlet using the water pipe, then turn on the water supply. Flush the toilet several times and check for any leaks.



The water supply pressure: 0.2~0.4Mpa.

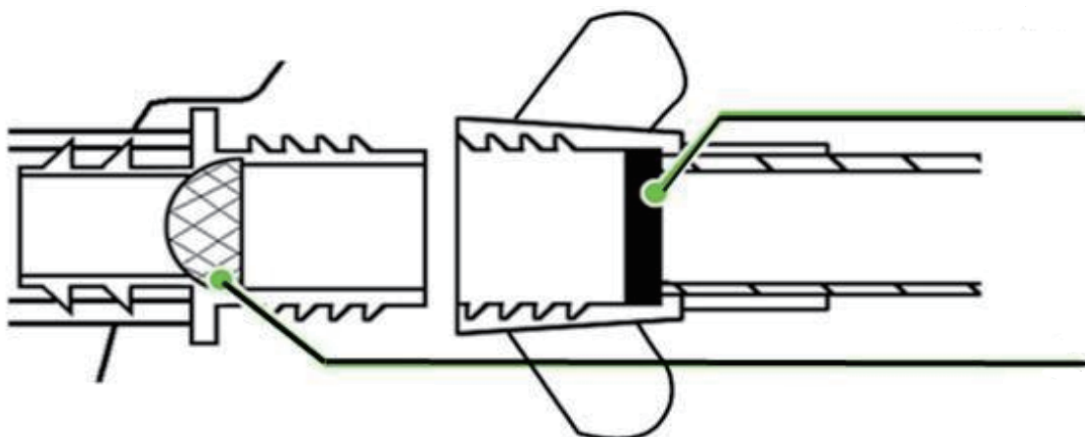

Water pipe joint with seal ring

Water inlet joint with filter (pr-assembled)

ASSEMBLY INSTRUCTIONS

Operation

1. Add water to bowl

To add water to the toilet, press the flush pedal partway down. Water flows into the bowl while the flush valve remains closed. If the flush valve moves, release the pedal slightly. Adding water to an empty bowl helps prevent holding tank odors from entering the living space. It is recommended to add water before flushing solids and toilet paper.

2. Flush the toilet

To flush, press the pedal down until it contacts the floor. Release the pedal after completing the flush.

When flushing liquids, press the pedal for 1-2 seconds.

When flushing solids, press the pedal until the contents in the bowl are rinsed.

Flushing longer than necessary will cause holding tank to fill too quickly.

A small amount of water will collect in the bowl after flushing, creating an airtight seal.

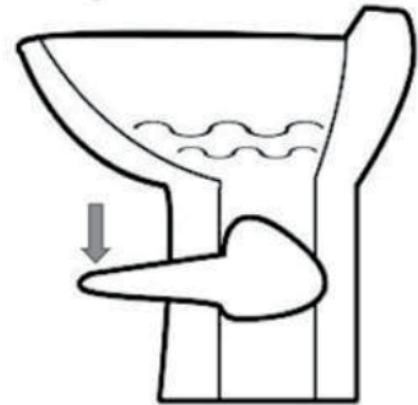

Flush valve / seal cleaning

After a period of time, mineral deposits from hard water may build up on the flush ball or seal, resulting in a slow water leak. To prevent this, periodically clean the flush valve and seal.

1) Remove minor debris from the flush valve and seal by slowly pressing and releasing the flush pedal several times. This will loosen and remove debris from the surfaces. Repeat several times for stubborn buildup. (Use a soft bristle brush if necessary)

2) Periodically lubricate the flush valve and seal with silicone spray or paste lubricant.

ASSEMBLY INSTRUCTIONS

Winterization and storage

This toilet is not intended for use when exposed to temperatures below freezing. Before storing the toilet, you need drain water from the toilet according to the following procedures.

- 1) Turn off the water supply to the toilet.
- 2) Remove the water supply line from the water inlet.
- 3) Place a small container under the inlet to collect draining water.
- 4) Press the flush pedal and allow water to completely drain from the water inlet.

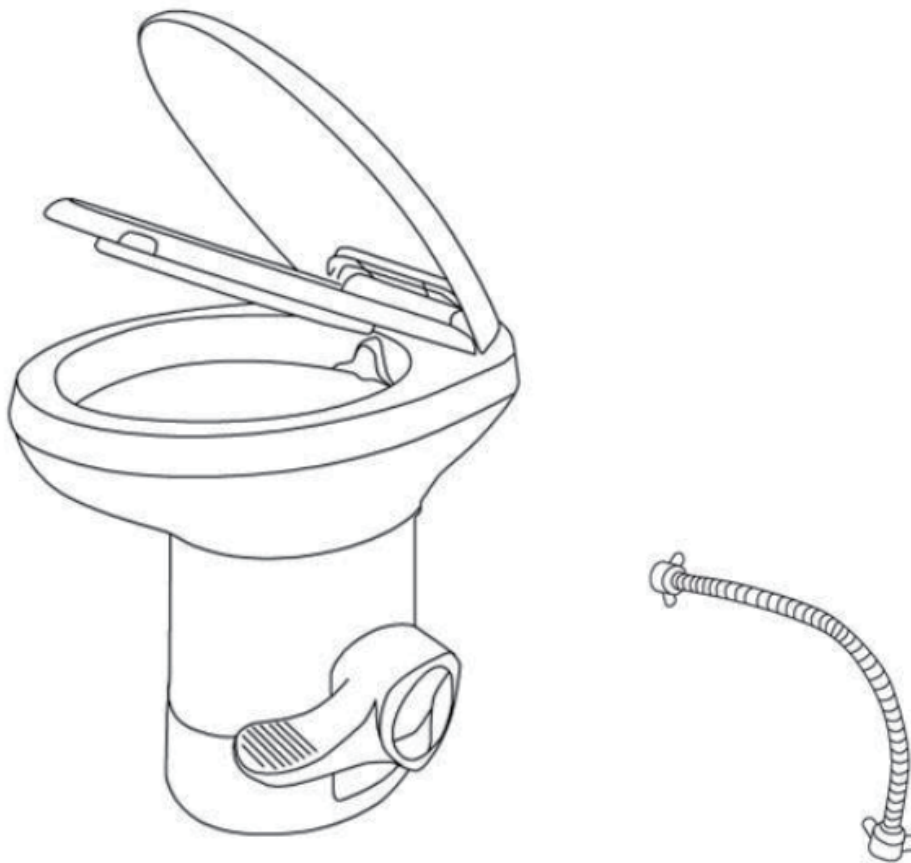

Leave the water line disconnected until the threat of freezing temperature disappears.5)

Thank you for your reading with great patience!

If you have any questions about the installation of Yitahome's Gravity Flush Toilet, just e-mail us at after-sale.cs@hotmail.com

ASSEMBLY INSTRUCTIONS

Main Features

Premium user comfort: American-standard full-size damping seat and lid, a large toilet bowl and a seat height of 478mm result in greater homelike performance.

Easy to flush: High-gloss toilet bowl with original T-type 3-way flush flow creates a high-speed, full bowl flush.

Ergonomically enhanced pedal operation: Lower pedal height for easier use. One-directional action to open drain valve and flush.

Easy installation: Two-bolt design fits most existing toilet floor flanges, great for new or replacement installations. Just place it on the floor flange, tighten the bolts, connect the water, and it's ready.

