

①	① light arm	② bolt screw	⑥	⑥ hanging ring	⑩	cap connector 3pcs	⑫	⑫ canopy 1pcs	⊗ X 1pcs
②			⑦	⑦ top cover	⑪	chain 1pcs	⑬	⑬ cap nut 2pcs	⊕ X 1pcs
③		③ bolt screw	⑧	⑧ bottom cover	⑭		⑮		⊗ X 3pcs
④	④ socket ring		⑨	⑨ bended profile	⑮				⊕ X 3pcs
⑤	⑤ light fixture								⊗ X 3pcs
									⊕ X 3pcs
									⊗ X 3pcs

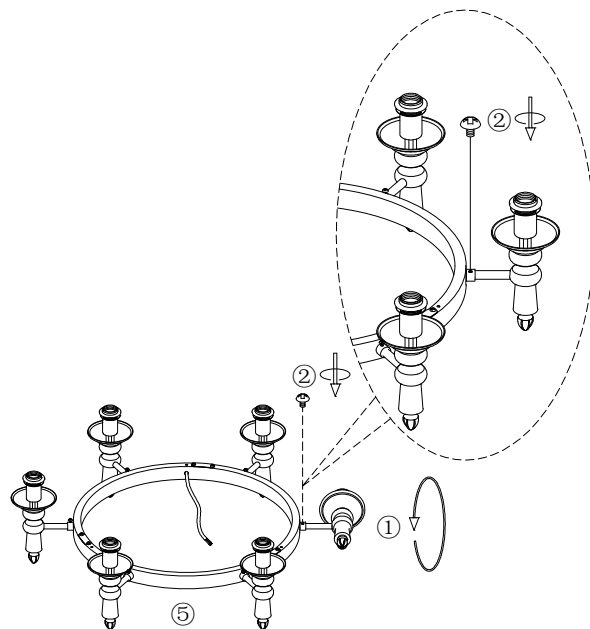

1. Rotate to loosen the screw ② and upward the light arm ① 90 degree to make it perpendicular to the ground, fasten it by rotate screw ②.

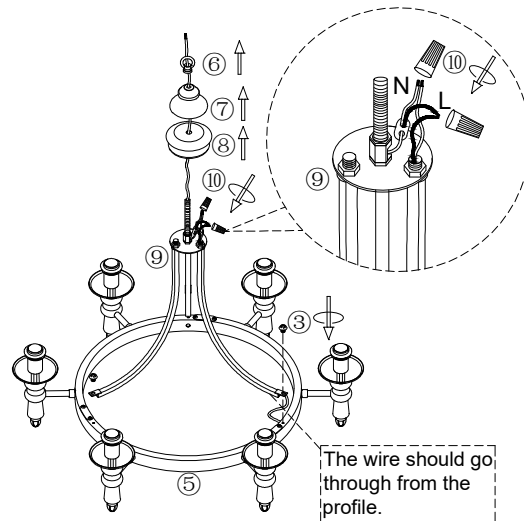

2. Loosen the hanging ring ⑥ to remove out the top cover ⑦ and bottom cover ⑧ from profile ⑨, let the wire of the fixture ⑤ go through the profile ⑨, install the profile ⑨ to the fixture with screw ③.  
3. Connect all the wires by parallel with connectors ⑩ (all live line-L use one connector, and neutral Line-N use another connector), close the bottom cover ⑧ and top cover ⑦ to the fixture with ring ⑥.

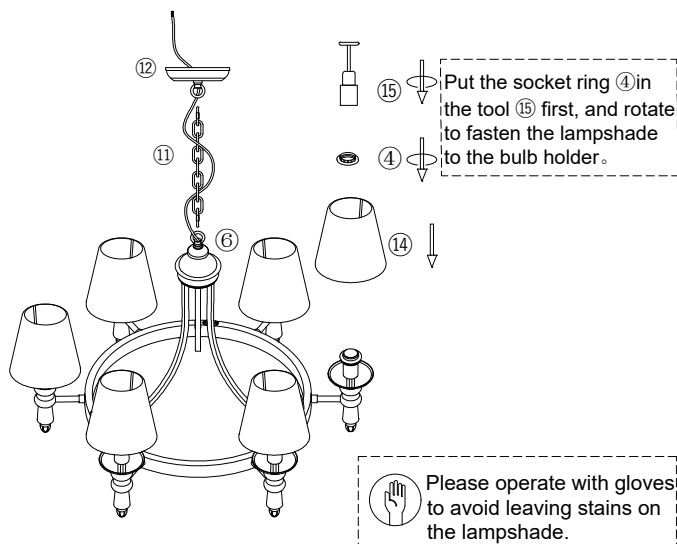

4. Hang the fixture to the canopy ⑫ with chain ⑪, let the wire go through the chain ⑪ and canopy ⑫.  
5. Rotate socket ring ④ to install the lampshade ⑭ to the fixture with tool ⑮.

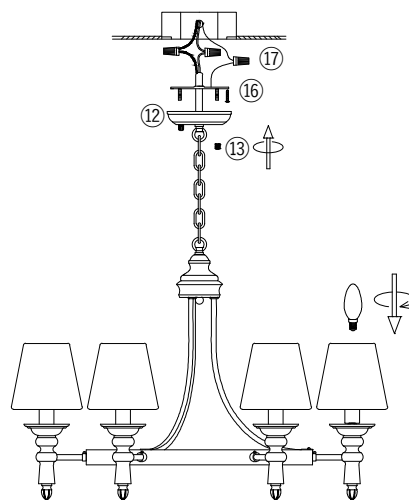

6. Install the bracket to the ceiling junction box with screw ⑯.  
7. Connect the wire to the home line with cap connector ⑰.  
8. Install the fixture to the bracket with cap nut ⑬.  
9. Install the bulb.

Please read carefully before installation!!!

Note: Please make sure that the electricity is powered off during installation !  
Only a professional electrician should install this kind of product !