

DeckTok

USER MANUAL

Smart Floor Lamp

What You Get

ITEM	QUANTITY
Light Pole	3
String Light	1
Lamp Base	1
Control Box	1
Power Adapter	1
Screw	9
Screw Driver	1
User Manual	1

At a Glance

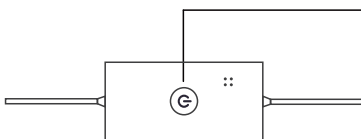
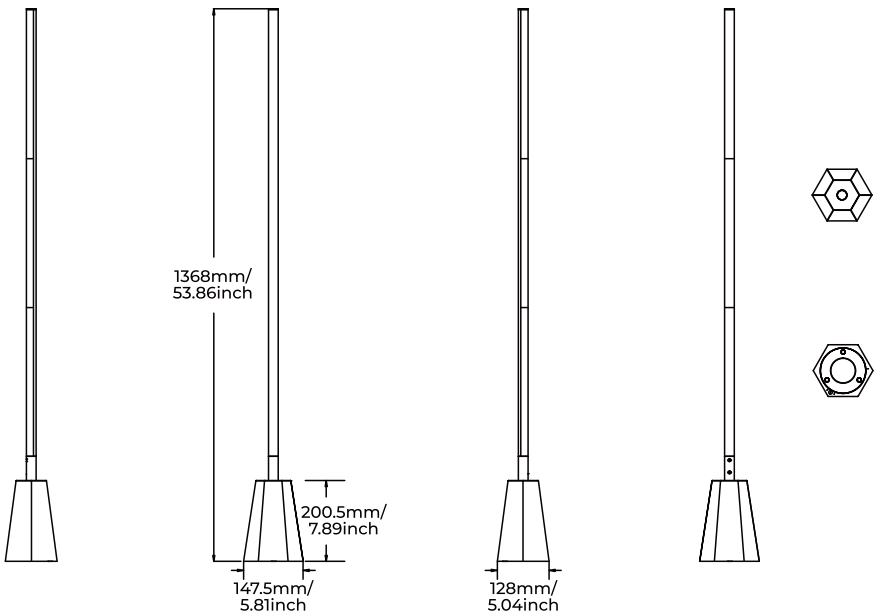

- Click once to switch the mode
- Click twice to turn off/on the light
- Long press for 5 seconds red light flashing in connection nextwork mode

Installation Drawing

①

Splicing sequence of aluminum rod

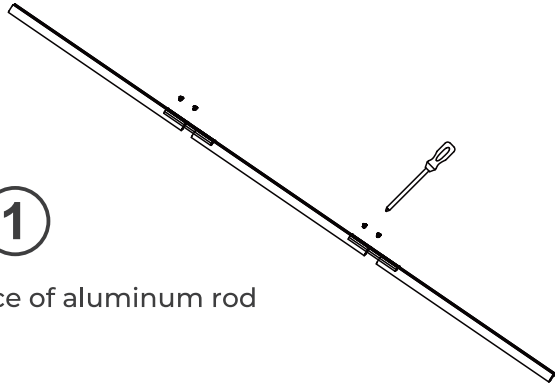

②

Splicing and assembling three aluminum rods

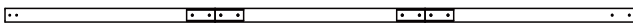

③

Assemble the aluminum rod onto the base and lock it with two M3 countersunk screws

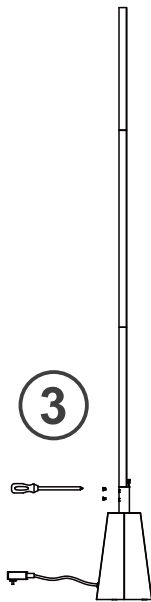

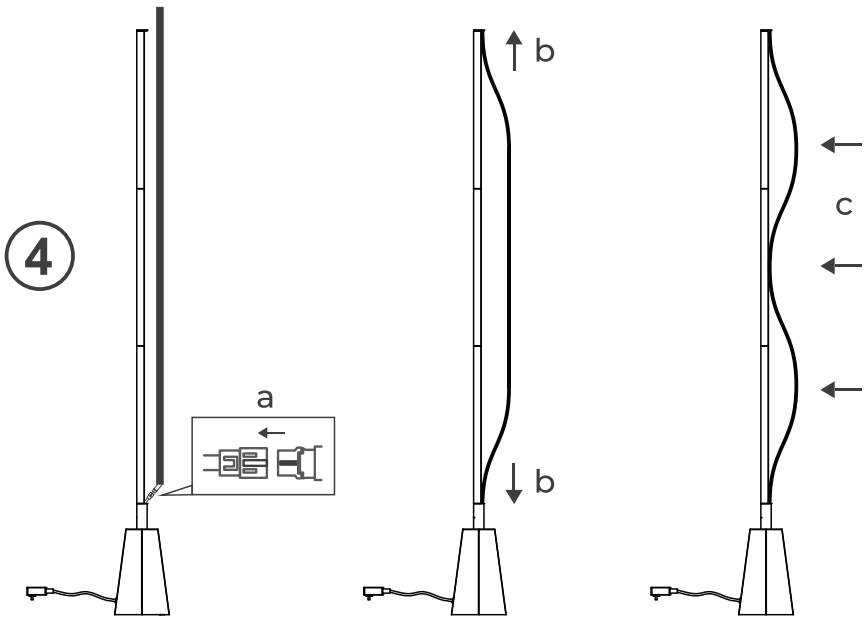

Assembling the neon light strip section

- a. Clip the top light strip to the aluminum pole.
- b. Next, insert the plug of the bottom neon light strip.
- c. Then clip the bottom neon light strip onto the aluminum pole.
- d. Finally, clip the rest of the neon light into the aluminum pole.

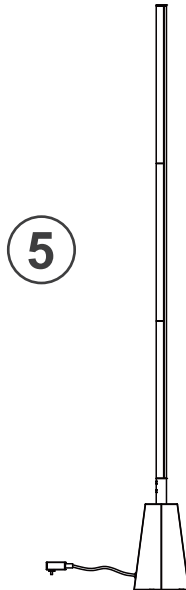

The entire lamp assembly is completed

Setting Up The System

1. Download the Decktok App from APP Store in Apple iPhone / APP market in Android mobile phone.



2. Connect to a 2.4GHz WiFi network and turn on your smartphone's Bluetooth.
3. Long press the on/off button of the control box for 5 seconds. When the red light flashes, you can open the app to connect to the network.
4. Click Add Device or click + icon on the upper right corner of the APP home page, to choose Add Device and enter the Add interface for selecting the device to be added.
5. When the device is connected to the network, the Add device interface will automatically pop up the device icon. Tap the device icon and follow the on-screen instructions to complete pairing.

Specifications

Adapter Input	AC 100-240V ~50/60HZ
Lamp Input	24V / 1A
Lumen	1500lm
Lighting Color	RGBWW
Color Temperature	2700K-6500K
Control Method	APP,Voice Control,Control Box
Working Temperature	14°F-104°F

Notice

- The product is only suitable for indoor use, avoid long time work in humid environment;
- Do not soak the product in water or other liquids;
- When installing, the screws need to be locked firmly and not loose;
- Do not install the product in a high temperature environment;
- The adapter needs to be connected in place, and there must be no looseness or poor contact;
- Use the product with the provided power adapter only;
- Do not allow children to install the floor lamp alone;
- CAUTION-The product is not a toy. Children and the disabled should use it under adult supervision.

Troubleshooting

1. Unable to connect to the App

- Ensure the light strip is powered on.
- Check if Bluetooth is enabled on your phone.
- Make sure your phone is connected to a 2.4GHz Wi-Fi network.
- Long-press the control box button for five seconds until the red light flashes to activate pairing mode.

2. The light does not glow

- Unplug the power adapter, disconnect and reconnect all components, then plug the power adapter back in.
- If the issue persists, please contact DeckTok's official customer service.

Customer Service

Warranty: 12-month Limited Warranty

 www.decktok.com

 info@decktok.com

