



## WARNING:

CHOKING HAZARD/SHARP POINTS- Assembly hardware contains small parts and components with sharp points. Adult assembly required.

### Tools Required:

- 4mm Hex Wrench (Provided)
- Medium Phillips Screwdriver

### Hardware Included:

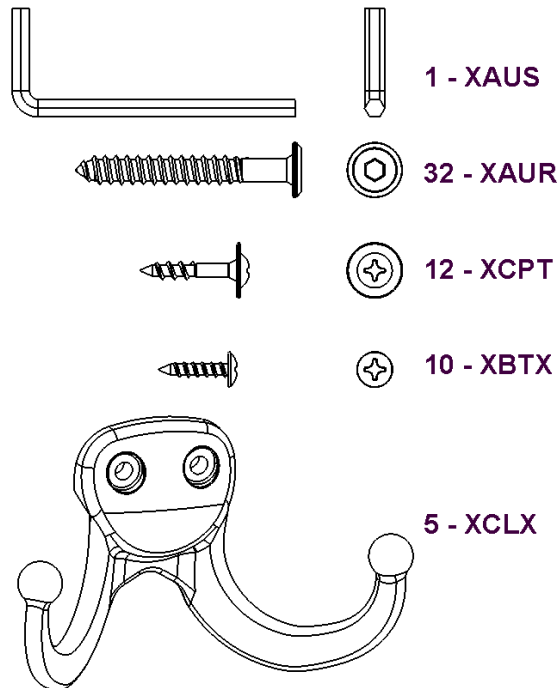

Not Actual Size

## Instructions for: 7106YT Coat Locker, 5-Section

### Hardware Package HCJX

Qty	Description
(1)	<b>XAUS</b> 4mm Hex Wrench
(32)	<b>XAUR</b> 2" Decorative Screw
(12)	<b>XCPT</b> #8 X 0-7/8" Washerhead Screw
(10)	<b>XBTX</b> #6 Truss Screw
(5)	<b>XCLX</b> Almond Double Coat Hook

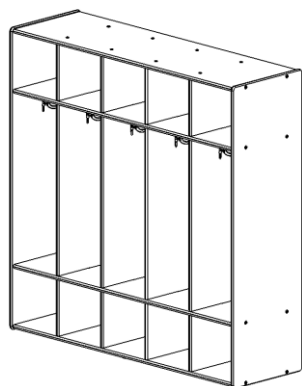

### Parts:

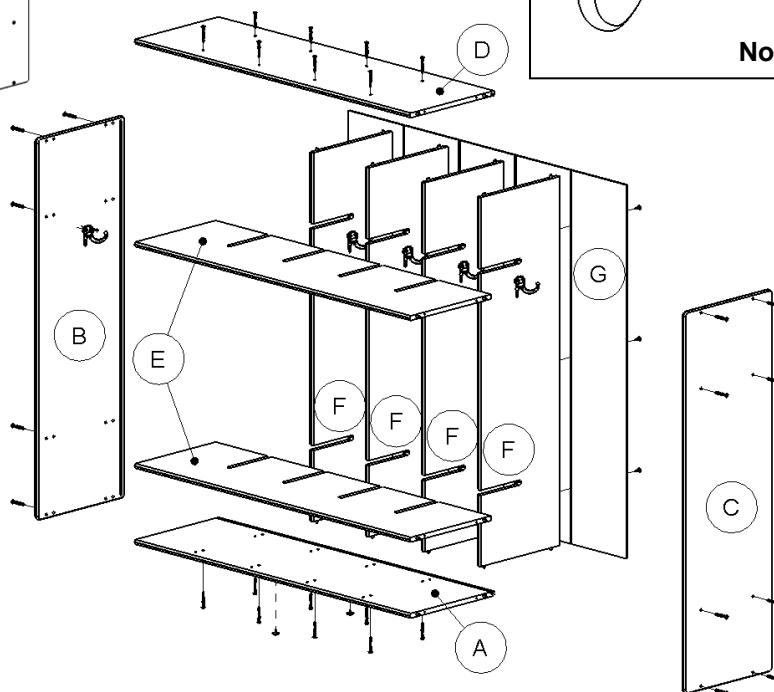

DHCJX – Rev. B – 23 October 2019

800-543-4149

507-342-5169

[www.jonti-craft.com](http://www.jonti-craft.com)

JonTi-Craft, Inc.

171 Hwy 68

P.O. Box 30

Wabasso, MN 56293

## Assembly Instructions:

1. Begin by installing 5-**XCLX** Nylon Coat Hooks to 1-**LH Side-B** and 4-**Dividers-F** using 10-**XBTX** Truss Screws.

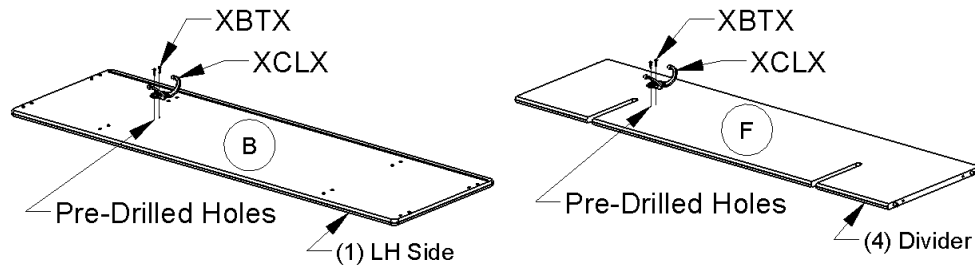

2. Assemble locker face down. Install **Shelves-E** to **LH Side-B** by aligning dowels in Shelves with dowel holes in Side. Ensure back groove is up on LH Side, and Shelf 'rounded edges' are down. Secure with 4-**XAUR** Decorative Screws with 4mm Hex Wrench provided.

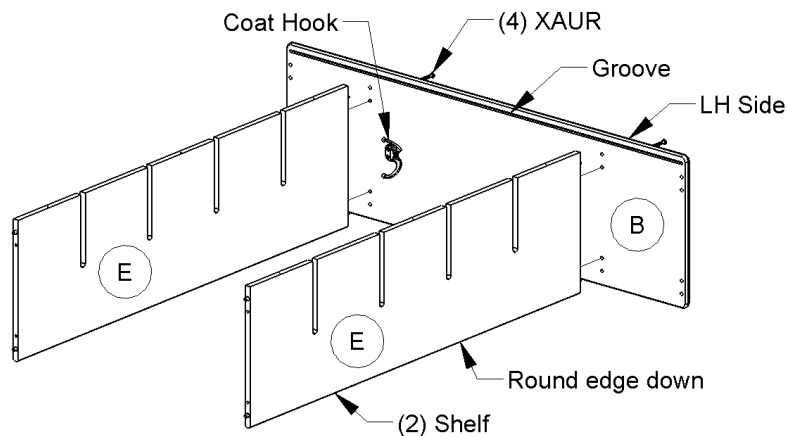

3. Install 4 **Dividers-F** with rounded edge down. Align Divider cutouts with Shelf cutouts ensuring all coat hooks are towards the top.

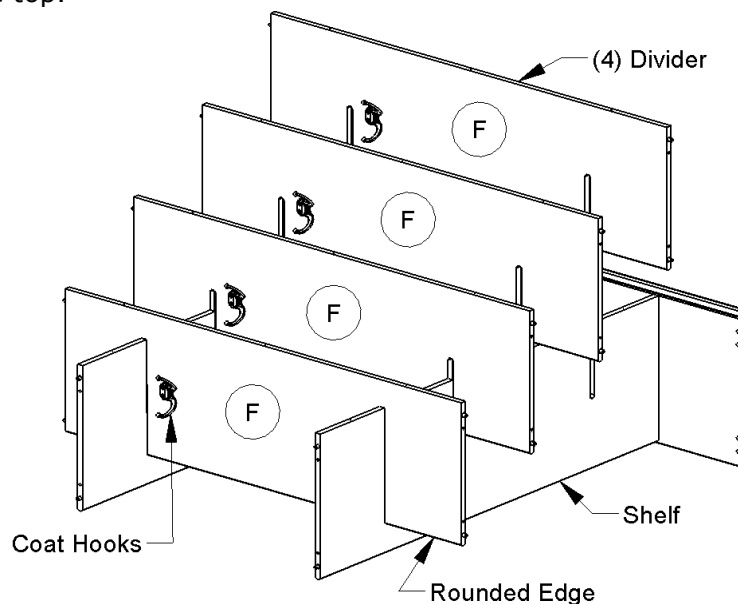

3. Align dowels of Bottom-A with dowel holes in LH side and 'partially' install with 2-**XAUR** Decorative Screws. Align dowels with each Divider to Bottom dowel holes and install 8-**XAUR** Decorative Screws. Tighten XAUR Screws to the LH Side.

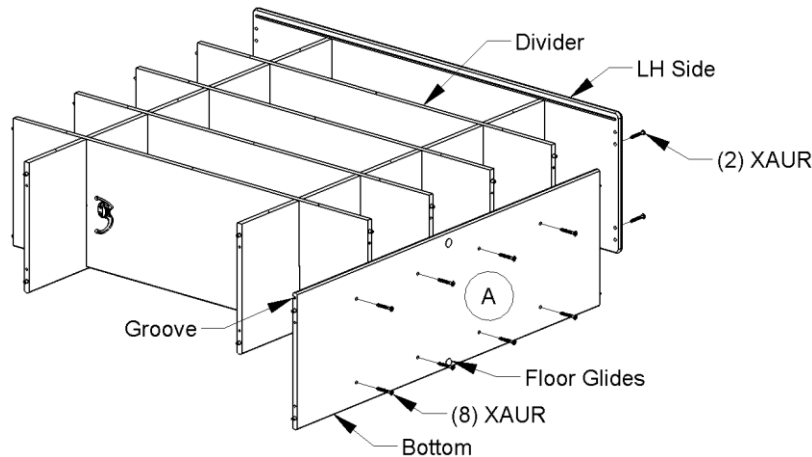

4. Align dowels of Top-D with dowel holes in LH side and 'partially' install with 2-**XAUR** Decorative Screws. Align dowels with each Divider to Top dowel holes and install 8-**XAUR** Decorative Screws. Tighten XAUR Screws to the LH Side.

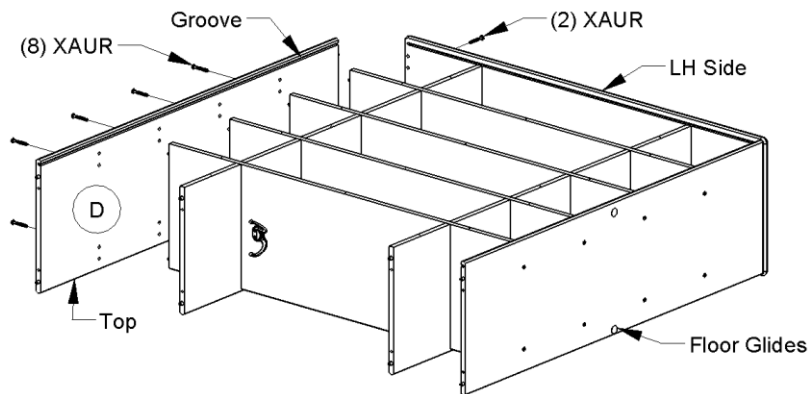

5. Install RH Side-C to Top, Bottom and Shelves by aligning dowels into dowel holes in RH Side. Secure with 8-**XAUR** Decorative Screws with 4mm Hex Wrench provided.

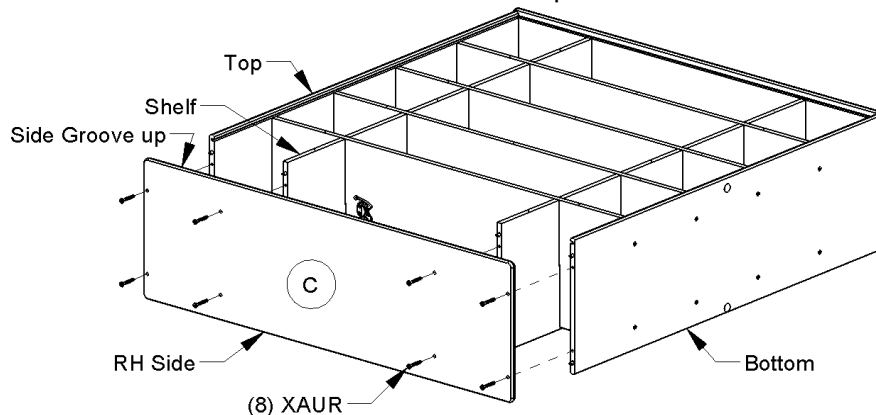

6. Insert 2 **Backs-G** by inserting into groove on Top and bowing into other groove on the Bottom. Slide into LH/RH Side grooves.

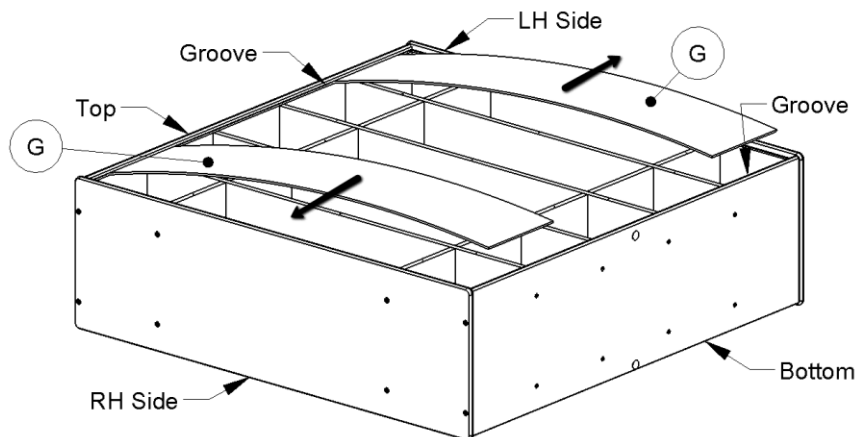

7. Locate pre-drilled holes in the edge of each Divider and install 6-**XCPT** Washerhead Screw, do not tighten!

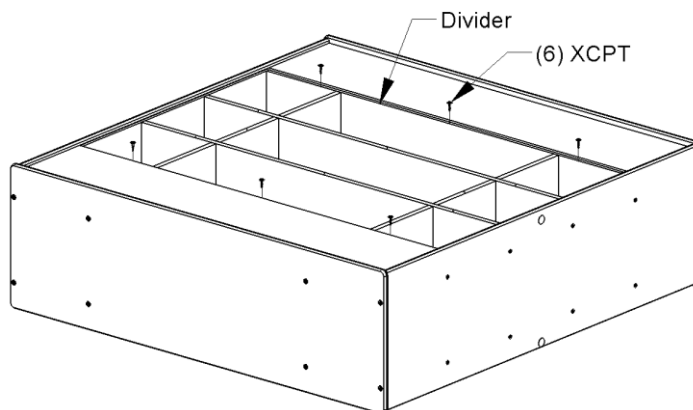

8. Install remaining 3-Backs in the same manner. Once all backs and screws are installed tighten all screws.

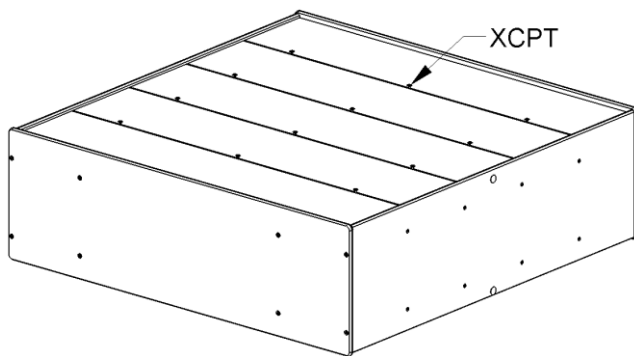

9. Stand unit upright.
10. If you experience any difficulties when assembling this product, please contact the Jonti-Craft Customer Relations Team at (800) 543-4149 or [sales@jonti-craft.com](mailto:sales@jonti-craft.com). All other requests for assistance must be directed to your Jonti-Craft Dealer.

**General Care & Maintenance Guidelines:** [www.jonti-craft.com/generalcare](http://www.jonti-craft.com/generalcare)