

## Programming the Awning Remote

**Note: During the settings, the programming time (step 1-5) must be shorter than 10 seconds; otherwise it will quit the setting and you need to start over again.**

**Step 1:** Put the battery on the remote control.

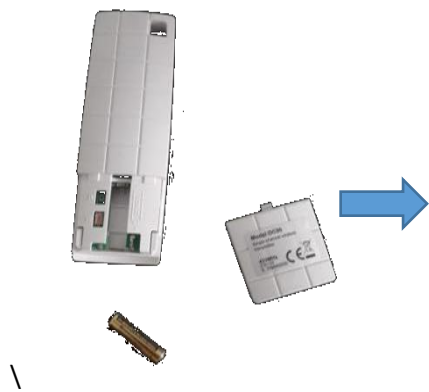

**Step 2:** Put the plug in the socket.

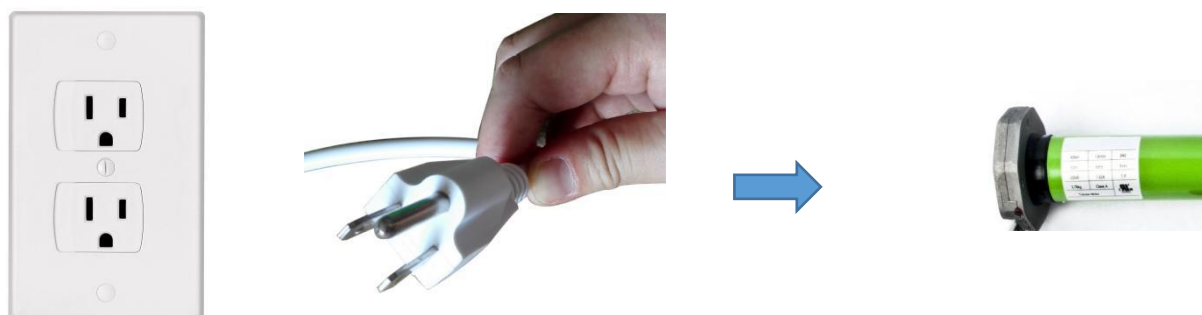

**Step 3:** Press **P2** two times. (Hold the button for 1 sec each time)

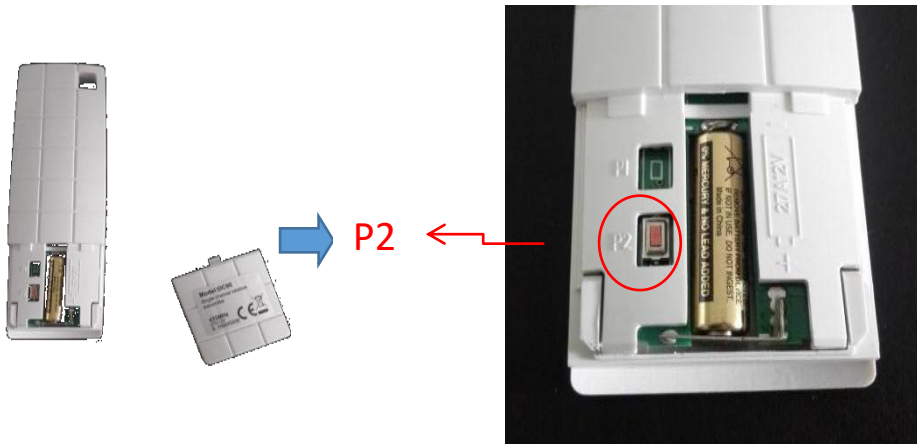

**Step 4:** Press **up button** twice time, remote will be programmed successfully.

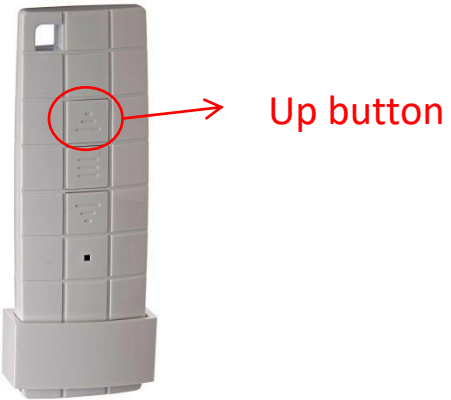

**Step5:** Press UP button once again to activate the motor.



## How to set limit position

**Note: When motor doesn't work stop rotating red or white worm with regulator.**

### Set extension limit position:

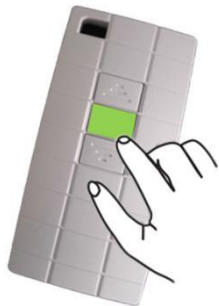
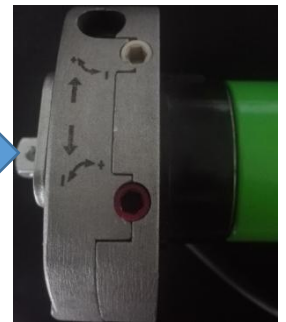
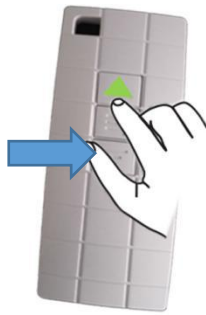
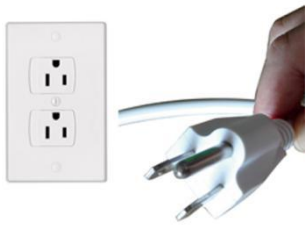

Power on

Press up button  
one time

Using special regulator  
to adjust "+" direction,  
and rotating red worm  
when need to increase  
the extension distance.  
(When the motor is in  
the left side)

When extension limit  
distance achieves the  
desired location, stop  
rotating red worm and  
press the stop button.  
**Extension limit setting  
is ok.**

### Set retraction limit position:



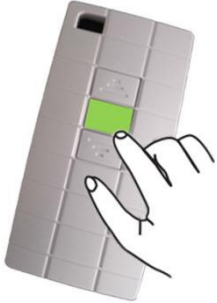
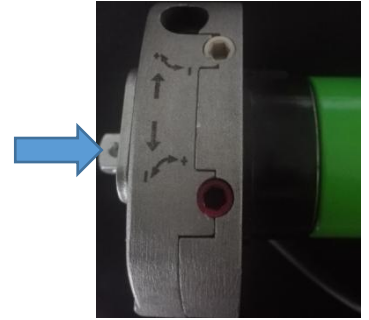
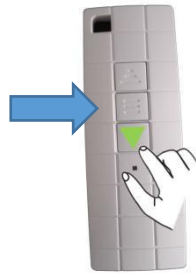

Power on

Press down button  
one time

Using special regulator  
to adjust "+" direction,  
and rotating white  
worm when need to  
increase the retraction  
distance. **(When the  
motor is in the left**

When retraction distance  
achieves the desired  
location, stop rotating  
white worm and press the  
stop button. **Retraction  
limit setting is ok.**

*\*\*\*\* Opening direction may be different when the motor is installed, if it is attached inversely or on the other side.  
Please check the motor opening direction during adjustment.*