

### Features

1. Solid wood and Ash veneered plywood;
2. Two doors with long interlock handle;
3. Interior shelf adjustable;
4. Three soft closing drawers with dovetail construction;
5. Countertop thickness laminated to 1.2";
6. Double 20" rectangular undermount sink cutout;

### Colors / Finishes

GYA - Grey Ash;  
BA - Brown Ash;  
GA - Glacier Ash;

### Countertops

WM - Natural White Carrara marble;  
BG - Natural Black Galaxy Granite;  
GY - Natural Grey Granite;  
WE - White Engineer Stone;

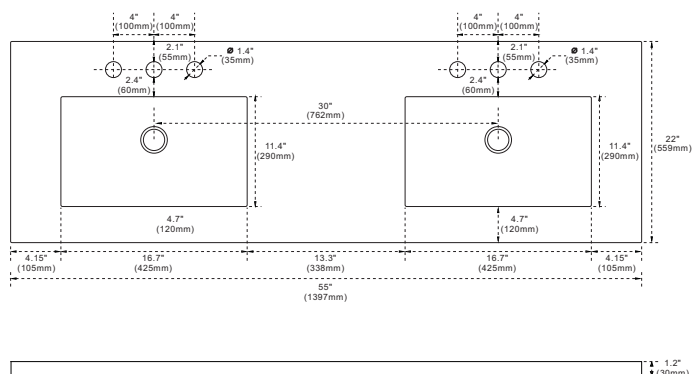

Top view

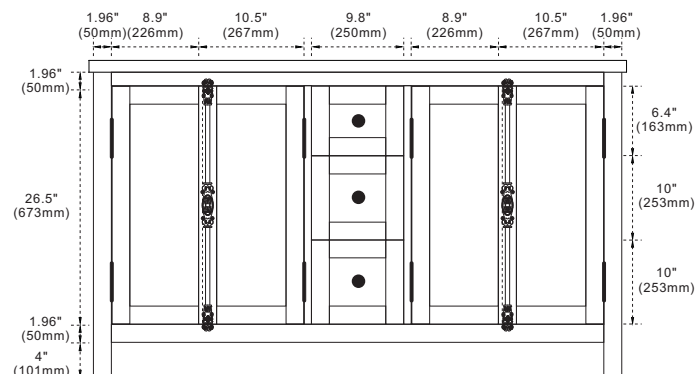

Front view

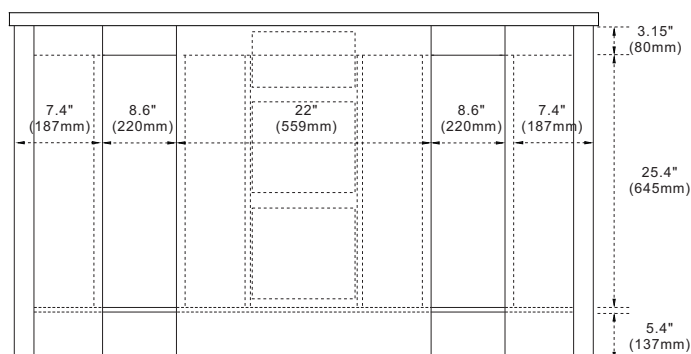

Back view

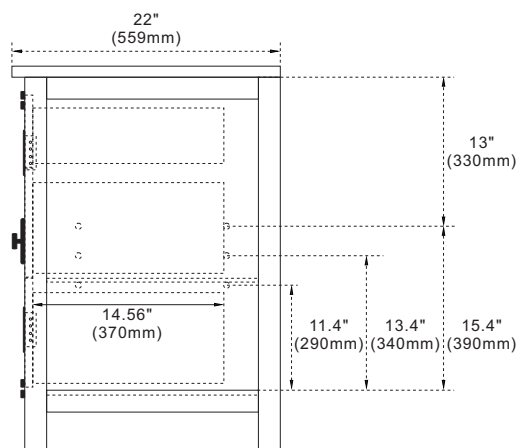

Side view

**NOTE: SINK STYLE, SHAPE, FAUCET HOLES, CUTOUT ON TOP, VANITY MAY VARY FROM THE PICTURE ABOVE. INSTRUCTIONAL PURPOSE ONLY.**

Professional installation is recommended.

All Rights Reserved