

# MODELLO i **PLANNING GUIDE**

## 3-Bar Horizontal Setup

This layout shows a standard 3-bar configuration. If desired, you can modify the spacing or add additional bars to suit your specific needs and preferences.

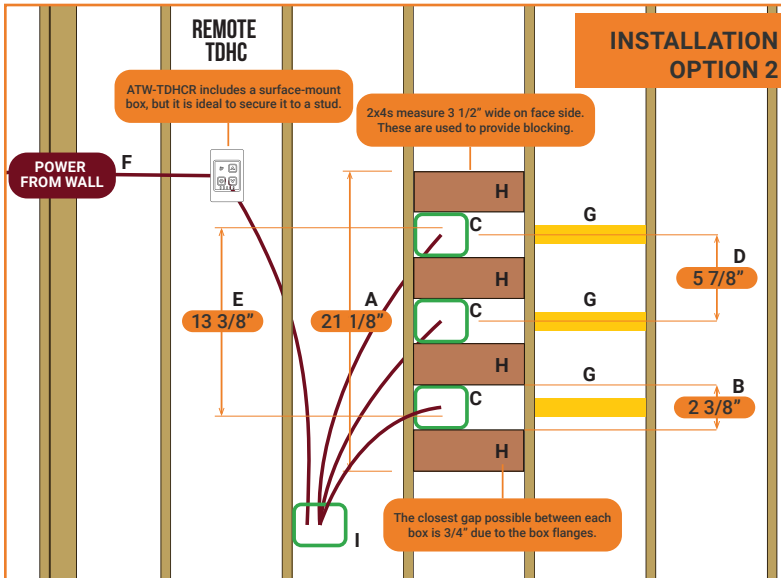
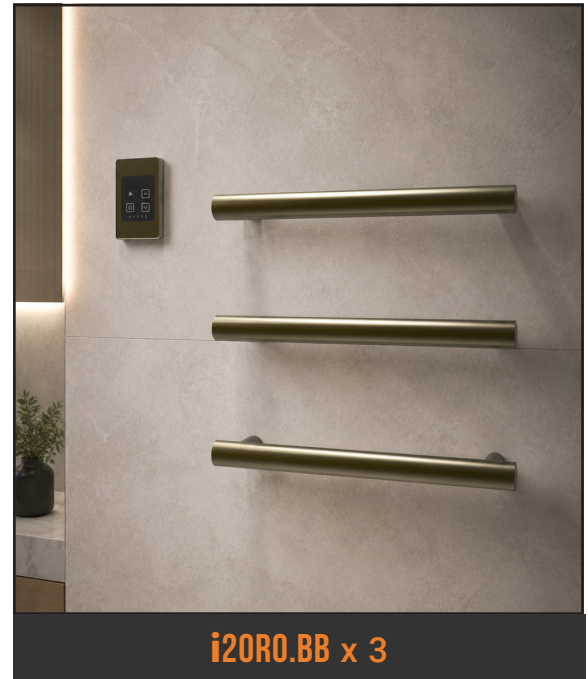
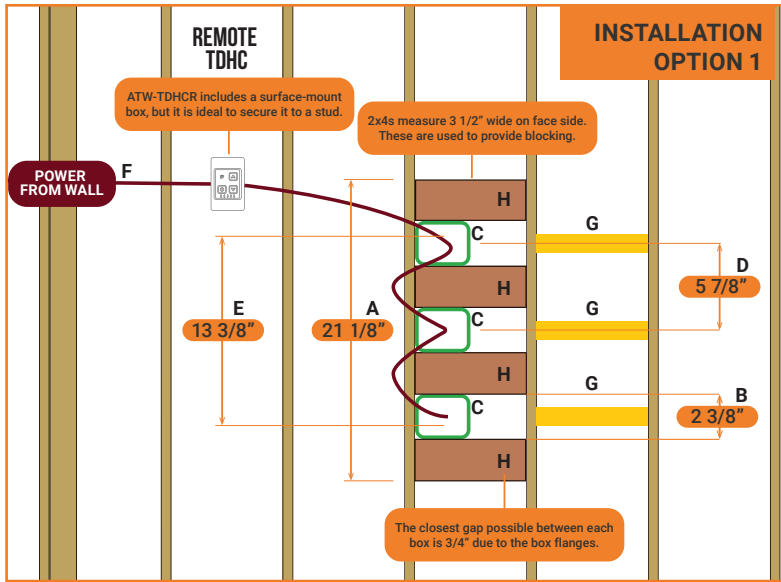

These images show two options for wiring the Modello i towel bars. Both options are ETL certified, but National Electrical Code (NEC) requirements supersede ETL wiring methods. Depending on the local electrical codes, option 2 may be the required wiring configuration.

**Option 1:** Wired in series - power supply from wall run to Remote TDHC. A wire is then run from the remote TDHC to the first bar, then from the first bar to the second bar. Each subsequent bar is wired from the previous bar.

**Option 2:** Wired in parallel - power supply from wall run to Remote TDHC. A wire is then run to a separate junction box. From junction box, separate wires are run to each individual bar.

A - Top of blocking to bottom

B - Gap between blocking for concealed wall box

C - Concealed wall box placement (ATW-CWB)

D - Center-to-center between boxes

E - Distance from top of 1st bar to bottom of 3rd bar

F - Wires from wall to the ATW-TDHC

G - Blocking for non-electrical mounting point

H - Blocking for concealed wall box (ATW-CWB)

I - Standard Junction Box

ITEMS	LIST PRICE	COST
i20RO.BB x 3	US\$550 / CAD \$1,100	US\$1,650 / CAD \$3,300
ATW-CWB x 3	US\$100 / CAD \$160	US\$300 / CAD \$480
ATW-TDHC-BB x 1	US\$480 / CAD \$740	US\$480 / CAD \$740
<b>TOTAL:</b>		<b>US\$2,430 / CAD \$4,520</b>



SCAN FOR  
MODELLO i  
INSTALLATION  
GUIDE



www.ambaproducts.com | +1(404) 350-9738

SCAN FOR  
MODELLO i  
TECHNICAL  
DRAWINGS

