



EBV-136-A

CODE #3325453

SOLENOID OPERATOR

- 1** Turn off water and relieve pressure by loosening and then retightening the Tailpiece Coupling.

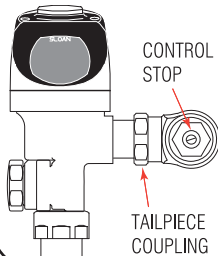

Loosen and remove top Screws along with the Outer Cover Assembly.

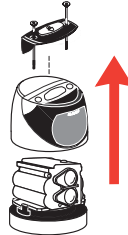

- 2** Disconnect Wire Clip from Battery Door and remove Module from Inner Cover Assembly.

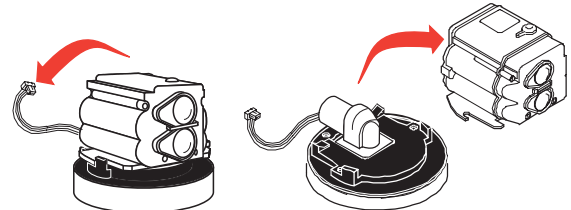

- 3** Remove Solenoid by turning counterclockwise. Remove any remaining O-rings or parts in orifice.

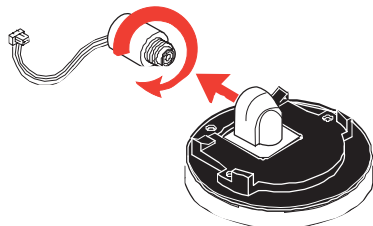

- 4** Remove Plastic Housing from the threaded end of new Solenoid Operator by unscrewing (counterclockwise). It is normal to find fluid inside this Housing.

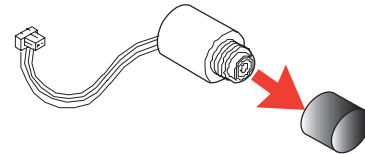

- 5** Make sure O-rings or Spider O-ring† is installed on the End Cap of the new Solenoid Operator. Install Solenoid Operator by threading it clockwise into the Housing. Tighten with fingers beyond just snug.

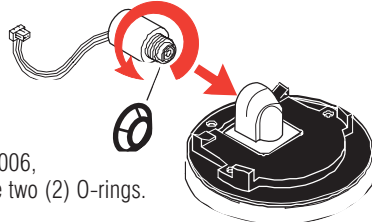

† Prior to 7/1/2006, Solenoids use two (2) O-rings.

- 6** Mount Module on Inner Cover Assembly. Reconnect the Plastic Clip on the Battery Door.

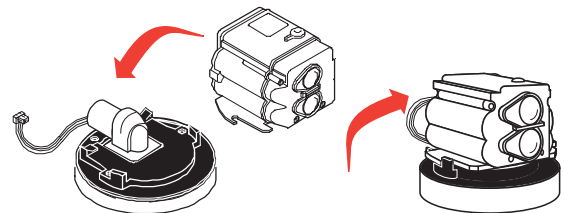

- 7** Assemble Outer Cover Assembly and secure with Screws.

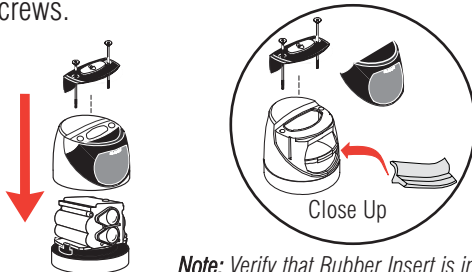

Note: Verify that Rubber Insert is installed.

- 8** Turn on water at Control Stop. Installation is now complete.

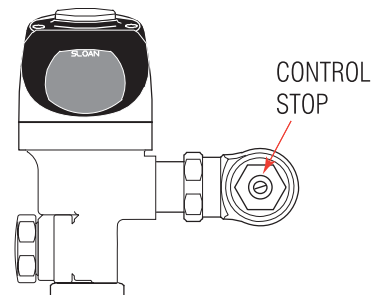

any
questions
?

The information contained in this document is subject to change without notice.

- We recommend that you review our G2 OPTIMA Plus Installation Instruction Manual and Maintenance Guides for complete instructions including Rough-in Dimensions, Specifications, Troubleshooting Guide, and Replacement Parts.
- Call our Installation Engineers for additional information at 1-888-SLOAN-14 or fax them at 1-800-737-3061.

SLOAN

SLOAN VALVE COMPANY • 10500 SEYMOUR AVENUE • FRANKLIN PARK, IL 60131

Phone: 1-800-9-VALVE-9 or 1-847-671-4300 • Fax: 1-800-447-8329 or 1-847-671-4380 • www.sloanvalve.com

Copyright © 2006 Sloan Valve Company • Printed in the U.S.A. • Made in the U.S.A. • EBV-136-A SOLENOID V.I.G. 0816576 — Rev. 0a (10/06)