

INSTRUCTION MANUAL

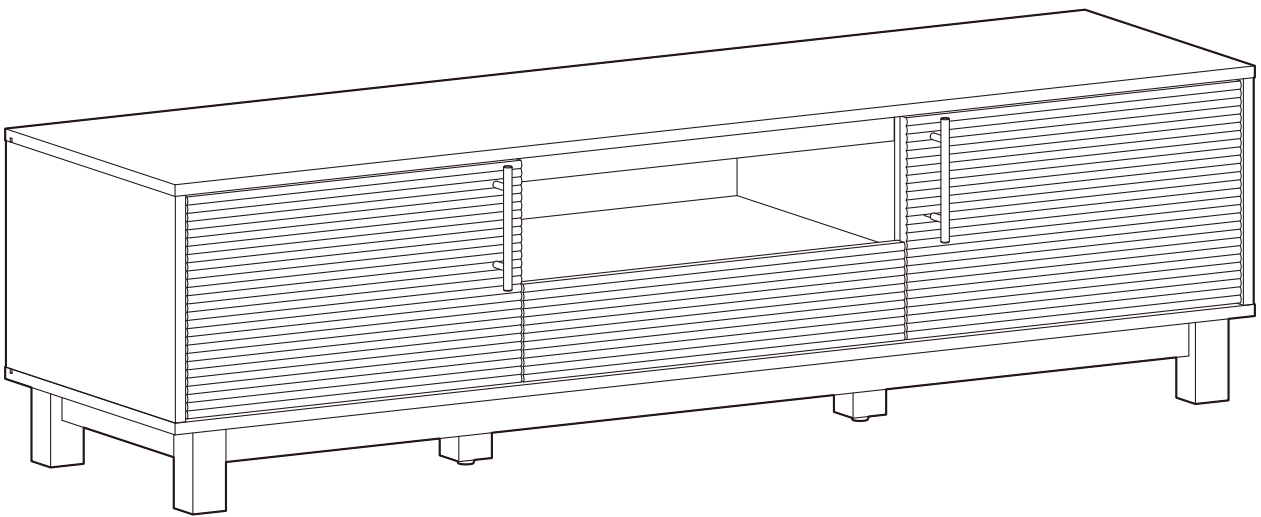

TV Console

Important Safety Information

- Please carefully read all instructions before attempting installation. If you DO NOT understand the instructions or have any questions or concerns, please call technical support or email customer service.

CAUTION: Avoid potential injuries and property damage!

- DO NOT use this product for any purpose that is NOT explicitly specified in this manual. We are NOT liable for damage or injury caused by improper mounting, incorrect assembly or inappropriate use.

WARNING: This product contains small parts that may pose a choking hazard.

- Before starting assembly, verify all parts are included and undamaged. DO NOT use damaged or defective parts. If you require replacement parts, please call technical support or email customer service.

Care and Maintenance

- Please clean the product with a damp cloth or mild detergent.
- Do not use bleach or other abrasive cleaners.

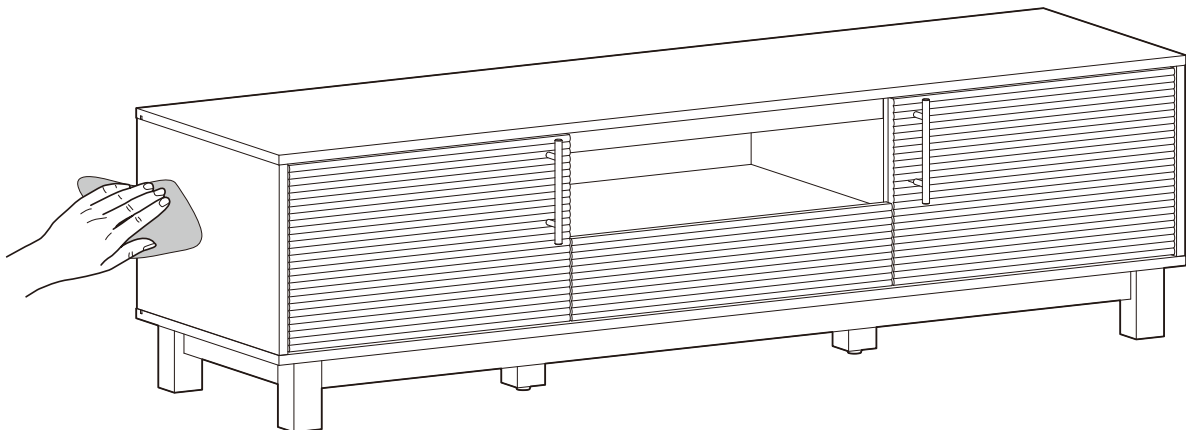

Installation Tips

- It is recommended that at least two people install this product together.
- Make sure you have enough space to lay the parts out before assembling.
- To avoid scratches, assemble this product on unfolded cardboard or a soft surface.

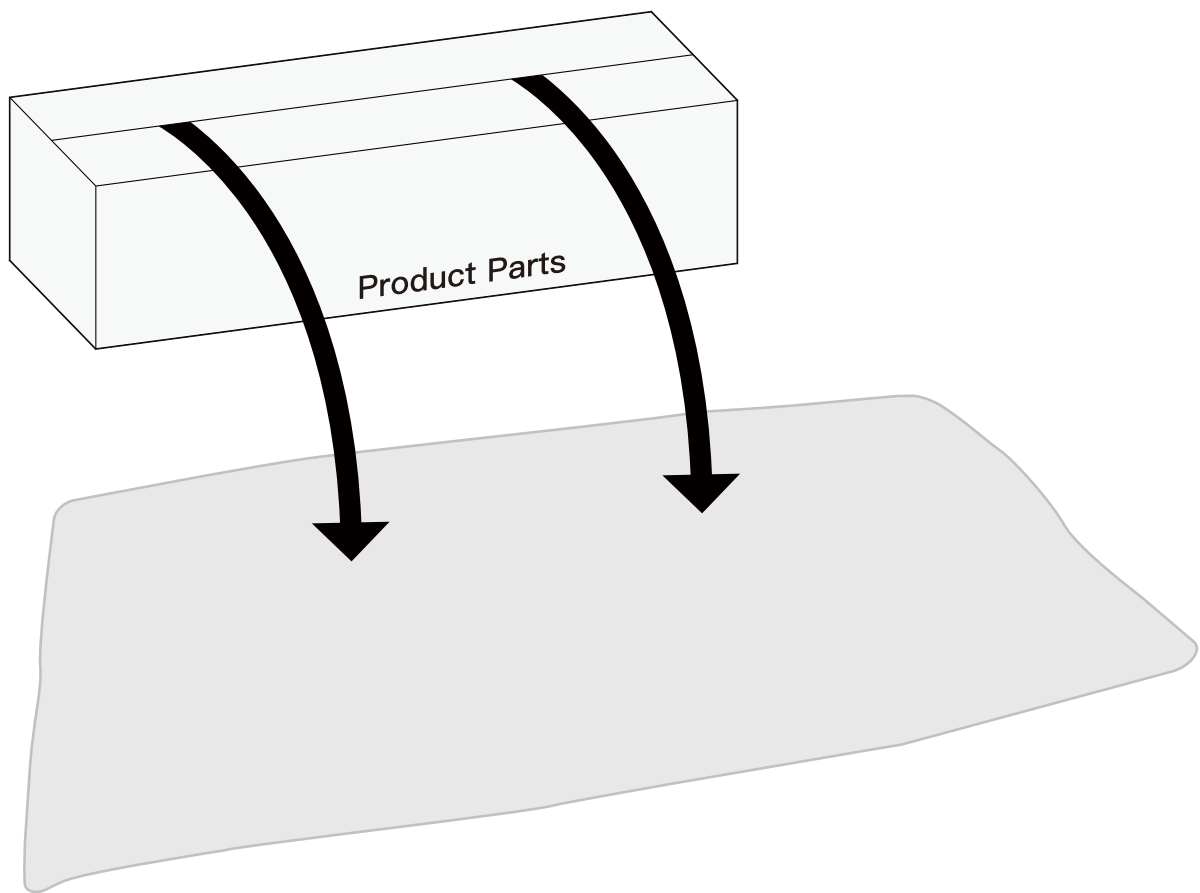
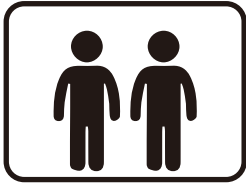

Tools Needed (Not Included)

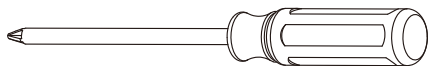

Phillips Screwdriver

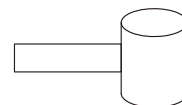

Rubber Mallet

How the Assembly System Works

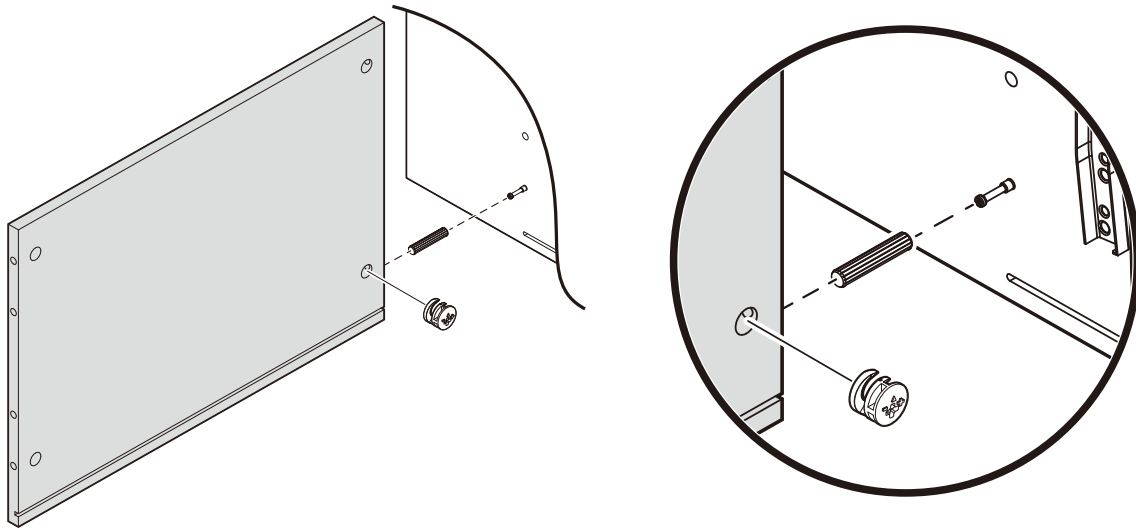

How to Install Wood Dowels

Insert the wood dowel [C] at least halfway into the hole. IF NECESSARY, lightly tap the wood dowel with a self-supplied rubber mallet.

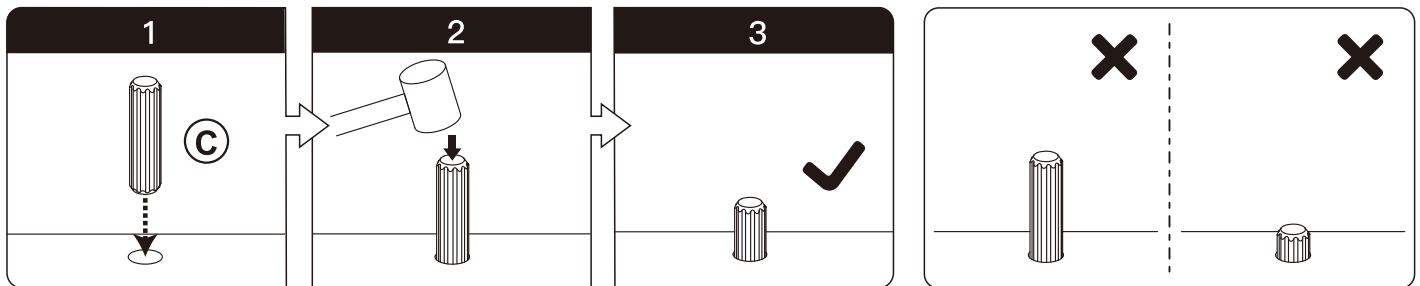

Using the Cam Lock System

1. Screw cam bolt [A] into threaded hole on the panel.
2. Connect both panels together. Make sure cam bolt [A] goes into the pre-drilled hole on the end of the panel for cam lock [B1/B2].
3. Insert cam lock [B1/B2] into large hole on the panel. Make sure the open slot on cam lock [B1/B2] faces the head of cam bolt [A].
4. Turn cam lock [B1/B2] clockwise to tighten.

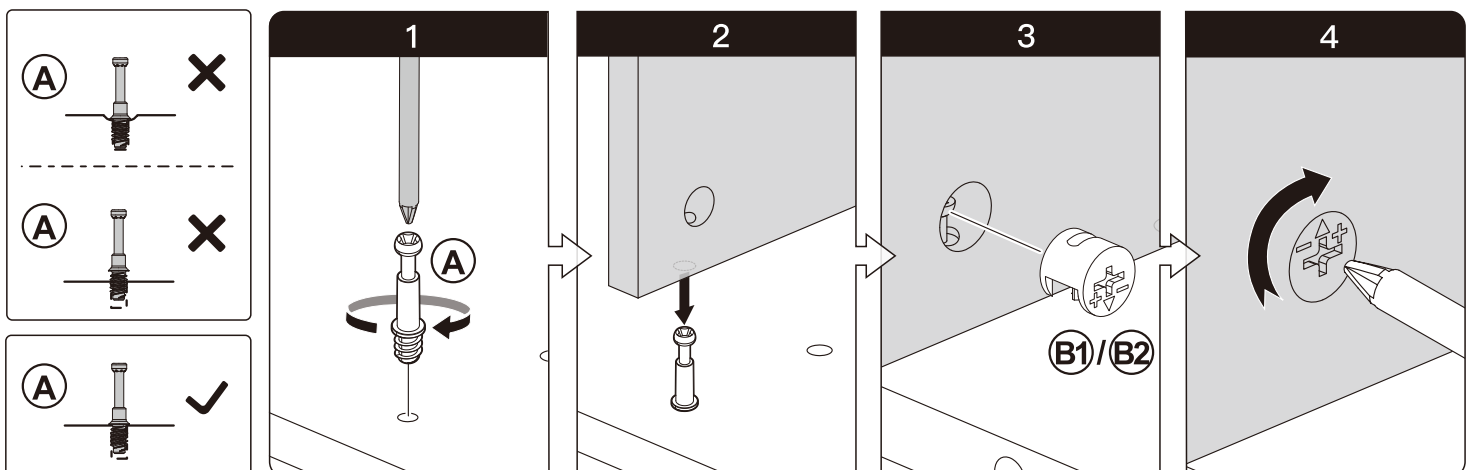

You are now ready to assemble the unit.

Exploded Drawing

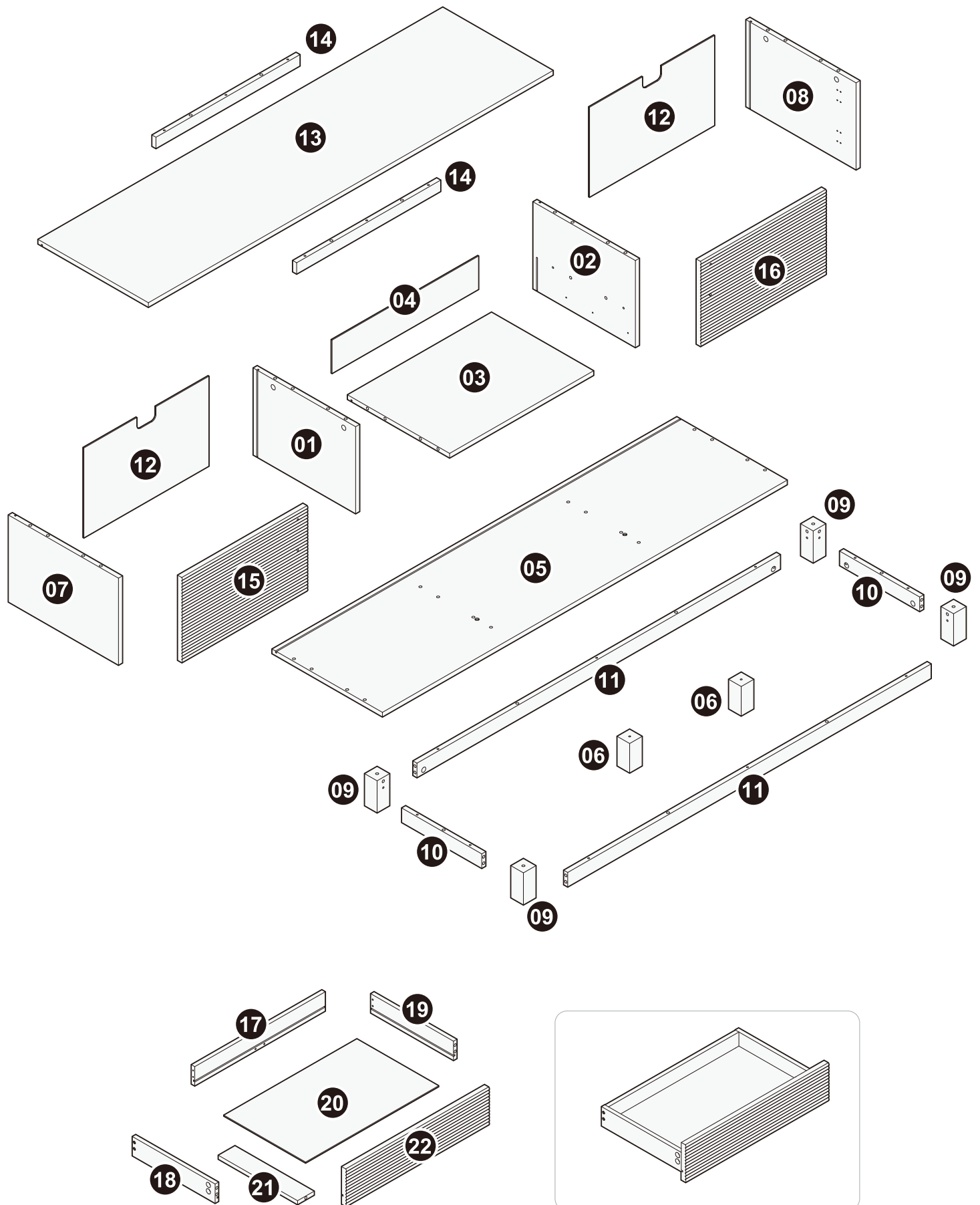

Supplied Parts and Hardware

01 x 1

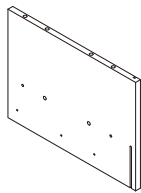

Left
Inside Panel

02 x 1

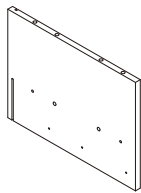

Right
Inside Panel

03 x 1

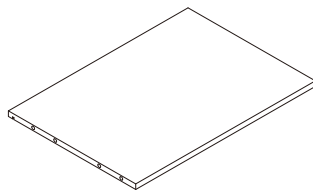

Middle
Shelf

04 x 1

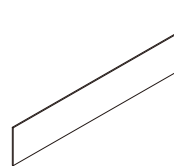

Middle
Back Panel

05 x 1

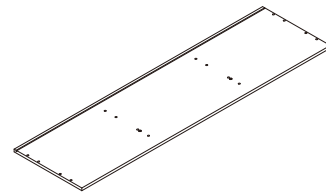

Bottom
Panel

06 x 2



Center
Leg

07 x 1

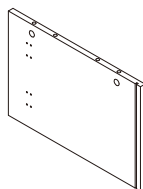

Left
Side Panel

08 x 1

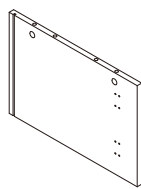

Right
Side Panel

09 x 4



Corner
Leg

10 x 2

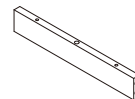

Bottom
End Rail

11 x 2

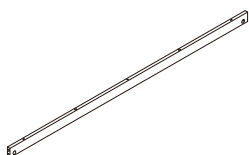

Bottom
Side Rail

12 x 2

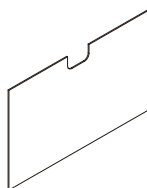

Back
Panel

13 x 1

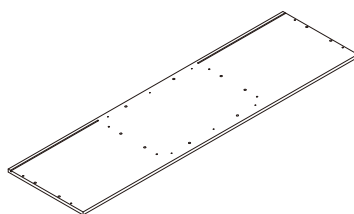

Top
Panel

14 x 2

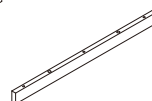

Center
Rail

15 x 1

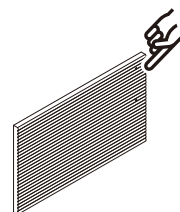

Left
Door

16 x 1

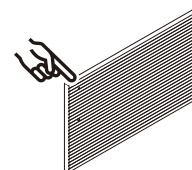

Right
Door

17 x 1

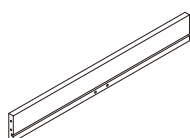

Drawer
Back Panel

18 x 1

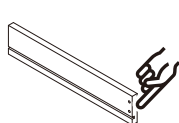

Drawer
Side Panel (L)

19 x 1

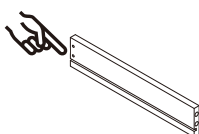

Drawer
Side Panel (R)

20 x 1

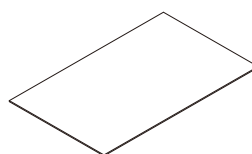

Drawer
Bottom Panel

21 x 1

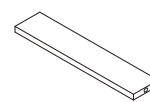

Drawer
Bottom Support

22 x 1

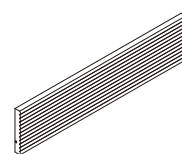

Drawer
Front Panel

Supplied Parts and Hardware

(A) x 25



Ø6 x 35mm
Cam Bolt

(B1) x 20



Ø15 x 11mm
Tall Cam Bolt

(B2) x 5



Ø15 x 9mm
Short Cam Bolt

(C) x 42



Ø8 x 30mm
Wood Dowel

(D) x 12



Ø3.5 x 12mm
Screw

(E) x 10



Ø6 x 50mm
Bolt

(F) x 22

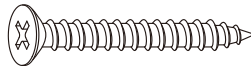

Ø4 x 38mm
Screw

(G) x 24



Ø3.5 x 14mm
Screw

(H) x 4

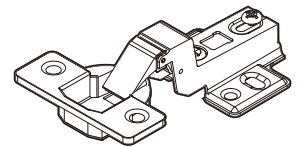

Hinge

(I) x 4



M4 x 25mm
Bolt

(J) x 2

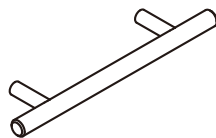

Drawer Pull

(K) x 16



Plastic Wedge

(L) x 16

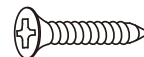

Ø3 x 17mm
Screw

(M) x 1



5/32" (4mm)
Allen Key

(N) x 1

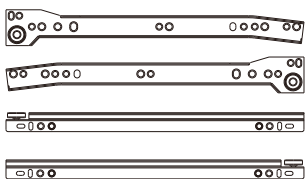

**TV
Console
Slides**

N1(L) x 1

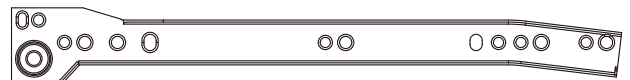

N1(R) x 1

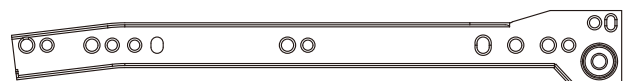

**Drawer
Slides**

N2(L) x 1

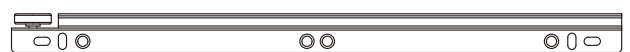

N2(R) x 1



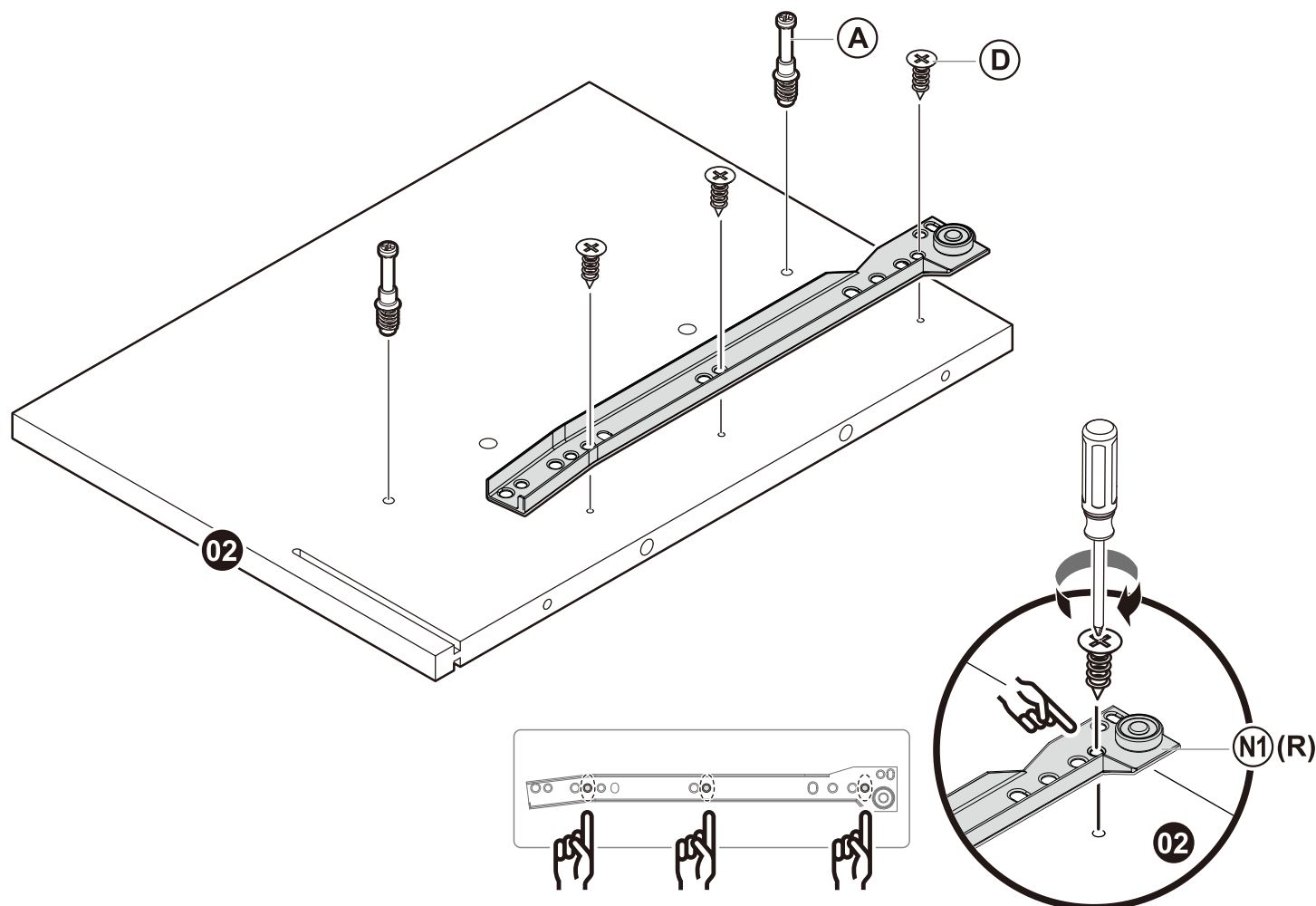
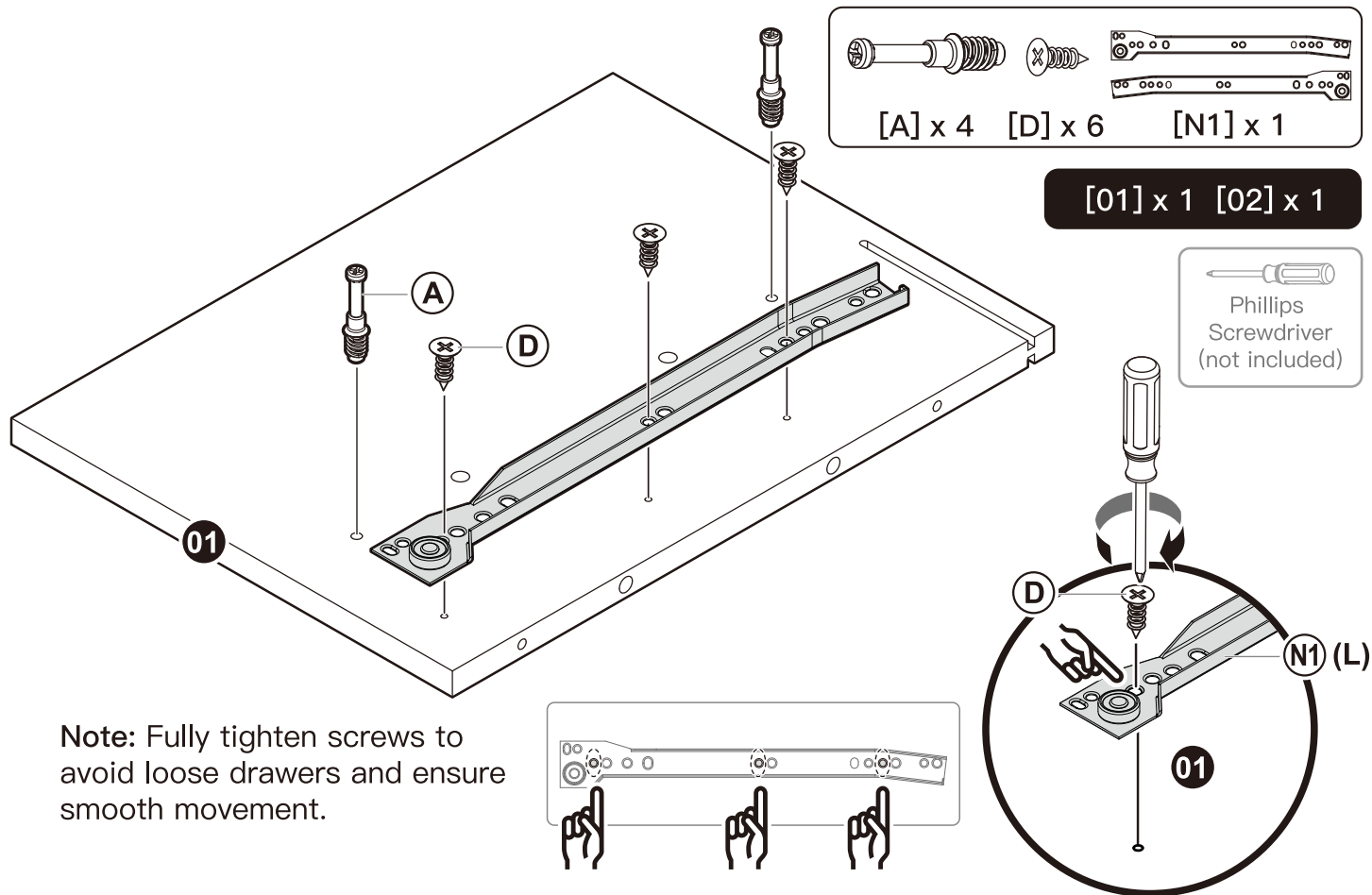

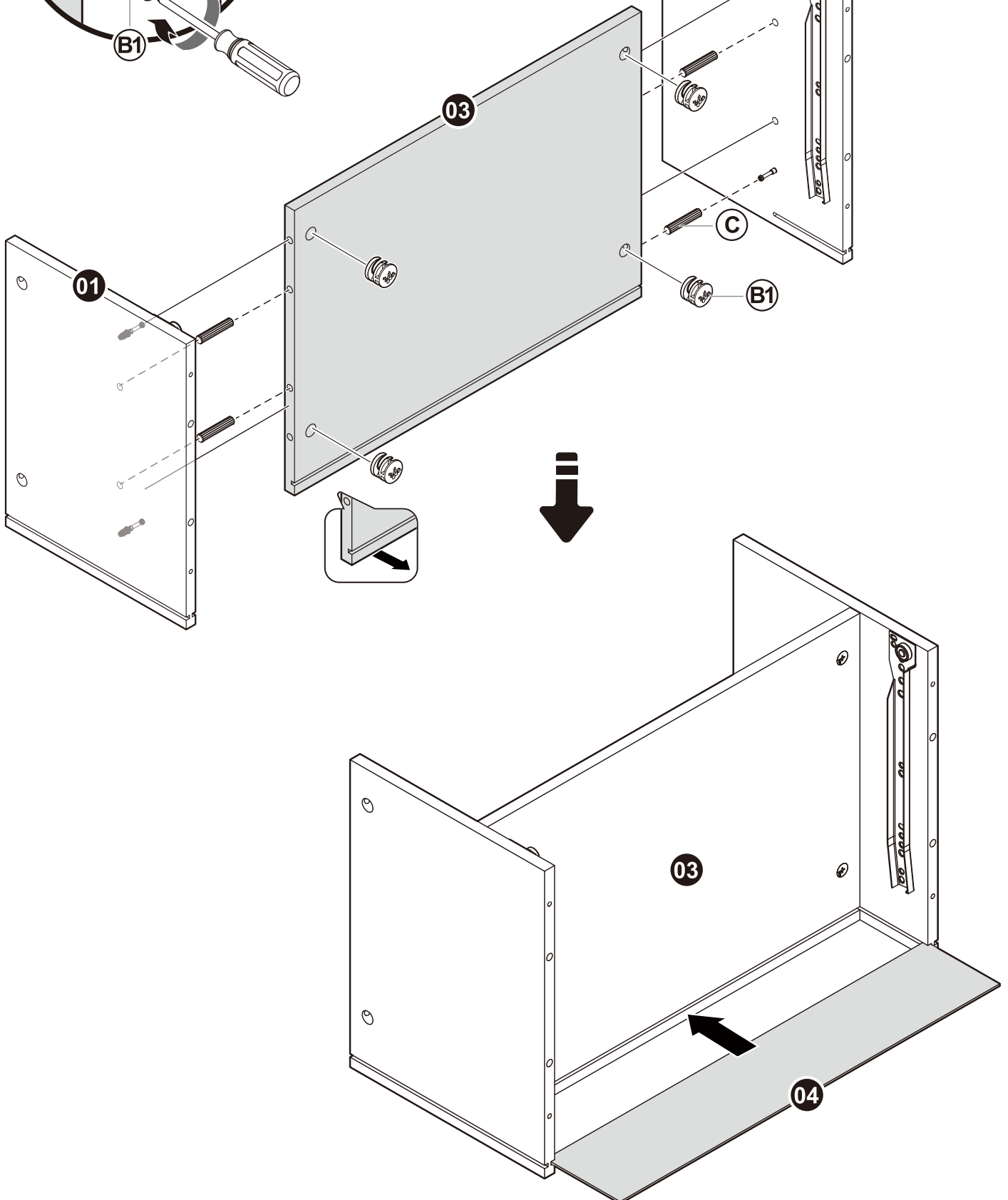
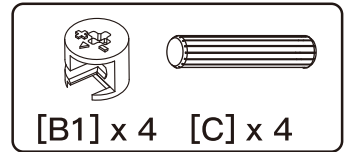
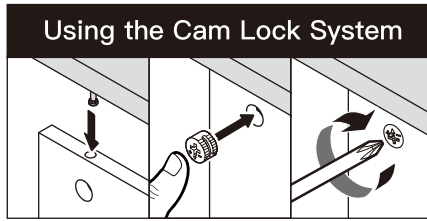
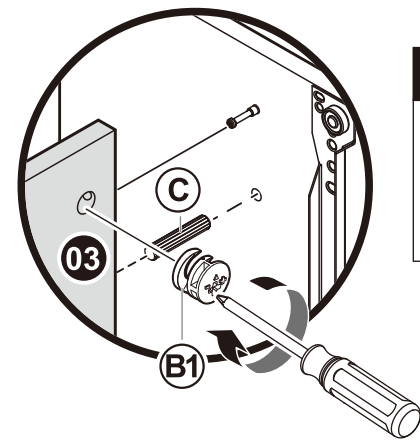

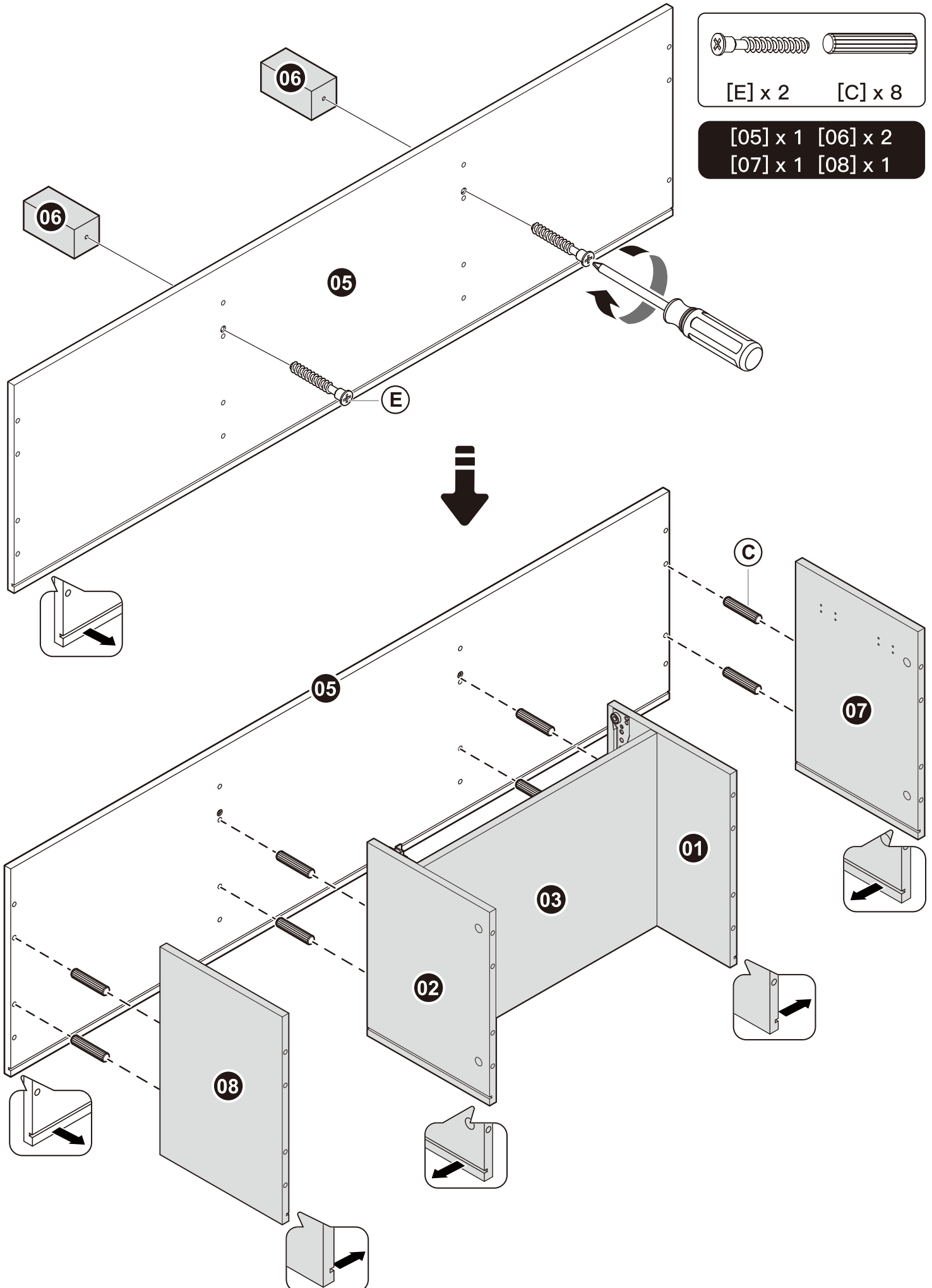

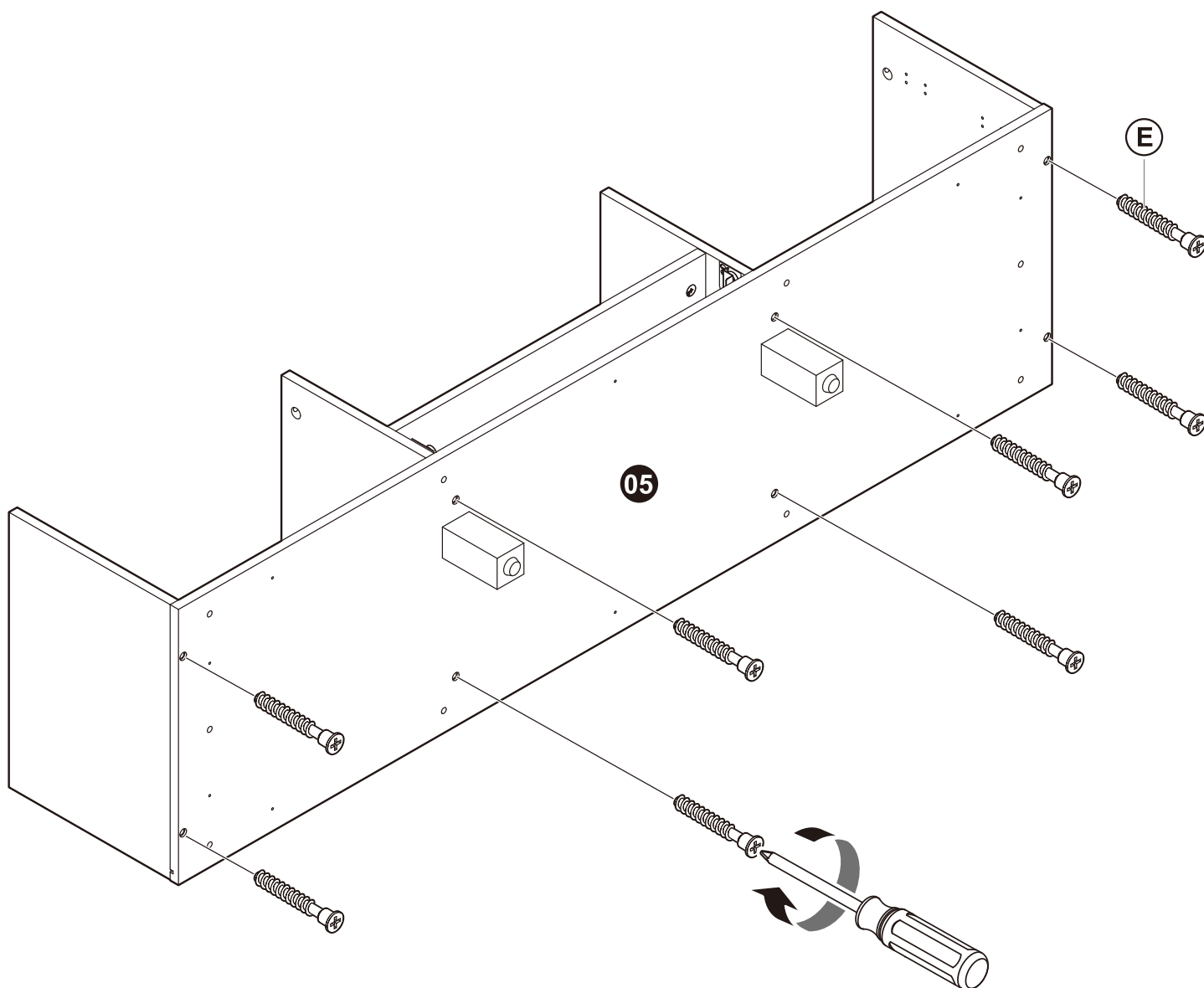
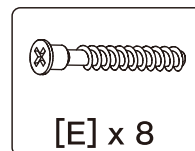

Step 2

Parts and Hardware

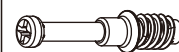
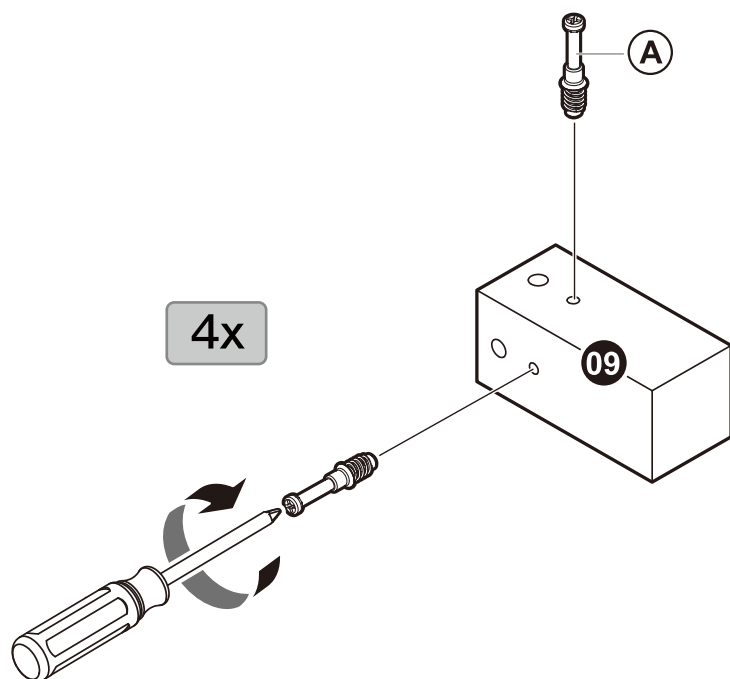

[A] x 8

[09] x 4



Phillips
Screwdriver
(not included)

Parts and Hardware

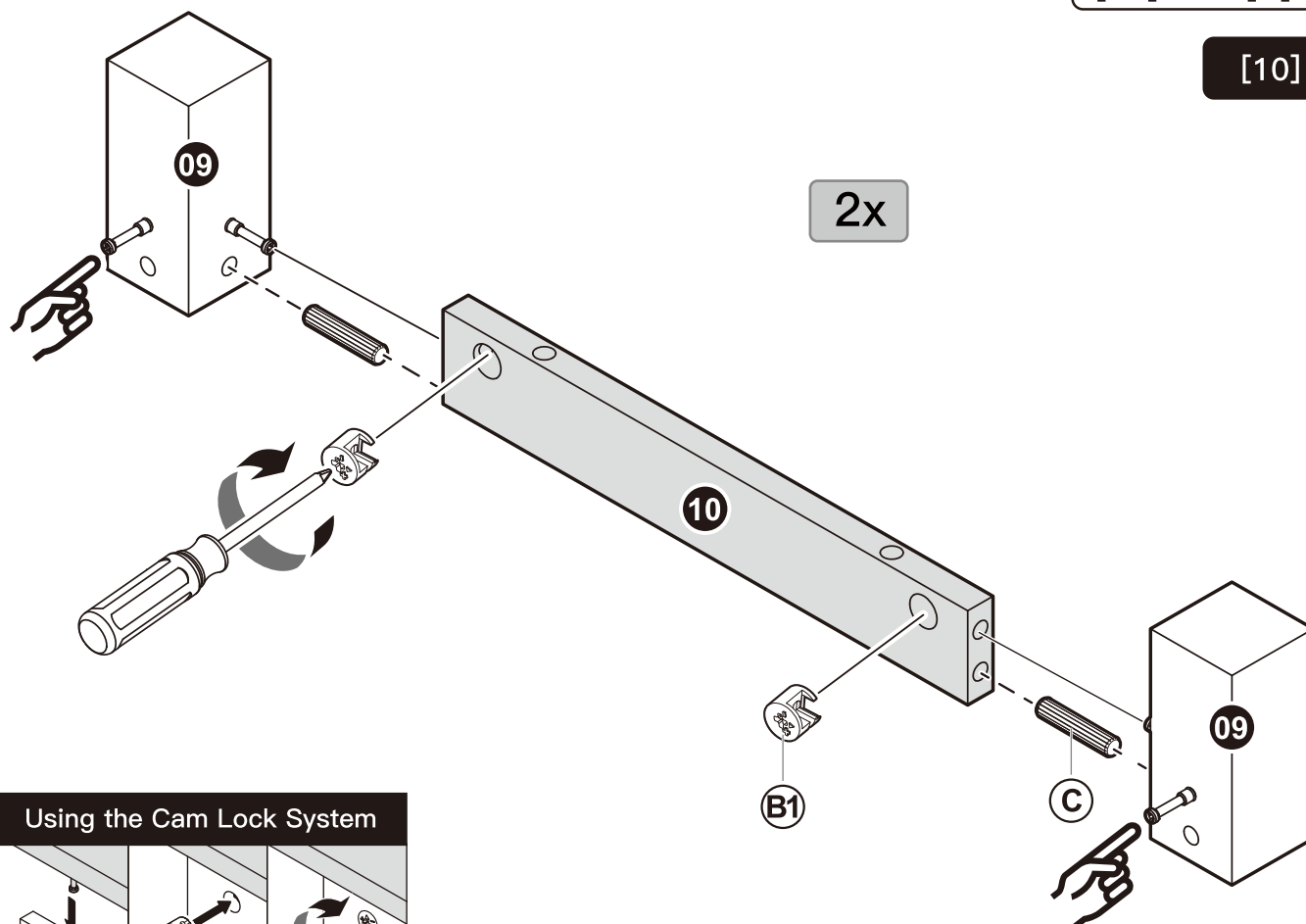

[B1] x 4



[C] x 4

[10] x 2

Using the Cam Lock System

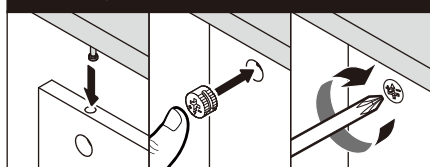



[B1] x 4 [C] x 4

[11] x 2

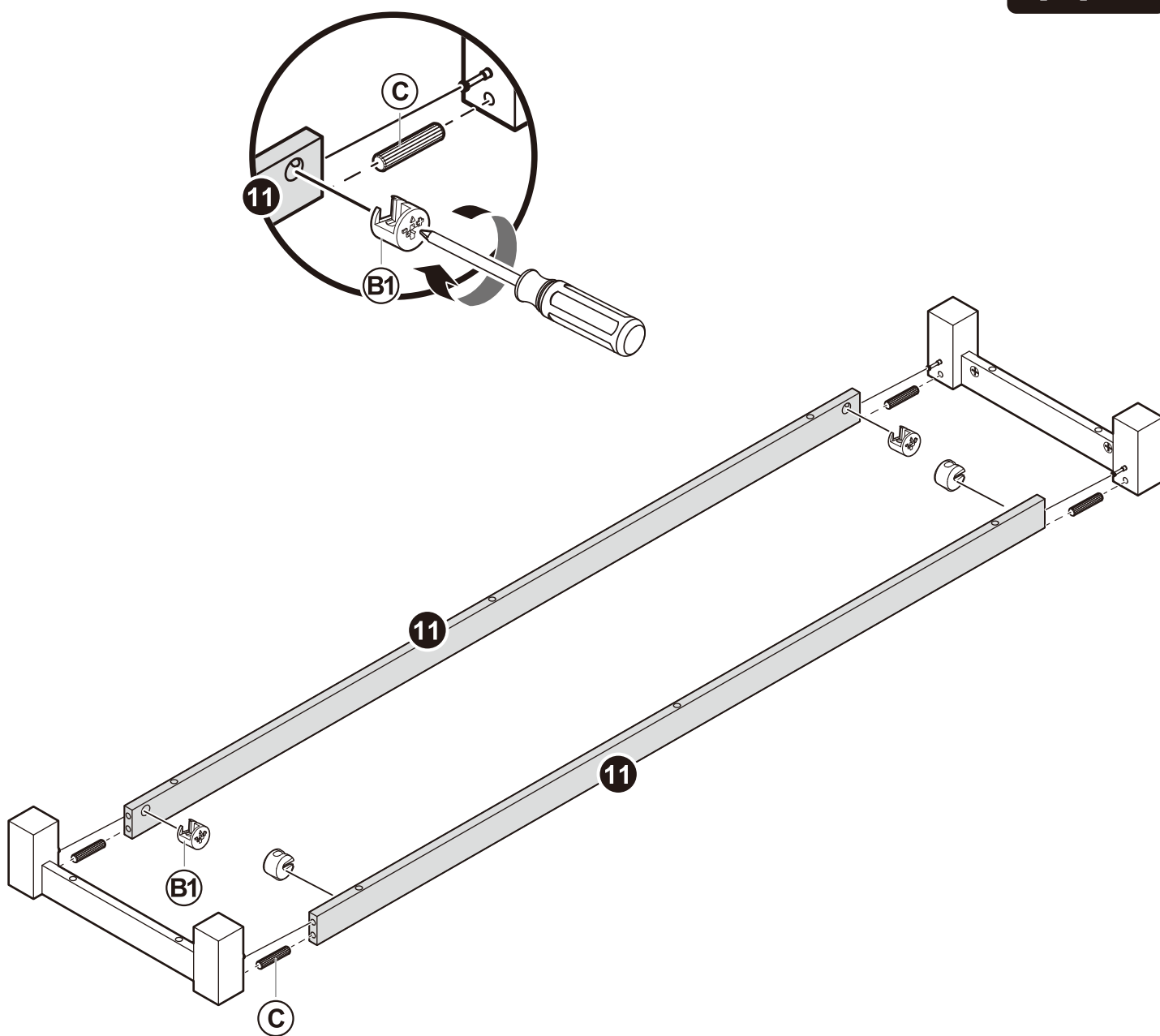

Using the Cam Lock System

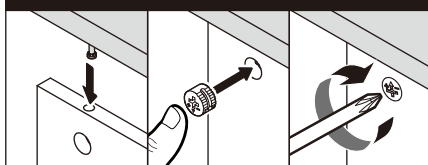

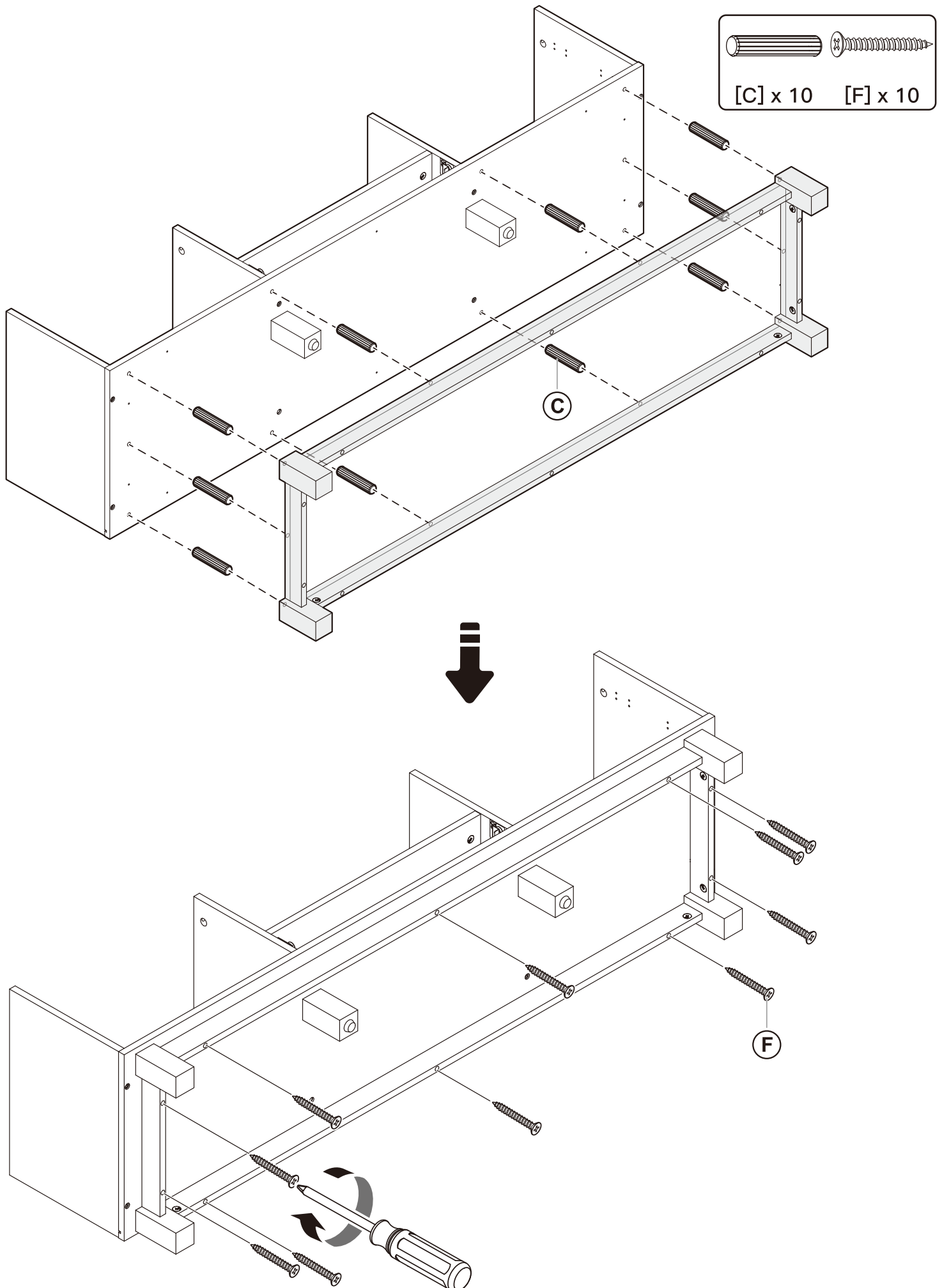

Step 3

Parts and Hardware



You may need assistance with this step.

[12] x 2

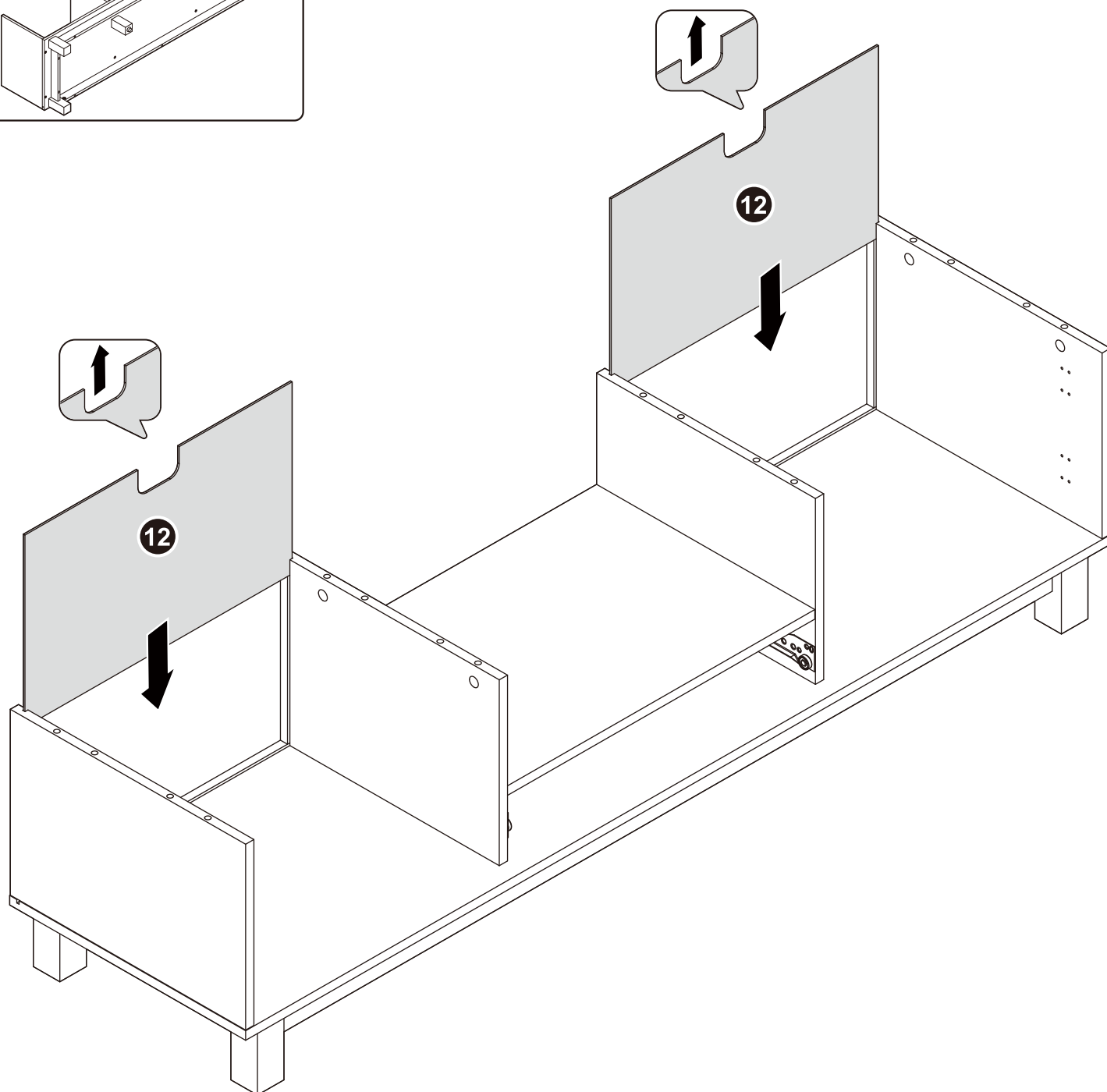
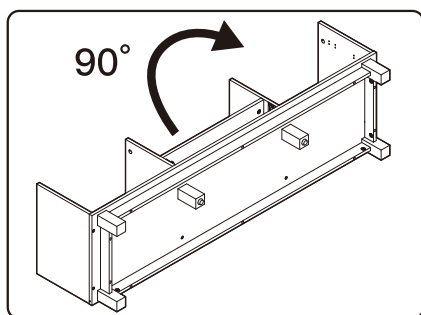

Step 4

Parts and Hardware

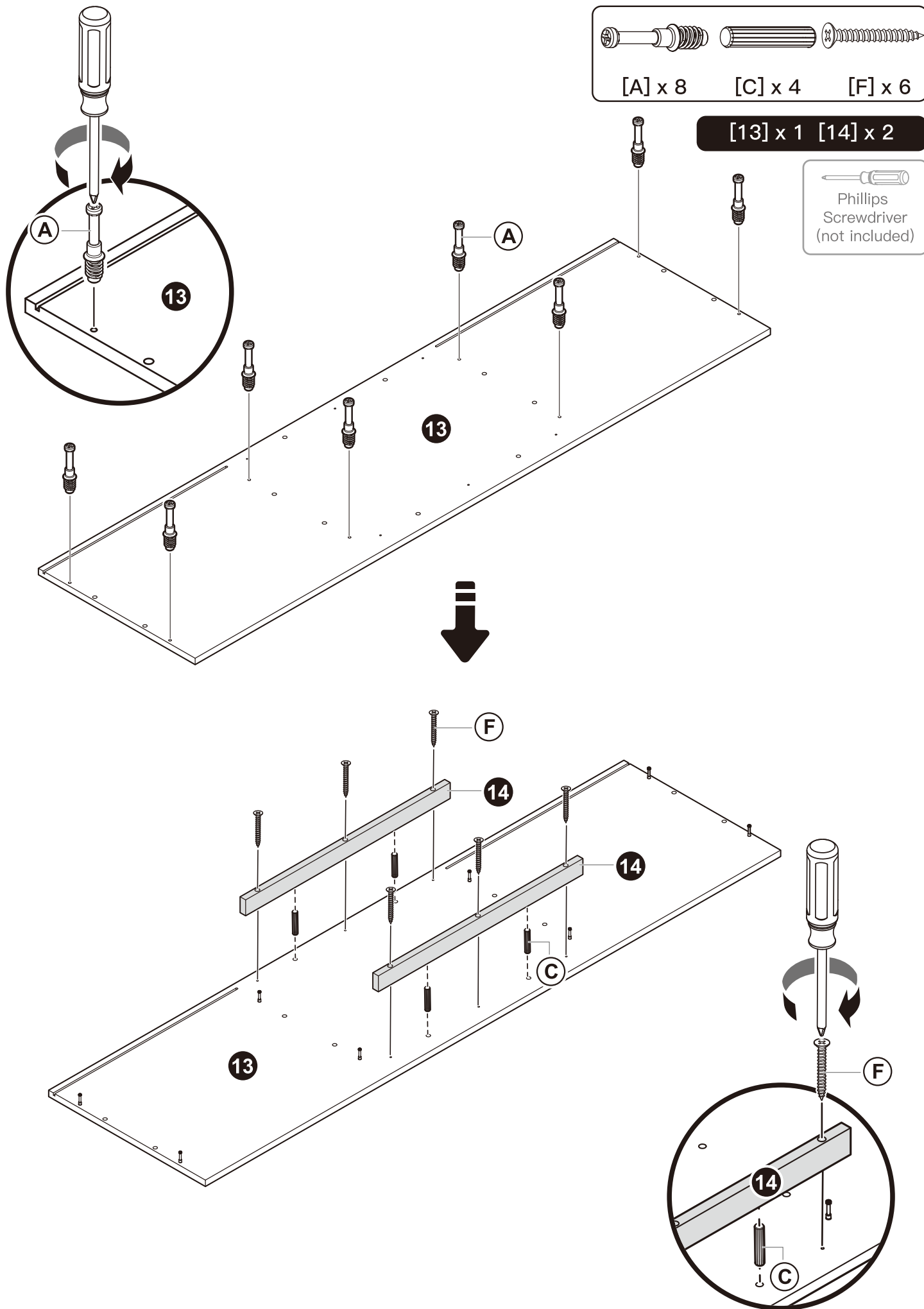

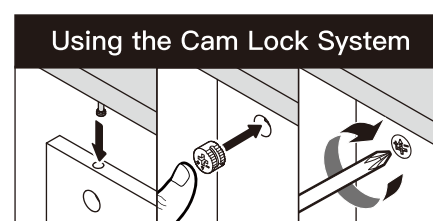
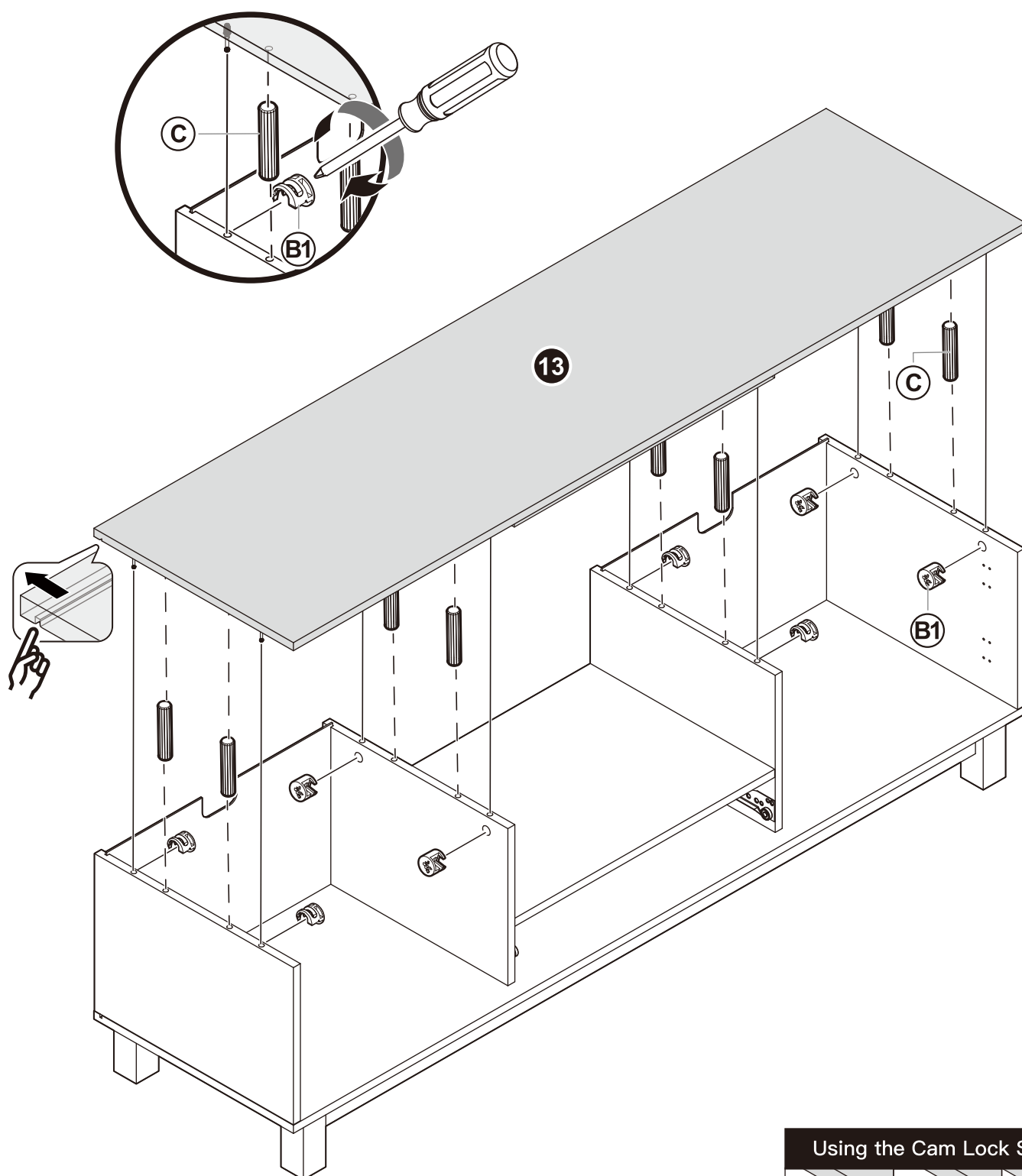
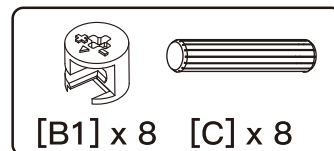

Step 5

Parts and Hardware



Phillips
Screwdriver
(not included)



[H] x 4



[G] x 8

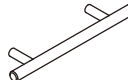

[J] x 2



[I] x 4

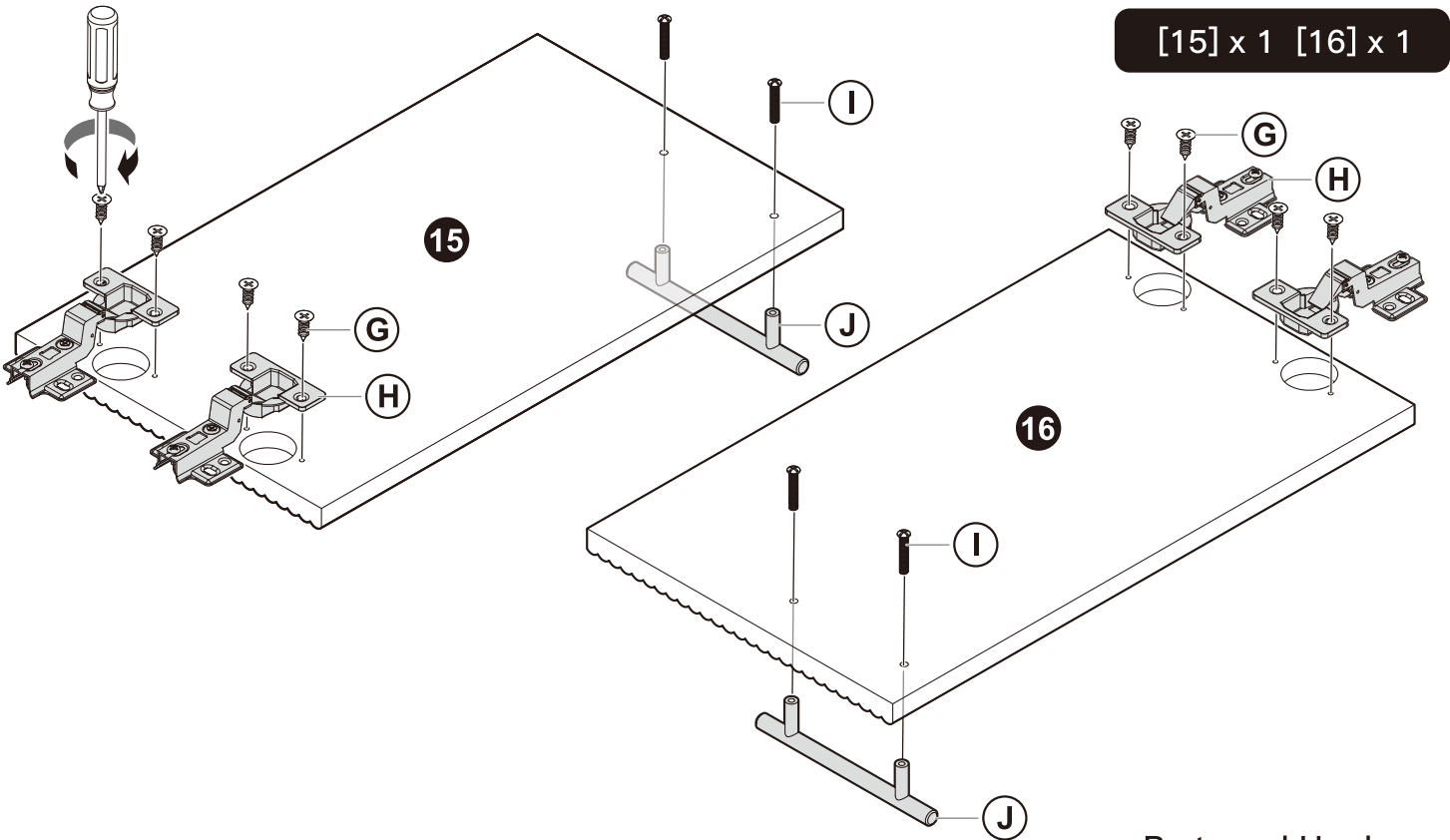

Parts and Hardware



[G] x 16

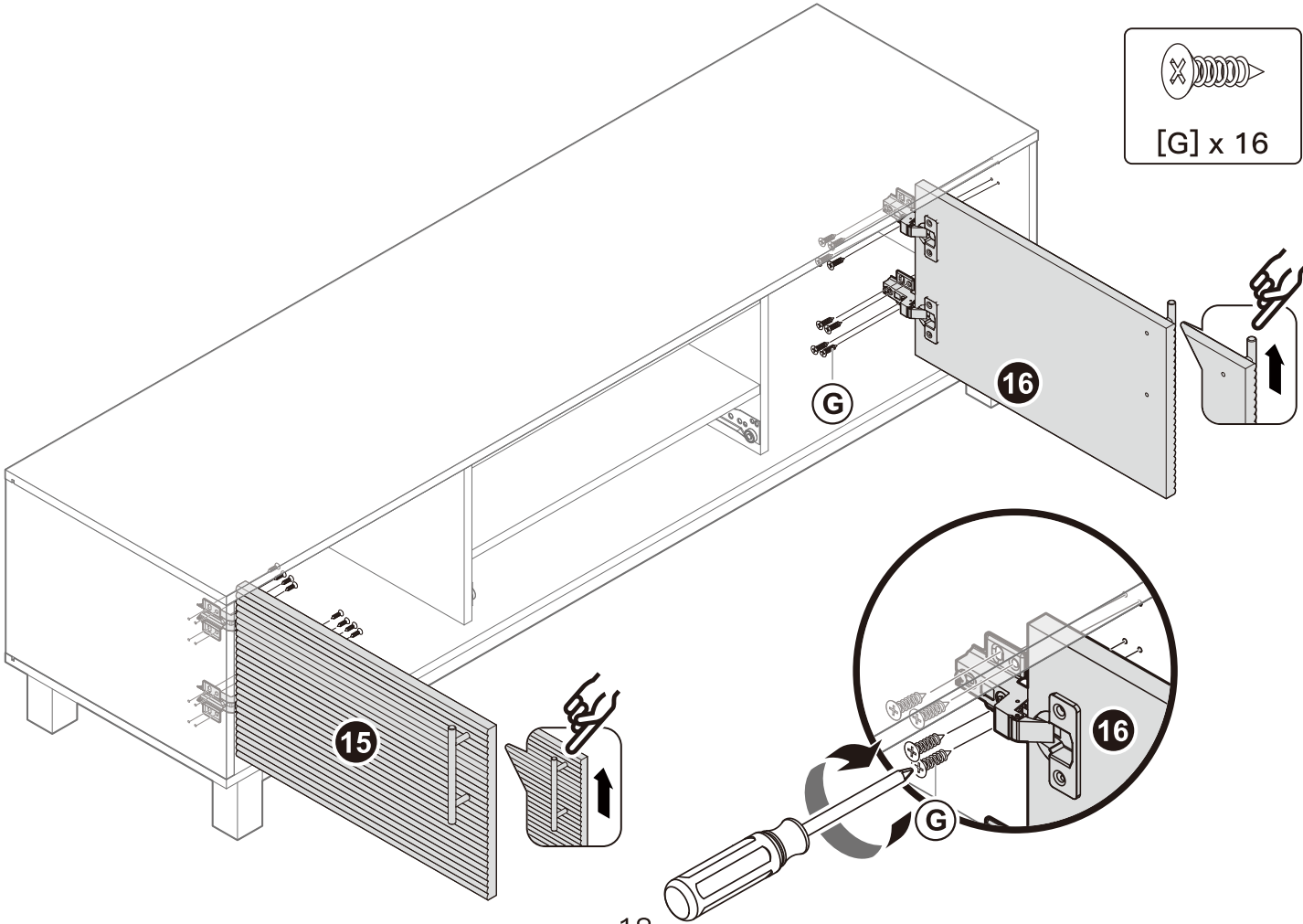

Adjustment

The doors may go out of alignment during shipping. Open and close the doors to make sure they are aligned correctly. If you find that the doors need to be adjusted, turn the appropriate screw, as illustrated.

The hinges are adjustable in three directions for perfect alignment.

To adjust door up or down

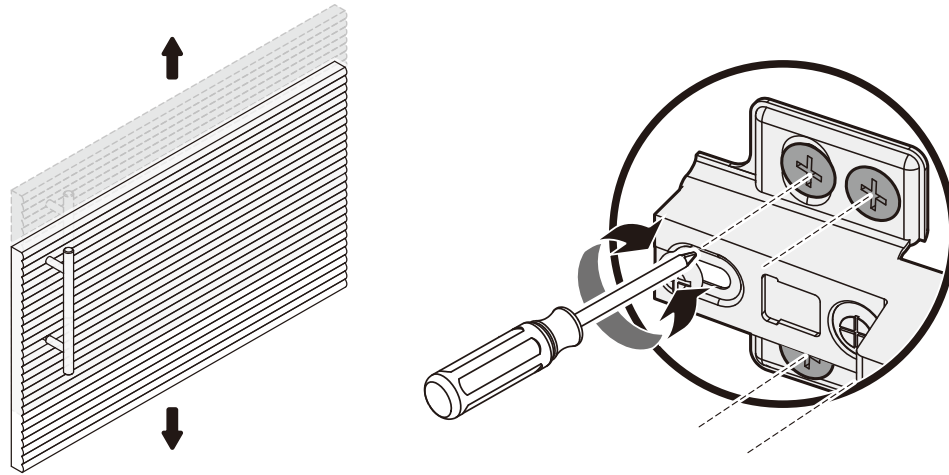

To adjust door forward or backward

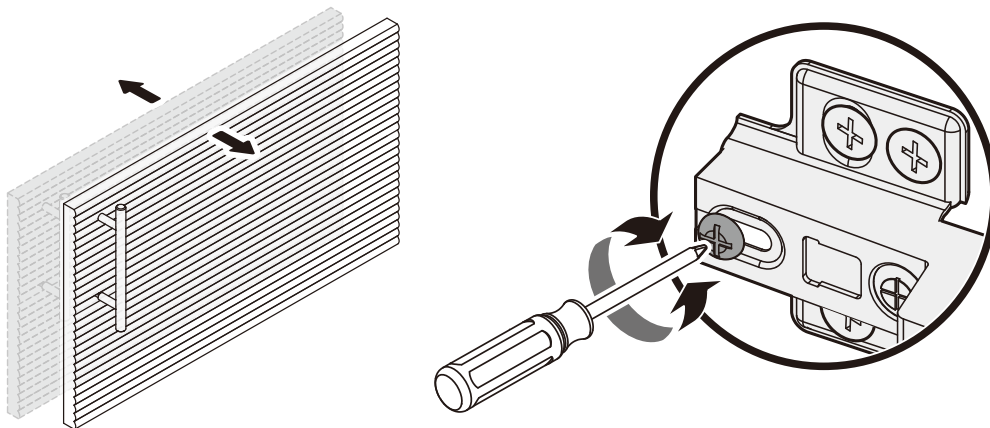

To adjust door right or left

Turn the set screw clockwise to narrow the gap between the door and the side panel.
Turn the set screw counterclockwise to enlarge the gap between the door and the side panel.

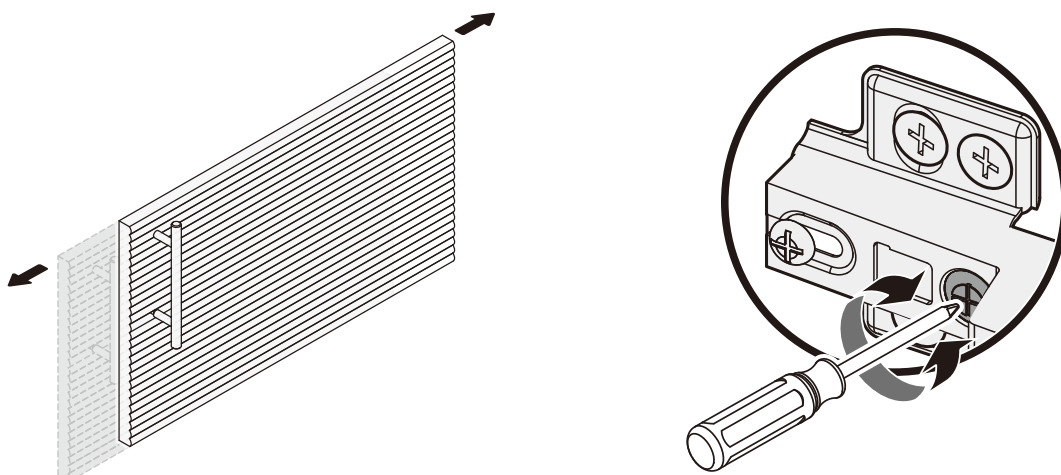

Step 6

Parts and Hardware

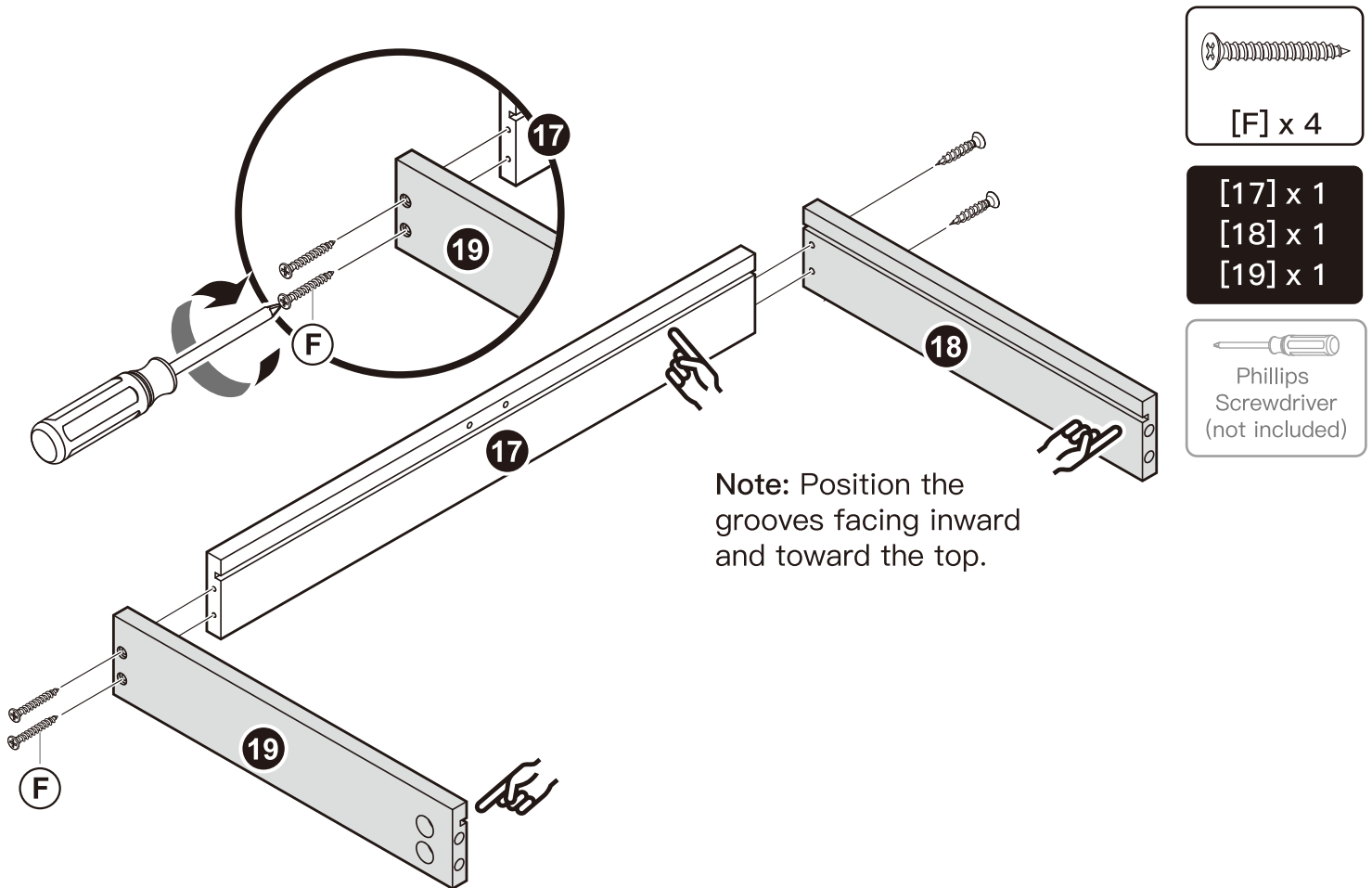

Parts and Hardware

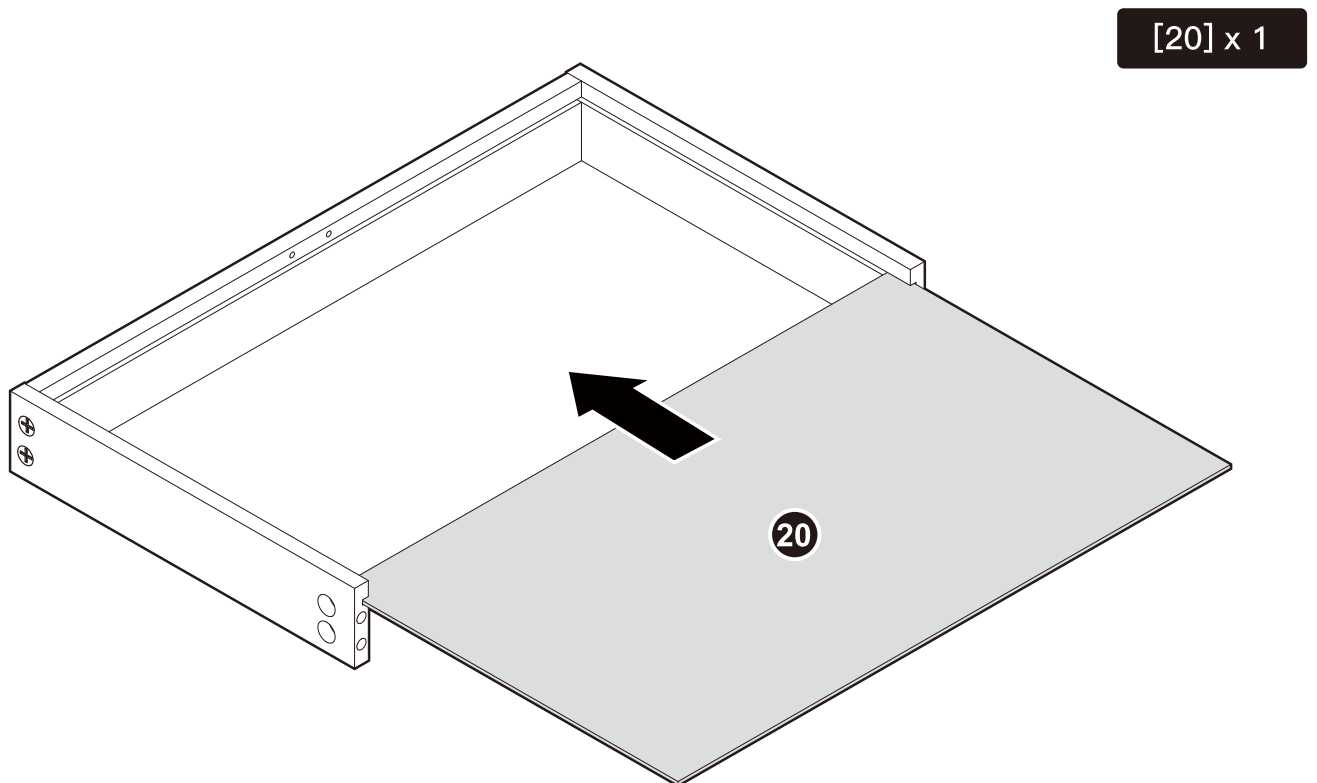

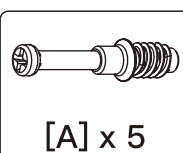
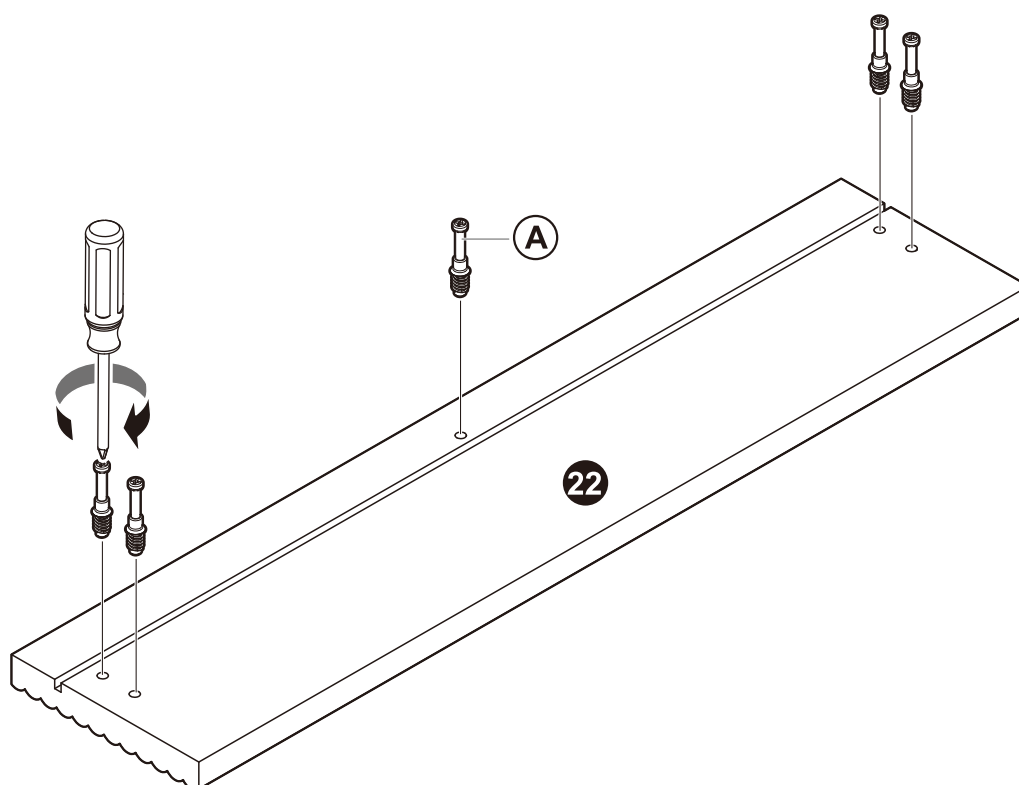
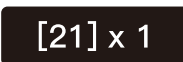
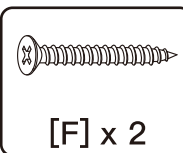
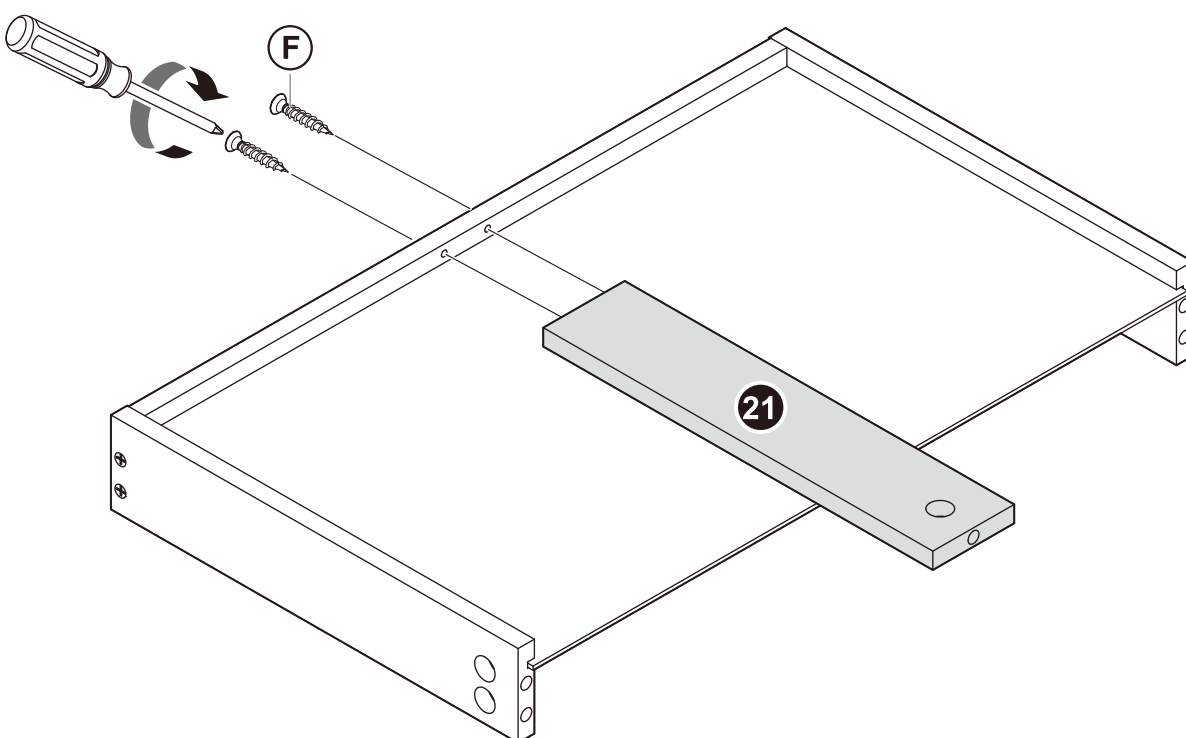

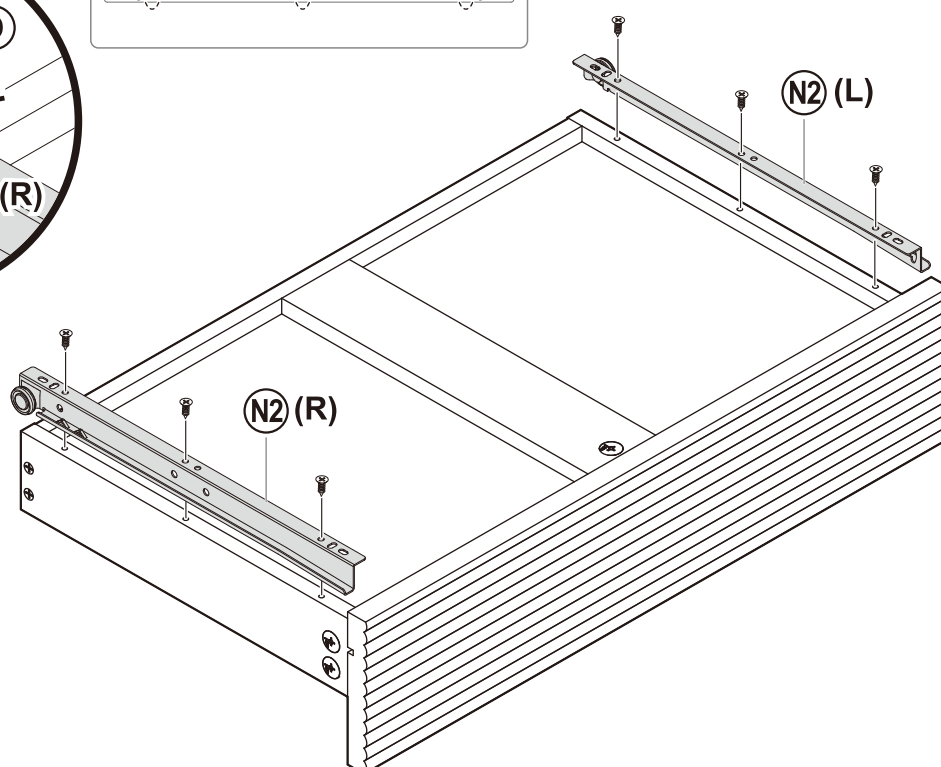
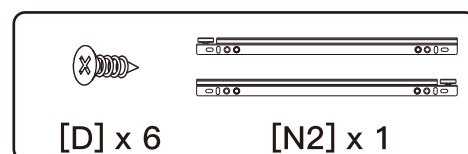
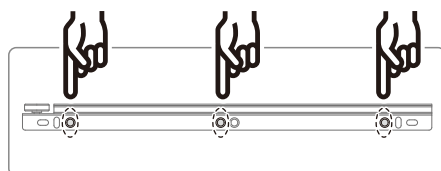
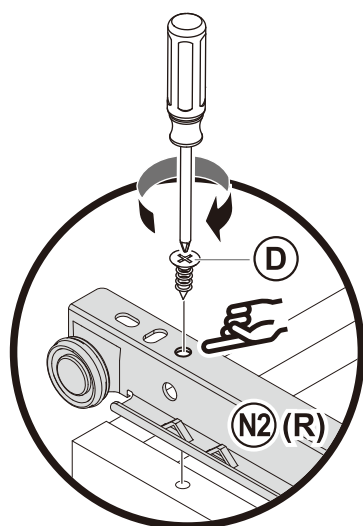
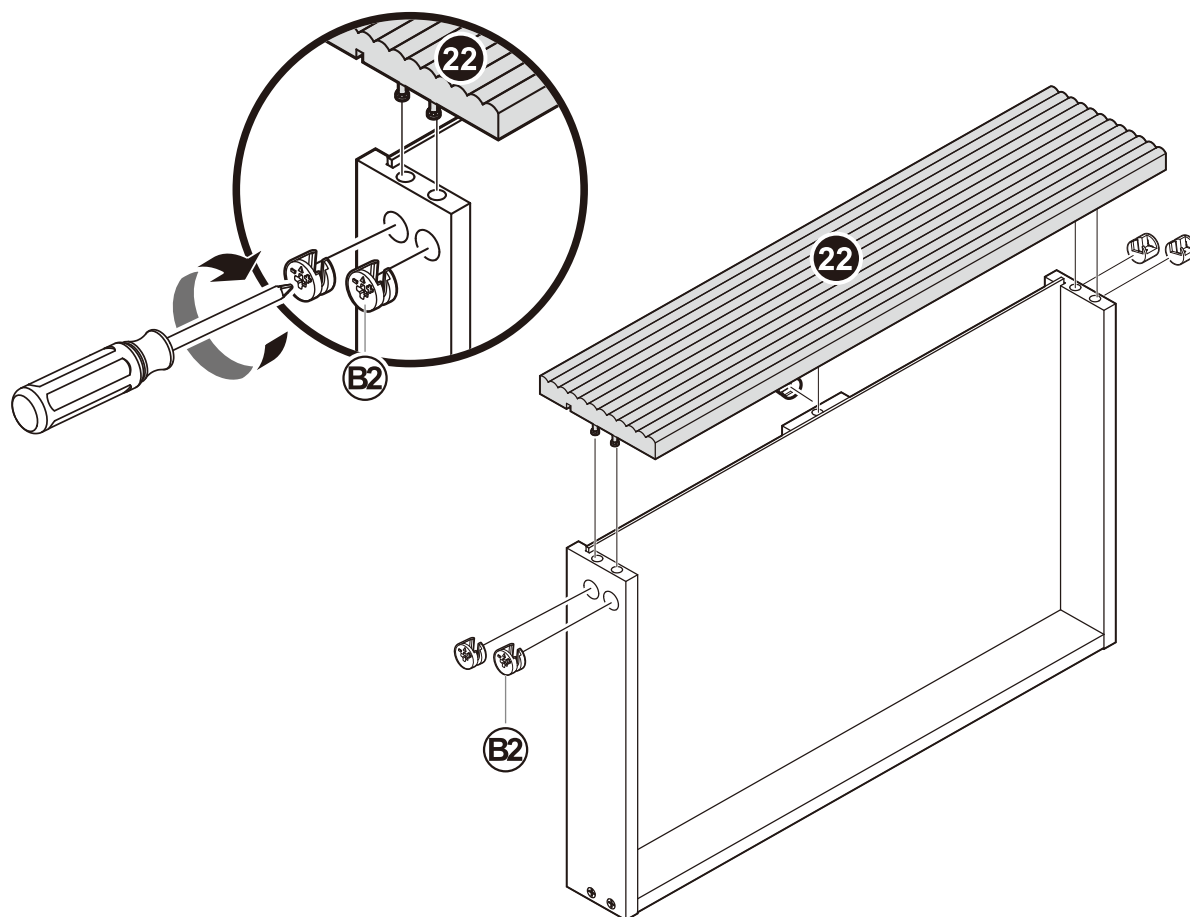

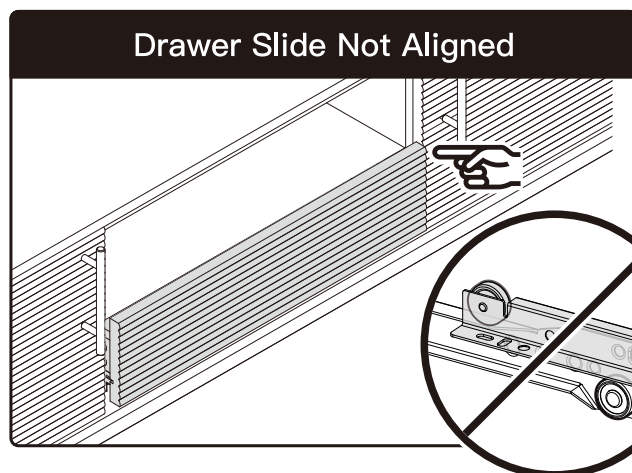
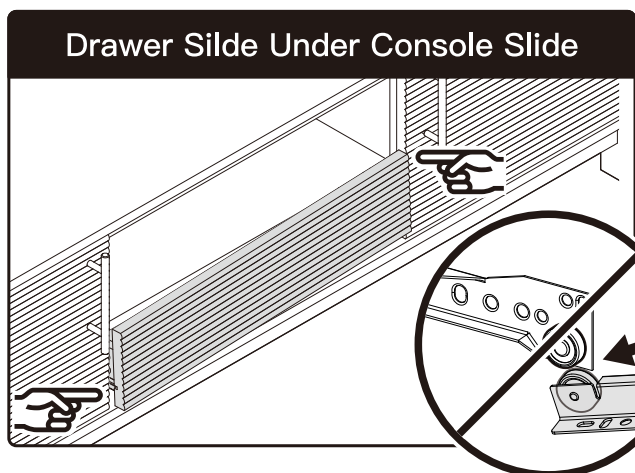
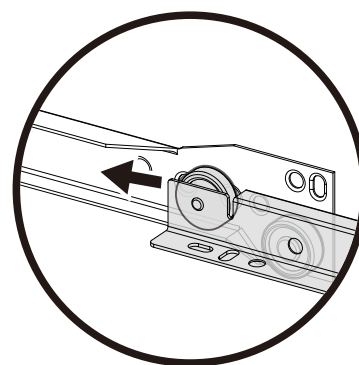
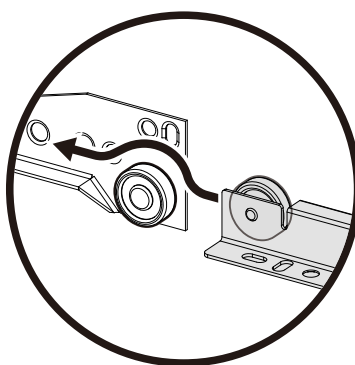
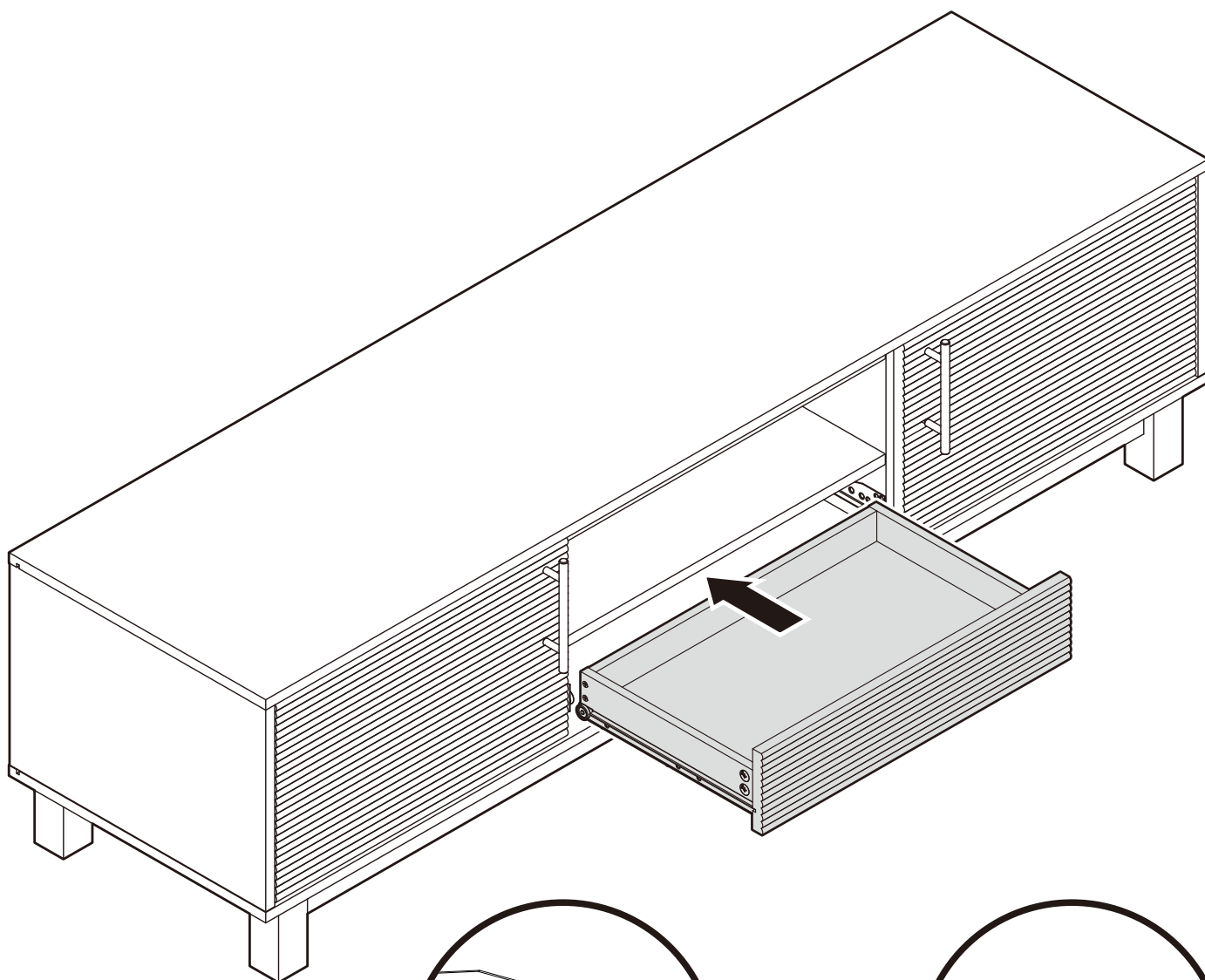



[K] x 16



[L] x 16



Phillips
Screwdriver
(not included)

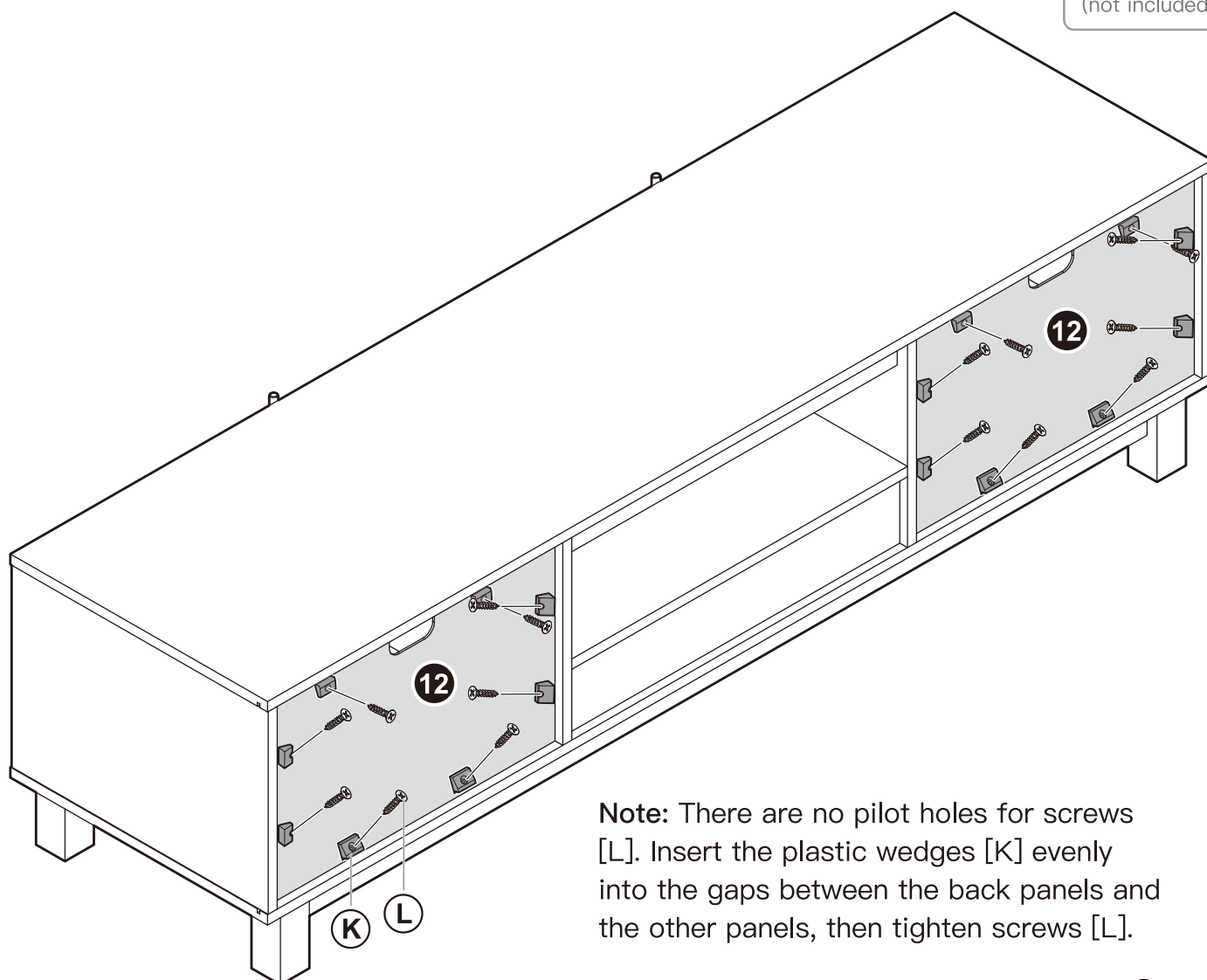

Note: There are no pilot holes for screws [L]. Insert the plastic wedges [K] evenly into the gaps between the back panels and the other panels, then tighten screws [L].

