

Mechanical Arm Single Ultrawide Monitor Desk Mount

STAND-V101E Series
Assembly Manual

Individual Product SKUs

STAND-V101E STAND-V101EW



WARNING



If you do not understand these directions, or if you have any doubts about the safety of the installation, please contact our product support team at 309-278-5303 or help@vivo-us.com for further assistance. Check carefully to make sure there are no missing or defective parts. Failure to report missing parts within 30 days may result in denial of free replacement. Improper installation may cause damage or serious injury. Do not use this product for any purpose that is not explicitly specified in this manual. Do not exceed weight capacity. We cannot be liable for damage or injury caused by improper mounting, incorrect assembly or inappropriate use.



WARNING: CHOKING HAZARD

SMALL PARTS - NOT FOR CHILDREN UNDER 3 YEARS. ADULT SUPERVISION IS REQUIRED.



DO NOT EXCEED WEIGHT CAPACITY

FAILURE TO DO SO MAY RESULT IN SERIOUS INJURY.

Need Help? We're Here For You

US-Based Customer Support from Trained Professionals

Monday-Friday from 7am-7pm CST

Saturday 8am-4pm CST



Email Us

help@vivo-us.com



Chat with Live Agent

www.vivo-us.com



Give Us a Call

309-278-5303 ext. 1



Assembly Video & Product Info

www.vivo-us.com/products/stand-v101e

Package Contents

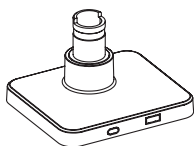

A (x1)
Base

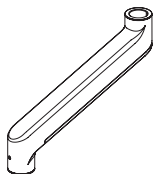

B (x1)
Lower Arm

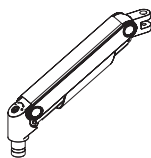

C (x1)
Spring Arm

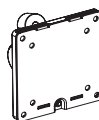

D (x1)
VESA Adapter

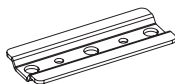

E (x1)
Clamp Plate

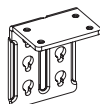

F (x1)
Clamp Brace

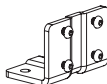

G (x1)
Clamp

Included Hardware & Tools



S-A (x1)
M8 Nut



S-B (x4)
M6x12mm
Screw



S-C (x1)
M8x35mm
Screw



S-D (x2)
M10x63mm
Screw



M-A (x4)
M4x12mm
Screw



M-B (x4)
M5x12mm
Screw



M-C (x4)
M5 Washer



T-A (x1)
4mm Allen
Wrench



T-B (x1)
6mm Allen
Wrench

Tools Needed:



**Phillips
Screwdriver**



Drill

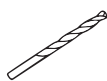

**3/8" (10mm)
Drill Bit**

Weight Capacity:

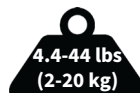

Assembly Steps

STEP 1

Option 1: Clamp Assembly

Attach Clamp Brace (F) to Base (A) using M6x12mm Screws (S-B) and tighten with 4mm Allen Wrench (T-A).

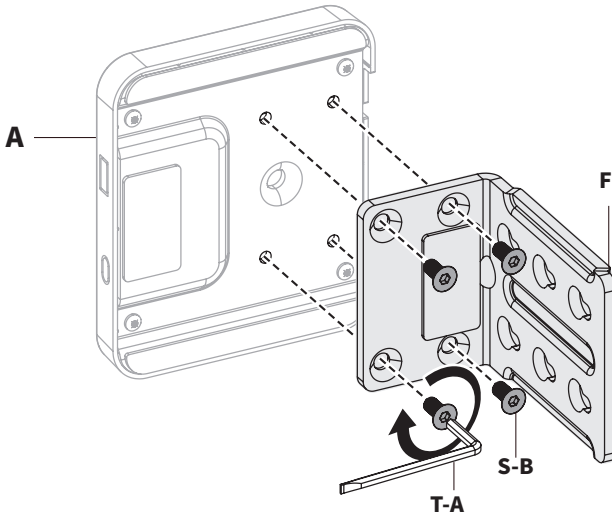

Thread M10x63mm Screws (S-D) into Clamp (G) and place Clamp Plate (E) on top.

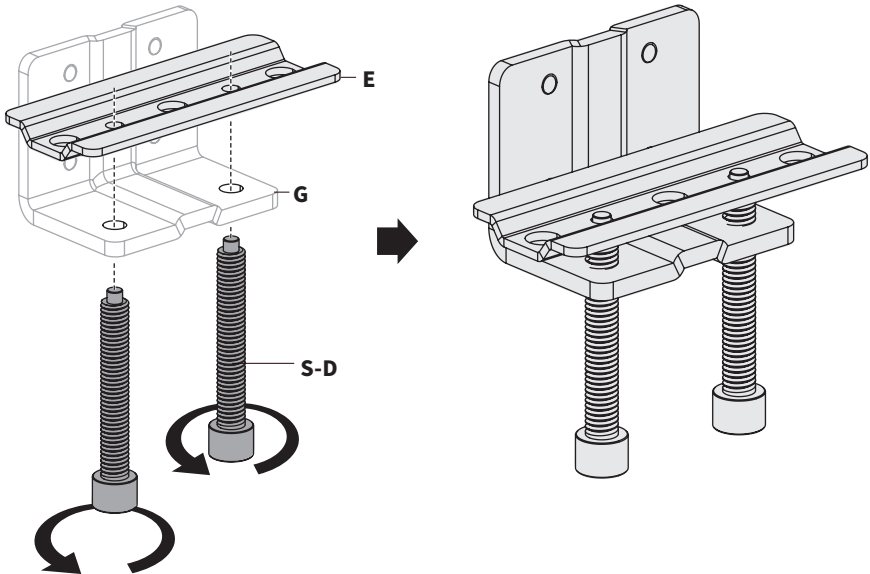

Clamp Assembly - Cont'd

Loosen bolts on back of Clamp Brace (G) using 4mm Allen Wrench (T-A), leaving 6mm of thread exposed.

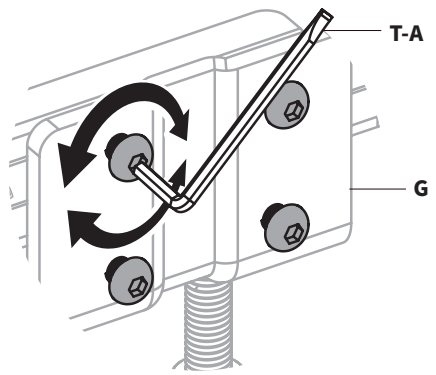

Hang assembled clamp into the slots on Clamp Brace (F), using instructions for your desk thickness below. Tighten using 4mm Allen Wrench (T-A).

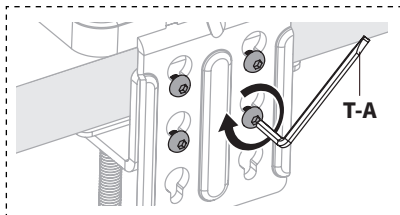
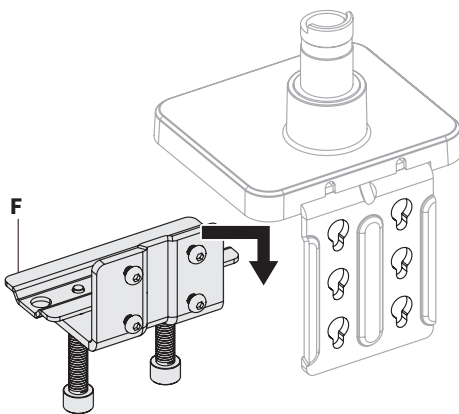

Desktop Thicknesses:

3/8" to 2" (10 - 50mm)
Use Upper Four Holes

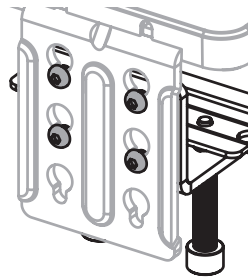

OR

1.5" to 3" (40 - 80mm)
Use Lower Four Holes

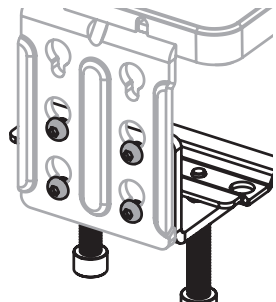

Clamp Assembly - Cont'd

Secure clamp assembly to the desktop using 6mm Allen Wrench (**T-B**).

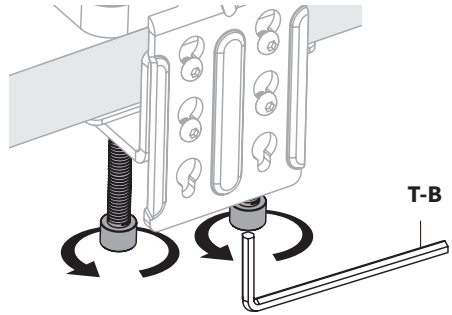

Proceed to **STEP 2**
on **Next Page**

Option 2: Grommet

Insert M10x63mm Screws (**S-D**) with Clamp Plate (**E**) up through the underside of the desk and tighten to Base (**A**) using the 6mm Allen Wrench (**T-B**).

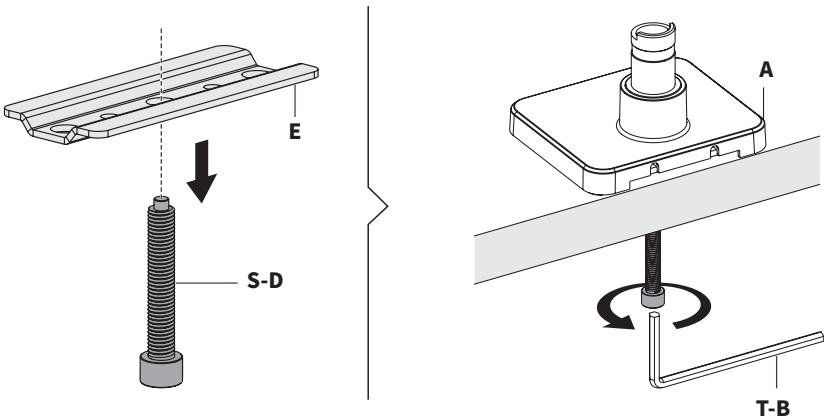

No Grommet Hole?

If you do not have an existing hole for installation, drill a hole through your desktop in your desired mounting location using a 3/8" (10mm) drill bit.

Proceed to **STEP 2**
on **Next Page**

STEP 2

Place Lower Arm (**B**) on top of Base (**A**), and secure by tightening **Set Screw** with 4mm Allen Wrench (**T-A**).

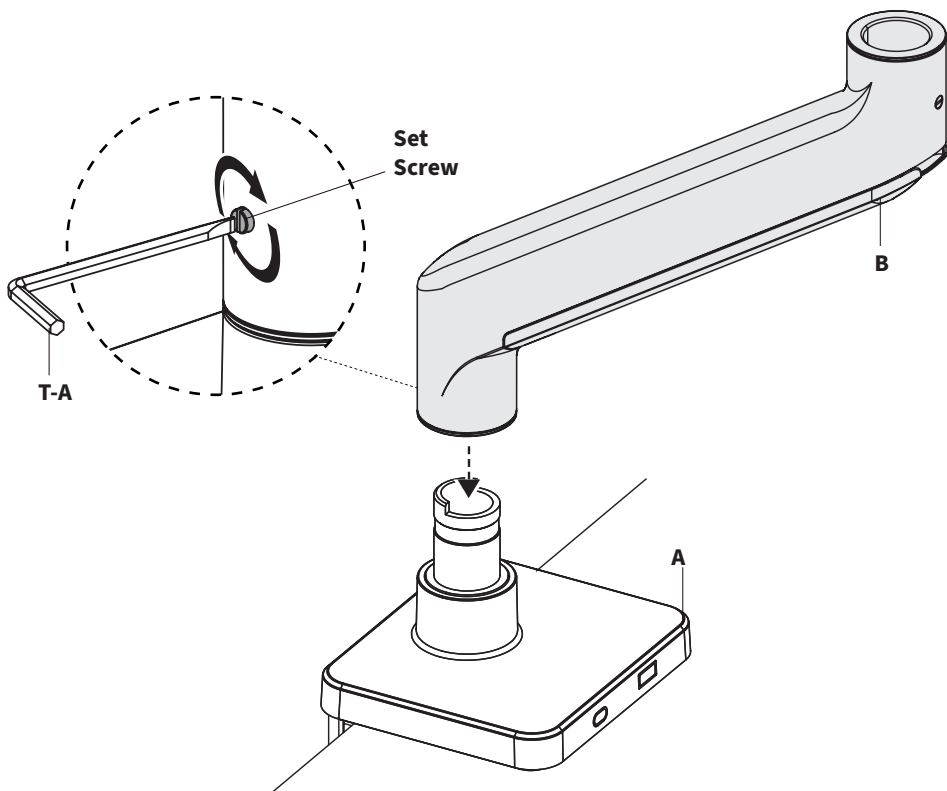

**** Optional **** **Limited 90° Rotation**

To limit Lower Arm (**B**) rotation to 90°, remove the Arm and turn upside down to reveal a **Set Screw** inside the opening.

Loosen the Screw 5-6 turns, which is approximately 5mm (3/16") using 4mm Allen Wrench (**T-A**). This will lock the rotation of the arm to 90°.

To revert back to full rotation, fully tighten **Set Screw**.

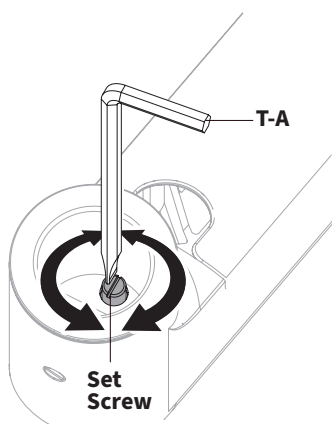

STEP 3

Place Spring Arm (C) on top of Lower Arm (B), and secure by tightening Set Screw with 4mm Allen Wrench (T-A).

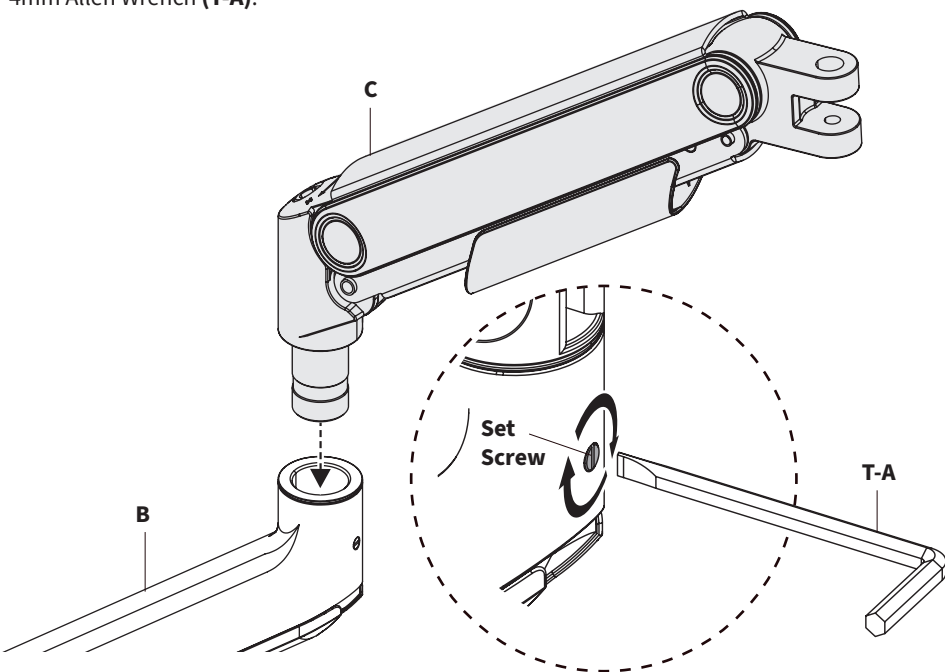

STEP 4

Attach VESA Adapter (D) using M8x35mm Screw (S-C) and M8 Nut (S-A) on Spring Arm (C) using 6mm Allen Wrench (T-B). Unscrew Thumbscrew (D1) on VESA Adapter (D) and remove VESA Plate (D2).

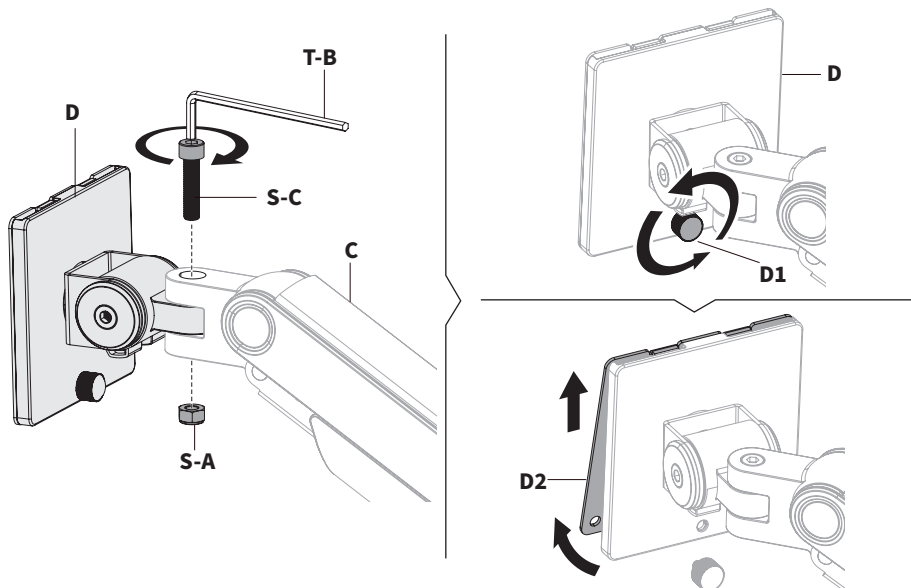

STEP 5

Install VESA Plate (**D2**) to monitor using M4x12mm Screws (**M-A**) or M5x12mm Screws (**M-B**) with M5 Washers (**M-C**).

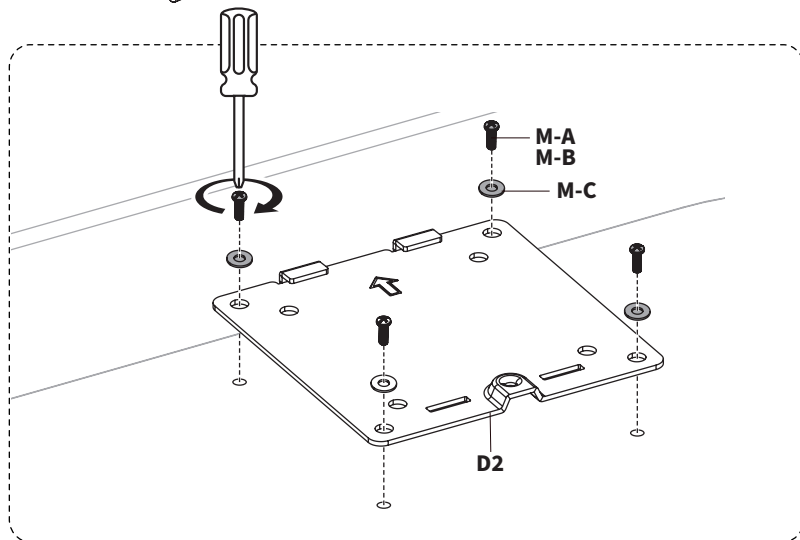
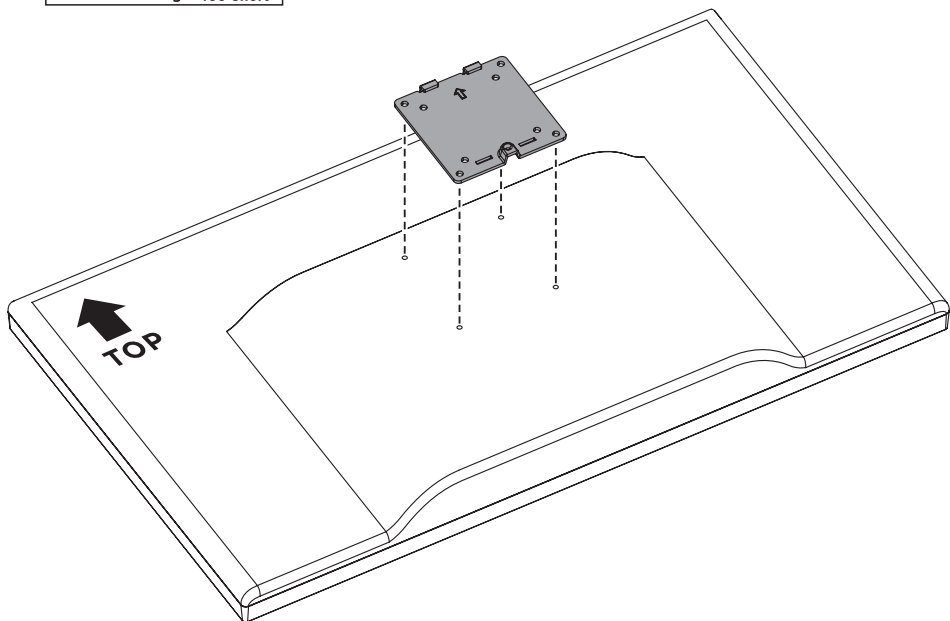
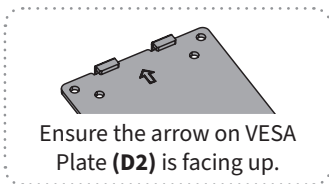
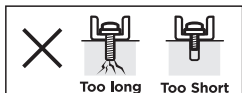
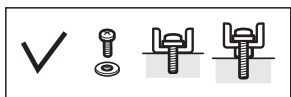

Adjusting the Tilt Joint

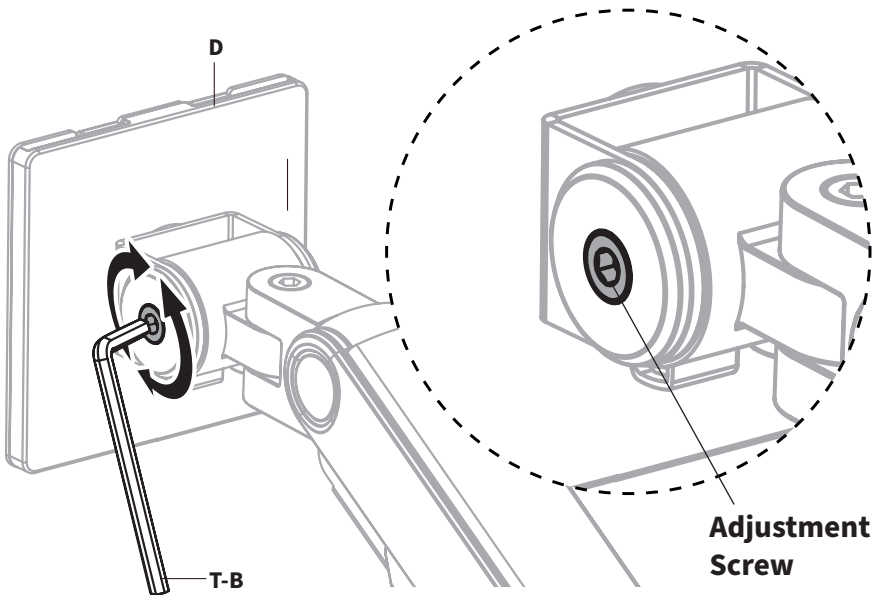

1 Loosen Tilt Joint:

Use 6mm Allen Wrench (**T-B**) to loosen the tilt joint **Adjustment Screw**, located on the side of VESA Adapter (**D**).

2 Set Angle

Firmly grip the VESA Adapter and adjust to your desired viewing angle, and hold in place.

3 Lock Angle

Tighten as much as possible using the 6mm Allen Wrench (**T-B**) to lock the angle.

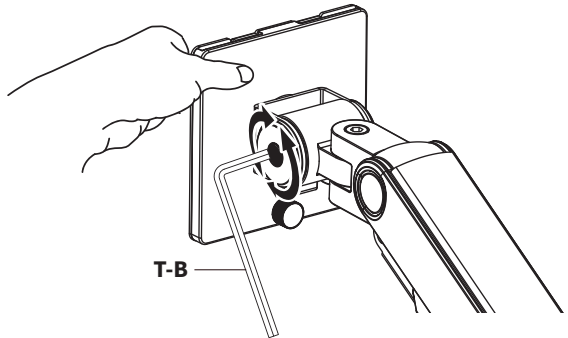

***Firmly hold VESA Bracket in place while adjusting tilt angle.**

With the assistance of a second person, line up the VESA Plate (**D2**) on your monitor with the VESA Adapter (**D**) and the Plate Hooks into the pockets of the VESA Adapter.



2 Person Mounting is Recommended

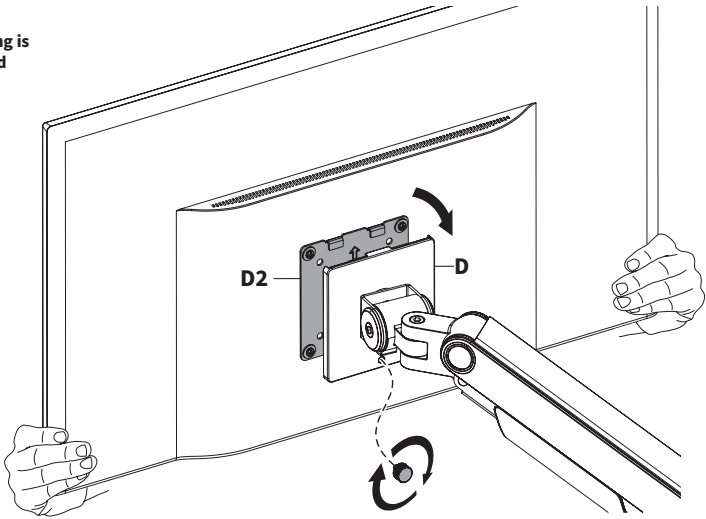

**Monitor & VESA Bracket may need to be angled backwards slightly when sliding on.*

Gently release the monitor and secure using the previously removed Thumbscrew (**D1**).



Monitor Tilted Too Far?

**** See Next Step ****

Refer to instructions in next step to adjust. **DO NOT** try to adjust angle freely. Doing so may result in accidental damage to your screen.

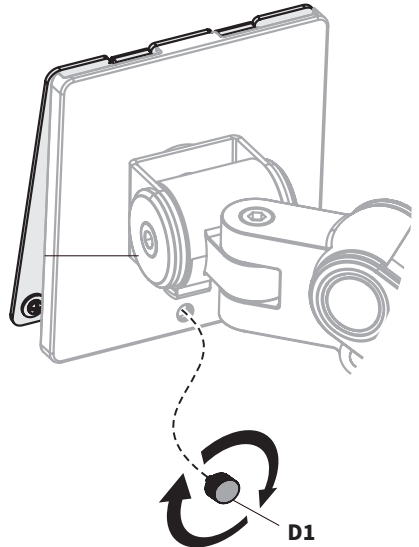

Fine Tune Tilt Angle

If the monitor is angled further than intended...



Heavy Weighted/ Ultrawide Monitors

[22lbs - 44lbs]

- 1 Firmly Hold Monitor**
Firmly grasp and hold the monitor in place. Do NOT release monitor until you have completed steps below.
- 2 Loosen Tilt Joint:**
With a hand still on the monitor, use 6mm Allen Wrench (**T-B**) to loosen the tilt joint **Adjustment Screw**, located on the side of VESA Adapter (**D**).
- 3 Set & Lock Angle**
Adjust screen slightly past your desired viewing angle, then tighten the screw as much as possible using 6mm Allen Wrench (**T-B**).
- 4 Straighten Angle**
Slowly adjust the monitor down until your desired angle is reached. Release monitor and check angle. Repeat process as necessary

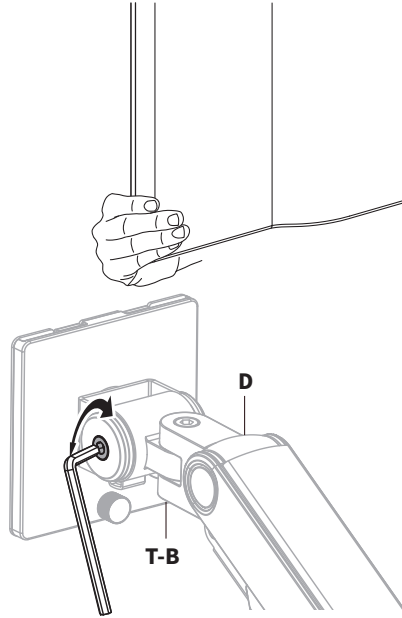

**2 Person
Adjustment is
Recommended**

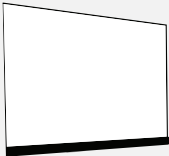

Ultra Thin Monitors



ALWAYS REMOVE MONITOR BEFORE RE-ADJUSTING

To prevent accidental damage to your screen, remove monitor and then follow Tilt Adjustment instructions. Reinstall monitor when desired angle is reached.

Adjusting Monitor Height

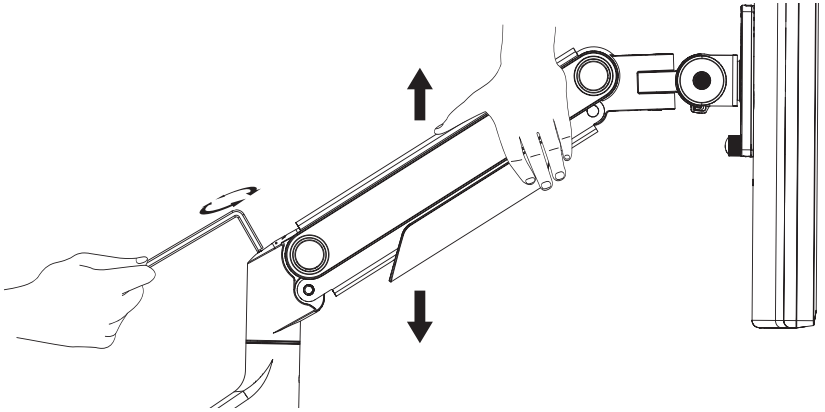

1 Position Mount Arm

Position the arm horizontally, as shown above, and firmly hold in place.

2 Insert 6mm Allen Wrench (T-B) Into Adjustment Screw

Insert the 6mm Allen Wrench (T-B) in to the adjustment screw on the back of the monitor arm.

3 Turn 10-20x to Set Monitor Height

Turn 6mm Allen Wrench (T-B) 10-20 times to obtain proper support for your monitor. Use the guide below to adjust the tension according to the amount of counterbalance needed to support the monitor.

Tension Adjustment Guide

Requires 10-20 Turns

Monitor Will Not Lower

Turn Screw *Counter-Clockwise* to Decrease Support

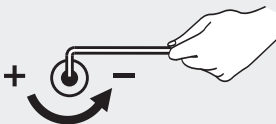

Turn the adjustment screw counter-clockwise to decrease the support for your monitor, allowing it to be lowered.

Monitor Will Not Raise

Turn Screw *Clockwise* to Increase Support

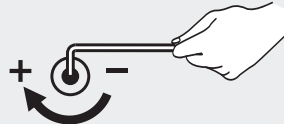

Turn the adjustment screw clockwise to increase the support for your monitor, allowing it to be raised up.

STEP 7

Remove cable cover on Spring Arm (**C**) by pulling the sides away from the arm to unclip them. Slide cable cover on Lower Arm (**B**) forward to remove it. Manage cables in cable covers and re-install.

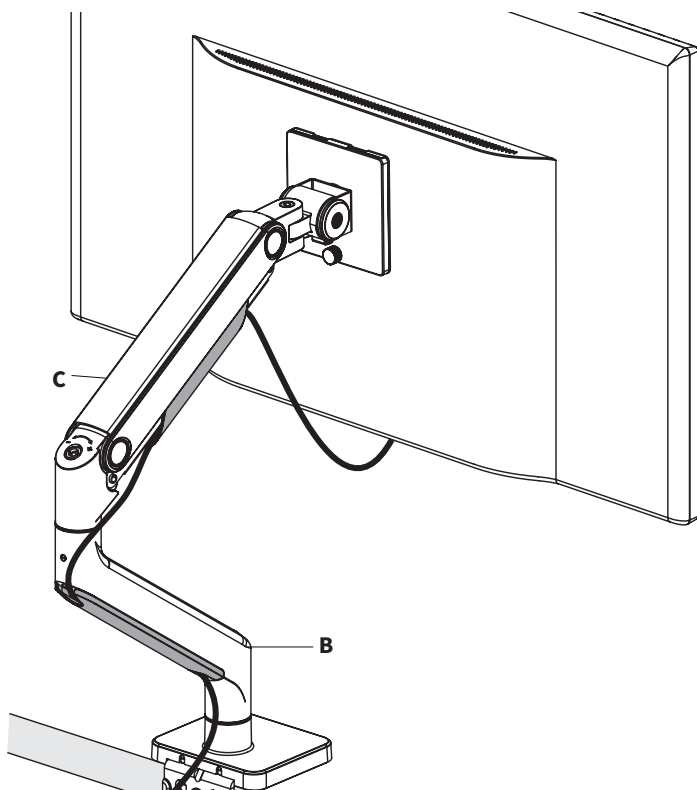

Spring Arm (C) Cable Sleeve

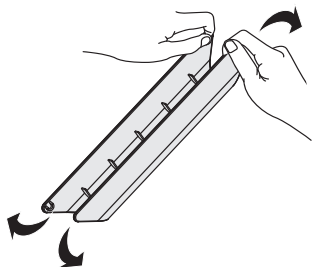

To remove Upper Arm Sleeve, gently pull apart.

Lower Arm (B) Cable Sleeve

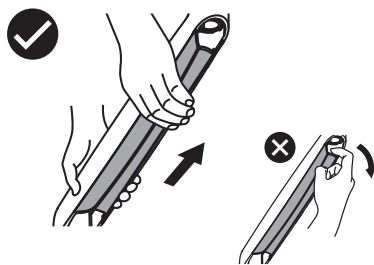

To remove Lower Arm Sleeve, slide the sleeve upwards. Replace when routing is complete.

Adjust as Desired

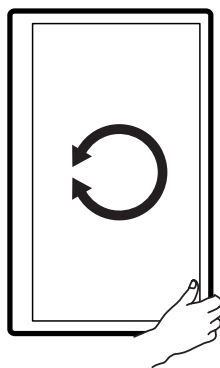
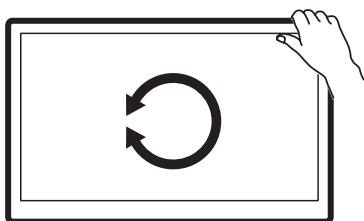
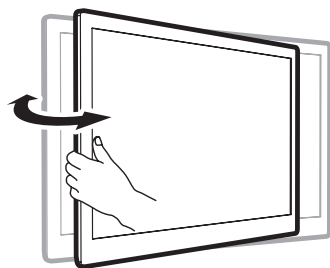
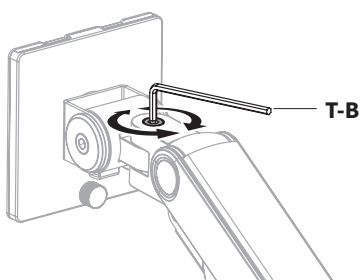

⚠ WARNING ⚠

Ensure the display is always positioned over the desk surface to prevent damage.

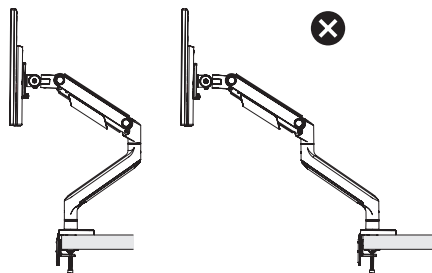
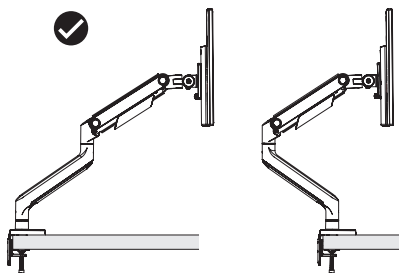



Need Help? **We're Here For You**

Monday-Friday from 7am-7pm CST

Saturday 8am-4pm CST



Email Us
help@vivo-us.com



Chat with Live Agent
www.vivo-us.com



Give Us a Call
309-278-5303 ext. 1



VIVO-us



@vivo_us



@VIVOus



VIVO