

DOUBLE DOOR METAL GATE

Accessories display:

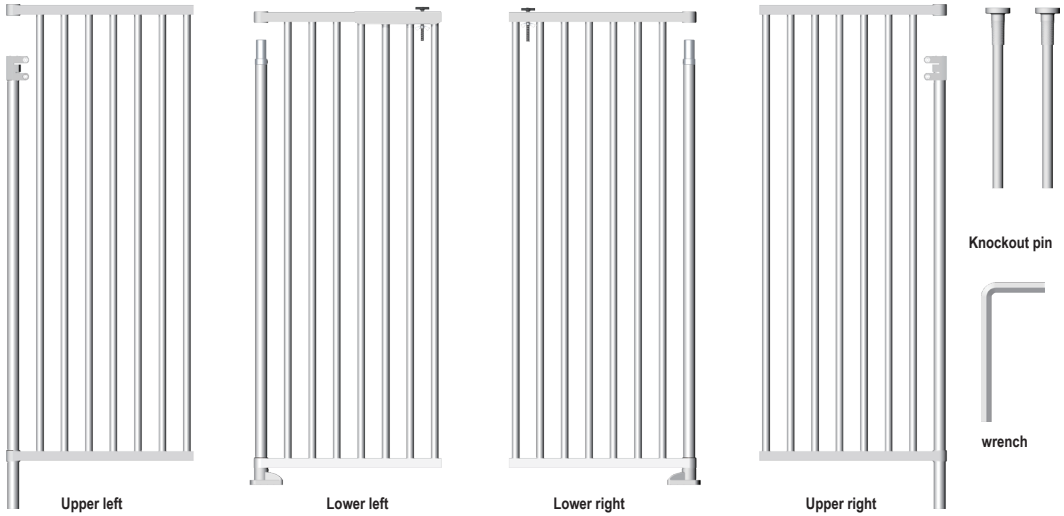

Installation Notes: After receipt, a total of 6 main accessories are as follows: the sides of the four main doors are marked with upper left, lower left, upper right, and lower right labels, two ejector rods are marked with ejector rod labels, and a screw part.

1. Remove the door lock installed in advance on the lower left and the screws that fix the door lock.

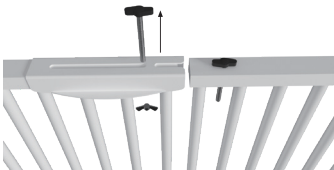

3. Install the door Lock, insert the screw into the hole in the middle of the left door to fix the door lock



2. Install and fix the upper left and lower left , and use the wrench to rotate and fx the middle Metal fasteners part of the lower right metal to fix the upper left and lower left door;

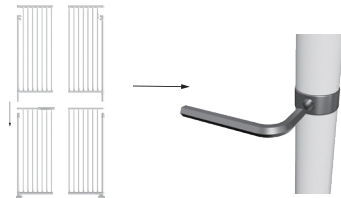

4. Install the knockout pin and insert it into the upper left tube bundle to adjust the height.

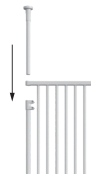

5. Same steps as above for the right door (the gap between the upper and lower doors The screws also need to be tightened)
6. Adjust the height of the knockout pin to 74.8-96.5inch, fix it in the door frame, and hold it against the door frame. After confirming the height, tighten the two screws on the access tube bundle
7. Rotate the rotatable part of the top of the ejector rod, adjust and tighten to lock the pole and the door frame.



Note: The height can be adjusted up to 74.8-96.5inch. The normal installation width of the door is 33.5inch. Slight adjustment can be applied to door frames of 33.5-35.8inch wide.

Instructions for use: The doors on both sides can be opened and closed 180 degrees. The door lock can be locked by gently pushing it into the gap in the middle of the door on the other side.

After inserting the tube bundle, you can stretch it up and down to adjust the height.

