

Installation Instructions for Cordless GII Madera Falsa 2-inch Blind



In the box (images are not to scale):

1 – Cordless GII Blind with Valance and tilt wand



2 – Hanging Brackets
8 – Screws and anchors

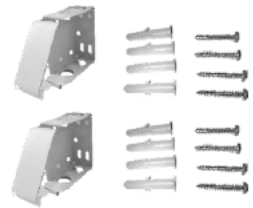

For door hanging option:
2 – Hold down brackets
4 – screws

2 – Valance clips



For 39-inch width blinds or greater:
1 – Center support bracket
2 – screws

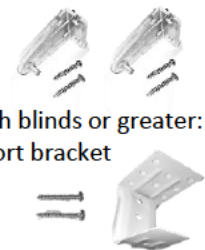

Important Safety Information

Please read all instructions, warning tags and labels provided with your new product. Proper installation and operation are essential to avoid injury. Keep these instructions for future reference.

Tools needed:

Pencil, tape measure, level, Phillips screwdriver,
drill, and 3/32-in drill bit

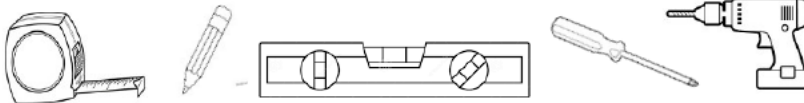

Time to complete:

Approximately 15 minutes

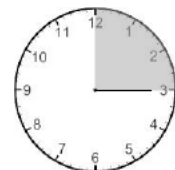

Installation Instructions for Cordless GII Madera Falsa 2-inch Blind

Step 1 – Determine mounting type for window: inside, ceiling or outside

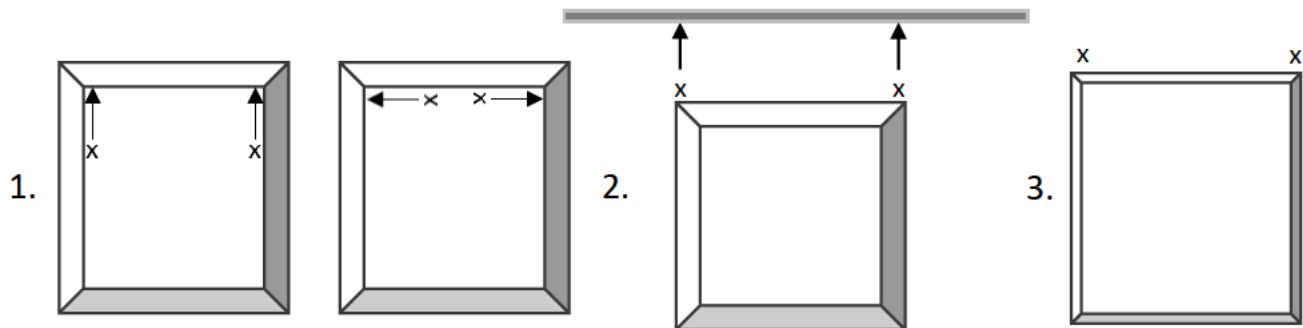

There are several options for hanging:

1. Inside mount will allow the blind to fit inside the window frame and will be installed using the bracket's top or side screw holes into the underside of the window frame.
2. Ceiling mount will allow the blind to hang in front of the window frame from the ceiling and will use the bracket's top screw holes.
3. Outside mount is typically chosen when there is not a traditional window frame. The blind will be installed into the wall above the window casing, using the bracket's back screw holes. This option can also be used when installing above a door's window. If installing on a door it is recommended to use a spacer block in between the door and bracket. The spacer block is not included with this product.

Measure the width of your desired hanging option, this blind will fit windows $\frac{3}{8}$ " (0.95 cm) smaller and $\frac{1}{2}$ " (1.27 cm) wider than it's stated size. This actual blind is $\frac{1}{2}$ " (1.27 cm) narrower/smaller than the stated size.

Step 2 – Place blind in desired location and mark the end corners of the headrail.

1. For inside mount, mark the underside of the window frame or the side of the window frame as indicated above in step 1.
2. For ceiling mount, use a tape measure to measure the thickness of the window frame and mark an equal distance from the wall as well as the corners of the headrail on the ceiling.
3. For outside mount, use a level to help ensure that the blind is completely level and mark the corners of the headrail. You can also use a tape measure to make sure the blind is perfectly centered above your window.

Step 3 – Align brackets and mark screw locations

Align brackets with the end headrail marks from step two. With the bracket's hinged side facing you, mark the appropriate screw holes for desired hanging option from step one. See bracket images below.

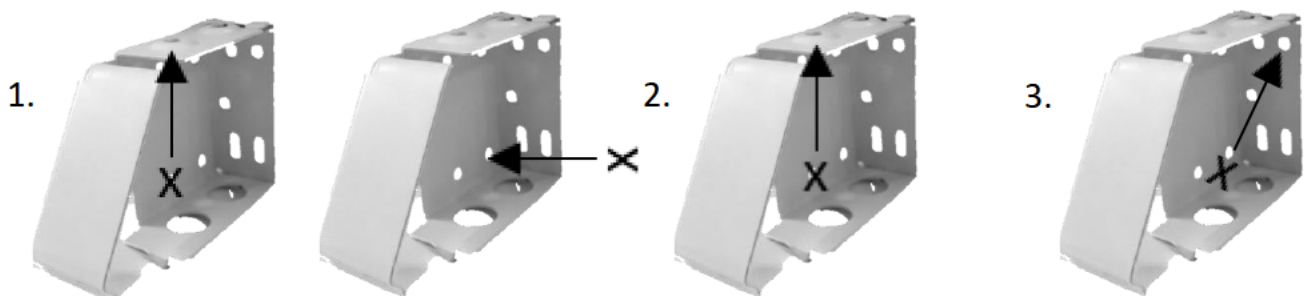

Installation Instructions for Cordless GII Madera Falsa 2-in Blind

Step 3 – continued

For blinds over 48" wide, a center support bracket will be provided. To install the support brackets, center the support bracket between the two end brackets. See diagram below. Keep the top and back of each support bracket level and aligned with the top and back of the end brackets. If more than one support bracket is used, space the support brackets evenly across the width of the headrail. Insert screws in the top for an inside mount, insert screws in the back for an outside mount.

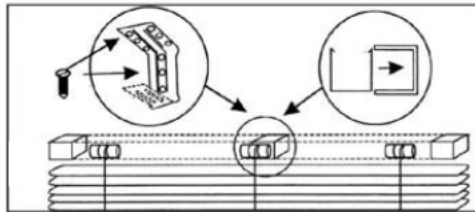

Step 4 – Drill holes at your pencil marks and screw brackets into place

Step 6 – Mount blind into brackets

With the blind fully retracted and the hook for the tilt wand facing you, slide the headrail into the end brackets and center support, if present. Then close the end bracket covers until they click into place.

Step 7 – Add Accessories

To attach the valance clips, simply insert the tab sideways into the slot on the back of the valance (see figure a), then twist the clip 90 degrees to secure the clip. After all clips are added to the valance, clip the valance onto the top of the headrail, see diagram b.

Add the tilt wand to the hook on the headrail.

For door installation: To attach hold-down brackets, lower the blind all the way down. Position bracket close enough to the bottom rail so that the hold-down pin lines up with the hole of the hold-down bracket, see diagram c. Attach the hold-down bracket with screws. Insert the pins into each side of the bottom rail.

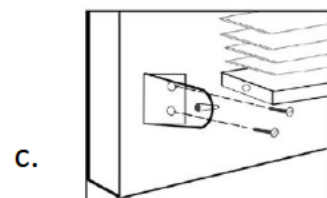
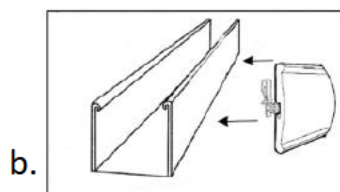
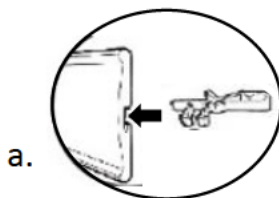

Operation Instructions

TO BRING THE BLIND DOWN TO THE WINDOWSILL:

Using the center of the bottom rail, pull the blind down to the windowsill.

TO FULLY OPEN THE BLIND:

Using the center of the bottom rail, simply push the blind up to the headrail. Please note, you can also stop at any desired height.

TO TILT THE SLATS:

Twist the tilt wand to adjust to the desired slat opening.

Installation Instructions for Cordless GII Madera Falsa 2-in Blind

Troubleshooting:

BOTTOM RAIL IS UNEVEN:

1. Raise the blind to the top and lower the blind using center of the bottom rail.
2. Lower the blind to approximately 3 ft from the headrail. While holding one side of the bottom rail, adjust the other side of the headrail as needed to align.
3. Raise and lower from the center of the bottom rail twice to check consistency and repeat above steps, if necessary.

DIFFICULTY ATTACHING HEADRAIL INTO MOUNTING BRACKETS:

1. Make sure the bracket is correctly secured to the window or wall, and the screws are completely tightened.
2. Make sure that the bracket is not interfering with the slats of the blind.

If additional assistance is needed, please contact our customer service center at the phone number or email address listed below.

Care of your new blind:

CLEAN:

Dust gently with a clean, damp non-abrasive cloth.

USAGE:

Do not over-extend blind.

Take care to not over tighten tilt wand, as this could break the hanging loop.

Proper installation and operation will extend the life and beauty of your new blind.

PLEASE NOTE:

This cordless blind cannot be shortened. This blind is intentionally made longer to allow for slat tilt operation. Altering the size of this blind will compromise the function of the blind.