

User Manual

T5005

Package List

Upon opening the package, please check for the following items:

- * 1 × Cold Press Juicer Machine
- * 1 × Pushing Rod
- * 1 × Strainer Container
- * 1 × Cleaning Brush
- * 1 × Juice Container
- * 1 × User Manual

Specifications

- * Material: ABS, Pure Copper Motor
- * Power: 300W
- * Per Container Size: 13×10×7.5cm/5.12×3.94×2.95in (600ml/20.3oz)
- * Powered By: US Plug 110V-240V
- * Power Cable Length: 114cm/44.88in/3.74ft
- * Item Size: 15×24×44cm/5.9×9.45×17.32in
- * Item Weight: 2.85kg/6.28lbs

Important Safe Instruction(For Household Use Only)

When use electrical appliances, basic safety precaution should always be followed including below:

1. Read all instruction carefully before using.
2. To protect against risk of electrical shock, do not put main body (motor) in water or any liquid.
3. Children should be supervised to ensure they do not play with the appliance.
4. Do not operate any appliance with damaged cord or plug or after the appliance malfunctions, or it is dropped or damaged in any manner. Return the appliance to nearest authorized service agent for examination, repair or electrical or mechanical adjustment.
5. If the supply cord is damaged, it must be replaced by manufacturer or its service agent or similar qualified person in order to avoid hazard.
6. Always unplug when it is not in use or before assembling or taking off parts or cleaning.
7. Forbid to touch moving parts.
8. Do not use any attachments which is not supplied by manufacturer, otherwise it may lead to fire, electrical shock or other injury.
9. Always ensure to switch off appliance and motor has been stopped completely before disassembling.
10. Do not put your fingers or any foreign object into the juicer when it is working. If food is stuck in the inlet, use pusher to push it down or use reverse switch to unstuck. If this manner can not solve the problem, then stop juicer immediately and ensure the motor is stopped.

11. Do not use appliance outdoor.
12. Do not use appliance for other intended purpose.
13. Do not put any parts into dishwasher for cleaning
14. Do not use the appliance more than 10min constantly to avoid motor is damaged. Use it again until appliance is cool (around 20mins)
15. Do not use appliance to extract had material, like large seeds, ice, frozen fruit and so on.
16. This appliance is not intended for use by persons (including children)with reduced physical, sensory or mental capabilities, or lack of experience and knowledge, unless they have been given supervision or instruction concerning use of the appliance by a person responsible for their safety. Children should be supervised to ensure that they do not play with the appliance.
17. Switch off the appliance and unplug from socket before changing accessories or approaching parts that move in using.

Installation & Operation Instruction

(1) Parts Instruction

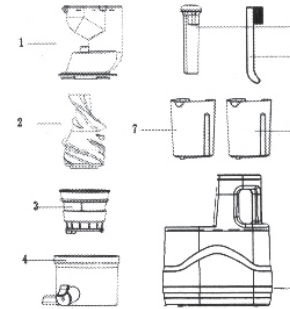

1. Hopper
2. Spiral Auger Head
3. Filter
4. Juice Bowl
5. Pusher
6. Cleaning Brush
7. Pulp Cup
8. Juice Cup
9. Base(Main Body)



Please scan the QR code to watch the assembly video before installation.

(2) Installation

Importance: Prior to assemble the juicer, please check this point: at the base of bowl, there is a rubber stopper, correctly fix the stopper to ensure all of the juice only exits via the juicer outlet, before extracting always ensure the rubber stopper is firmly in place. See below fig.

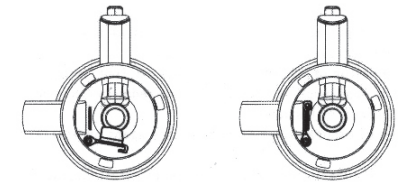

1. Assemble bowl onto the base. Put bowl on the base and clockwise rotate to lock the bowl. Make sure the bowl is always locked on the base tightly. See below fig.

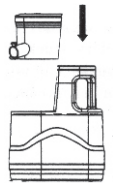

2. Insert the auger head and filter into the bowl, make sure the auger head's shaft must be tightly fixed on the bases axes. See below fig.



3. Assemble hopper onto the bowl: Align the bowl and hopper, cover the hopper, and then rotate the hopper clockwise. See below fig.

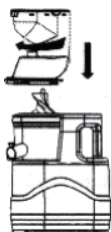

(3) Operation Instruction

Importance:

- Do not switch on appliance prior to inputting materials
- Do not operate appliance more than 10mins at one times

1. Plug in appliance
2. Place cups under outlet of juice and outlet of pulp
3. Know of switch: ON/ OFF/REV -- see switch button on product
 - ON-starts the motor and juicing process
 - O-switch off appliance
 - R-reverse rotation, only use the function when something is stuck in the bowl and need to be unclogged
4. Put materials into the hopper to extract juice. Ensure pieces are not large to enter into hopper. Remove hard seeds or pips or other hard part of material. Do not over stuff the hopper or force material in. Put material slowly one by one. The pusher only be used if materials are stuck.
5. Switch on juicer to extract juice, at the same time put materials into hopper one by one as step 4.
6. If materials are stuck or clogged, stop juicer and then shift switch to REV to unclog materials.
If such action is not working, stop juicer and disassemble hopper to clean material, then assemble hopper again to go on work.(very important: Before disassemble hopper, must unplug from power socket)
7. When finished or leave juicer for a while, switch off the juicer and unplug from power socket.

Cleaning & maintenance

(1) How To Clean Juicer

1. Switch off juicer and unplug from power socket before cleaning
2. As per step of assembling to be reverse method to disassemble all parts of juicer one by one
3. Use brush to clean all parts under water tap
4. Use damp cloth to wipe base, make sure do not let any liquid go into the base

(2) Trouble Shooting

Before you call for service, review the trouble shooting firstly

Problem	Possible Case	What To Do
No Power To Work	Juice is not plugged in correctly	Check the juicer is plug in tightly
	Incorrect to assemble hopper	Re-assemble hopper correctly
Motor Is Stopped During Working	* Bowl is overfill with material * Hard material inside of much fiber inside that cause juice be stuck	Press reverse button to unclog material. If not working, then disassemble hopper to clean materials and then assemble hopper again to try. If juicer still not working, stop to call service agent.
Leakage From Beneath The Bowl	Rubber plug on base of bowl is not inserted correctly.	Disassemble all parts to check rubber plug and re-plug in correctly
Stain On The Bowl, Filter, Spinning Brush	Natural color from juicing material	This is perfectly normal
Damage Filter	Frozen material, seeds, pips, and other hard material in bowl	Ensure you have read the manual carefully and operate correctly
Squeaking Noise During Working	Juicing noise from squeezing screw	This is perfectly normal. Ensure you did not over stuff material
	Some hard material in the bowl	Stop juicer to disassemble hopper to clean material

Warning Sign

1. The machine must be installed in place, the feed tube behind the buckle need to lock with the host lock to close the normal operation, not installed in place of the machine will not work.
2. Please push the material with the material bar, do not use the brush, chopsticks, spoons and other hard objects into the feed mouth, to avoid the machine stuck and damaged.
3. Multi-fruit meat ingredients such as mango, banana and other recommended direct consumption, or with other hard fruit, such as apples, pears and other mixed use. High-fiber fruits and vegetables such as celery, cut into small pieces to put; ultra-high-hardness, such as cut sugar cane can not put into use. Products for food-grade PC material is not resistant to strong acid, can not squeeze lemon and other strong acid fruit ingredients.
4. Use time please control within 20 minutes, more than 20 minutes need to be disassembled and cleaned at least half an hour before re-use. After use, please clean it immediately. Do not leave it uncleaned for a long time. If the machine is stopped halfway or can not be opened due to food blockage, please press the reverse switch for about 3 seconds, and then re-use.
5. Product quality problems due to improper operation will be non-refundable and free maintenance, please comply with the operation specifications.