

## WALL MOUNTED AV CONSOLE ASSEMBLY INSTRUCTIONS

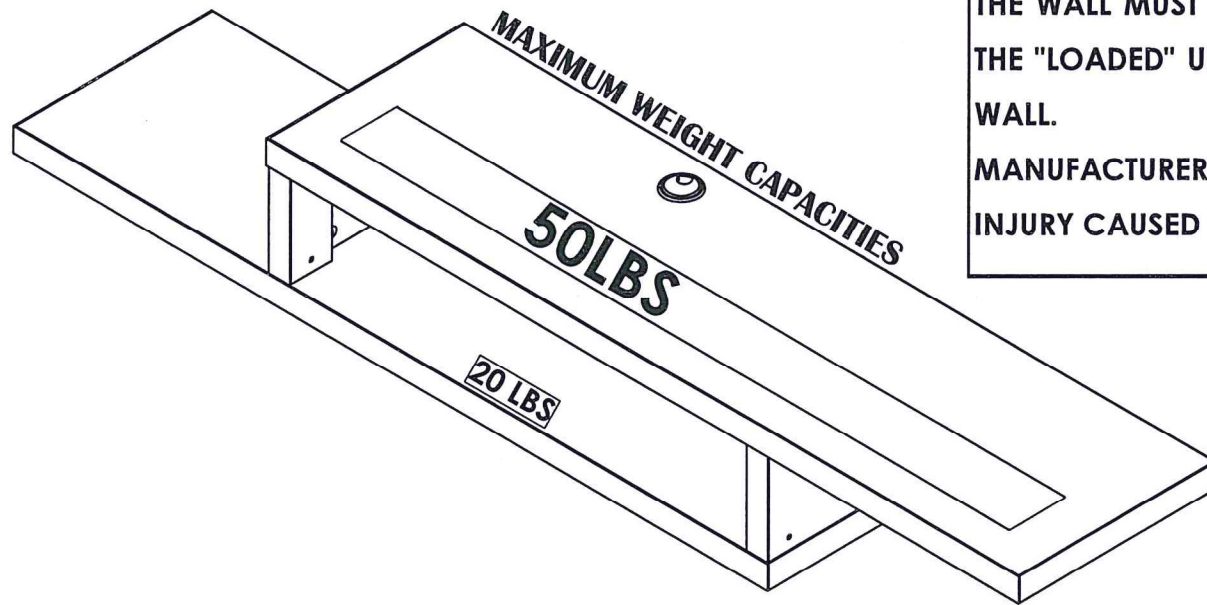

THIS PRODUCT IS DESIGNED FOR WALL MOUNTED TV's DO NOT PLACE TV DIRECTLY ON CONSOLE.

THE WALL MUST BE CAPABLE OF SUPPORTING THE WEIGHT OF THE "LOADED" UNIT AND ANY OTHER ITEMS ATTACHED TO THE WALL.

MANUFACTURER IS NOT RESPONSIBLE FOR DAMAGE OR INJURY CAUSED BY INCORRECT ASSEMBLY OR USE.

### IF A PART IS NEEDED PLEASE NOTE:

MODEL #

DATE OF PURCHASE

PURCHASE LOCATION

SERIAL # ON BOX

PART # FROM INSTRUCTIONS  
(SEE PAGE 2) YOUR ADDRESS AND  
CONTACT INFORMATION

## WARNING

THIS PRODUCT CONTAINS SMALL ITEMS THAT COULD BE A CHOKING HAZARD IF SWALLOWED.

## PARTS

- 1 TOP
- 2 LEFT SIDE PANEL
- 3 RIGHT SIDE PANEL
- 4 BOTTOM SHELF
- 5 WALL CLEAT

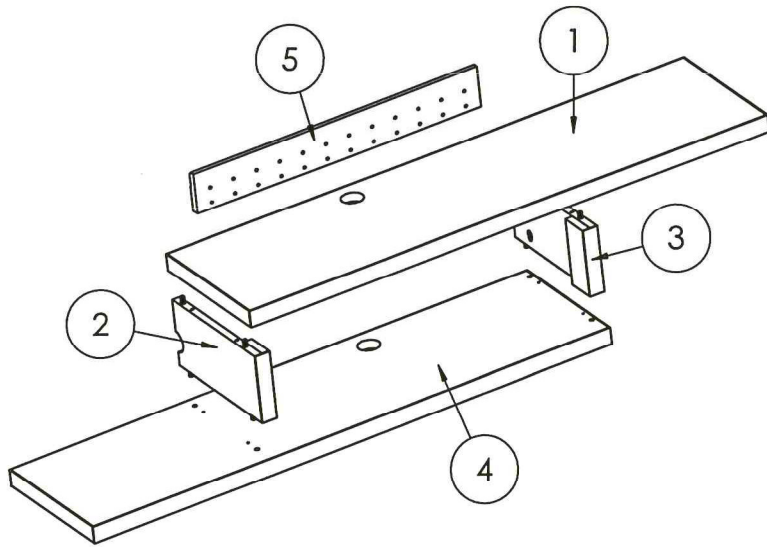

## REQUIRED TOOLS

\* 2 Person assembly recommended



Phillips Screwdriver

Level

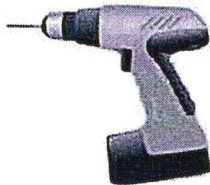

Power Drill

For mounting wall cleat only

## CAUTION

Do not over tighten any screw. the last few turns of each screw should be done very slowly or by hand.

## HARDWARE

- A CAM LOCK DOWEL [X4] (ACTUAL SIZE)
- B L. BRACKET [X4]
- C PHIL RDN WASHER [8X] (ACTUAL SIZE)
- D BARREL NUT BLACK [X4] (ACTUAL SIZE)
- E CAM LOCK [X4] (ACTUAL SIZE)
- F 4mm HEX WRENCH [X1]
- G HILO. SCREW [X4] (ACTUAL SIZE)
- H MODZ10X0350 [X6] (ACTUAL SIZE)
- I 6 X 5/8 PHIL FLAT PBS BLACK [x4] (ACTUAL SIZE)
- J GROMMET [X1]

**STEP 1.** INSTALL FOUR CAM LOCK DOWELS (A) INTO TOP (1).  
INSTALL FOUR L-BRACKETS (B) INTO THE LOCATOR HOLES ON THE  
TOP (1) USING EIGHT PHILLIPS WASHER SCREWS (C).

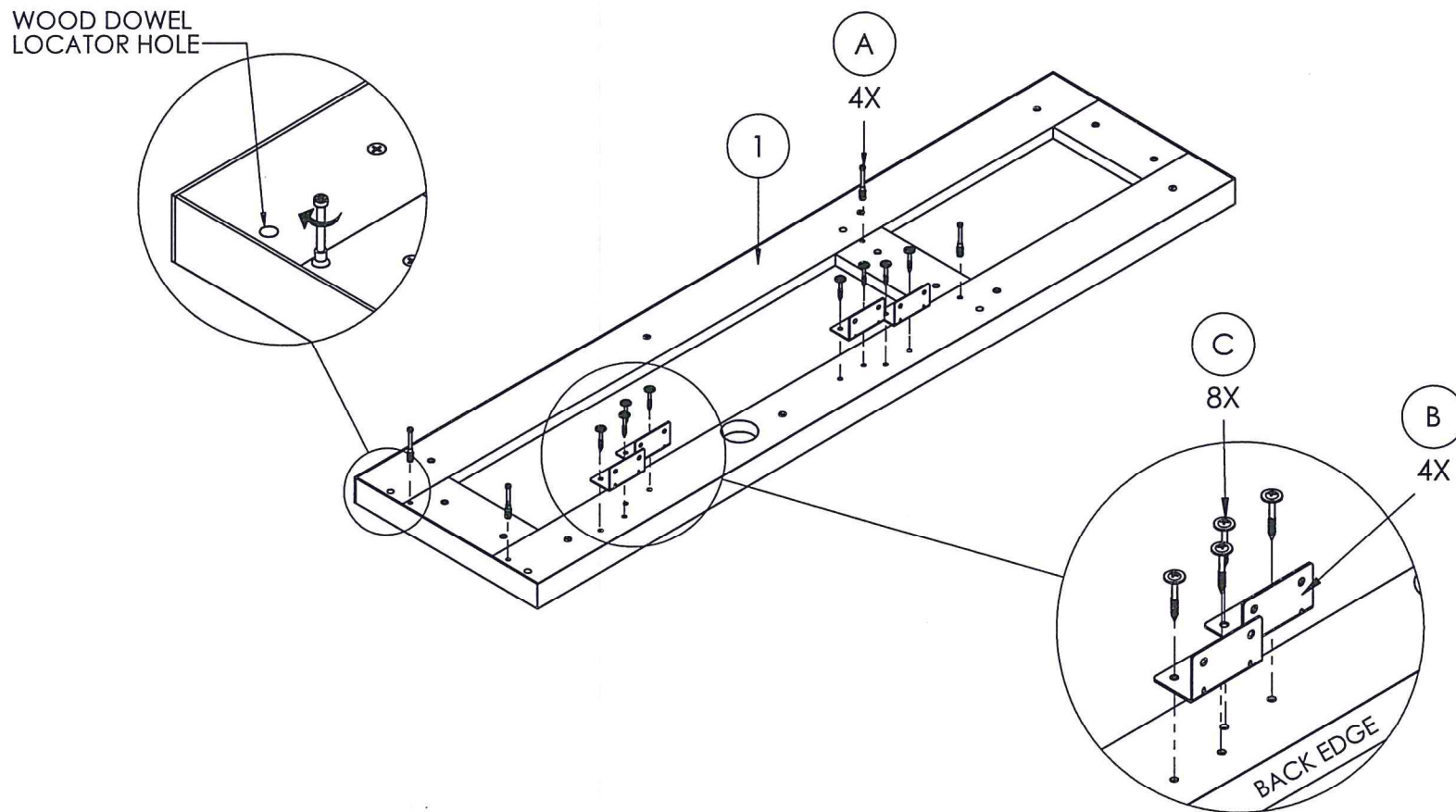

**STEP 2.** INSERT TWO BARREL NUTS (D) INTO EACH SIDE (2 & 3).

ALIGN SLOT ON BARREL NUT SO THAT IT "POINTS" TO THE EDGE OF THE PANEL TO RECEIVE HILO SCREW

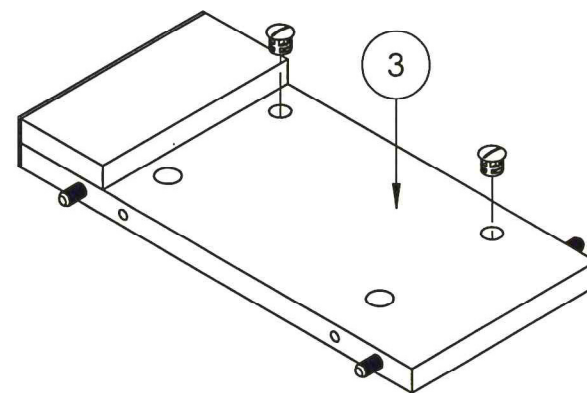
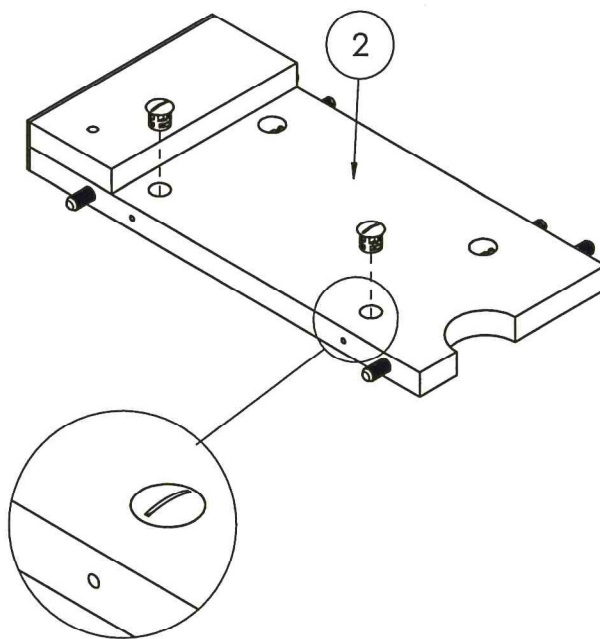
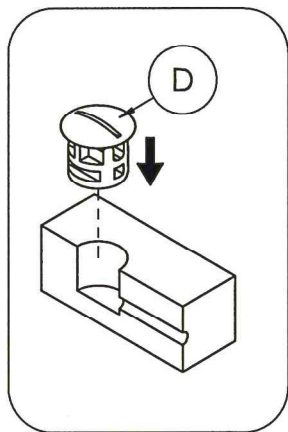

**STEP3.** POSITION LEFT SIDE PANEL (2) TO THE EDGE OF THE TOP (1) [DETAIL A **1**➤]

POSITION RIGHT SIDE PANEL (3) TO THE CENTER OF THE TOP (1)

ALIGN AND INSTALL FOUR CAMS LOCKS (E) INTO HOLES [DETAIL A **2**➤] TIGHTEN USING ALLEN WRENCH (F). [DETAIL A **3**➤]

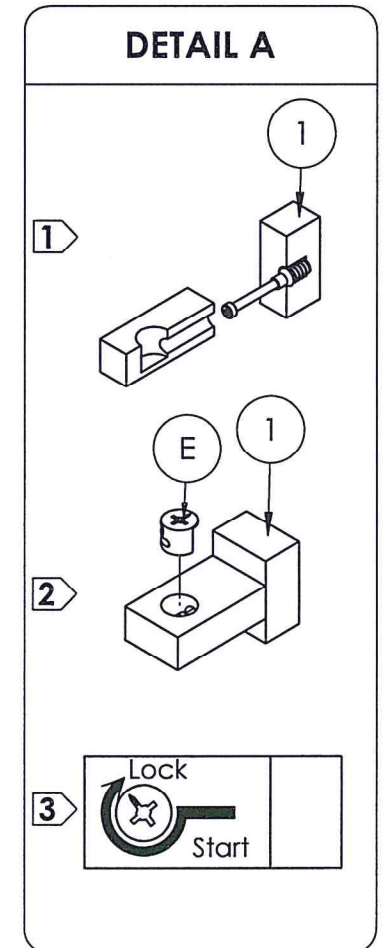
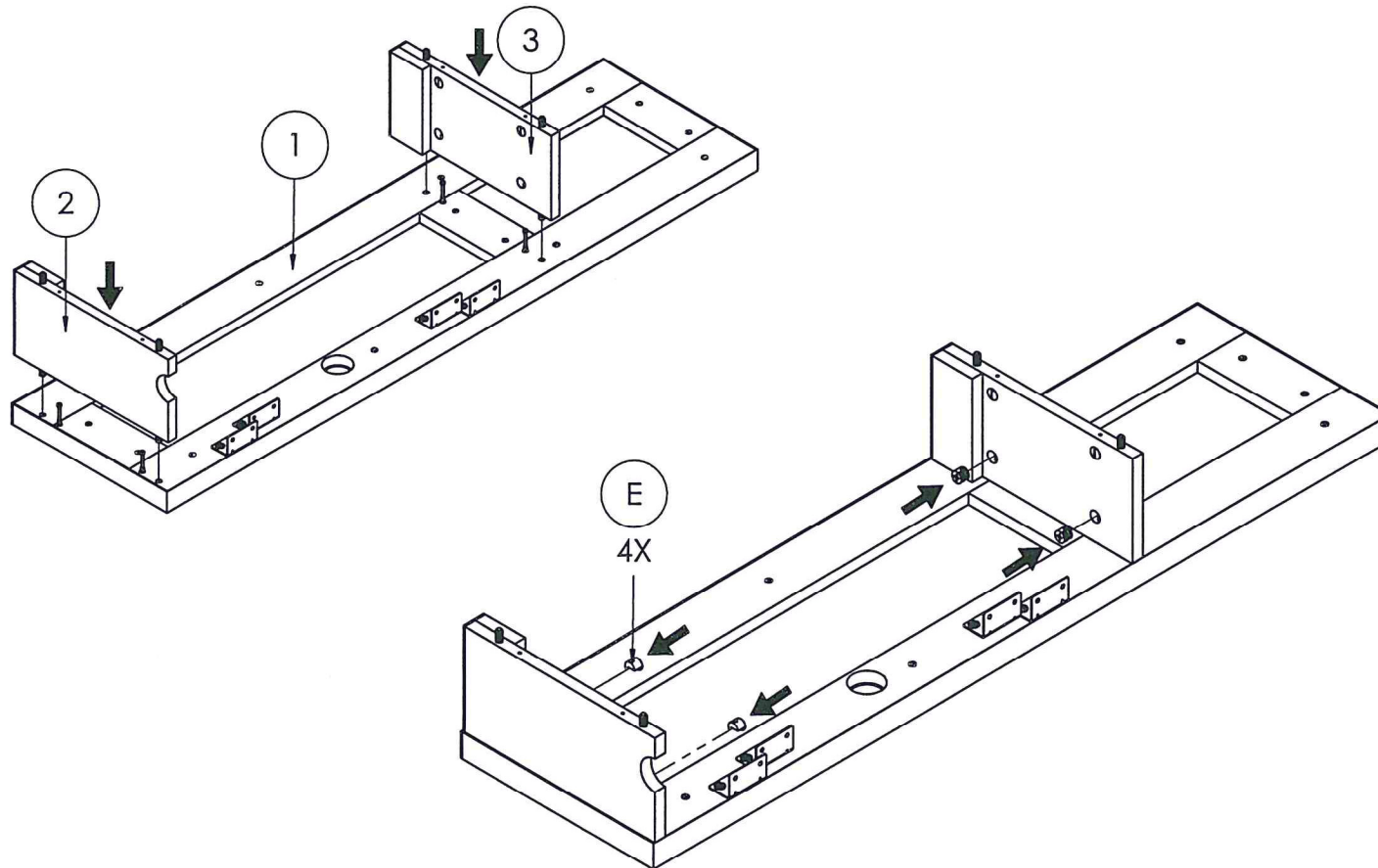



**STEP 4.** ALIGN THE BOTTOM SHELF (4) ONTO BASE SUBASSEMBLY. **1**

USE FOUR HILO SCREWS (G) TO ATTACH THE BOTTOM SHELF (4).

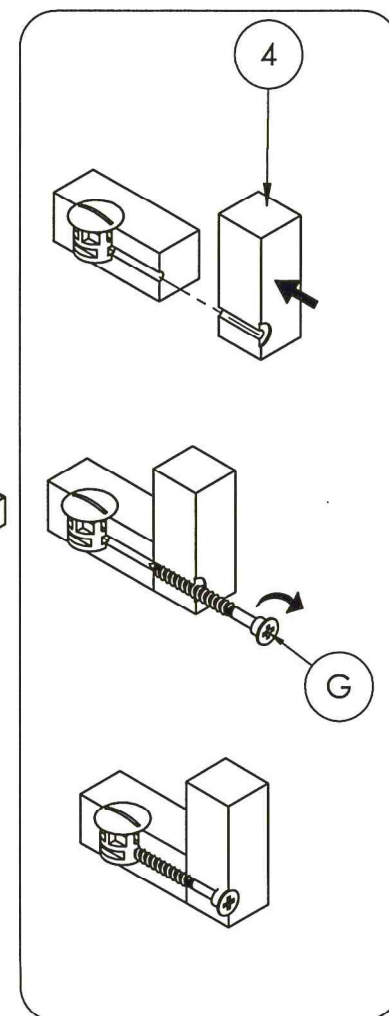
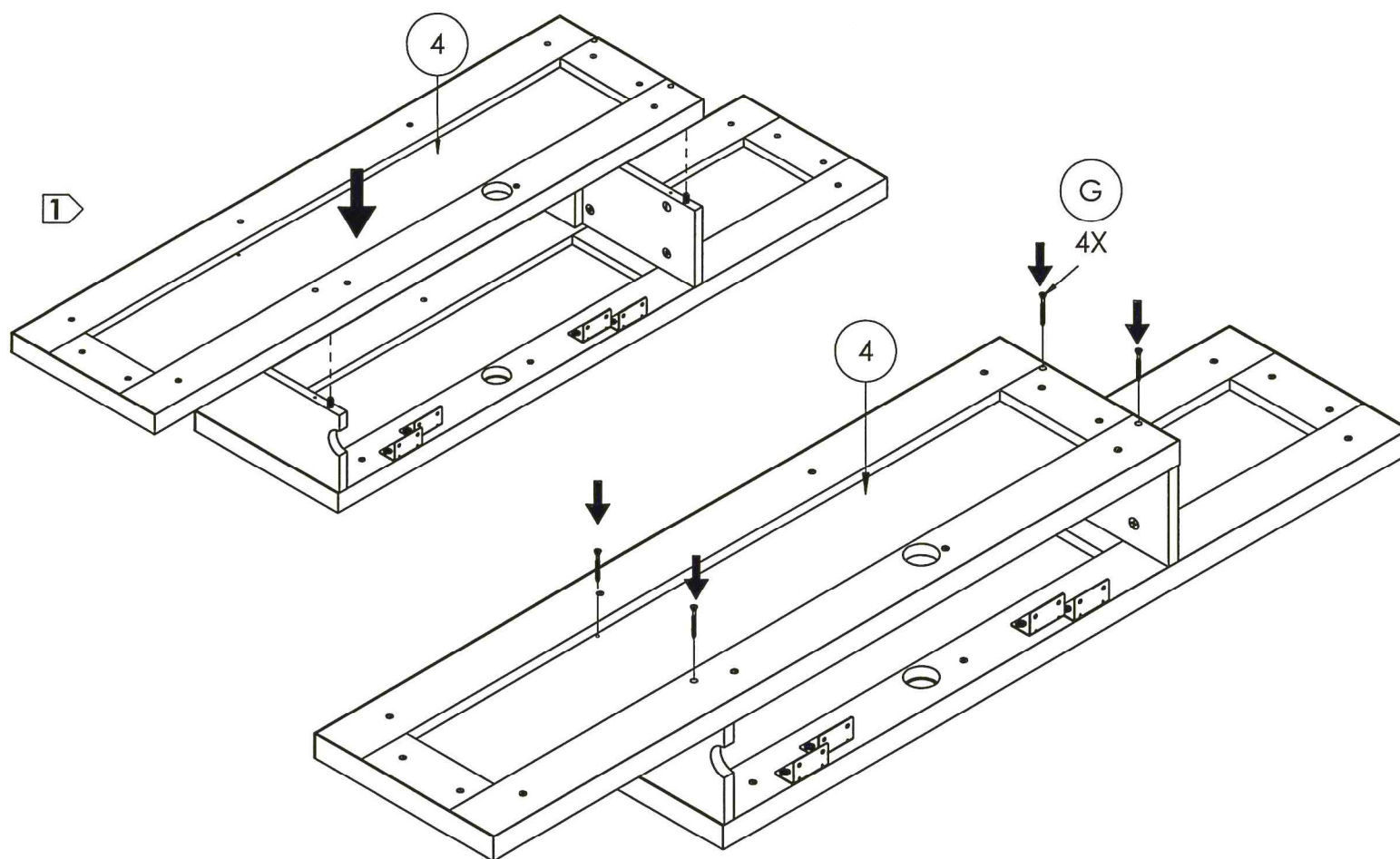

## CAUTION

-AVOID PERSONAL INJURIES AND PROPERTY DAMAGE!  
 -DRYWALL COVERING WALL MUST NOT EXCEED 5/8" (16mm)  
 -MINIMUM WOOD STUD SIZE: COMMON 2X4, NOMINAL 1-1/2"X3-1/2" (38mmX89mm)

-MINIMAL HORIZONTAL SPACING BETWEEN FASTENERS; 16" (406mm)  
 -BE SURE TO SCREW INTO THE CENTER OF THE WOODEN WALL STUD.

## WOOD STUD WALL MOUNT INSTRUCTION SHEET

Determine where you want to hang the Console.  
 Make sure you are able to attach it to 3 wall studs.

STEP 1. Locate wood studs.

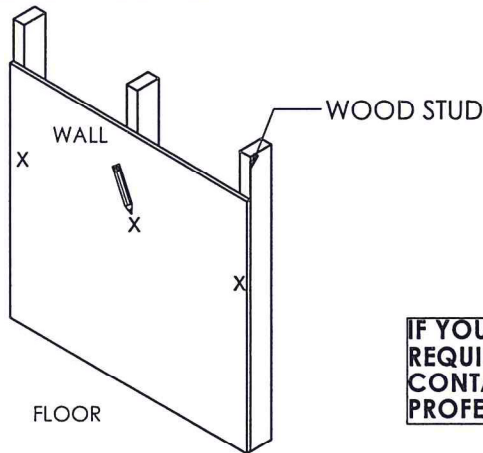

**IF YOU CAN NOT LOCATE THE  
 REQUIRED WOOD STUDS,  
 CONTACT YOUR LOCAL  
 PROFESSIONAL.**

STEP 2. Using a lever, draw a horizontal line on the wall.

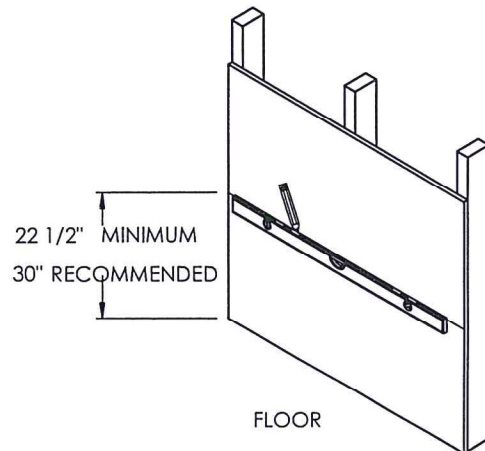

STEP 3. Attach the wall cleat with (5) notch facing the wall, using six modz screws (H) and using the line (step2) to make sure it is level.

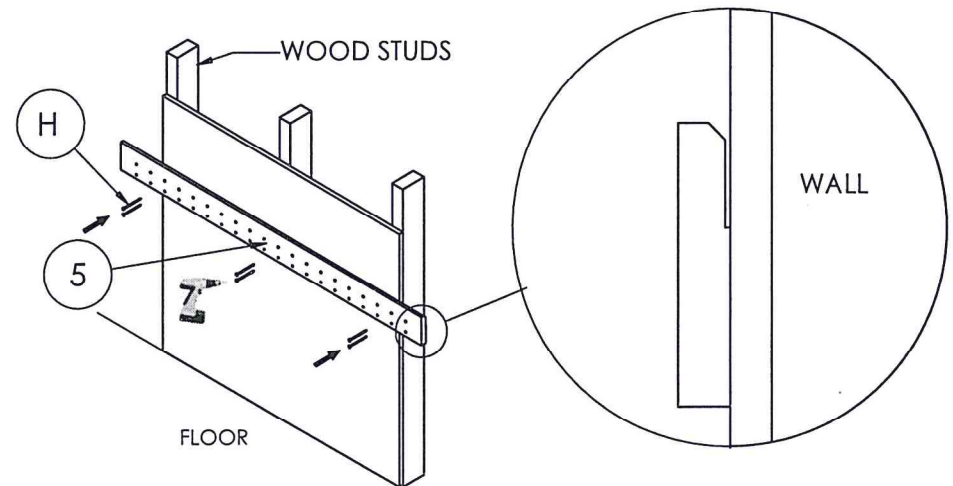

STEP 4. Mounting the console requires two people, carefully lower the console brackets (B) onto the wall cleat (5) until the unit fits tightly into the wall cleat.

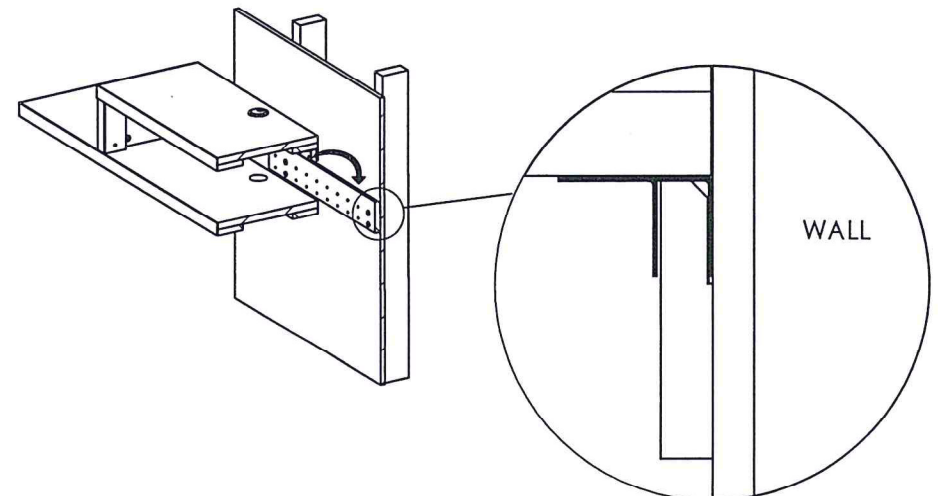

**STEP 5.** Secure the console to the wall cleat (5) using four #6 bx 5/8 screws (I) through the L-bracket (B).

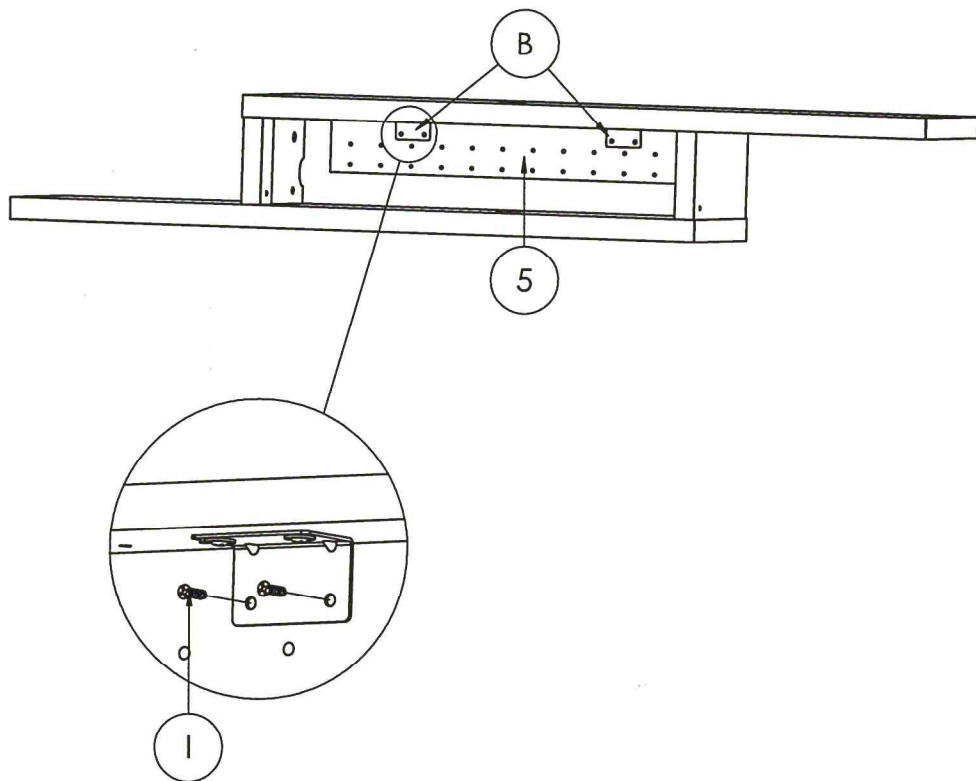

**STEP 6.** Install grommet (J) into Top (1).

