



Chandelier Instruction

DIRECTORY

PRODUCT ANALYSIS	2
FEATURES AND SCOPE OF APPLICATION	2
TECHNICAL PARAMETERS	2
INSTALLATION DIAGRAM	3
INSTALLTION REQUIREMENTS	4
PRECAUTIONS	5
APPLICABLE ROOM SIZE	5
SCOPE OF USE	6

01

PRODUCT ANALYSIS

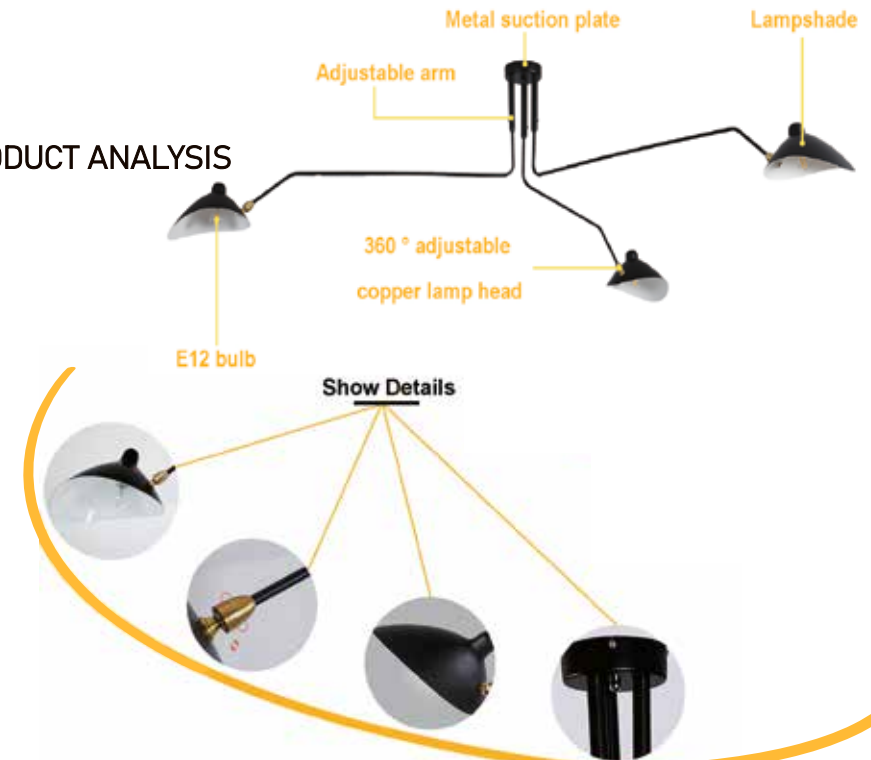

The modern fashion design of the branches has different arms that allow you to clean it easily. Three unbalanced arms have a real and primitive appearance. The entire minimalist design is classic, not rigid. This simple and ancient appearance can enhance your space.

02

FEATURES AND SCOPE OF APPLICATION

03

TECHNICAL PARAMETERS

Working voltage	AC110V
Colour	Black
Material	metal
Number of lights	3
Bullet foundation	E12
Maximum power	3*40W

04

INSTALLATION DIAGRAM

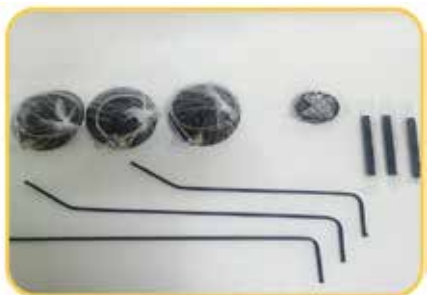
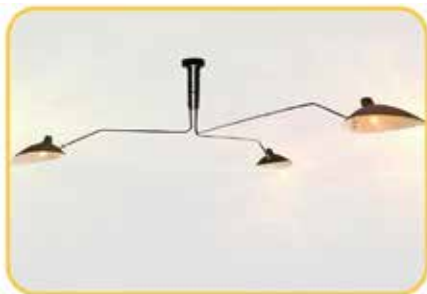

Installation Steps

①



②



③



④



⑤



05

INSTALLATION REQUIREMENTS

1. Please check whether the lamps and accessories are complete before installation. Lamps and accessories should be free from damage, deformation and paint peeling.

2. The carrying capacity of the lamps on the wall and ceiling where the lamps are installed should match the weight of the lamps.

3. Before installing the lamp, please conduct a power-on test to confirm that the lamp can be lit.

4. Please make sure the power supply is disconnected before installing the lamp.

(1) Thread the chain through the long pipe.

(2) Tie the wire to the chain and pull it out.

Pay attention not to pull off the L and N marks (On the line with printed words is L and on the other side with out words is N)

(3) Rotate the elbow to the lamp shade, pay attention to the alignment of the teeth of the lampshade and the teeth of the pipe, and turn clockwise to tighten the teeth.

(4) Install the rotating straight pipe, and install the rotating straight pipe on the other end to pass the line through the bullet shaped nozzle, and the line comes out from the flat end pipe. Then screw on m10*20mm tooth rod. Repeat the above operations for three lamp arms to complete the installation. Note that the number on the lampshade matches the number on the tube: 1, 2, 3.

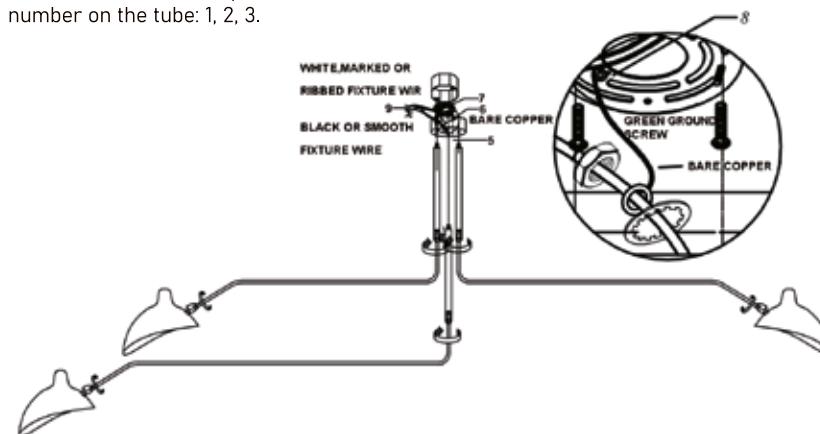
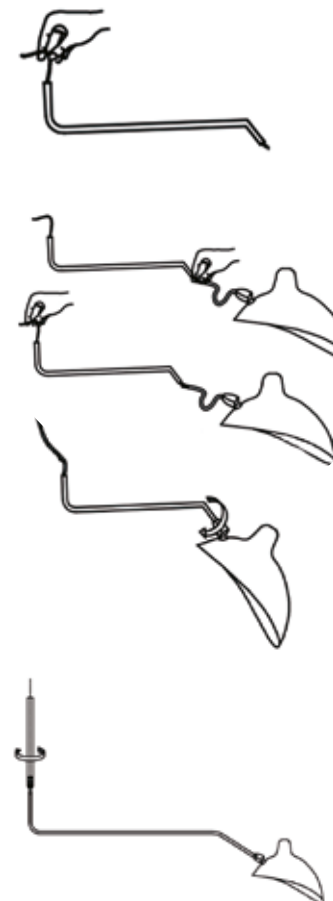

06

PRECAUTIONS

1. Ac110~130v,50~60Hz. The maximum power of the lamp is 40W class a bulb.
2. Avoid scratching the lamp surface and wires during installation.
3. Connect the live wire black with the L wire, connect the zero wire with the N wire, and wind the bare copper wire on the greenscrew with the symbol \perp on.

4. Before the ceiling is completely dry, do not install it on the ceiling. The surrounding must be ventilated and dry.

5. Keep away from acidic and alkaline objects and gases, clean with a soft cloth, and do not wash with water.

6. Lighting fixtures must be installed by professional electricians and can only be used indoors.

7. Please cut off the power supply when installing, cleaning and replacing the bulb.

07

APPLICABLE ROOM SIZE

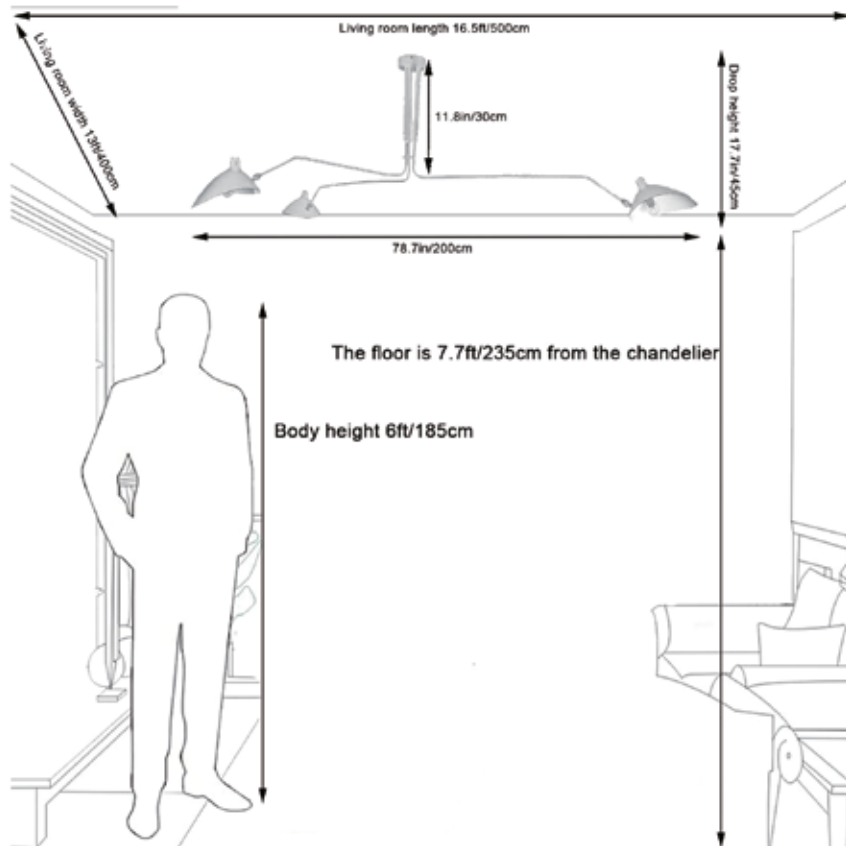

08

SCOPE OF USE

Use various occasions to add fun of life

Creative lighting originated from the Light of nature
Light your life