

VANE MASSAGE OFFICE CHAIR USER MANUAL

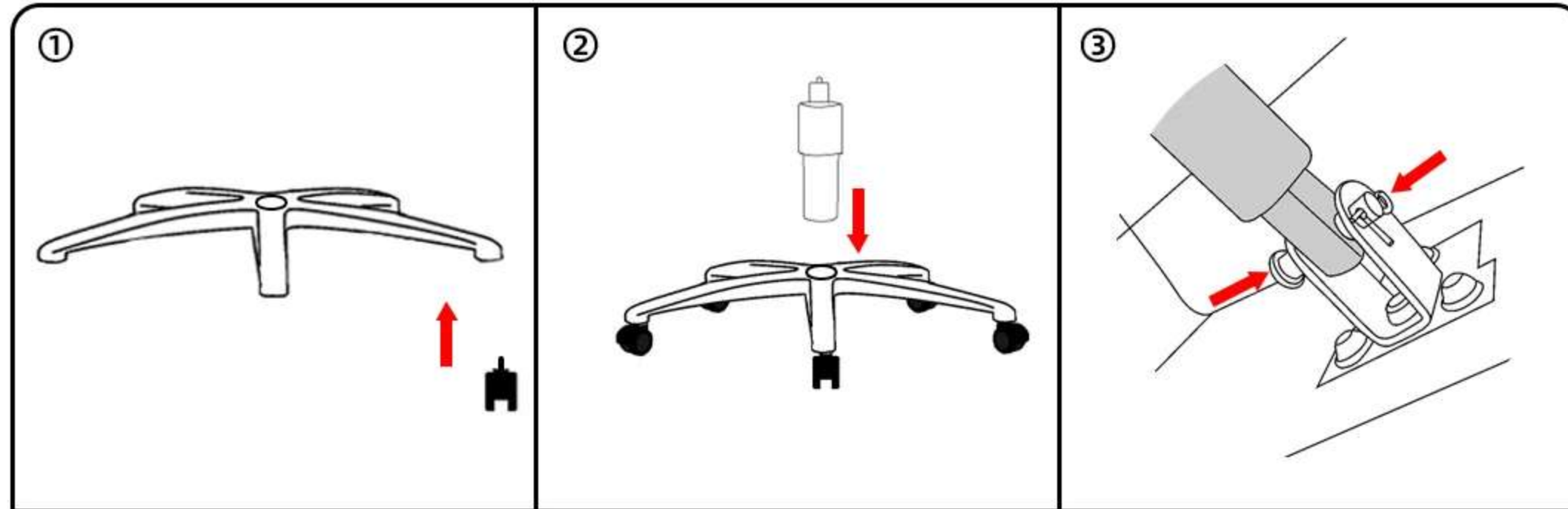

ASSEMBLY INSTRUCTION



1. Install the casters by pressing firmly into the base.

2. Insert the gas lift cylinder into the center of the base.

3. Connect the reclining rod with the fixed end of the backrest.

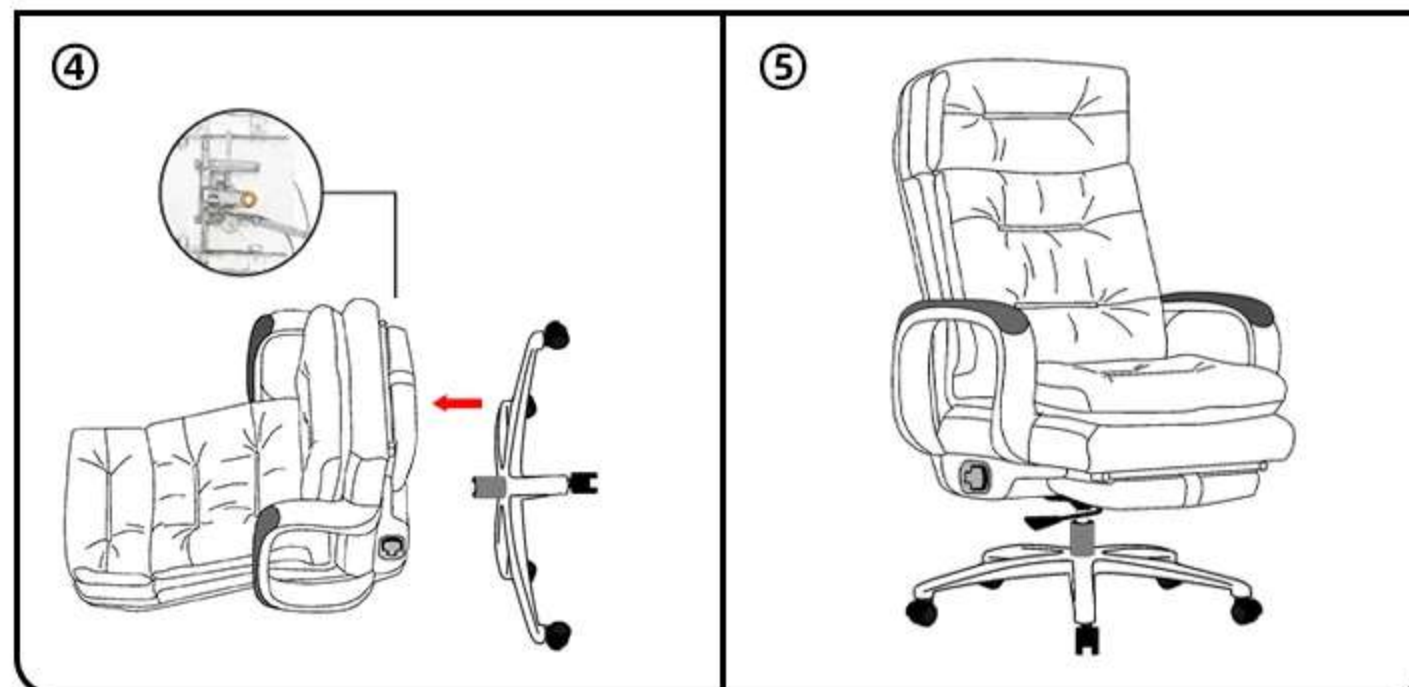

4. Insert the top of the gas lift cylinder into the mounting hole.

5. The installation is complete.



PARTS LIST

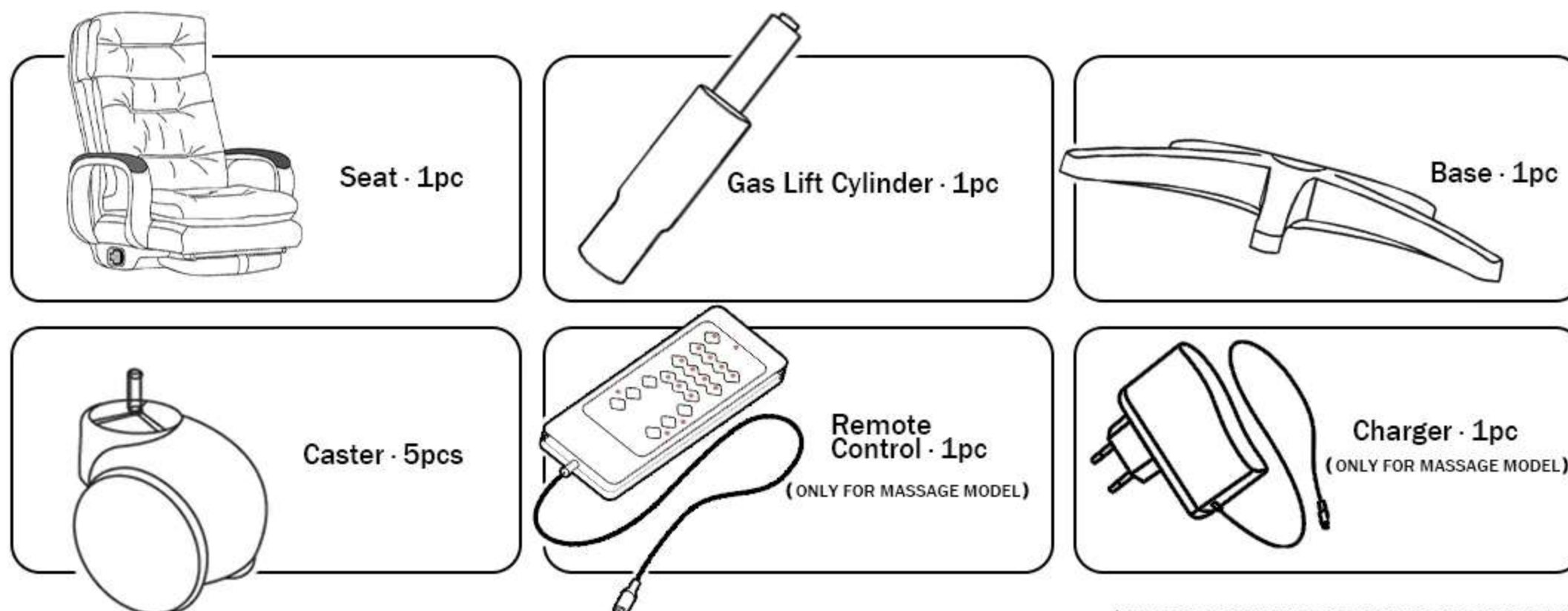

* PLEASE MAKE SURE ALL PARTS ARE INCLUDED



FEATURES & FUNCTIONS



IMPORTANT SAFETY CAUTIONS

