

Assembly Instructions

Manual Recliner / Glider

IMPORTANT NOTE

Read these instructions carefully, and familiarize yourself with each procedure before assembling the furniture. Check that you have all the component parts, and familiarize yourself with each part before proceeding.

Take all the fittings out of the plastic bag and separate them into groups. Ensure you have enough space to lay out all the parts before assembly. To prevent damage to the parts, we recommend that you assemble the unit on a soft, level surface.

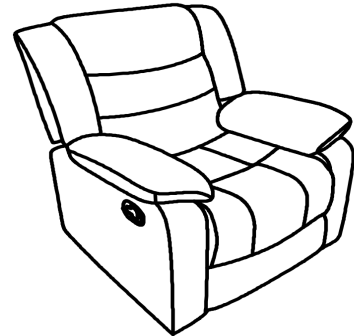

Part List

A. Back
1 piece

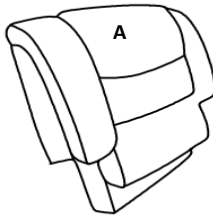

B. Seat
1 piece

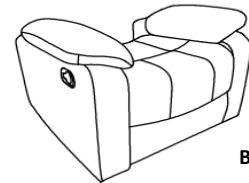

Assembly Instructions

STEP 1

Attach the Back (A) to the Seat (B). Ensure the latches fit well. (See Figure 1.)

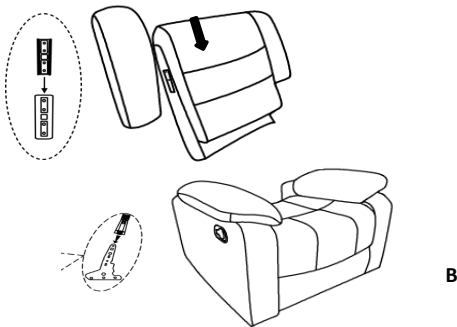

Figure 1

STEP 2

Fasten the back flap to the bottom of the furniture. (See Figure 2.)

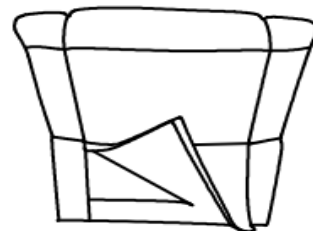

Figure 2

IMPORTANT NOTE

- To avoid any risk of suffocation to children or pets, dispose of all plastic bags immediately.
- To ensure proper performance, occasionally check for loose screws and tighten as needed.
- If the reclining functions are not working properly, check for loose cable connections before contacting the retailer.

Modular Sofa Assemble Instruction

Step 1: BACK CUSHION ASSEMBLY INSTRUCTION

BACK ASSEMBLY. INSERT BACK CUSHION INTO THE BASE ON BOTH SIDES AT THE SAME TIME

LAF/RAF Recliner :

take the back ear out from the underneath c

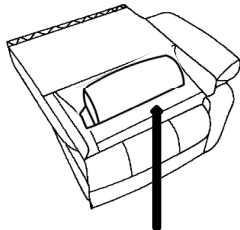

back ear

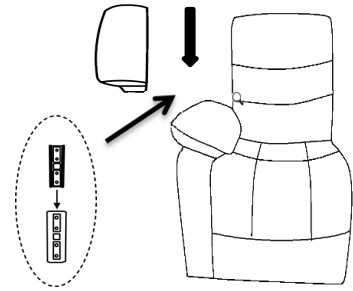
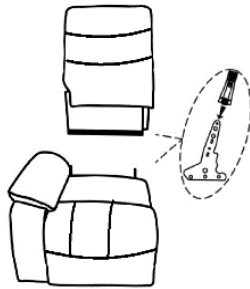

Console:

Step 1: Open bottom of console the zipper, then take the backrest .

Step 2: Insert "A" to "B"

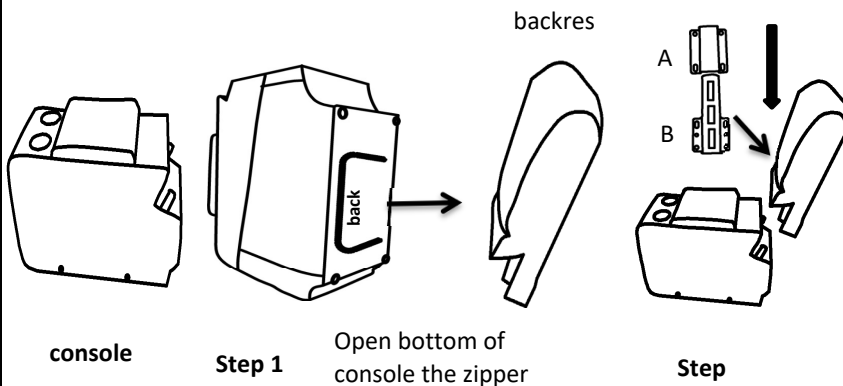

console

Step 1

Open bottom of console the zipper

Step

Armless Chair :

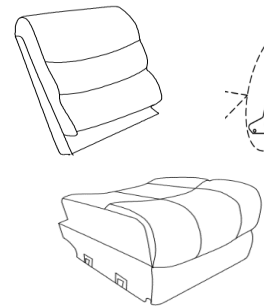

Step 2: SET UP THE SECTIONAL

LIFT THE PIECES ON THE OPEN END WHERE HOOK IS LOCATED AND LET THE DOWNWARD HOOK SLIDE INTO THE UPWARD HOOK SLOT.

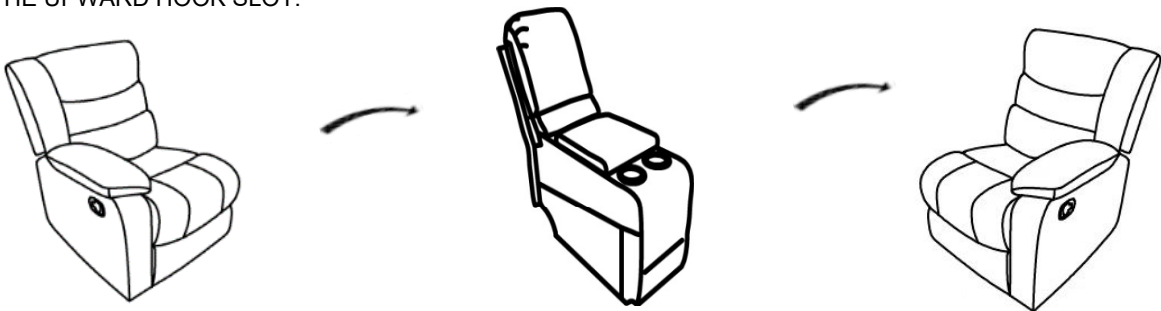

Step 3: DIFFERENT CONFIGURATIONS OF THE SECTIONAL

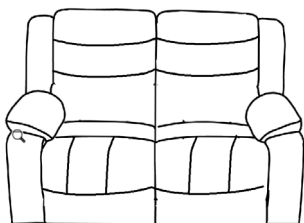

Option A

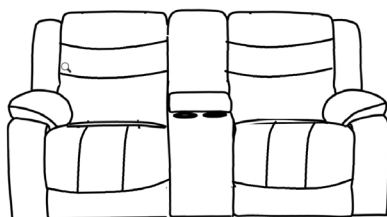

Option B

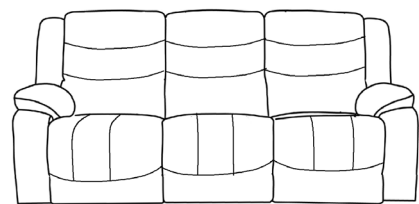

Option C