

MEDIUM DIGITAL SAFE

08/091 - Instruction Manual

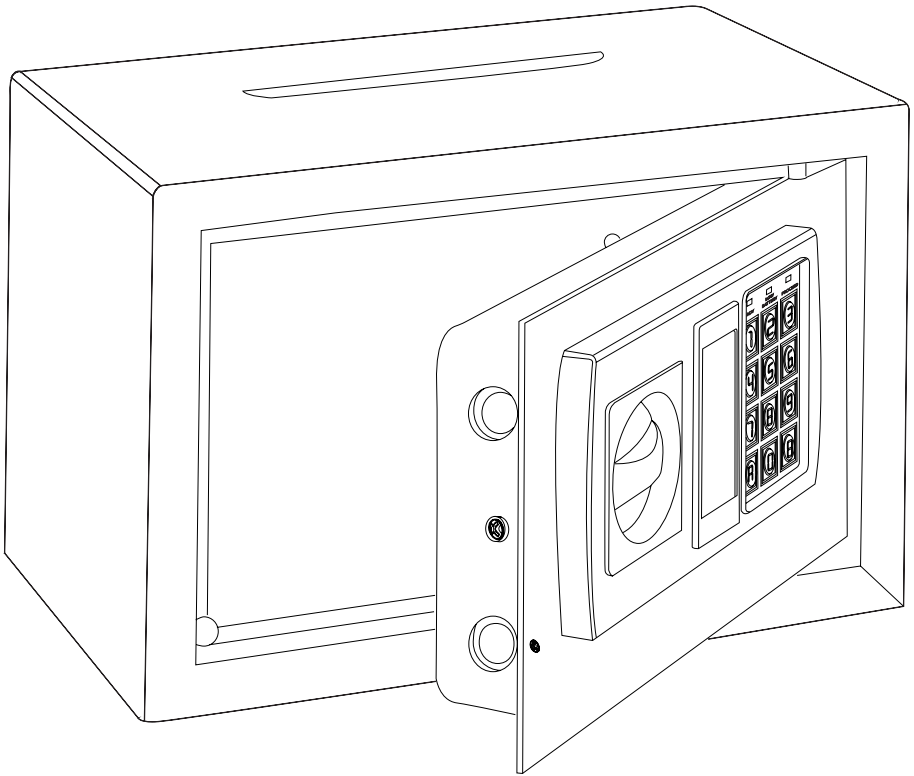

CONTENTS

Safety Instructions	1
Tools Required, Securing the Safe	2
Specification	3
Before Use	4
Quick Set Up, Usage	5
Troubleshooting	6
Warranty	7

WARNING

PLEASE READ THESE INSTRUCTIONS CAREFULLY AND KEEP FOR FUTURE REFERENCE

This manual contains important information regarding the operation and maintenance of the Medium Digital Safe. Please ensure you read and understand all instructions regarding the correct operation of the product before securing items in the Safe.

INTENDED USE.

This Safe is designed and intended for domestic indoor use only. Do not use for commercial purposes.

This Safe is not a toy. Keep away from children. Children should be supervised to ensure they do not play with the Safe.

ADVICE AND GUIDANCE FOR USE.

NEVER store the override keys (or the manual) in the Safe. Once the batteries have been exhausted, you will require the keys to override and open the Safe. For security reasons, spare keys are not available.

IMPORTANT: Store the override keys in a safe place for use in the event of the batteries becoming exhausted, or should the unlock code require resetting.

Periodically check the batteries for charge (every 3 months or as appropriate). If the batteries are of low charge, replace immediately. Refer to the '**Battery Safety**' section for guidance on battery use.

NOTE: This Safe is **NOT** fireproof or cash rated. Contact your insurance provider for guidance before storing any valuables in the Safe.

For security purposes, it is recommended that you secure the Safe to both a suitable wall and floor surface using appropriate fixings. Contact your local hardware store or qualified person for advice and guidance on the most appropriate fixings to use for your wall/surface. The Safe should be located out of sight for extra security.

Fixings supplied are intended for use with some masonry wall surfaces. If you are unsure about assembly or the suitability of your wall or the fixings, do not proceed. Contact a qualified person for advice and guidance.

NOTE: These important safeguards and instructions cannot cover all possible conditions and situations that may occur. It must be understood that common sense and caution are factors which cannot be built into any product and are the responsibility of the user.

The Safe contains no user-serviceable parts with the exception of battery replacement. Repairs should only be carried out by a qualified person. Improper repairs may compromise the integrity or function of the Safe.

BATTERY SAFETY.

This product requires 4 x 1.5V LR6 "AA" Batteries (included).

Batteries are to be inserted according to the correct polarity as indicated on the Safe.

Always recharge a full set of batteries at the same time. Do not mix old and new batteries.

Only use batteries of the same or equivalent type (e.g. Alkaline, Lithium-ion etc.)

Do not attempt to recharge non-rechargeable batteries. Rechargeable batteries should be removed from the Safe before recharging.

Do not attempt to short-circuit the supply terminals or batteries for any reason.

Do not dispose of batteries in a fire. Do not attempt to crush, puncture or in any way dismantle the batteries for any reason.

Do not dispose of batteries in your household waste. Batteries contain chemicals which are damaging to the environment. Recycle batteries where appropriate. Contact your local government offices for advice and guidance on the correct disposal of batteries or local recycling centres.

TOOLS REQUIRED *NOT INCLUDED



Power Drill

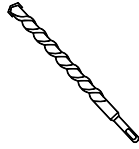

Suitable Drill Bit



Suitable Screwdriver



Wrench

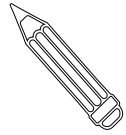

Pencil

SECURING THE SAFE

For security reasons, it is recommended that you secure the Safe against a secure masonry wall and floor surface.

1. Locate the area where the Safe is to be installed.
2. Using a pencil, mark the centre of the mounting holes inside the Safe against each surface.
3. Using a suitable drill bit, drill pilot holes in these positions.
4. Place the Safe over the pilot holes and insert the fixings (including washers to protect the Safe walls) into the pilot holes. Tighten to secure.

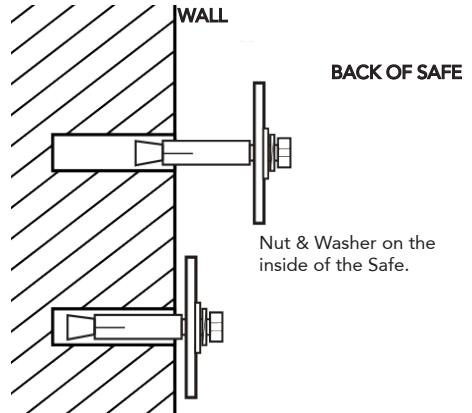

SPECIFICATIONS

DIMENSIONS

Length: 200mm
Width: 310mm
Height: 200mm

NET WEIGHT

kg
4.5

BATTERY POWER

4 x 1.5V LR6
AA

INTERNAL VOLUME

L
9.3

FIRE PROOFING

None

CASH RATING

None

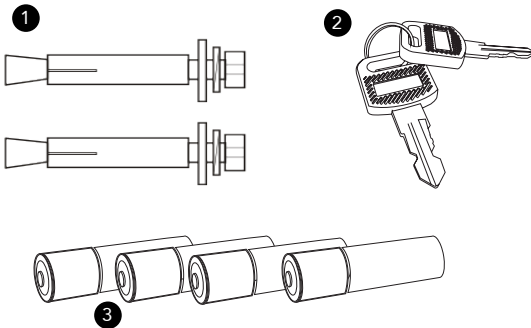
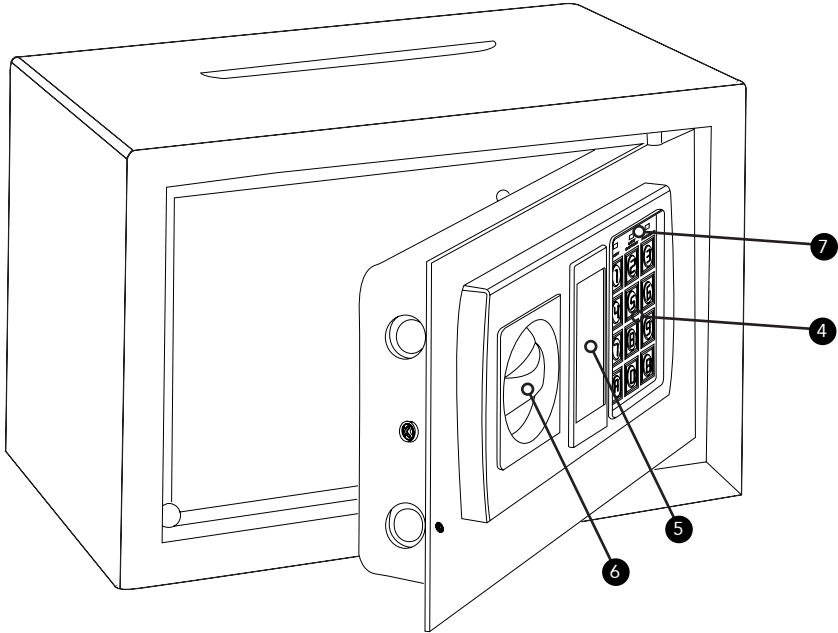

1. Anchor Bolts
2. Override Keys
3. 1.5V LR6 "AA" Batteries (x4)
4. Electronic Keypad
5. Lock Cover
6. Locking Handle
7. LED Indication
8. Battery Cover (not shown)
9. Reset Button

*Anchor Bolts are suitable for most masonry walls. Anchor Bolts are not suitable for stud or plaster walls. The Safe should not be mounted to stud or plaster walls for security.

BEFORE FIRST USE

VERRIDE KEY

The Override Keys provide a way to open the Safe if you have forgotten your code or the batteries have been exhausted.



WARNING! NEVER lock your Override Keys (2) in the Safe. Keep separate in a secure location for future use.

Unlock the Safe using the Override Keys. Open the Lock Cover (5) to expose the keyhole. Insert the Override Key and turn anticlockwise (left) to the end and hold in this position. Turn the Locking Handle (6) clockwise (right) and then open the Safe. Return the Override Key to its central position and retain for future use.

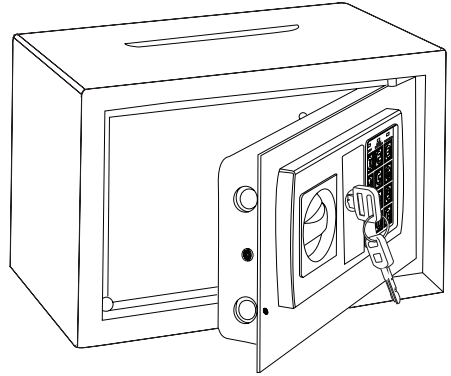

INSTALLING BATTERIES

Remove the battery cover located on the back of the Safe door. Push in the catch and carefully remove the cover.

Insert 4 x 1.5V LR6 "AA" Batteries (included) according to the correct polarity as indicated on the inside of the battery compartment. Replace the battery cover to secure.

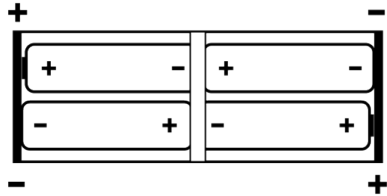

LOW BATTERY INDICATION

The Red Low Battery Light will illuminate when the Safe is opened to indicate whether the batteries need replacing. If lit, replace the batteries before closing the Safe.

NOTE: Periodically check the batteries (every 3 months or as appropriate). Replace if necessary. If the batteries are exhausted or removed, the Safe will retain the user unlock code for approximately **4 hours**. After this time, the user will be required to open the Safe using the Override Key and reset their unlock code.

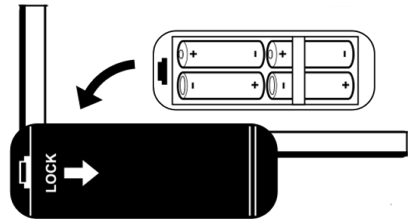

QUICK SET UP

1. Open the door with key, (lock is located behind the Lock Cover (5)).
2. Insert batteries .
3. Press the Reset Button (located inside the safe).
4. Insert desired code followed by "A" or "B" buttons.
5. To unlock use the code followed by the "A" or "B" buttons.

USAGE

SETTING AN UNLOCK CODE

Open the Safe door and locate the protruding button press to begin.

- The Safe will beep. The Orange Indicator Light will illuminate for approx 20 seconds.
- During this period, select and enter an unlock code between 3-8 digits long and press the "A or B" button to assign the code.
- If successful, the Safe will confirm with beeps.

NOTE: It is recommended that your unlock code be easily memorable but should not be personal information such as birthdays, anniversaries, telephone numbers etc. as these may be easy to guess and compromise the security of the Safe.

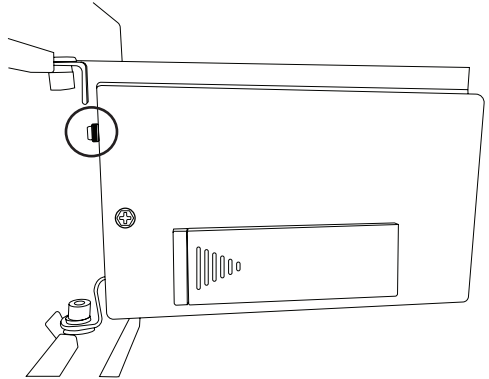

OPENING THE SAFE USING THE UNLOCK CODE.

- Once an unlock code has been set, the Safe can be opened by entering the unlock code using the Electronic Keypad (4) and confirming the code by pressing "A or B".
- The Orange Indicator Light will illuminate to acknowledge the input of each number. If the correct code is entered the safe will beep and the locking mechanism will disengage for approx. 5 seconds.
- During this period, turn the Locking Handle (6) clockwise (right) and then open the Safe.

NOTE: If the user has entered an incorrect code, the Orange Indicator Light will illuminate. The user must enter the code again. Inserting the wrong code 3 times in a row will lock the electronic keypad for 20 seconds.

LOCKING THE SAFE

Close the Safe door and turn the Locking Handle anti-clockwise (left) to engage the locking mechanism.

TROUBLESHOOTING

PROBLEM	SOLUTION
LOST OVERRIDE KEYS AND PIN NUMBER FORGOTTEN AND BATTERIES HAVE EXHAUSTED	Please contact hello@DOMU.co.uk
KEYPAD IS NOT RESPONDING	Open the Safe using the Override Keys and replace the batteries.
SAFE WILL NOT OPEN WHEN CORRECT UNLOCK CODE IS ENTERED	Unlock the Safe using the Override Keys and replace the batteries. Reset the unlock code.
LOCK IS STIFF	Lubricate the lock using a suitable non-water-based lubricant and try again.
CODE HAS RESET AND BATTERIES HAVE EXHAUSTED	Open the Safe using the Override Keys and reset the unlock code.
DOOR WILL NOT OPEN WITH OVERRIDE KEYS	Ensure the Override Keys are turned anticlockwise and held whilst the Locking Handle is turned clockwise and pulled to open the door.

The sticker on the front of the Digital Safe is the serial number of the keys. Please make a note of this serial number and keep it in a safe and secure place.

For extra safety, you may wish to peel off the sticker from the Safe.

In the event that additional keys are required, please contact DOMU Brands Customer Services to arrange for replacement keys to be provided:

Tel: +44(0) 161 833 5447

E-mail: hello@domu.co.uk

PLEASE NOTE: There is a charge for this service.

DISPOSAL INFORMATION

Please recycle where facilities exist. Check with your local authority for recycling advice.

WARRANTY

To register your product and find out if you qualify for a free extended warranty please go to

www.Vonhaus.com/warranty.

Please retain a proof of purchase receipt or statement as proof of the purchase date.

The warranty only applies if the product is used solely in the manner indicated in the Warnings page of this manual, and all other instructions have been followed accurately. Any abuse of the product or the manner in which it is used will invalidate the warranty.

Returned goods will not be accepted unless re-packaged in its original colour box and accompanied by a relevant and completed returns form. This does not affect your statutory rights.

No rights are given under this warranty to a person acquiring the appliance second-hand or for commercial or communal use.

COPYRIGHT

All material in this instruction manual are copyrighted by DOMU Brands Ltd.

Any unauthorised use may violate worldwide copyright, trademark, and other laws.

www.VonHaus.com

Thank you for purchasing the Medium Digital Safe

VonHaus is a registered trademark of DOMU Brands Ltd
Made in China for DOMU Brands Ltd BL2 2HH

VonHaus