

Power Lift Chair Recliner With Heat+Massage



We're excited for you to regain your independence with Lift Chair!
To ensure the best experience, please read this guide carefully before
using your new lift chair.

Be sure to keep this manual close by, preferably in your chair pocket so
that you can always refer to it as needed.



Safety Rules.....	3&4
Lift Chair Parts.....	5
Heat/Massage Remote	6
How to use the massage features.....	6
Massage Areas & Assembly Parts.....	7
Assembly Instructions.....	8&9&10
Lift and Recline Function.....	11
Date Sheet.....	12
Troubleshooting.....	13

SAFETY RULES

- Never set the lift chair in wet/damp areas or where dust can accumulate as these could cause an electrical fault or a mechanical dysfunction.
- Never use the lift chair inside your home if the room temperature is over 90°F.
- Never place the lift chair near a heat source(oven,chimney,fernace etc...) or in direct sunlight.

Do Not use the armchair if:

- The lift chair is wet.
- Your hands are wet.
- Only clean the chair with a dry cloth.
- It's advisable not to use the heat or massage feature for more than 30 minutes at a time and that you drink 2 glasses of water after using it.

Situations where you should not use the lift chair:

Switch the lift chair's massage system off if it gets wet or seems not to be working properly,if any part of the lift char is damaged or malfunctioning,if any part of the lift chair appears to be damaged or wiring is exposed,if you feel unwell or feel any pain during the massage,or if ther has been a general electrical fault.

Usage:

- Indoors, avoid high temperatures and wet or damp areas.

Precaution:

- Never sit on the remote or place heavy objects on top of it.
- Do not drop the remote on the floor.
- Do not tug on the electric cable.
- Do not use the remote with wet fingers.
- Do not press or touch the buttons with sharp objects.
- Never unplug the remote without first turning the power off.
- The lift chair should rest for 30 minutes after it has been used for 30 minutes.

When the massage system of the lift chair is not in use:

- Make sure it is switched off.
- Unplug the lift chair's massage system from the wall outlet when you are not going to use it for long periods of time.
- Keep the lift chair in a clean and dry place.

Do not disassemble the lift chair:

- Do not remove the back of the lift chair .
- Do not try to disassemble or repair the lift chair yourself.
- Tampering with the lift chair will void your warranty.please call us with any questions.

Correct way to handle the electrical plug:

- Check that you have the right voltage.
- Never use force on the cable or plug.
- Never pull the cable with wet hands.
- When removing the plug, hold the plug itself, do not pull on the cable.
- Do not use the lift chair system if either the cable or the plug are damaged.

Lift chair Parts:

- 1) Back
- 2) Armrests
- 3) Seat
- 4) Footrest
- 5) 2 Control units
 - Heat/Massage Remote
 - Lift/Recline Remote



Heat/Massage Remote

1) Power On/Power Off

2) Heating function

3) Intensity

4) Massage mode

5) Select massage area

- **Back**

- **Lumbar region**

- **Thighs**

- **Legs**

2) Timer

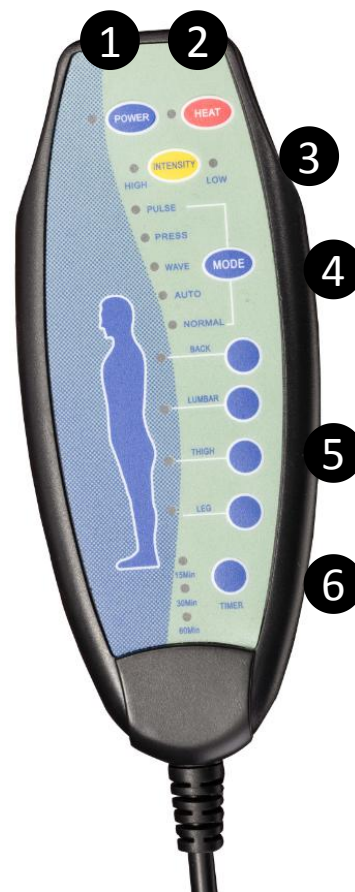

How to Use the massage features

POWER: Press the Power button to start, press it again to Stop.

MODE: With the Mode button, you can choose from 9 different massage systems.

We recommend the default setting when the massage feature is powered On. To select the massage area, just press the button you want to select: back, lumbar region, thighs and legs.

- **INT:** The INTensity of the massage can be controlled, select from high or low.
- **Timer:** You can choose 15Min, 30Min or 60 Min timer for massage and heating.

Massage Areas

- The lift chair has 8 vibrating massage points for 2 points in 4 areas: Back, Lumbar, Thighs, Legs. Each Region can be controlled by the massage remote as well as the type of massage pattern and intensity.

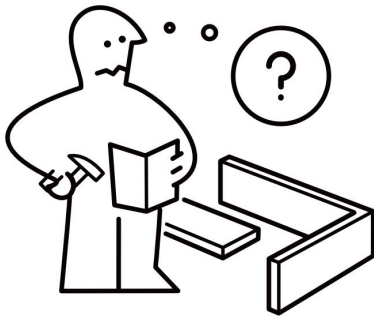
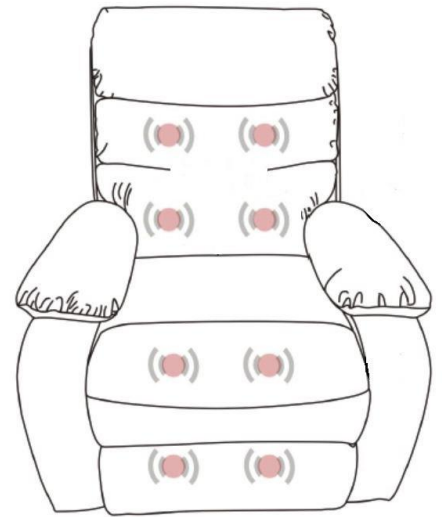

- Please check you have all hardware before assembling.
- Please ensure you have all the parts and hardwares as the instruction shown.
- Please contact us by mail, if you have any questions, and we will reply you ASAP.
- Enjoy your new purchase!

Lift and Recline Function

Assembly Parts:

Chair base

A.

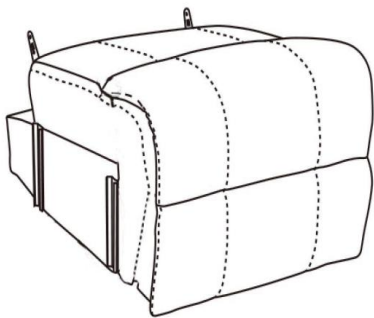

x1

Backrest

B.

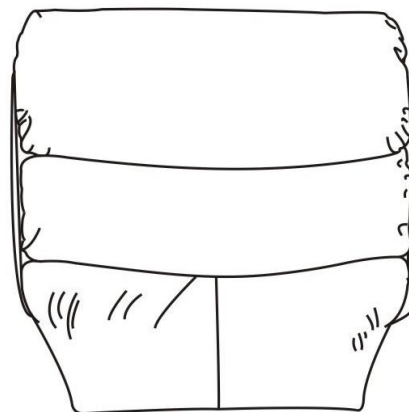

x1

Armrests

C.

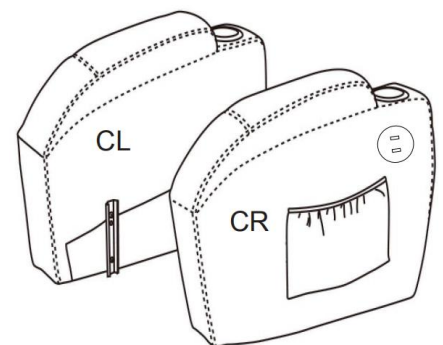

x1

Supplies:

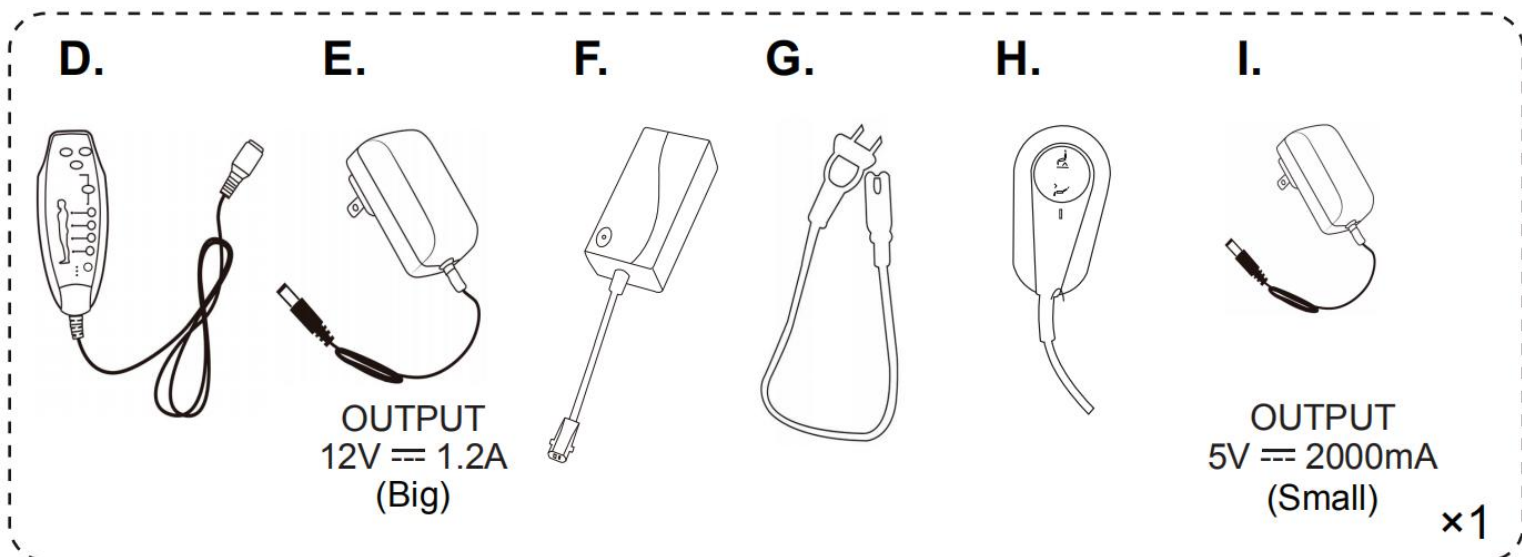

Note:

Please check the electric current on Part E and Part I to distinguish them. Part E is used for massage, Part I is used for USB.

1. Position the armrests

Put the armrests fit into the seat, you will hear a "click" when they are in place.

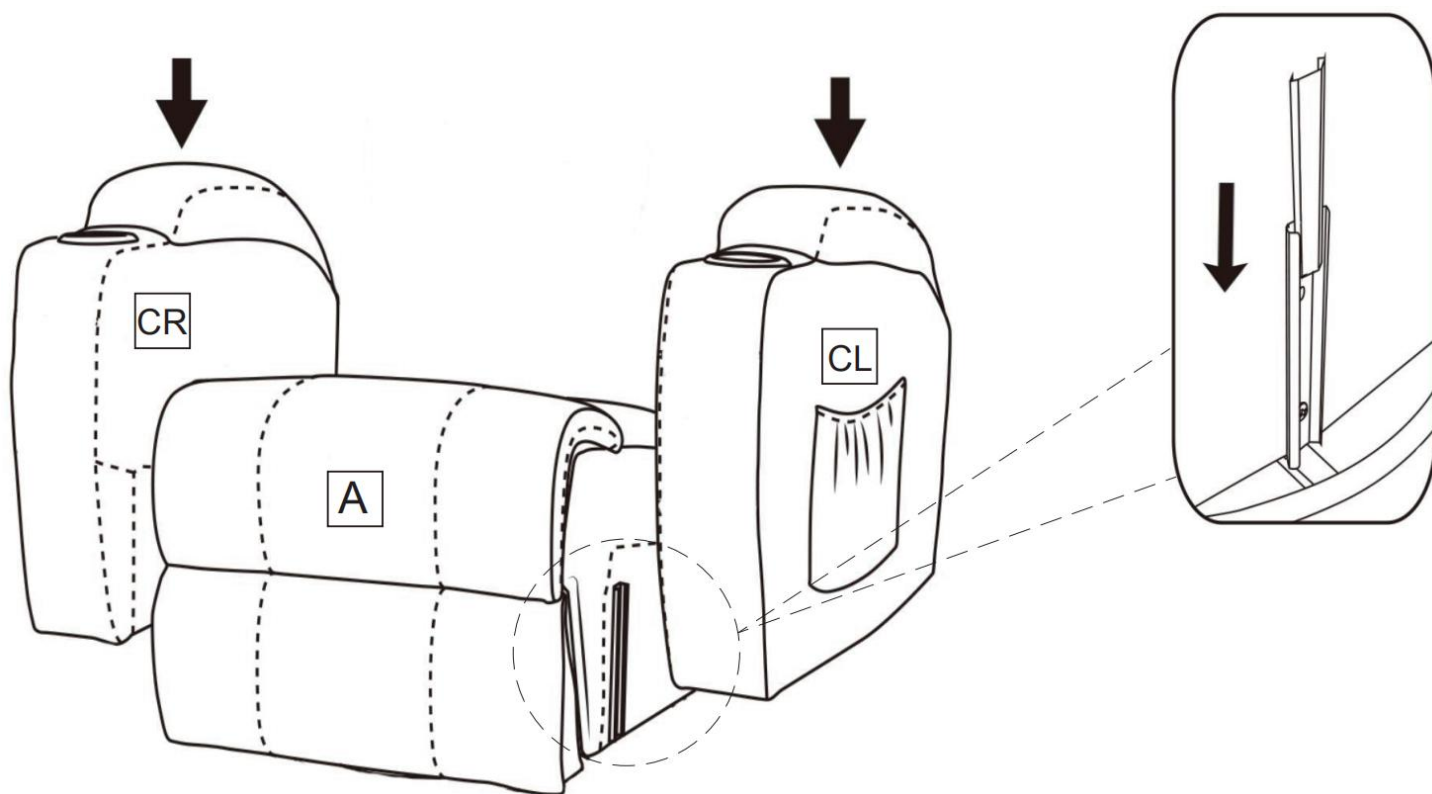

2. Position the backrest

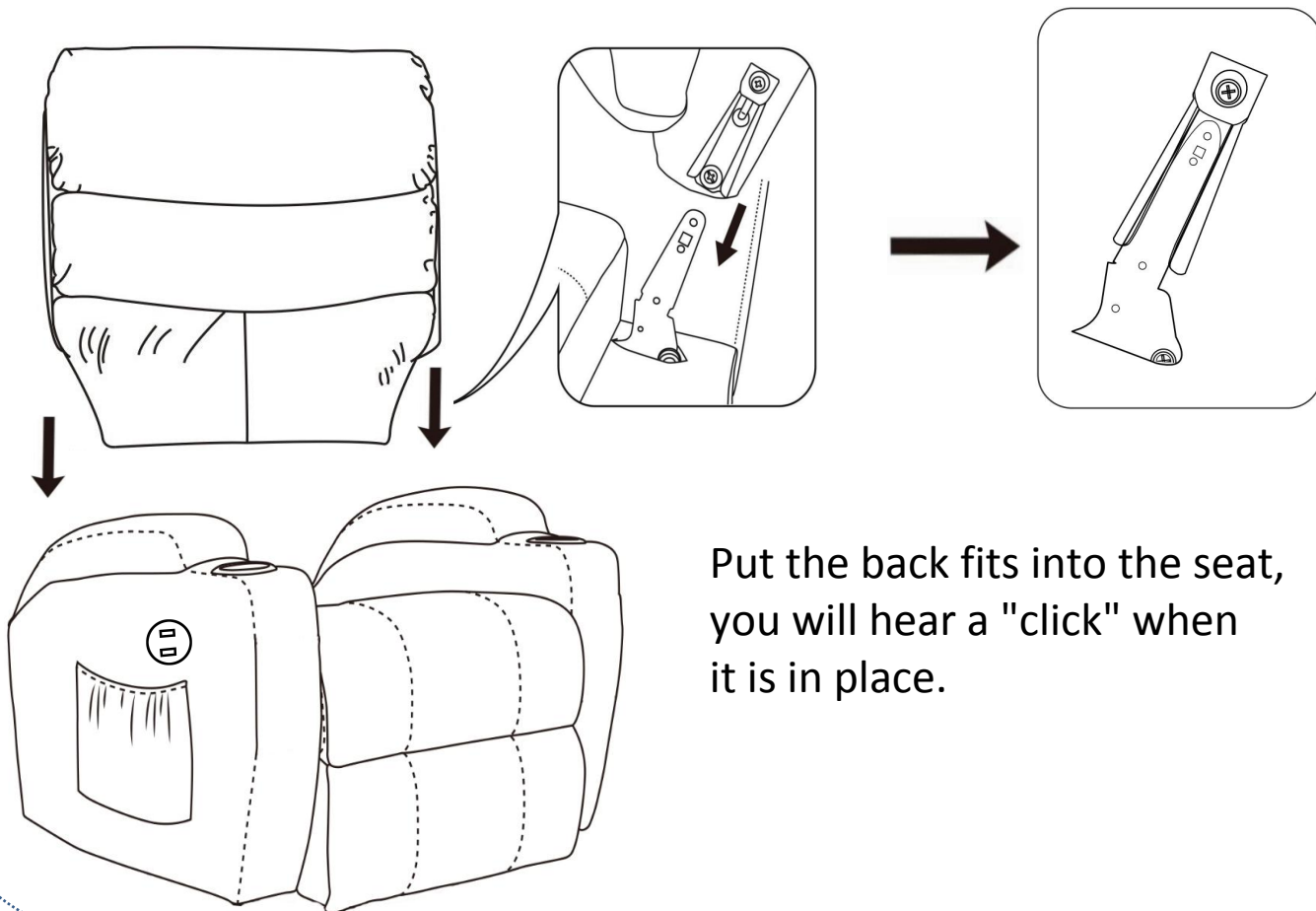

3. Connect the supply cable pins

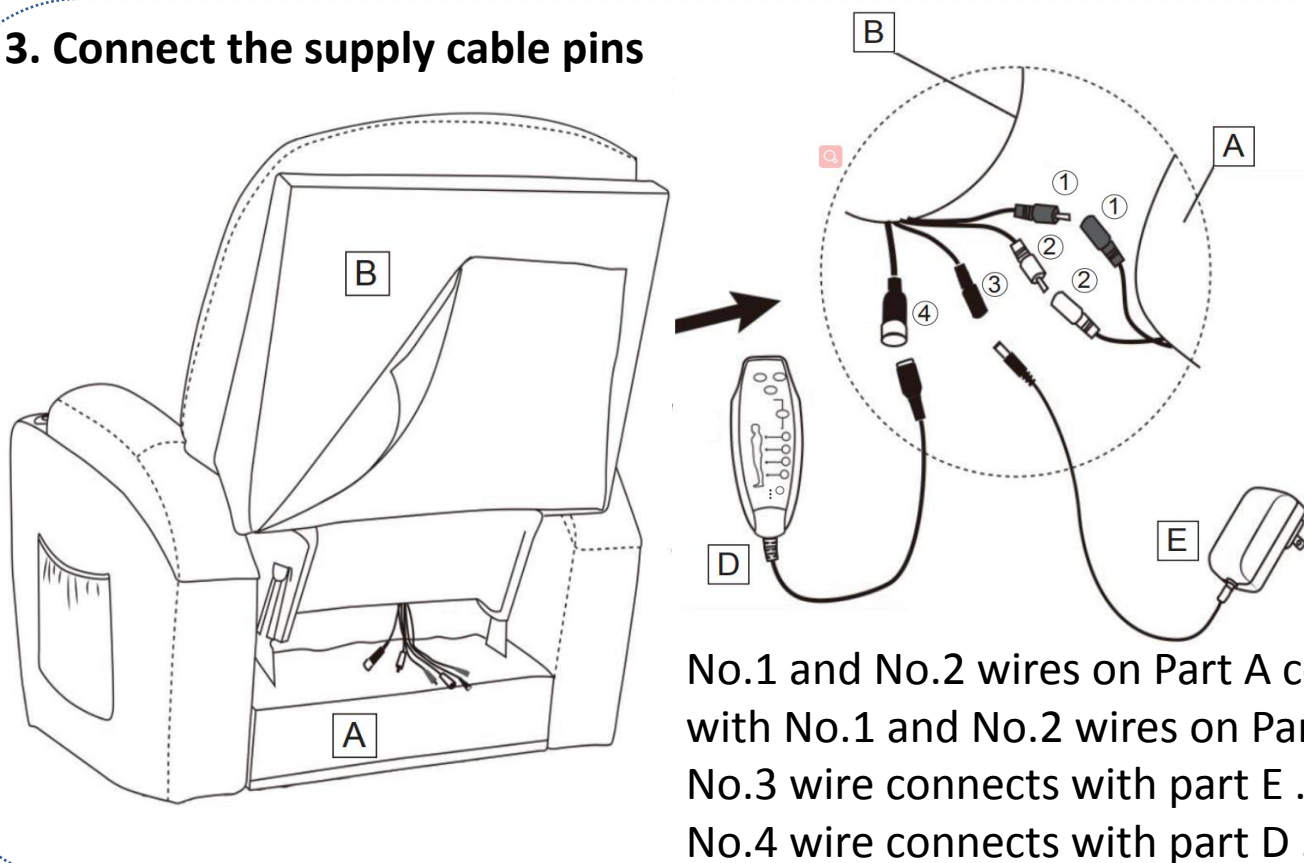

Fits the pins properly in the manner shown in the image.

Do not force them, they only have one correct position.

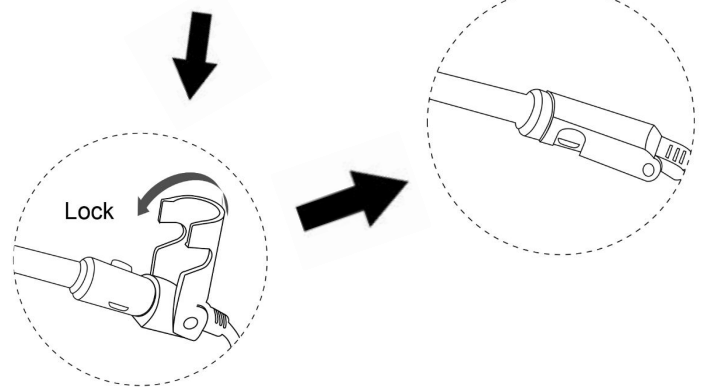
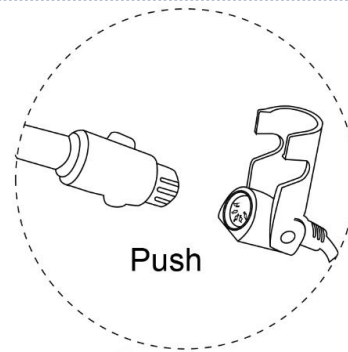
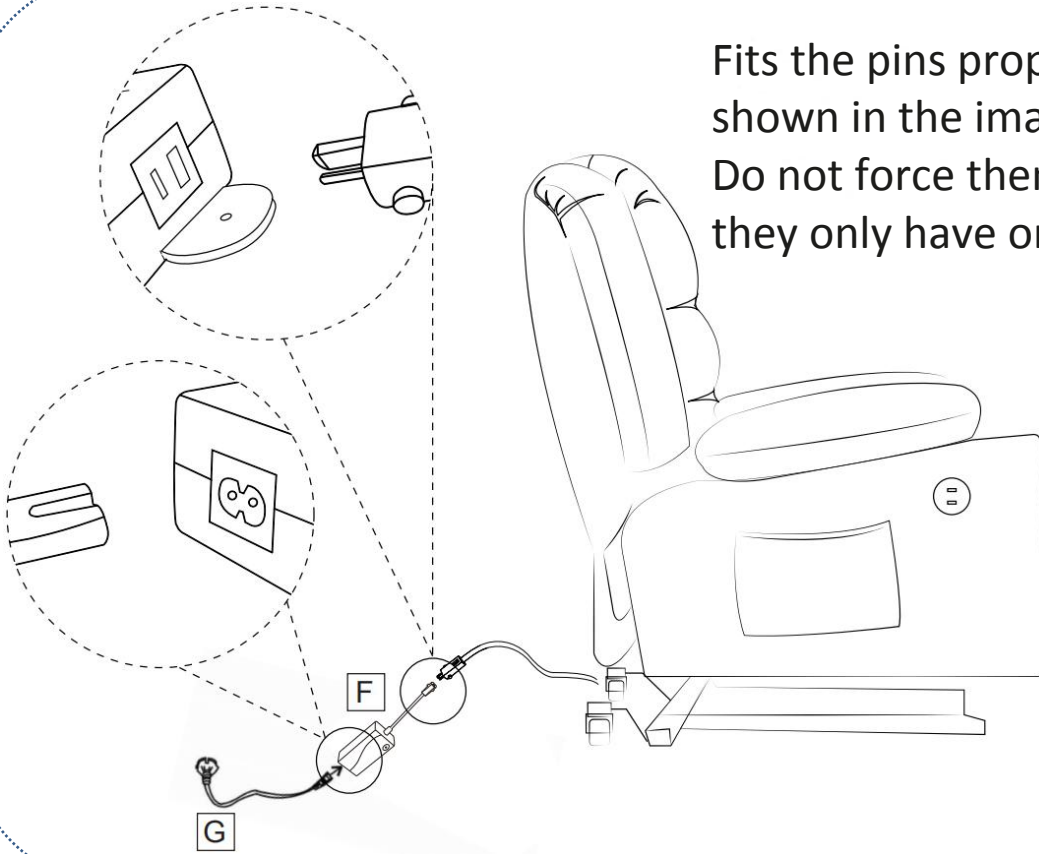



The pins must be connected correctly.

If the lift chair doesn't work when you finally turn it on, it is because the pins have been connected incorrectly.

If that should happen, turn the power off and reconnect the pins.

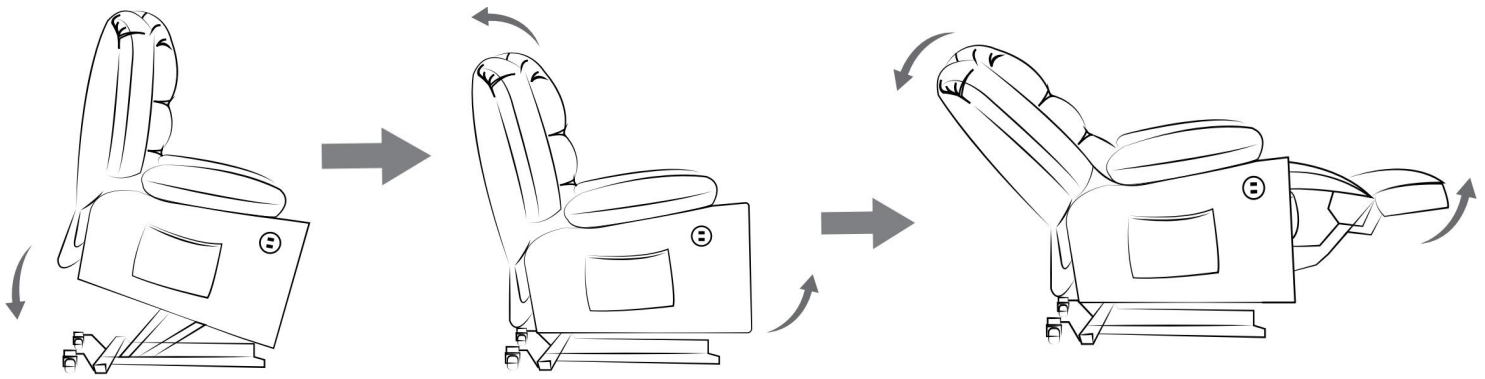
1. Please keep pressing the button  , the lift chair will return from standing position to sitting position. If you keep pressing the button, the legrest will rise up, at the same time, backrest will move down.



2. Please press the button  , the legrest will move down, at the same time, backrest will raise up. If you keep pressing the button, the lift chair will rise up and forward until it elevates you a standing position.

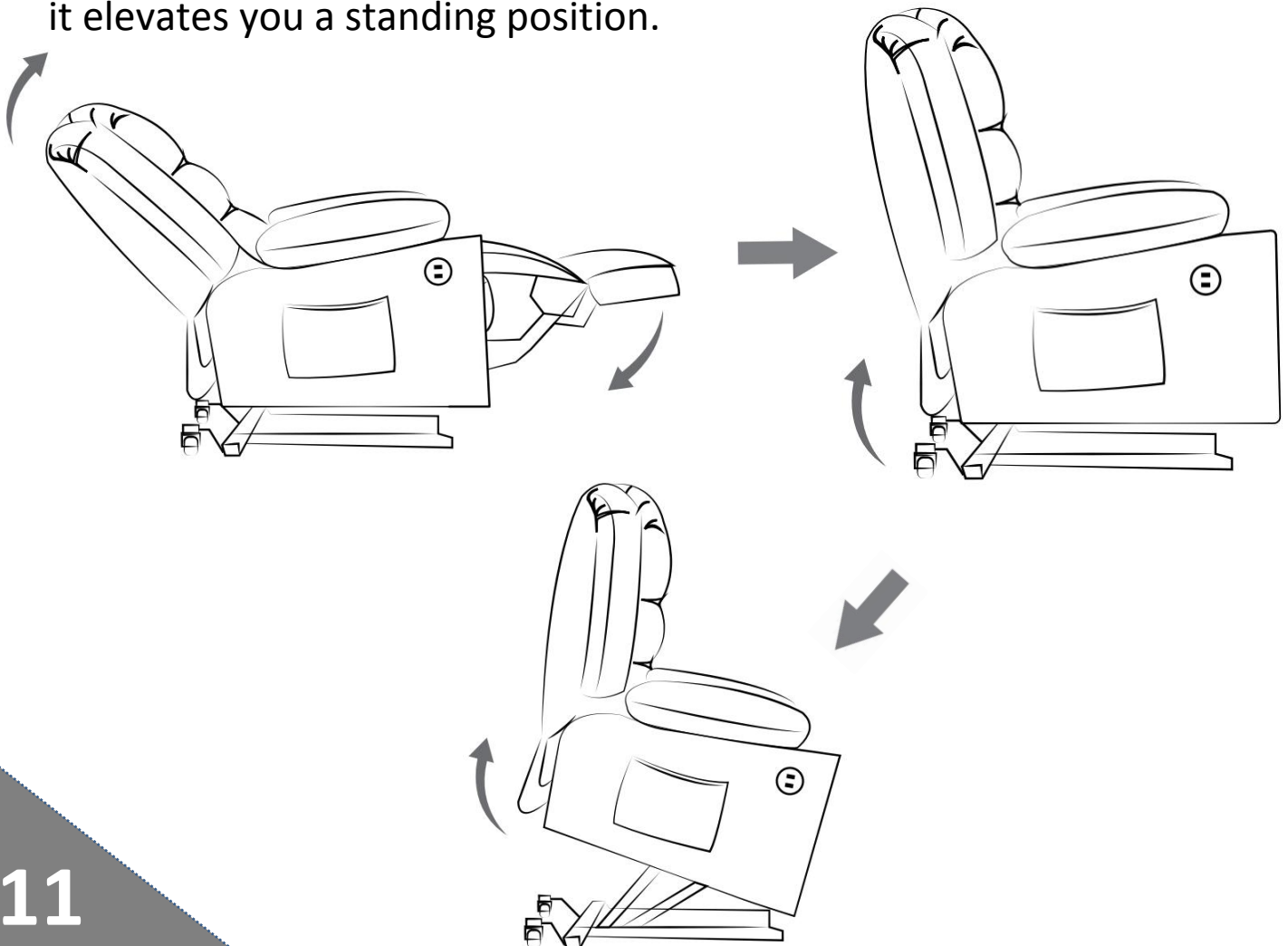

Data sheet

- Mains plug (CETL; CUL)
- Voltage: o Input: 110V-50HZ o Output: DC12V
- Packaging size: 75.5 cm x 57 cm x 49.5 cm
77 cm x 72.5 cm x 45.5 cm
- Armchair measurements: 90 cm x 94 cm x102 cm
- Weight: 45 Kg
- Maximum weight supported: 125 kg.
- Max Heating Temperature:50-60°C(90° F Max)
- Material: PU



The Dimensions:

Height-42.9"

Width-32"

Length-36"

Seat Width-20.5"

Arm Height-23.8"



Troubleshooting:

If the lift chair is not working, check the following chart. Make sure you turn the power off and unplug from the wall outlet. If you have any questions, please contact us. Do not disassemble or repair any part of the lift chair yourself.

PROBLEM

POSSIBLE CAUSE

There is a noise during the massage

The noise is caused by the massage motors, and is normal.

The lift chair does not function when the button on the control unit is activated

Check that the plug is pushed into the wall outlet properly.
Check whether the power supply button is on.